

4FT PRE-LIT XMAS TREE

Please read the following carefully to ensure the safe and satisfactory use of this product. Retain the box for storage and future reference. Dispose of any surplus packaging with care and consideration for others and the environment

Instructions for Use

This Pop-Up Tree comes in two individual sections, with the main body being of collapsible construction and the upper section of wrapped construction for adjustment of display.

1. After unpacking the product, attach the 4 support feet into the slots on the side of the base, as shown in Fig 1 below.
2. Locate the connectable metal trunk frame tubes and join together, inserting into the central hole within the base unit as shown in Fig 1 and Fig 2 below.
3. Locate the lower section of the collapsed tree and carefully fit this over the top of the trunk frame - ensuring that the top of the frame is over and within the inner central rim of the collapsed tree, as shown in Fig 3.
4. Carefully let the actual tree drop towards the ground, around the inner trunk frame, then locate the top section of the tree and connect this to the hole on the upper end of the already assembled lower section, as shown in Fig 4.
5. Please ensure that the two sections of light chain are correctly and securely connected together, as shown in Fig 4.
6. With the tree assembled and in your desired location, it is now recommended that you arrange the branches to your preferred display. This process is known as "tweaking". We suggest tweaking all branches from the spiral sections – some up, some down and some remain central – this will create the fullness effect of the tree concealing unnecessary space gaps within the Pop-Up / Collapsible construction. The top section of the tree can then be arranged in similar fashion making the perfect artificial Christmas tree.
7. The lights are activated by connecting the transformer to your indoor mains supply socket and switching on the mains power.
8. The LED lights are sealed units and not user replaceable. Although these LED's are not user replaceable they are highly energy efficient and have a life many times greater than an ordinary filament bulb.

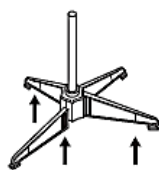

Fig 1

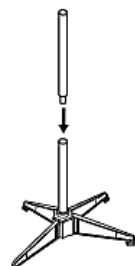

Fig 2

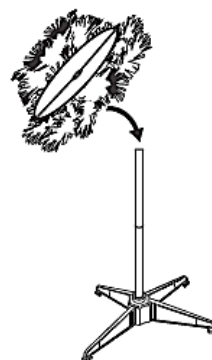

Fig 3

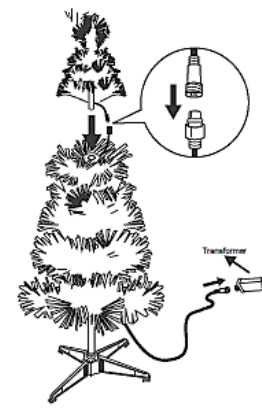

Fig 4

WARNING

- THIS PRE-LIT TREE IS FOR INDOOR USE ONLY.
- THE TREE STAND MUST BE PLACED ON A RIGID SURFACE.
- DO NOT OPERATE THIS PRODUCT WHILST IN PACKAGING.
- DISCONNECT FROM THE MAINS SUPPLY WHEN NOT IN USE.
- DO NOT OPERATE IN A CONFINED SPACE OR ALLOW TO COME INTO CONTACT WITH ANY FLAMMABLE MATERIALS.
- DO NOT ALLOW ANY PART OF THIS SET TO COME INTO CONTACT WITH DIRECT HEAT OR FLAME.
- THE TRANSFORMER IS A SEALED UNIT, DO NOT ATTEMPT TO OPEN OR TAMPER WITH IT.
- THERE ARE NO USER REPLACEABLE PARTS TO THIS PRODUCT.
- PLEASE KEEP A FREE FLOW OF AIR AROUND THE TRANSFORMER.
- KEEP AWAY FROM SOURCES OF HEAT OR FLAME.
- DO NOT LEAVE THIS UNATTENDED WHEN IN USE.
- ALWAYS SWITCH OFF AND DISCONNECT FROM THE MAINS SUPPLY WHEN NOT IN USE.

The Environment:

Do not put this product in regular domestic waste at end of life. For further advice on disposal of electrical goods please contact your local authority. Packaging is widely recyclable.

SPECIFICATION:

Transformer: JT-DC31V3.6W-E3-IP44
Supply: 220-240V ~ 50-60Hz 0.10A
Output: 31V ~ Max 3.6VA

CARE AND CLEANING INSTRUCTIONS:

- Do NOT use abrasive cleaners or sharp utensils to clean this product.
- Store the item in a cool, dry place.
- Wipe with a clean dry cloth.

DISPOSAL

- Dispose of all packaging, paper, cartons, plastic and plastic bags in accordance with your local recycling regulations.
- At the end of the product's lifespan please dispose of it at an authorised household WEEE waste recycling centre.



5FT PRE-LIT XMAS TREE

Please read the following carefully to ensure the safe and satisfactory use of this product. Retain the box for storage and future reference. Dispose of any surplus packaging with care and consideration for others and the environment

Instructions for Use

This Pop-Up Tree comes in two individual sections, with the main body being of collapsible construction and the upper section of wrapped construction for adjustment of display.

1. After unpacking the product, attach the 4 support feet into the slots on the side of the base, as shown in Fig 1 below.
2. Locate the connectable metal trunk frame tubes and join together, inserting into the central hole within the base unit as shown in Fig 1 and Fig 2 below.
3. Locate the lower section of the collapsed tree and carefully fit this over the top of the trunk frame - ensuring that the top of the frame is over and within the inner central rim of the collapsed tree, as shown in Fig 3.
4. Carefully let the actual tree drop towards the ground, around the inner trunk frame, then locate the top section of the tree and connect this to the hole on the upper end of the already assembled lower section, as shown in Fig 4.
5. Please ensure that the two sections of light chain are correctly and securely connected together, as shown in Fig 4.
6. With the tree assembled and in your desired location, it is now recommended that you arrange the branches to your preferred display. This process is known as "tweaking". We suggest tweaking all branches from the spiral sections – some up, some down and some remain central – this will create the fullness effect of the tree concealing unnecessary space gaps within the Pop-Up / Collapsible construction. The top section of the tree can then be arranged in similar fashion making the perfect artificial Christmas tree.
7. The lights are activated by connecting the transformer to your indoor mains supply socket and switching on the mains power.
8. The LED lights are sealed units and not user replaceable. Although these LED's are not user replaceable they are highly energy efficient and have a life many times greater than an ordinary filament bulb.

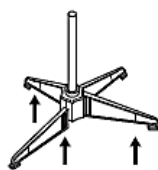

Fig 1

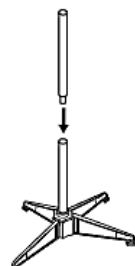

Fig 2

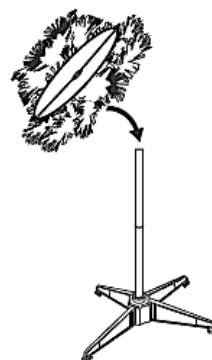

Fig 3

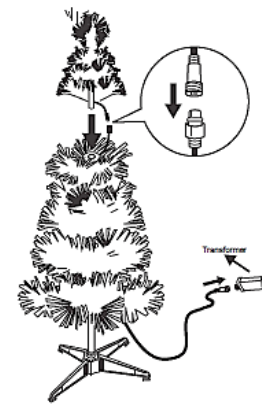

Fig 4

WARNING

- THIS PRE-LIT TREE IS FOR INDOOR USE ONLY.
- THE TREE STAND MUST BE PLACED ON A RIGID SURFACE.
- DO NOT OPERATE THIS PRODUCT WHILST IN PACKAGING.
- DISCONNECT FROM THE MAINS SUPPLY WHEN NOT IN USE.
- DO NOT OPERATE IN A CONFINED SPACE OR ALLOW TO COME INTO CONTACT WITH ANY FLAMMABLE MATERIALS.
- DO NOT ALLOW ANY PART OF THIS SET TO COME INTO CONTACT WITH DIRECT HEAT OR FLAME.
- THE TRANSFORMER IS A SEALED UNIT, DO NOT ATTEMPT TO OPEN OR TAMPER WITH IT.
- THERE ARE NO USER REPLACEABLE PARTS TO THIS PRODUCT.
- PLEASE KEEP A FREE FLOW OF AIR AROUND THE TRANSFORMER.
- KEEP AWAY FROM SOURCES OF HEAT OR FLAME.
- DO NOT LEAVE THIS UNATTENDED WHEN IN USE.
- ALWAYS SWITCH OFF AND DISCONNECT FROM THE MAINS SUPPLY WHEN NOT IN USE.

The Environment:

Do not put this product in regular domestic waste at end of life. For further advice on disposal of electrical goods please contact your local authority. Packaging is widely recyclable.

SPECIFICATION:

Transformer: JT-DC31V3.6W-E3-IP44
Supply: 220-240V ~ 50-60Hz 0.10A
Output: 31V ~ Max 3.6VA

CARE AND CLEANING INSTRUCTIONS:

- Do NOT use abrasive cleaners or sharp utensils to clean this product.
- Store the item in a cool, dry place.
- Wipe with a clean dry cloth.

DISPOSAL

- Dispose of all packaging, paper, cartons, plastic and plastic bags in accordance with your local recycling regulations.
- At the end of the product's lifespan please dispose of it at an authorised household WEEE waste recycling centre.



6FT PRE-LIT XMAS TREE

Please read the following carefully to ensure the safe and satisfactory use of this product. Retain the box for storage and future reference. Dispose of any surplus packaging with care and consideration for others and the environment

Instructions for Use

This Pop-Up Tree comes in two individual sections, with the main body being of collapsible construction and the upper section of wrapped construction for adjustment of display.

1. After unpacking the product, attach the 4 support feet into the slots on the side of the base, as shown in Fig 1 below.
2. Locate the connectable metal trunk frame tubes and join together, inserting into the central hole within the base unit as shown in Fig 1 and Fig 2 below.
3. Locate the lower section of the collapsed tree and carefully fit this over the top of the trunk frame - ensuring that the top of the frame is over and within the inner central rim of the collapsed tree, as shown in Fig 3.
4. Carefully let the actual tree drop towards the ground, around the inner trunk frame, then locate the top section of the tree and connect this to the hole on the upper end of the already assembled lower section, as shown in Fig 4.
5. Please ensure that the two sections of light chain are correctly and securely connected together, as shown in Fig 4.
6. With the tree assembled and in your desired location, it is now recommended that you arrange the branches to your preferred display. This process is known as "tweaking". We suggest tweaking all branches from the spiral sections – some up, some down and some remain central – this will create the fullness effect of the tree concealing unnecessary space gaps within the Pop-Up / Collapsible construction. The top section of the tree can then be arranged in similar fashion making the perfect artificial Christmas tree.
7. The lights are activated by connecting the transformer to your indoor mains supply socket and switching on the mains power.
8. The LED lights are sealed units and not user replaceable. Although these LED's are not user replaceable they are highly energy efficient and have a life many times greater than an ordinary filament bulb.

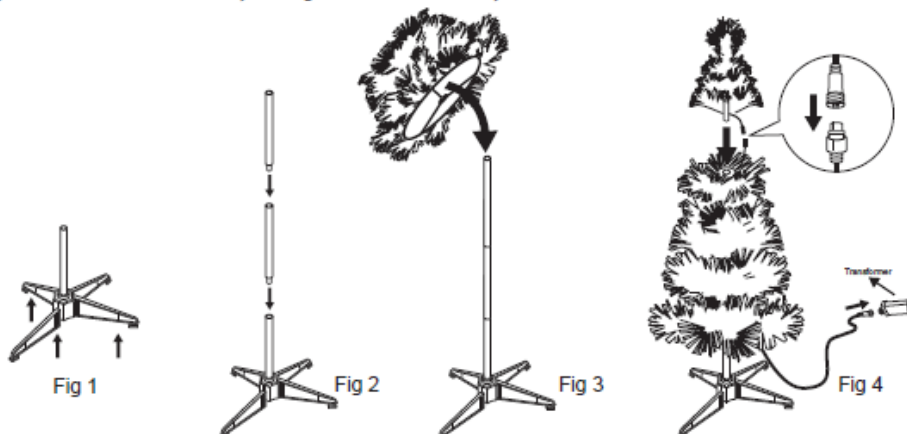

WARNING

- THIS PRE-LIT TREE IS FOR INDOOR USE ONLY.
- THE TREE STAND MUST BE PLACED ON A RIGID SURFACE.
- DO NOT OPERATE THIS PRODUCT WHILST IN PACKAGING.
- DISCONNECT FROM THE MAINS SUPPLY WHEN NOT IN USE.
- DO NOT OPERATE IN A CONFINED SPACE OR ALLOW TO COME INTO CONTACT WITH ANY FLAMMABLE MATERIALS.
- DO NOT ALLOW ANY PART OF THIS SET TO COME INTO CONTACT WITH DIRECT HEAT OR FLAME.
- THE TRANSFORMER IS A SEALED UNIT, DO NOT ATTEMPT TO OPEN OR TAMPER WITH IT.
- THERE ARE NO USER REPLACEABLE PARTS TO THIS PRODUCT.
- PLEASE KEEP A FREE FLOW OF AIR AROUND THE TRANSFORMER.
- KEEP AWAY FROM SOURCES OF HEAT OR FLAME.
- DO NOT LEAVE THIS UNATTENDED WHEN IN USE.
- ALWAYS SWITCH OFF AND DISCONNECT FROM THE MAINS SUPPLY WHEN NOT IN USE.

The Environment:

Do not put this product in regular domestic waste at end of life. For further advice on disposal of electrical goods please contact your local authority. Packaging is widely recyclable.

SPECIFICATION:

Transformer: JT-DC31V3.6W-E3-IP44
Supply: 220-240V ~ 50-60Hz 0.10A
Output: 31V ~ Max 3.6VA

CARE AND CLEANING INSTRUCTIONS:

- Do NOT use abrasive cleaners or sharp utensils to clean this product.
- Store the item in a cool, dry place.
- Wipe with a clean dry cloth.

DISPOSAL

- Dispose of all packaging, paper, cartons, plastic and plastic bags in accordance with your local recycling regulations.
- At the end of the product's lifespan please dispose of it at an authorised household WEEE waste recycling centre.

