

# Burgundy 2in1 Vacuum 600W J038 Instructions for Use

Please read and retain these instructions for future reference

v003:02/11/22



## Power Details:

Voltage:	220-240Va.c.
Frequency:	50/60Hz
Wattage:	600W max
Size:	105cm x 26cm x15.5cm
Weight:	1.7kg
Capacity:	0.9L
Noise level:	77db (approx.)



## Features:

- Removable handle and 2-in-1 design (stick vac/handheld vac)
- Lightweight stick design allows for easy manoeuvring
- Versatility and ability to vacuum awkward spaces
- Works great on hard floors
- Full set accessories to cover variable cleaning needs
- This appliance uses cyclone filter system with bag-less design. The appliance uses a washable filter system. The dust cup is easy to detach and is washable.

**COOPERS  
OF STORTFORD**

UK Head Office, 11 Bridge Street, Bishop's Stortford, CM23 2JU

Tel: 0844 4824400\*, Fax: 01279 756595

[www.coopersofstortford.co.uk](http://www.coopersofstortford.co.uk)

EU address: D.S.B. LD, 160 Bd. de Fourmies, 59100 Roubaix, France

Tel: (+44) 1279 701269

\*UK Calls cost around 7 pence per minute plus your telephone company's network access.  
Please check with your telephone supplier.

# Burgundy 2in1 Vacuum 600W J038 Instructions for Use

Please read and retain these instructions for future reference

v003:02/11/22

## PARTS AND ACCESSORIES:

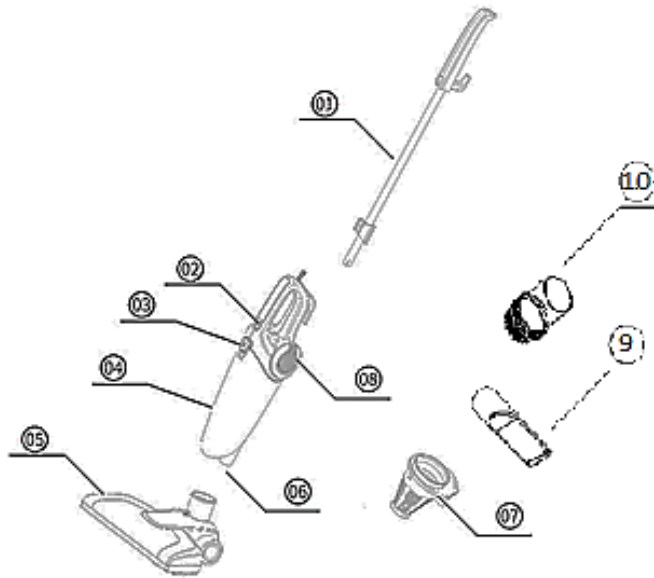

1. Hand shank
2. Switch
3. Dust bin release switch
4. Dust bin
5. Floor Brush
6. Air inlet
7. HEPA filter
8. Air outlet
9. Flat suction nozzle
10. Round brush head

## ASSEMBLY GUIDE:

Please do not plug into mains during assembly.

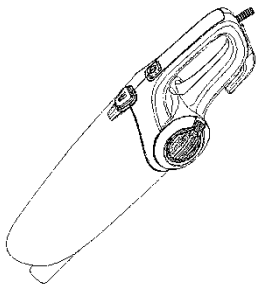

1. Put HEPA filter into the dust bin.
2. Put the Dust bin into the main machine.

**COOPERS  
OF STORTFORD**

UK Head Office, 11 Bridge Street, Bishop's Stortford, CM23 2JU

Tel: 0844 4824400\*, Fax: 01279 756595

[www.coopersofstortford.co.uk](http://www.coopersofstortford.co.uk)

EU address: D.S.B. LD, 160 Bd. de Fourmies, 59100 Roubaix, France

Tel: (+44) 1279 701269

\*UK Calls cost around 7 pence per minute plus your telephone company's network access.  
Please check with your telephone supplier.

# Burgundy 2in1 Vacuum 600W J038 Instructions for Use

Please read and retain these instructions for future reference

v003:02/11/22

3. Insert the extend tube into the main machine

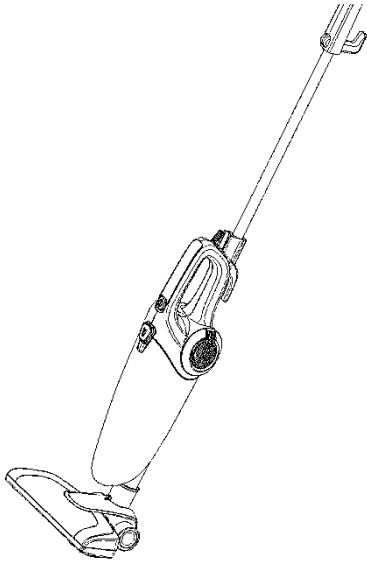

## Assembly Tips:

Stand the vacuum on its end then add the handle and clip into place.

The clip is next to the electric cable. It is tight to get the clip to click in place. Move the handle slightly from left to right and put pressure on the clip and wait for it to click.

Another way of putting the clip in place is to put your thumb on the clip which is shown in photo 1 and push down and push the handle toward the vacuum part and at the same time move the clip very slightly left and right and it will click in place shown in photo 2.



4. Insert the floor brush into the extend tube

**5. Regularly clean and empty the filter and inside of the vacuum of all dust/grit to avoid risk of overheating.**

## HOW TO CLEAN:

1. Push the dust bin lip release button and empty the bin.
2. Push the dust bin release button and remove the dust bin from the main machine.
3. Remove the HEPA filter from the dust bin. Clean the dust bin and HEPA filter.

**Please read this instruction manual thoroughly before starting and ensure you are familiar with the operation of your new 2in1 vacuum.**

**COOPERS  
OF STORTFORD**

UK Head Office, 11 Bridge Street, Bishop's Stortford, CM23 2JU

Tel: 0844 4824400\*, Fax: 01279 756595

[www.coopersofstortford.co.uk](http://www.coopersofstortford.co.uk)

EU address: D.S.B. LD, 160 Bd. de Fourmies, 59100 Roubaix, France

Tel: (+44) 1279 701269

\*UK Calls cost around 7 pence per minute plus your telephone company's network access.  
Please check with your telephone supplier.

# Burgundy 2in1 Vacuum 600W J038 Instructions for Use

Please read and retain these instructions for future reference

v003:02/11/22

## CAUTION:

- **DO NOT PULL THE APPLIANCE BY THE POWER CABLE.**
- **DO NOT USE TO VACUUM HOT ASHES.**
- **DO NOT USE TO VACUUM LIQUIDS.**
- **DO NOT USE TO VACUUM SHARP OBJECTS.**
- **ALWAYS CHECK THE DUST CUP FILTER REGULARLY AND EMPTY AND CLEAN WHEN FULL. WE SUGGEST AT LEAST A WEEKLY CHECK.**

## TROUBLESHOOTING:

Not enough suction	1. Filter system blocked 2. Parts connection	1. Clean dust cup 2. Re-assemble parts ensuring connections are tight
--------------------	---	--

## WARNINGS AND SAFETY INSTRUCTIONS:

WHEN USING ELECTRICAL APPLIANCES, BASIC SAFETY PRECAUTIONS SHOULD ALWAYS BE FOLLOWED:

- READ ALL INSTRUCTIONS BEFORE USE.
- FOR DOMESTIC INDOOR USE ONLY.
- DO NOT USE OUTDOORS OR FOR COMMERCIAL USE.
- BEFORE USE, CHECK THOROUGHLY FOR ANY DEFECTS AND DO NOT USE IF DEFECTS ARE FOUND. TAKE CARE NOT TO DROP THE APPLIANCE AS HEAVY IMPACTS MAY CAUSE INTERNAL DAMAGE.
- BEFORE CONNECTING THE APPLIANCE, CHECK IF THE VOLTAGE INDICATED ON THE BOTTOM OF THE APPLIANCE IS IN ACCORDANCE WITH THE MAINS VOLTAGE IN YOUR HOME.
- CHECK THE APPLIANCE AND POWER CABLE CAREFULLY FOR DAMAGE BEFORE EACH USE.
- THIS APPLIANCE CAN BE USED BY CHILDREN AGED FROM 8 YEARS AND ABOVE AND PERSONS WITH REDUCED PHYSICAL, SENSORY OR MENTAL CAPABILITIES OR LACK OF EXPERIENCE AND KNOWLEDGE IF THEY HAVE BEEN GIVEN SUPERVISION OR INSTRUCTION CONCERNING USE OF THE APPLIANCE IN A SAFE WAY AND UNDERSTAND THE HAZARDS INVOLVED. CHILDREN SHALL NOT PLAY WITH THE APPLIANCE. CLEANING AND USER MAINTENANCE SHALL NOT BE MADE BY CHILDREN WITHOUT SUPERVISION.
- CHILDREN OF LESS THAN 3 YEARS SHOULD BE KEPT AWAY UNLESS CONTINUOUSLY SUPERVISED.
- **SOME PARTS OF THIS PRODUCT CAN BECOME VERY HOT AND CAUSE BURNS. PARTICULAR ATTENTION HAS TO BE GIVEN WHERE CHILDREN AND VULNERABLE PEOPLE ARE PRESENT.**

**COOPERS**  
OF STORTFORD

UK Head Office, 11 Bridge Street, Bishop's Stortford, CM23 2JU

Tel: 0844 4824400\*, Fax: 01279 756595

[www.coopersofstortford.co.uk](http://www.coopersofstortford.co.uk)

EU address: D.S.B. LD, 160 Bd. de Fourmies, 59100 Roubaix, France

Tel: (+44) 1279 701269

\*UK Calls cost around 7 pence per minute plus your telephone company's network access.  
Please check with your telephone supplier.

# Burgundy 2in1 Vacuum 600W J038 Instructions for Use

Please read and retain these instructions for future reference

v003:02/11/22

- THE USE OF ANY ACCESSORY ATTACHMENTS NOT RECOMMENDED BY COOPERS OF STORTFORD MAY CAUSE INJURIES AND INVALIDATE ANY WARRANTY YOU MAY HAVE.
- DO NOT COVER THE ITEM IN ANY WAY WHEN IN USE AS THIS MAY CAUSE OVERHEATING.
- DO NOT USE THIS APPLIANCE FOR ANY OTHER USE THAN THE INTENDED USE IT IS DESIGNED FOR.
- TO PROTECT AGAINST ELECTRIC SHOCK, DO NOT IMMERSE POWER CABLE, PLUG OR APPLIANCE, IN WATER OR ANY OTHER LIQUID.
- UNPLUG FROM OUTLET WHEN NOT IN USE AND BEFORE CLEANING.
- DO NOT OPERATE ANY APPLIANCE WITH A DAMAGED POWER CABLE OR PLUG OR AFTER THE APPLIANCE MALFUNCTIONS, OR HAS BEEN DAMAGED IN ANY MANNER. WE RECOMMEND THAT THE POWER CABLE IS NOT KINKED OR STORED IN A TWISTED MANNER, AND THAT YOU REGULARLY CHECK ITS CONDITION.
- ANY REPAIRS MUST BE CONDUCTED BY A QUALIFIED ELECTRICIAN OR ELECTRICAL SERVICE AGENT.

## PLUG WIRING (UK & IRELAND)

This appliance is fitted with a moulded BS 1363 13-amp plug. If you have to replace the fuse, only those that are ASTA or BSI approved to BS1362 and with a rated current of 13-amperes should be used.

If there is a fuse cover fitted, this cover must be re-fitted after changing the fuse. If the fuse cover is lost or damaged the plug must not be used. Spare fuse holders and fuses are available from electrical outlets. If the socket outlets in your home or office are not suitable for this product's plug, the plug must be removed and disposed of safely. Attempts to insert the plug into the wrong socket is likely to cause electric hazard.

## CARE AND CLEANING INSTRUCTIONS:

- Always switch off and unplug before cleaning.
- Do NOT immerse in water. Risk of electric shock.
- Do NOT use abrasive cleaners or sharp utensils to clean this appliance.
- Wipe surfaces with a soft dry cloth.
- **Regularly clean and empty the filter of dust/grit to avoid overheating.**
- Allow to dry thoroughly before further use.
- Store the appliance in a cool, dry place.

## DISPOSAL

- Coopers of Stortford use recyclable or recycled packaging where possible.
- Please dispose of all packaging, paper, cartons, packaging in accordance with your local recycling regulations.
- Plastics, polybags – Contains the following recyclable plastic.



**COOPERS**  
OF STORTFORD

UK Head Office, 11 Bridge Street, Bishop's Stortford, CM23 2JU

Tel: 0844 4824400\*, Fax: 01279 756595

[www.coopersofstortford.co.uk](http://www.coopersofstortford.co.uk)

EU address: D.S.B. LD, 160 Bd. de Fourmies, 59100 Roubaix, France



Tel: (+44) 1279 701269

\*UK Calls cost around 7 pence per minute plus your telephone company's network access.  
Please check with your telephone supplier.

# Burgundy 2in1 Vacuum 600W J038 Instructions for Use

Please read and retain these instructions for future reference

v003:02/11/22

Code & Symbol		
Type of Plastic	Polypropylene	Please Specify (includes ABS, Nylon)
Commonly used for	Microwaveable food containers, yoghurt pots, butter tubs, disposable plates and cups	CD's, crisp packets, various flexible packaging, baby bottles, sunglass lenses
Notes	Commonly recycled and collected from household recycling bins (packaging tape itself not recyclable but does not interfere with cardboard)	Not often or widely recycled

- At the end of the product's lifespan please check with your local council authorised household waste recycling centre for disposal.



**COOPERS  
OF STORTFORD**

UK Head Office, 11 Bridge Street, Bishop's Stortford, CM23 2JU

Tel: 0844 4824400\*, Fax: 01279 756595

[www.coopersofstortford.co.uk](http://www.coopersofstortford.co.uk)

EU address: D.S.B. LD, 160 Bd. de Fourmies, 59100 Roubaix, France

Tel: (+44) 1279 701269

\*UK Calls cost around 7 pence per minute plus your telephone company's network access.  
Please check with your telephone supplier.