

# All Weather Privacy Screen G483

# Instructions for Use

Please read and retain these instructions for future reference

v001: 19/03/20

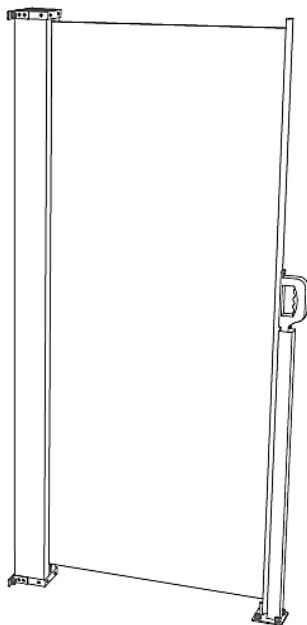

## Dimensions

160cm (H) x300cm (W) (when fully retracted)

## Composition

Aluminium roller, galvanized steel bar & 180GM2 Polyester Screen

Wall fixings included

## Features

- PROTECTS AGAINST BREEZES AND PROVIDES UV 50+ SUN PROTECTION
- DURABLE THANKS TO THE ALUMINIUM ROLLER & GALVANISED STEEL BAR
- WATERPROOF WITH ITS 180GM2 100% POLYESTER WITH PU SCREEN
- EASILY RETRACTABLE SO WHEN ITS NOT IN USE IT GOES BACK INTO ITS WALL MOUNTING BASE
- JUST ATTACH THE STEEL BAR TO THE SIDE OF YOUR HOUSE AND AWAY YOU GO, TO USE JUST SLIDE OUT THE SCREEN USING THE HANDLE AND CLICK DOWN INTO PLACE
- IDEAL FOR WHEN DINING OUTSIDE OR JUST RELAXING IN THE GARDEN

\*Calls cost 7 pence per minute plus your telephone company's network access charge

Head Office, 11 Bridge Street,  
Bishop's Stortford CM23 2JU  
Tel: 0844 482 4400\*  
Fax: 01279 756 595  
[www.coopersofstortford.co.uk](http://www.coopersofstortford.co.uk)

**Coopers**  
OF STORTFORD



## SAFETY INSTRUCTIONS

**Warning:** For your own and the safety of other persons it is important to read and follow below instructions and obey the warnings. Keep the instruction manual in a safe place for future reference.

1. Children should be supervised to ensure that they do not play with the awning.
2. Check the assembly of the awning on a regular basis for stability and signs of wear or damage to parts. Do not use the appliance when repair or adjustment is necessary.
3. Do not use the awning when maintenance is being performed.
4. Technical knowledge is required to assemble the awning. Do not attempt to do the assembly by yourself but contact a qualified workman for help in the following situations.
  - you are unsure if the awning can be mounted on the place you have chosen for installation
  - you do not understand the instruction manual or some parts of it
  - necessary assembling tools are not available
  - you do not have necessary technical knowledge
5. Do not attempt to assemble the awning if any parts are missing or damaged. In this case please contact our customer service.
6. Keep children and pets out of work area during assembly and adjustment.
7. The awning and its fixing parts are only suitable for installation on a plain cement wall. If a wall shows cracks, you have to consult a qualified specialist.
8. Please make sure that your hands are clean at the time of assembly, otherwise you may dirty the awning fabric and frame.
9. The operation in frosty conditions may damage the awning.
10. Check the load-bearing capacity of the mounting base before assembly and if necessary, take corresponding measures to ensure stable installation of the brackets. Otherwise, the awning might not be stable, especially in windy, rainy, or snowy conditions.
11. Retract the fabric manually instead of rebounding it automatically by spring.
12. Withdraw the awning and store it in a dry place when it is not in use for a long time, such as in winter.
13. The awning should be kept away from fire and inflammable objects.
14. Please ensure safe and proper disposal of the awning and accessories to avoid harm.



Not for use in frosty conditions. The operation in frosty conditions may damage the awning.



Do not apply excessive force to the handle.

# All Weather Privacy Screen G483

# Instructions for Use

Please read and retain these instructions for future reference

v001: 19/03/20



Do not use during storms or high winds.

## Parts

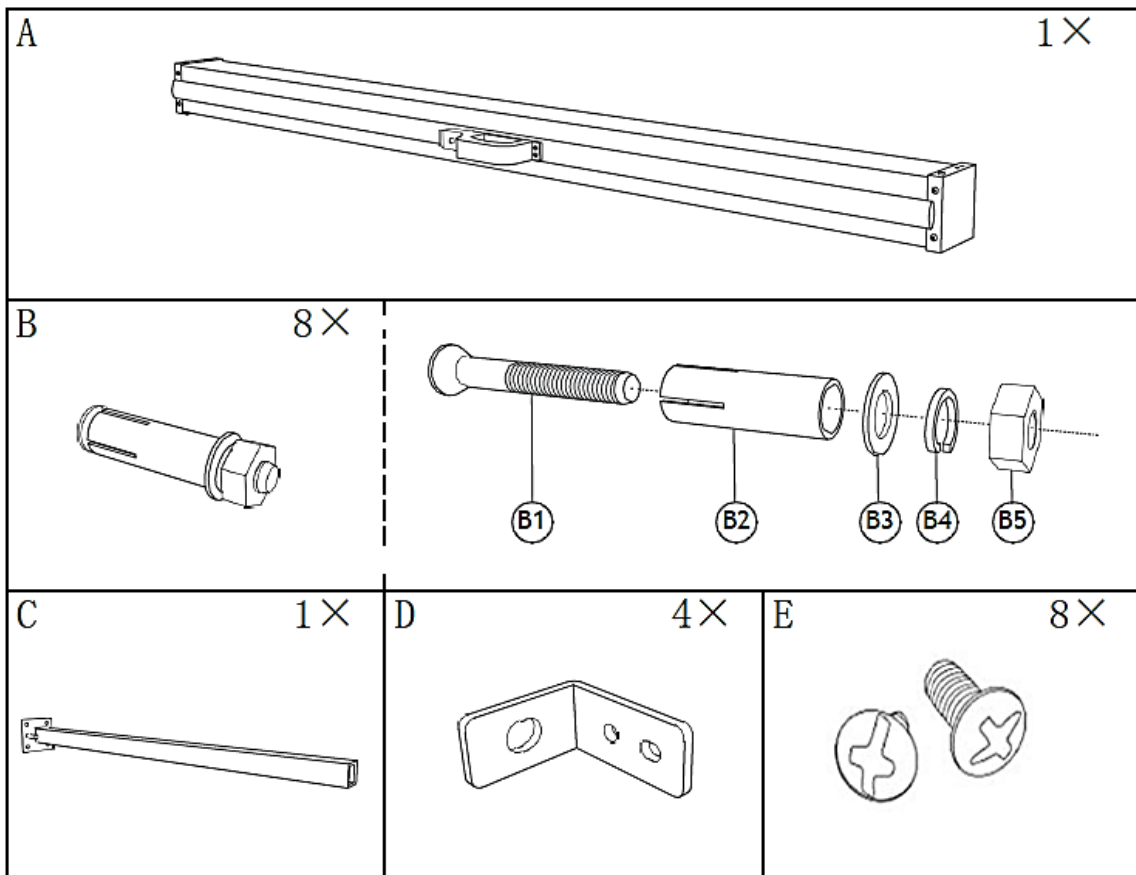

\*Calls cost 7 pence per minute plus your telephone company's network access charge

Head Office, 11 Bridge Street,  
Bishop's Stortford CM23 2JU  
Tel: 0844 482 4400\*  
Fax: 01279 756 595  
[www.coopersofstortford.co.uk](http://www.coopersofstortford.co.uk)

**Coopers**  
OF STORTFORD

# All Weather Privacy Screen G483

# Instructions for Use

Please read and retain these instructions for future reference

v001: 19/03/20

## Assembly

1

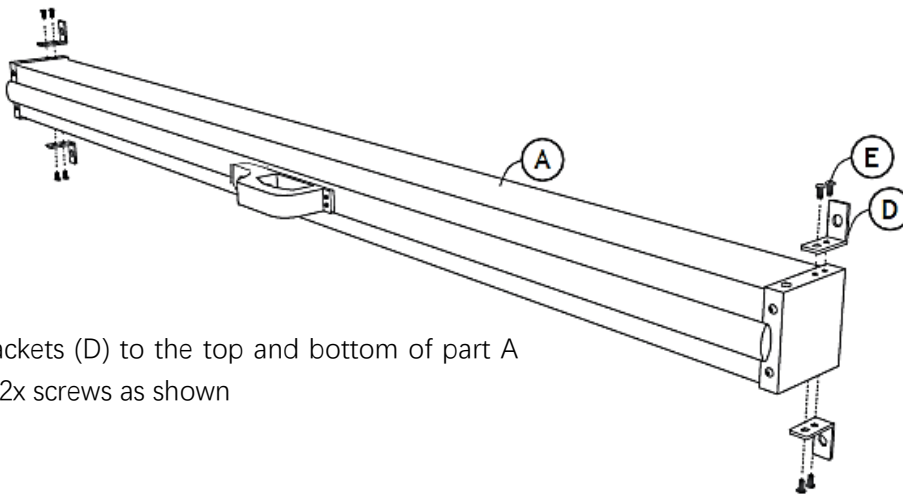

Fit brackets (D) to the top and bottom of part A using 2x screws as shown

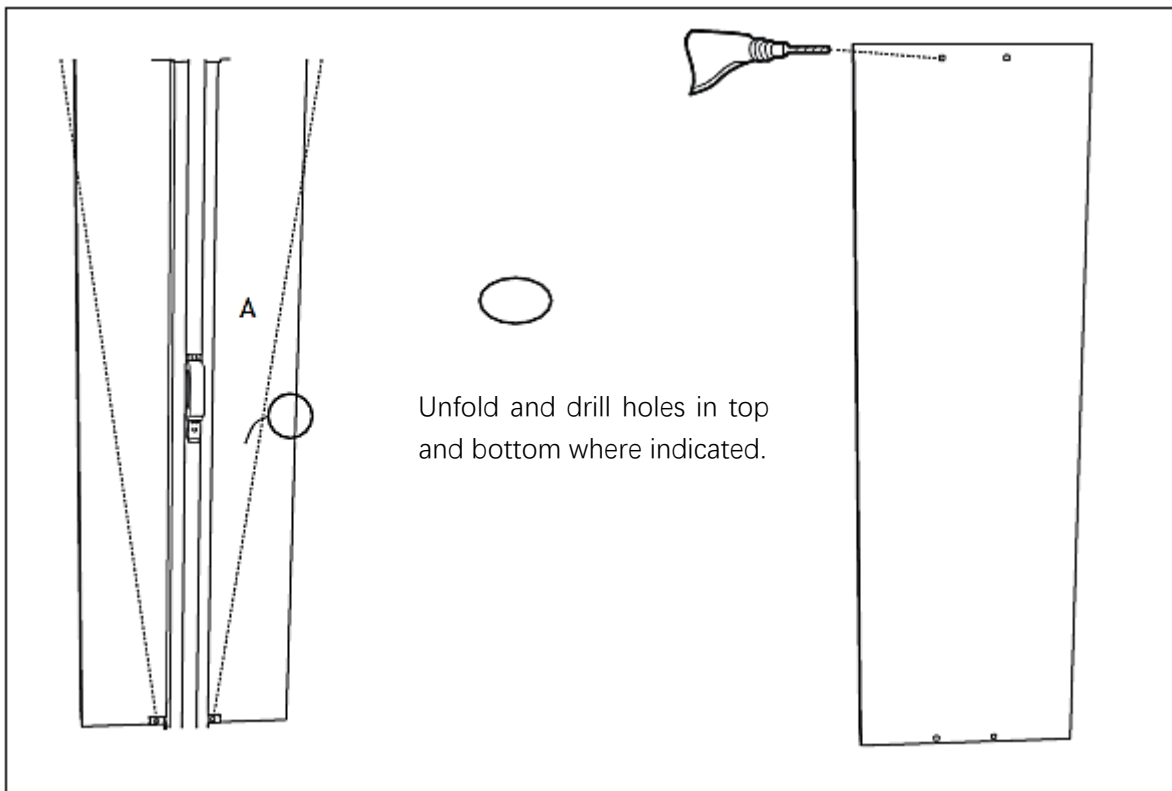

\*Calls cost 7 pence per minute plus your telephone company's network access charge

Head Office, 11 Bridge Street,  
Bishop's Stortford CM23 2JU  
Tel: 0844 482 4400\*  
Fax: 01279 756 595  
[www.coopersofstortford.co.uk](http://www.coopersofstortford.co.uk)

**Coopers**  
OF STORTFORD

# All Weather Privacy Screen G483

# Instructions for Use

Please read and retain these instructions for future reference

v001: 19/03/20

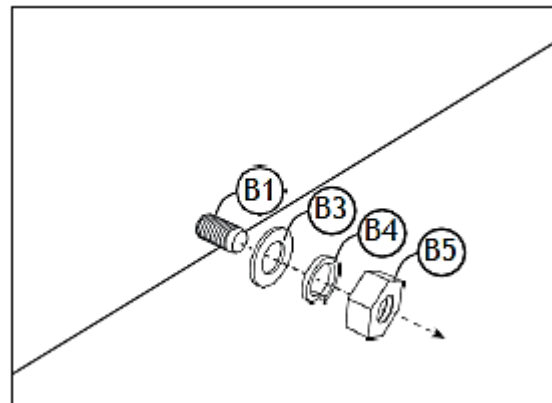
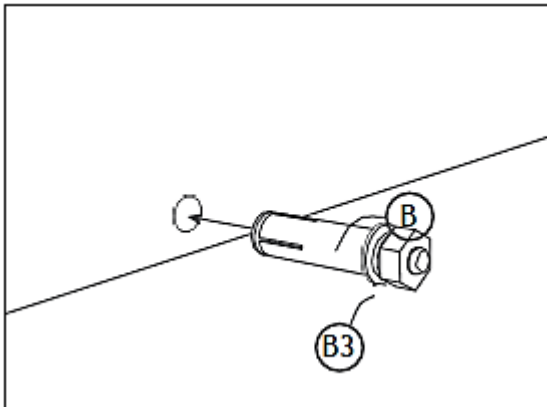

Fit part B (as detailed) through the drilled holes.

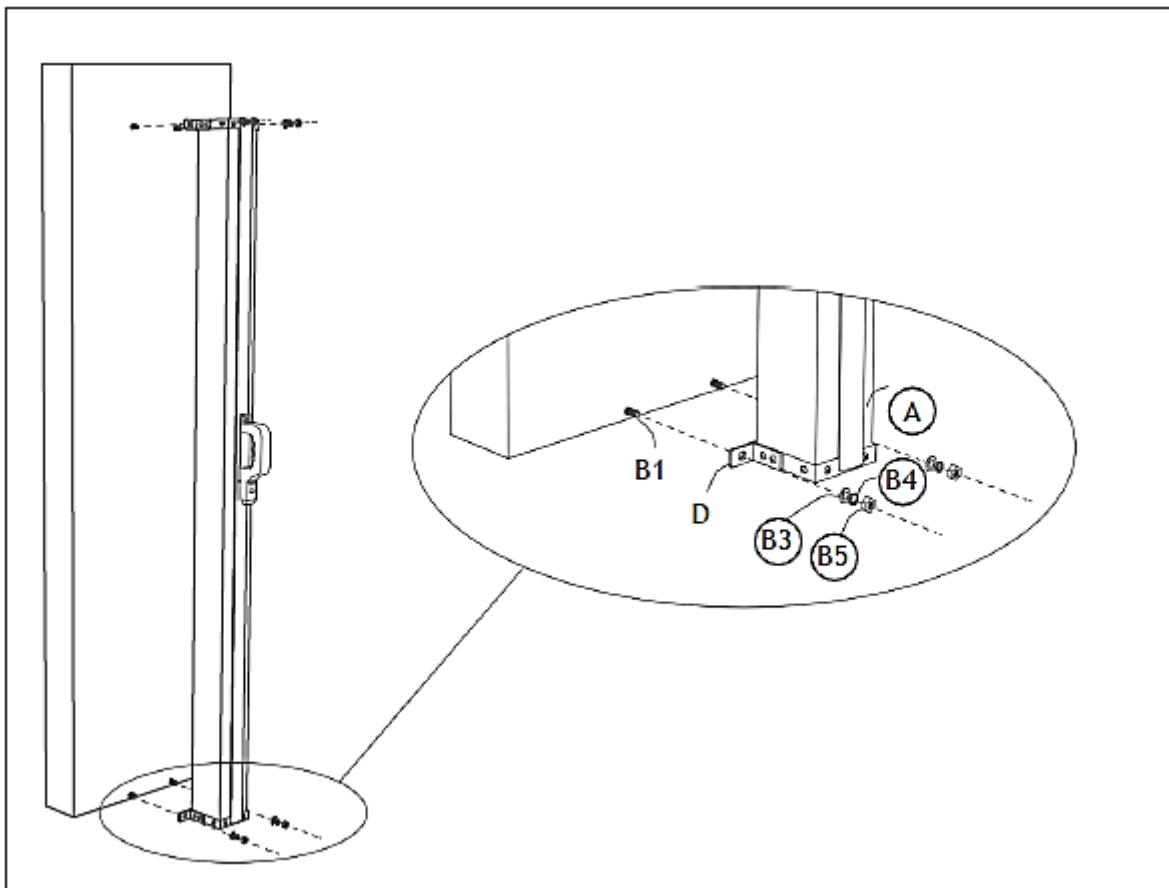

\*Calls cost 7 pence per minute plus your telephone company's network access charge

Head Office, 11 Bridge Street,  
Bishop's Stortford CM23 2JU  
Tel: 0844 482 4400\*  
Fax: 01279 756 595  
[www.coopersofstortford.co.uk](http://www.coopersofstortford.co.uk)

**Coopers**  
OF STORTFORD

# All Weather Privacy Screen G483

# Instructions for Use

Please read and retain these instructions for future reference

v001: 19/03/20

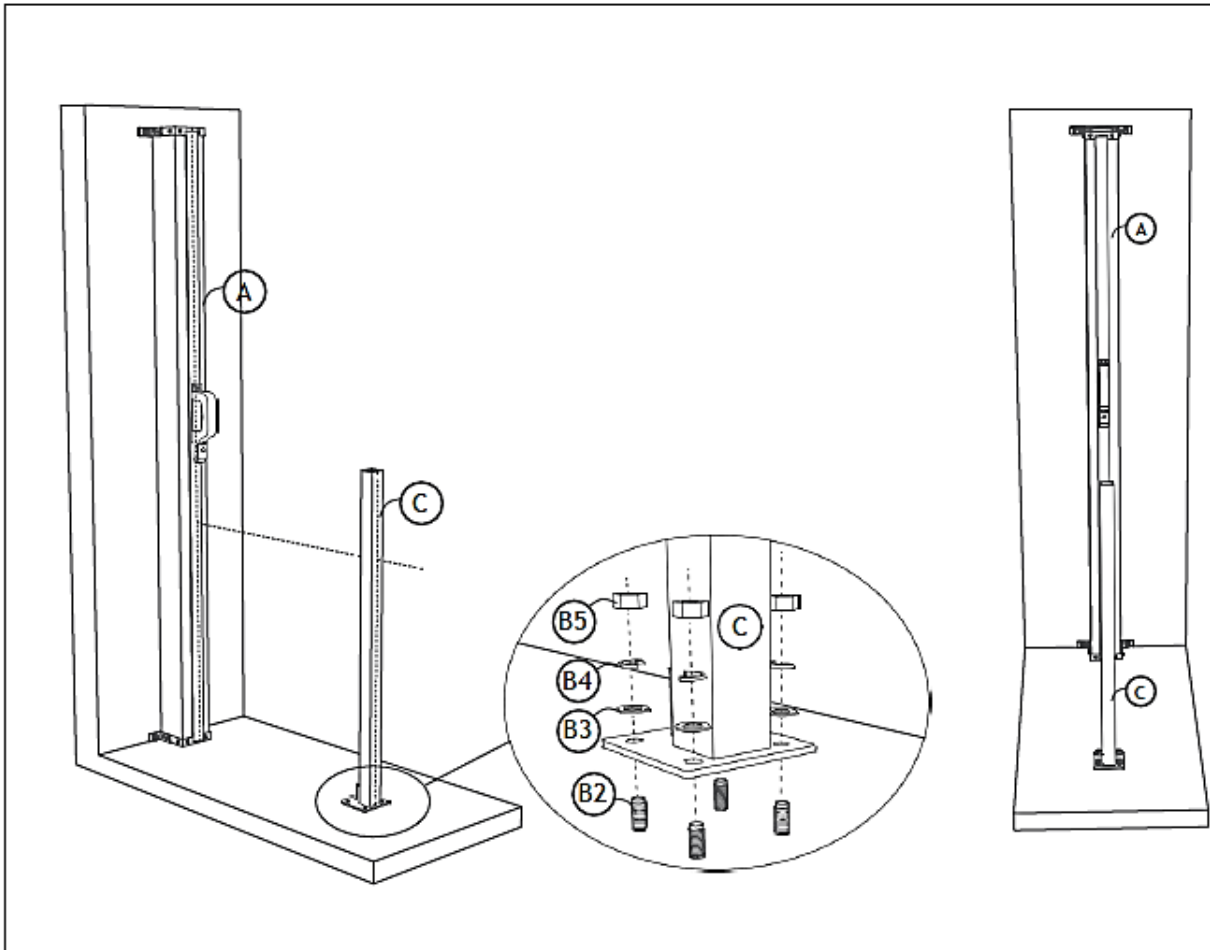

\*Calls cost 7 pence per minute plus your telephone company's network access charge

Head Office, 11 Bridge Street,  
Bishop's Stortford CM23 2JU  
Tel: 0844 482 4400\*  
Fax: 01279 756 595  
[www.coopersofstortford.co.uk](http://www.coopersofstortford.co.uk)

**Coopers**  
OF STORTFORD

# All Weather Privacy Screen G483

Please read and retain these instructions for future reference

# Instructions for Use

v001: 19/03/20

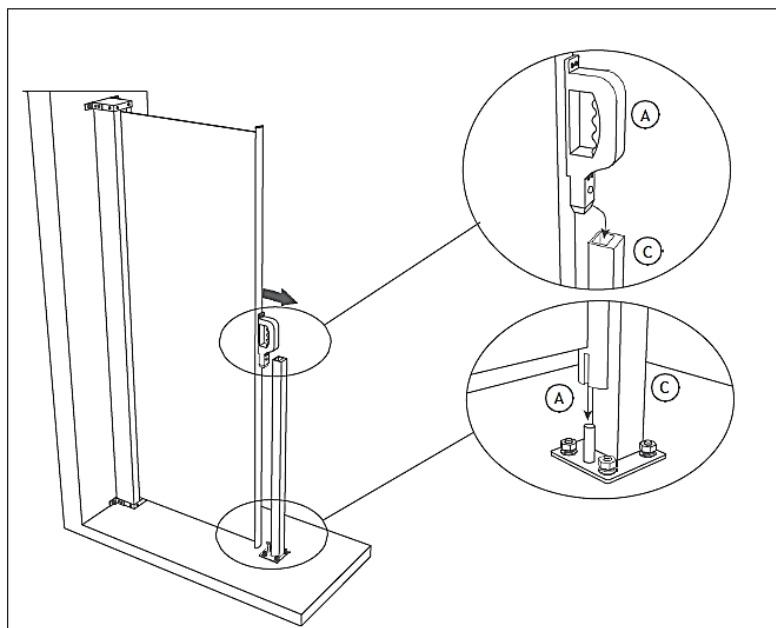

## Cleaning and Maintenance

- Hand wash only
- Do not bleach
- Hang to dry
- Do not tumble dry
- Iron on Medium
- Do not dry clean
- Store away safely in a dry location.
- Wipe clean before and after use.

## DISPOSAL

- Dispose of all packaging, paper, cartons, plastic and plastic bags in accordance with your local recycling regulations.
- This contains the following plastic. Polyester screen.
- At the end of the product's lifespan please dispose of it at an authorised household waste recycling centre.



\*Calls cost 7 pence per minute plus your telephone company's network access charge

Head Office, 11 Bridge Street,  
Bishop's Stortford CM23 2JU  
Tel: 0844 482 4400\*  
Fax: 01279 756 595  
[www.coopersofstortford.co.uk](http://www.coopersofstortford.co.uk)

**Coopers**  
OF STORTFORD