

3PC Plastic Rattan Furniture Set G538 Instructions for Use

Please read and retain these instructions for future reference

v002: 17/03/21

Parts (Chairs)

1 PC

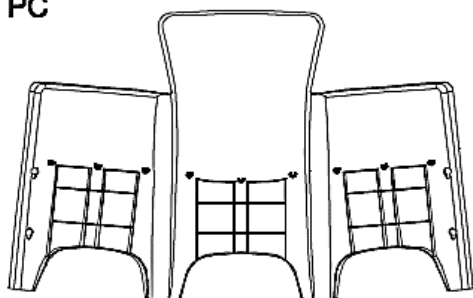

1 PC

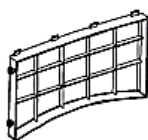

1 PC

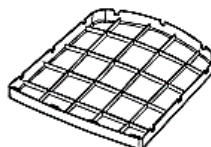

Chair Dimensions:
57 x 55 x 86 CMS

Chair Max load:
160Kg

**IMPORTANT! PLEASE READ AND RETAIN THESE INSTRUCTIONS FOR FUTURE REFERENCE.
FOR DOMESTIC USE ONLY**

3 piece garden furniture set made up of 2 chairs with a high back and arms and a table.

- Made from durable plastic that looks just like rattan but you don't have to worry about leaving this out all year round!
- Lightweight so you can move to the best spot in your garden with ease
- If you did want to store it away its easy as you can taken them apart and they go completely flat, perfect if you only have a small shed or garage
- Comes complete with 2 cream cushions.

WARNING:

- Peg and slot assembly.
- Ensure pegs are properly inserted and seated. Tap firmly into position. Do not use a hammer or force parts together.
- Use on a flat surface.
- Take care when opening or folding up: risk of finger entrapment.

CHAIR ASSEMBLY:

Step 1

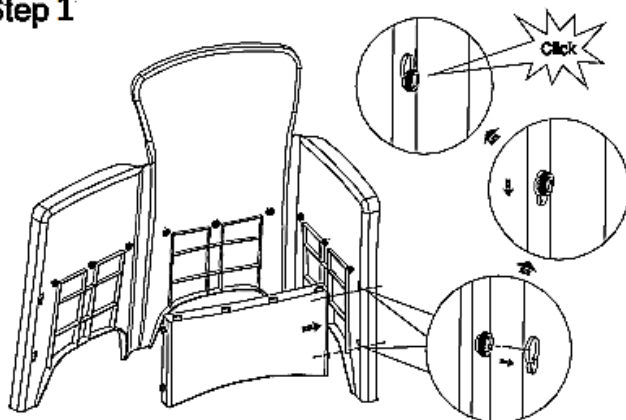

Fold side panels in by 90° and connect with front panel.
Align pegs with slots.
Insert pegs into slots and push down until it clicks and locks in place.
Do not use hammer.
Repeat on the other side.

*Calls cost 7 pence per minute plus your telephone company's network access charge

Head Office, 11 Bridge Street,
Bishop's Stortford CM23 2JU
Tel: 0844 482 4400*
Fax: 01279 756 595
www.coopersofstortford.co.uk

Coopers
OF STORTFORD

3PC Plastic Rattan Furniture Set G538 Instructions for Use

Please read and retain these instructions for future reference

v002: 17/03/21

Step 2

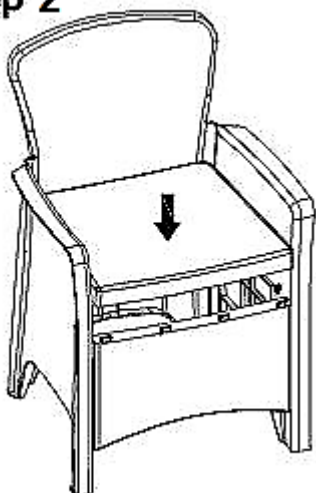

Place seat pad on top.
Align pegs with slots.

Step 3

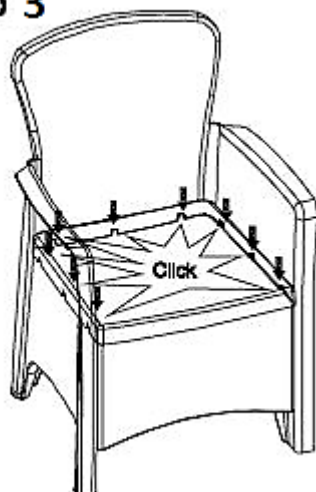

Tap firmly into position where indicated until pieces click together.

TABLE ASSEMBLY

Parts (Table)

1 PC

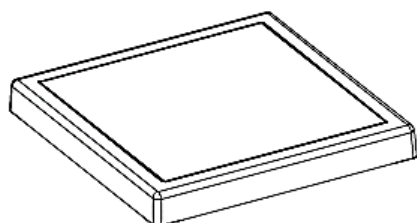

4 PCS

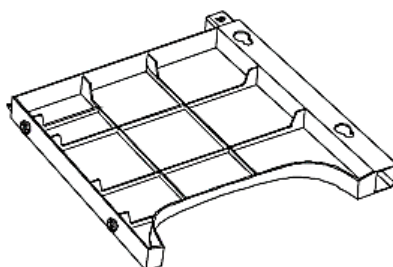

Table Dimensions:
39 x 39 x 39 CMS.,

Table Max load: 20 Kg

**Not designed for
sitting on.**

*Calls cost 7 pence per minute plus your
telephone company's network access charge

Head Office, 11 Bridge Street,
Bishop's Stortford CM23 2JU
Tel: 0844 482 4400*
Fax: 01279 756 595
www.coopersofstortford.co.uk

Coopers
OF STORTFORD

3PC Plastic Rattan Furniture Set G538 Instructions for Use

Please read and retain these instructions for future reference

v002: 17/03/21

Step 1.

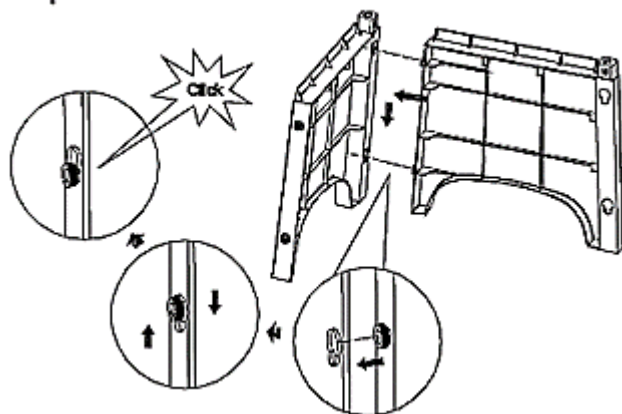

Align pegs with slots, insert pegs into slots and push down until it clicks and locks.

Repeat until all side panels are connected.

Step 2

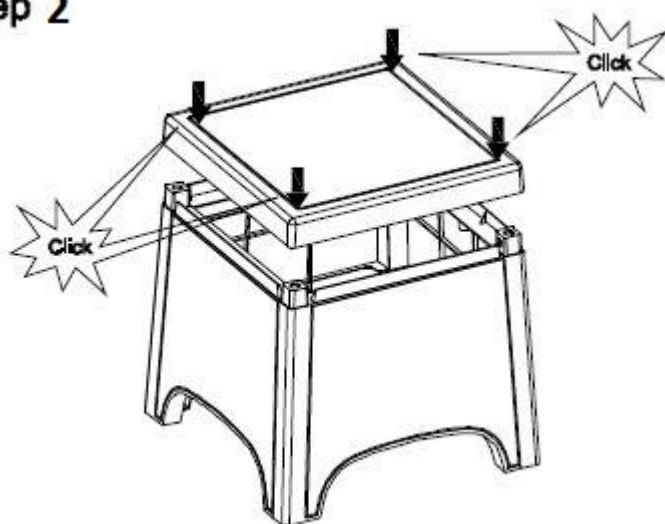

Align pegs with slots, insert pegs into slots and push down where indicated until it clicks and locks.

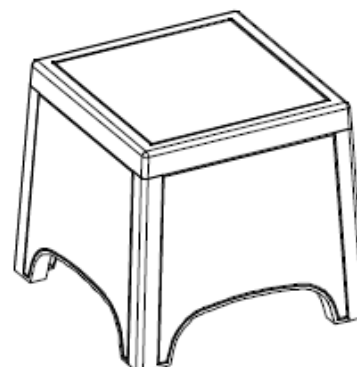

MAINTENANCE & CLEANING INSTRUCTIONS:

- Check all fixings, pegs are secure, and all parts are firmly on place before each use.
- Hand push until secure. Do not use a hammer,
- Protect from adverse weather.
- Gently wipe clean with a damp cloth.
- Store in a dry place.
- Do not store when wet.

DISPOSAL:

- Dispose of all packaging, paper, cartons and plastic, plastic bags in accordance with your local recycling regulations.

*Calls cost 7 pence per minute plus your telephone company's network access charge

Head Office, 11 Bridge Street,
Bishop's Stortford CM23 2JU
Tel: 0844 482 4400*
Fax: 01279 756 595
www.coopersofstortford.co.uk

Coopers
OF STORTFORD

3PC Plastic Rattan Furniture Set G538 Instructions for Use

Please read and retain these instructions for future reference

v002: 17/03/21

- At the end of the product's lifespan please dispose of it at an authorised household waste recycling centre.

*Calls cost 7 pence per minute plus your
telephone company's network access charge

Head Office, 11 Bridge Street,
Bishop's Stortford CM23 2JU
Tel: 0844 482 4400*
Fax: 01279 756 595
www.coopersofstortford.co.uk

Coopers
OF STORTFORD