



Dimensions

11cm x10cm x16.5cm

- TOTALLY WIRELESS AS BATTERY OPERATED
- BUILT IN MOTION SENSOR THAT DETECTS MOTION UP TO 5M AWAY WITH A 360 DEGREE ANGLE AND WHEN IT DOES IT LIGHTS UP A POWERFUL 250 LUMENS THROUGH ITS 2 SPOTLIGHTS TO ALERT YOU OR JUST TO HELP YOU SAY WHEN YOU GET HOME!
- WEATHERPROOF AND DURABLE FOR LONG LASTING SECURITY THROUGHOUT THE YEAR
- AUTO ON/OFF AFTER 20 SECONDS
- SWIVELLING HEAD THAT ROTATES UP & DOWN 360 DEGREES
- POWER 6 WATTS
- USES 4XD BATTERIES (Not included)

Accessories

3 screws and 3 anchors

Warning

- Use only new alkaline D-Cell batteries with 1.5V rating. Do not mix old and new batteries. If batteries are not new, it may cause the light to malfunction.
- Install batteries with polarity in correct position.
- If your spotlight will not turn off, that means it is time to replace the batteries.

ASSEMBLY INSTRUCTIONS / INSTRUCTIONS FOR USE:

Unpack the components carefully. Please check all parts have been removed from the packaging.

Before you mount your spotlight

Illustration 1

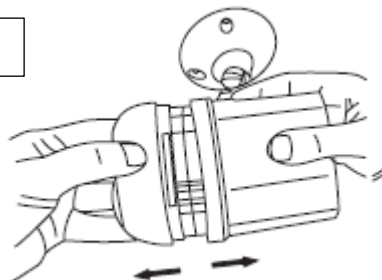
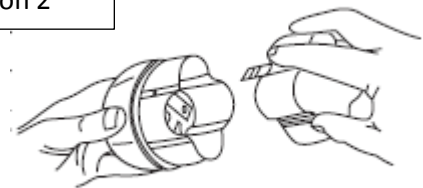


Illustration 2

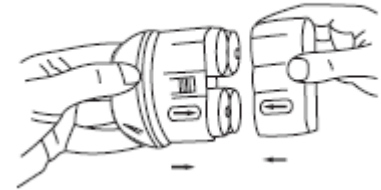


1. Remove front cover of spotlight by rotating counter-clockwise as shown in Illustration 1. Pull face out from cup to reveal attached battery holder. Separate two parts by squeezing tabs and pulling apart (Illustration 2).

Illustration 3

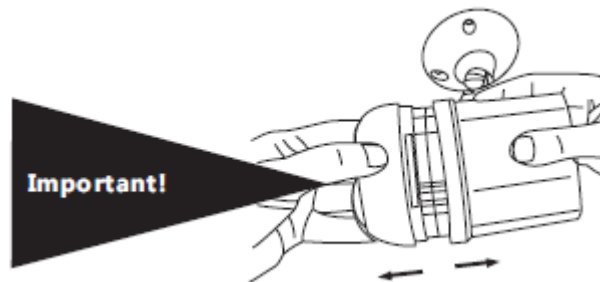


Illustration 4



2. Insert 4 D-Cell batteries into Night Rhino as shown in illustration 3. Attach battery holder by aligning the grooves on the side and snapping both sides' tow tabs on the inside of the holder (illustration 4).

Illustration 5



3. Align grooves and arrow to insert battery holder (illustration 5). **Turn front cover clockwise as far as it will go. Make sure unit is securely closed with arrow pointing at the lock symbol to ensure weatherproof seal is tight.** Not fully tightening those two parts may allow water leaks.

Note:

Light sensor only allows Night Rhino to activate in darkness. We recommend testing in a dark room or closet. When your Night Rhino will not turn off, that means it is time to replace the batteries.

Mounting your spotlight

Illustration 6

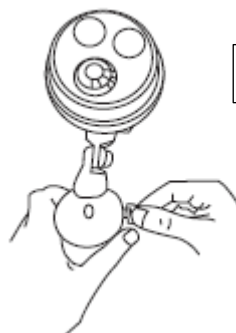


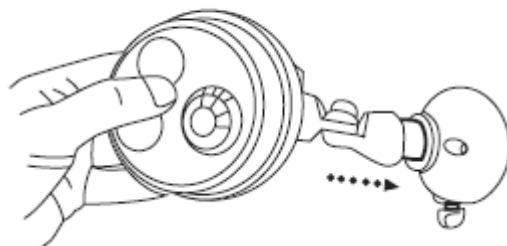
Illustration 7



Remove mounting base by turning thumbscrew counter-clockwise as shown in illustration 6. Pull mounting base off stem of light.

Drive three screws into three holes to mount the mounting base (illustration 7). For best results, drill pilot first and insert anchors.

Illustration 8

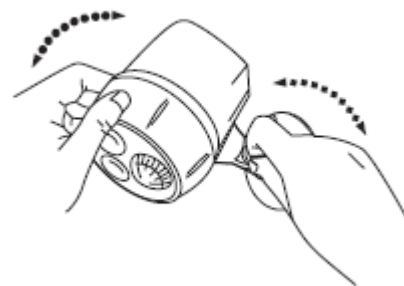


Insert spot light back into mounting base pointed in the desired direction as shown in illustration 8.

Illustration 9



Illustration 10



To pivot spotlight up and down, loosen larger thumbscrew in the joint of the spotlight stem and adjust spotlight head to proper direction as shown in illustration 9 and 10. Tighten thumbscrew.

CARE AND CLEANING INSTRUCTIONS:

- Always switch off and remove batteries when not in use.
- Do not shine light directly towards eyes.
- Do NOT immerse in water.
- Do NOT use abrasive cleaners or sharp utensils to clean this appliance.
- Wipe with a clean dry cloth.



BATTERIES

- Keep batteries away from children and pets.
- Do not mix used and new batteries.
- Install batteries in accordance with its polarity symbols.
- Remove the batteries if left for long periods.
- Never dispose of batteries in a fire.
- Battery disposal, spent or expired batteries must be properly disposed of and recycled in compliance with local regulations. For detailed information, contact your local authority.
- Follow the battery manufacturer's safety, usage, and disposal instructions.

DISPOSAL

- Coopers of Stortford use recyclable or recycled packaging where possible.
- Please dispose of all packaging, paper, cartons, packaging in accordance with your local recycling regulations.
- Plastics, polybags – The product is made from the following recyclable plastic.



Code & Symbol	 LDPE (bag)	 OTHER (product)
Type of Plastic	Low Density Polyethylene	Please Specify (includes ABS, Nylon)
Commonly used for	Shopping bags, bread bags, squeeze bottles, stretch/pallet wrap, bubble wrap, multi-pack can holders	CD's, crisp packets, various flexible packaging, baby bottles, sunglass lenses
Notes	Usually recyclable supermarket deposit points. Check other plastic films as any non-polythene film e.g. cling film, crisp packets film lids	Not often or widely recycled

- At the end of the product's lifespan please check with your local council authorised household waste recycling centre for disposal.

