

Dimensions

11.5cm (L)

Composition

Steel and Zinc Metal

- 2 IN 1 BOLT
- EASIER TO USE THAN A REGULAR PADLOCK
- BUILT IN LOCK
- WITH STRONG SOLID STEEL BOLT 11.5CM LONG ZINC ALLOW CASING
- 4 DIGIT COMBINATION LOCK WITH LARGE DIGITS WHICH YOU CAN CHOOSE YOURSELF
- PERFECT FOR GARAGES, SHEDS, EXTERNAL STORAGE ETC
- SIMPLE INSTALLATION WITH ALL SCREWS INCLUDED



ASSEMBLY INSTRUCTIONS / INSTRUCTIONS FOR USE:

Unpack the components carefully. Please check all parts have been removed from the packaging.

TO OPEN

Rotate all 4 dials to the pre-set combination along the centre line. The pre-set factory combination is 0-0-0-0.

Set your own combination

- On the end of the locking bolt, fully depress the small silver button.
- Whilst holding in the pin, rotate the 4 dials to your desired code. Ensure the numbers are positioned centrally and have clicked into position.
- Release the pin to the original position.
- Memorize and record the new combination for future reference.
- The new code is now set.

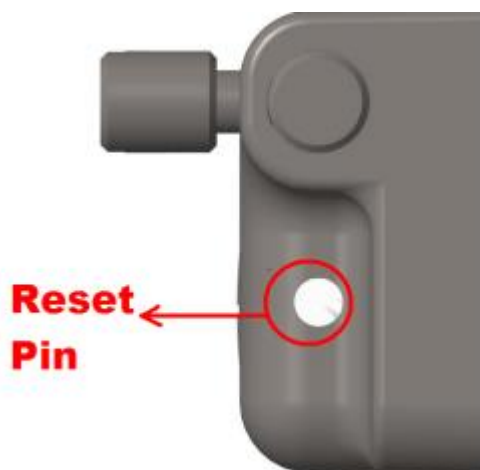

TO LOCK

- The combination must be scrambled by rotating the 4 dials.

TO FIT

It is important to drill a small pilot hole for the screws as they cannot be unscrewed once used.

- Hold the slide bolt in the required position and check the slide bolt and the gate /door will function correctly. Once positioned correctly, mark the location of the 4 screw holes.
- The slide bolt should be mounted using all 4 corner fixing holes on the back plate. Drill a small Pilot hole for the screws. Screws should be tight without distorting the back plate.

- Hold in the required position and check the slide bolt and the gate/door will open and close correctly. Mark the location of the 3 screw holes and drill small pilot holes. Fix in position using the screws.

Care and Maintenance

- It is recommended the dials are rotated weekly to keep them moving freely.

DISPOSAL

- Coopers of Stortford use recyclable or recycled packaging where possible.
- Please dispose of all packaging, paper, cartons, packaging in accordance with your local recycling regulations.

