

# Dessicant Dehumidifier

**H003** v01: 02/09/20

Please read and retain these instructions for future reference

# BERGSTRÖM



## Dimensions

30 x20 x45.3cm

Net weight:

5.7kg

Input:

220-240V a.c. 50/60Hz

Power:

650W

Volume

2.5L

Working capacity:

7L/D (30 °C 80% RH)

Operating Temperature: -10 to 50 °C

Coverage area:

<40m<sup>2</sup>

- DON'T LET DAMP WEATHER IMPACT YOUR HOME
- HIGHLY EFFECIENT AND POWERFUL 650W
- POWERFUL 2.5L DESICCANT DEHUMIDIFIER THAT ABSORBS UP TO 7 LITRES OF MOISTURE EVERY DAY
- VISIBLE WATER LEVEL WINDOW AND AUTO OFF FUNCTION WHEN THE WATER COLLECTOR NEEDS EMPTYING
- QUIET OPERATION
- BUILT IN HANDLE SO YOU CAN EASILY MOVE FROM ROOM TO ROOM
- AUTOMATIC LOUVRES
- MAINS POWERED
- 3 FAN SPEEDS, LOW, MED HIGH
- A CHOICE OF TIMER SETTINGS, 2H, 4HR, 8HR (IT WILL AUTOMATICALLY SWITCH OFF AFTER THIS AMOUNT OF TIME)
- IDEAL FOR GARAGES, CARAVANS, CONSERVATORIES, BASEMENTS AND ANYWHERE THAT DAMP OR CONDENSATION IS A PROBLEM,
- 1.5M POWER LEAD

\*Calls cost 7 pence per minute plus your telephone company's network access charge

The Enterprise Department  
Head Office: 11 Bridge Street  
Bishop's Stortford, CM23 2JU  
Tel: 0844 482 4400\*  
Fax: 01279 756 595  
[www.coopersofstortford.co.uk](http://www.coopersofstortford.co.uk)

### Safety Warning

- TO AVOID ELECTRIC SHOCK AND FIRE, DO NOT ALLOW WATER, LIQUID OR ANY FLAMMABLE DETERGENT TO GET INTO OR TO CLEAN THE PRODUCT.
- DO NOT SPRAY INSECTICIDE, PERFUME OR OTHER FLAMMABLE SPRAY AROUND THE PRODUCT.
- IF POWER CORD IS DAMAGED, IN ORDER TO AVOID DANGER, IT MUST BE REPLACED BY A QUALIFIED TECHNICIAN.
- PLEASE STOP USING IF THE PLUG, POWER CORD OR PRODUCT IS DAMAGED.
- KEEP THE AIR INLET/OUTLET FROM BEING BLOCKED.
- ENSURE NO FOREIGN BODIES ENTER THE PRODUCT THROUGH THE AIR INLET.
- ENSURE THE POWER SOCKET IS WELL CONNECTED WITH THE PLUG. IF NOT, THE PLUG WILL BE HOT.
- DO NOT PLACE ANY ITEMS ABOVE OR ON TOP OF THE PRODUCT.
- ENSURE THE PRODUCT IS USED AND KEPT IN A WELL-VENTILATED AREA.
- LEAVE AT LEAST 30CM OF SPACED ON THE BACK AND SIDES OF THE PRODUCT, AND AT LEAST 50CM OF SPACE ABOVE THE PRODUCT WHEN USING.
- DO NOT PLACE THE PRODUCT UNDER AIR CONDITIONER TO PREVENT CONDENSATION WATER DROPPING INTO THE PRODUCT.
- PLEASE DO NOT USE THE CONTINUOUS DRAINAGE, IF THE TEMPERATURE AROUND THE WATER PIPE IS BELOW 0 °C.
- BEFORE USING THE CONTINUOUS DRAINAGE, PLEASE KEEP THE WATER PIPE IN PLACE TO ENSURE A SMOOTH DRAINAGE.
- WHEN THE MACHINE IS IN CONTINUOUS DRAINAGE OR UNATTENDED FOR A LOGN TIME, PLEASE CHECK EVERY 2 WEEKS.
- DO NOT USE HARD OBJECTS TO STRIKE THE PROEDUCT, ESPECIALLY THE AIR OUTLET AND AIR INLET.
- PLEASE DO NOT USE CLOTHES, CURTAINS AND OTHER ITEMS TO COVER THE AIR INLET AND AIR OUTLET OR MANUALLY CLOSE THE AIR DEFLECTOR.
- DO NOT INSERT FINGER OR OTHER THINGS INTO THE AIR OUTLET/INLET TO PREVENT ENTRAPMENT.
- DO NOT USE THIS PRODUCT WHEN YOU ARE USING AN INDOOR SPRAY REPELLENT, OR IN A PLACE FILLED WITH GREASE, FLAMMABLE GAS OR CHEMICAL FUMES.
- ENSURE THE PRODUCT IS UNPLUGGED IF YOU NEED TO MOVE IT.
- DO NOT TRY TO REPAIR, DISASSEMBLE OR TRANSFORM THIS UNIT.
- THE PRODUCT IS SUITABLE TO USE IN HOUSEHOLD AND UNDER WORKING CONDITION. IT WILL HAVE STABLE PERFORMANCE AFTER 30-60 MINUTES.
- THIS APPLIANCE CAN BE USED BY CHILDREN AGED FROM 8 YEARS AND ABOVE AND PERSONS WITH REDUCED PHYSICAL, SENSORY OR MENTAL CAPABILITIES OR LACK OF EXPERIENCE AND KNOWLEDGE IF THEY HAVE BEEN GIVEN SUPERVISION OR INSTRUCTION CONCERNING USE OF THE APPLIANCE IN A SAFE WAY AND UNDERSTAND THE HAZARDS INVOLVED. CHILDREN SHALL NOT PLAY WITH THE APPLIANCE. CLEANING AND USER MAINTENANCE SHALL NOT BE MADE BY CHILDREN WITHOUT SUPERVISION.
- CHILDREN OF LESS THAN 3 YEARS SHOULD BE KEPT AWAY UNLESS CONTINUOUSLY SUPERVISED.

## Contents

Safety Warning .....	2
Components .....	4
Control Panel Description.....	5
Basic Operation .....	5
Emptying the water tank .....	7
Maintenance.....	8
Cleaning .....	8
Storage.....	9
FAQ .....	9
PLUG WIRING (UK & IRELAND) .....	9
DISPOSAL .....	10

Please read and retain these instructions for future reference

v001: 02/09/20

## Components

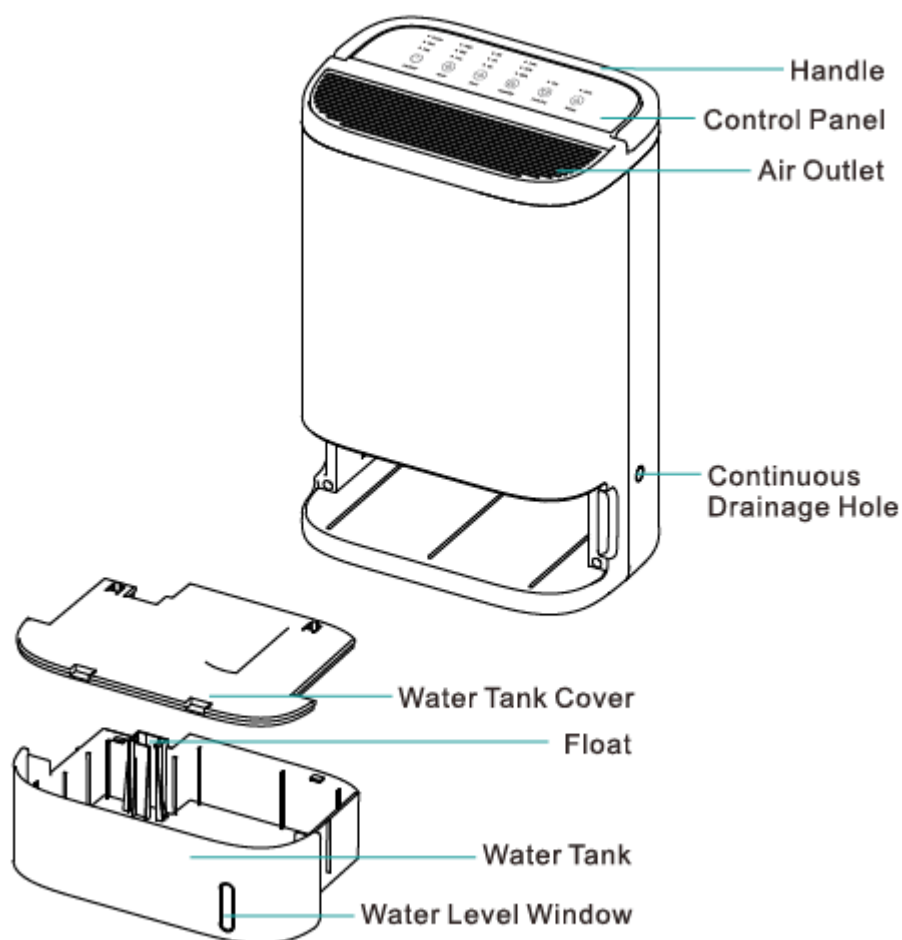

## Control Panel Description

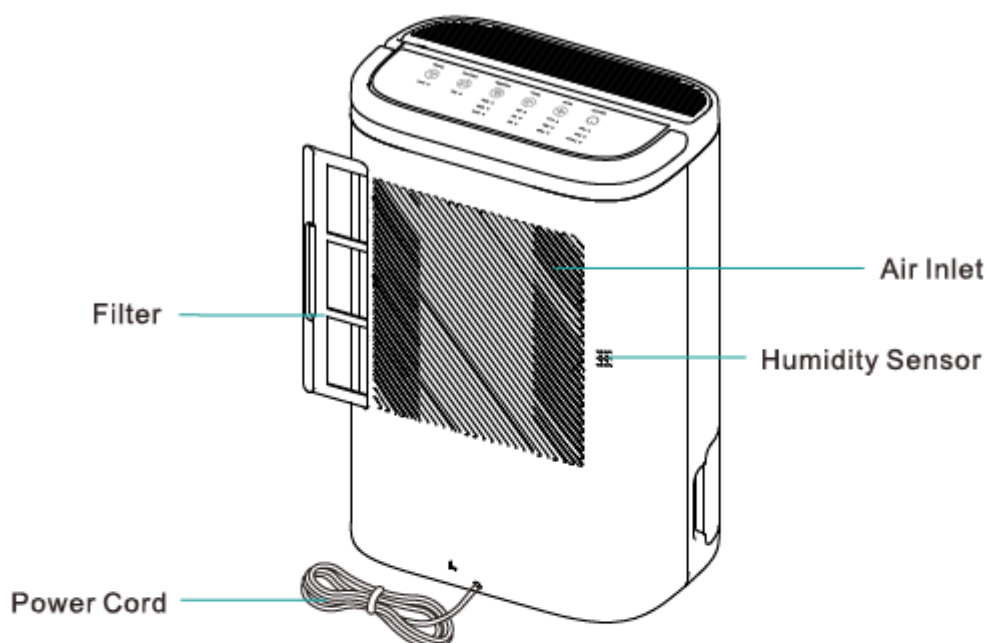

## Control Panel

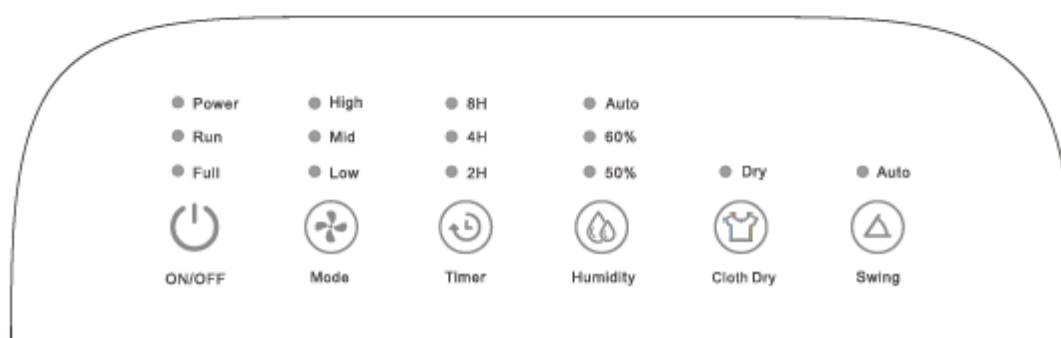

## Basic Operation

Connect the power cord to a wall socket

All LED indicators on the panel will be on for 1s and then off, at the same time the buzzer will ring three times. When the unit connects with power, the power indicator turns red.



### Power ON

Press the power button to turn on the unit, the unit will start dehumidifying and the wind deflector will go up.

**Power OFF**

Press the power button again to turn off the unit, the power indicator turns red, and other indicators will be off. The unit will keep working for 4 minutes then turn off, and the wind deflector rotates down to its original position.

Notice: The machine can record the dehumidify mode and humidity mode of the last operation.

**Button Operation****1. Mode Setting**

Press the mode button to adjust the wind speed between Low, Mid and High mode, the corresponding indicator light turns on. Press the button again, it will start from beginning.

Notice: When the unit dehumidifies in any humidity mode, user can set wind speed and timer if required.

- ☐ High
- ☒ Mid
- ☐ Low

**Mode****2. Timing Shutdown**

Whilst in working mode, press the timer button to set 2h, 4h or 8h timer or cancel. Press again, it will start from the beginning.

(1) The unit will auto-off when the water tank is full even if the unit is on timer and the remaining time will still be recorded. After emptying the water tank, the unit will keep working for the remaining set hours.

(2) When the water tank is not full, the timing function could be set in any timer. If the unit stops working or cuts off, it needs to be reset.

- ☐ 8H
- ☒ 4H
- ☐ 2H

**Timer****3. Humidity Setting**

(1) Press the humidity button to dehumidify under the condition of RH50%, RH60% or Auto, then the corresponding indicator turns on. Press the button again, it will start from the beginning.

(2) When the ambient humidity is lower than the set humidity, the unit will stop dehumidifying. When the ambient humidity is higher than the set humidity, the unit will re-start dehumidifying.

- ☒ Auto
- ☐ 60%
- ☐ 50%

**Humidity**

Notice: When the unit is set to automatic dehumidification its operation is not affected by the change in ambient humidity.

### 4. Clothes Dry Setting

Press the clothes dry button, the unit will work in strong mode. The user can set timer and humidity but the function of dehumidification cannot be set. If the unit does not work under time, the unit will keep working for 10 hours and then stop for half an hour. It will then restart automatically.

● Dry



Cloth Dry

### 5. Swing Setting

When in working mode, the position of the wind deflector can be controlled by the fan setting button. Press the fan setting button to set the wind deflector to either swing or stop status. The wind deflector can swing or stop at any angle within 90 degrees.

● Auto



Swing

### Emptying the water tank

The water tank has a capacity of 2.5L with 7L per day working capacity. When the tank is full, the machine will stop dehumidifying immediately. The full indicator will keep flashing in orange.

#### Pour water from the tank

Turn the machine off, take out the water tank and pour out the water.

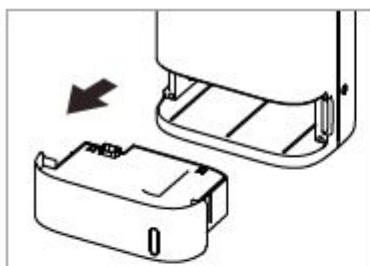

1. Pull out the water tank

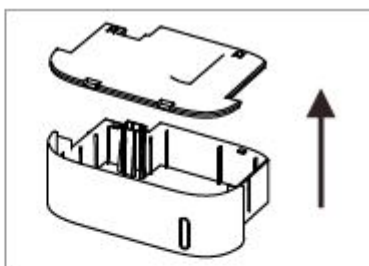

2. Remove the water tank cover

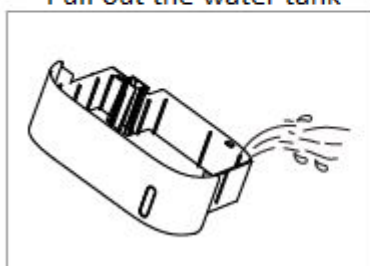

3. Discard the water

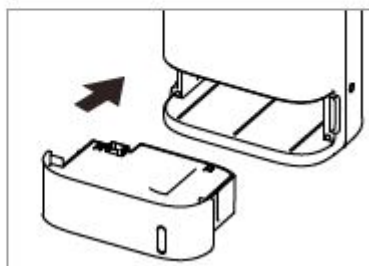

4. Push the water tank back in

### Continuous Drainage

1. Turn the machine off, remove the water tank and cut off the plastic block of the continuous drainage hole.
2. Extend the drain pipe from the continuous drainage hole to the inside of the machine and then insert the drain pipe into the drain hole from the mouth of the tank.
3. After resetting the water tank, the machine will be in protected status.

Protected status: water full indicator and power indicator will keep flashing.

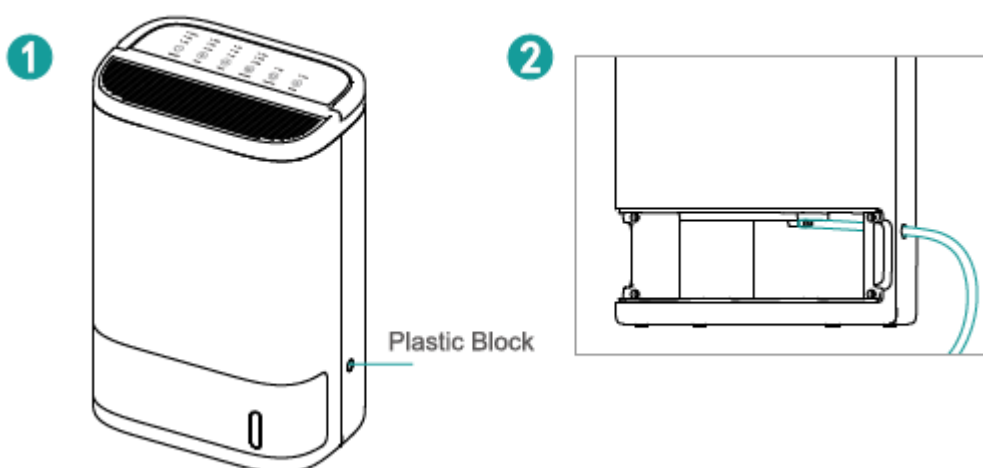

### Maintenance

#### Note

- Ensure the machine is turned off and unplugged before maintenance.
- Do not immerse the dehumidifier in water or any other liquid.
- Do not use abrasive, corrosive or flammable cleaners (such as bleach or alcohol) to clean any part of the machine.

### Cleaning

1. Ensure the machine is turned off and unplugged.
2. Use a soft cloth with neutral cleaner to clean away any dust or debris from the surface of the unit and air inlet/outlet.  
Notice: Please do not drop any water into the machine when cleaning the air outlet.
3. Pull out the water tank and open the cover to clean the water tank.
4. If the filter is blocked by dust, the dehumidifying action will be weakened. Please clean the filter twice a week.
  - Take out filter.
  - Clean the filter with a vacuum cleaner or water and put it in a ventilated place to dry out. Do not put the filter in high temperature or in sunlight to dry out.
  - After drying please re-install the filter.



**Storage**

- Ensure the machine is powered off and unplugged.
- Ensure the water tank is clean and dry.
- Use a soft cloth with neutral cleaner to clean away any dust or debris from the surface of the air inlet/outlet.
- After the machine is completely dry, put on the bag and place it in a cool and well-ventilated space.
- If you do not use the dehumidifying for a long time, you should turn on the machine for a few minutes from time to time to ensure a good performance.

**FAQ**

Problem	Reason
Not working	Is it plugged into a power socket? Is there a power cut? Is the home leakage switch or fuse cut off? Is the water tank full?
Poor performance (less water in the tank)	Is the filter blocked? Is the door opened? Is there any obstacle blocking the air inlet/outlet? Is there any other equipment releasing steam indoors? Is the indoor temperature too low? (The dehumidification capacity will be weakened in low temperatures and in a humid environment)
The air volume becomes smaller	Is the filter too dirty so that it blocks the air to enter inside? Is the air inlet/outlet of the machine blocked by something?
Significant noise	Is there anything stuck on the fan in the air outlet? Is the machine tilted?
Leakage	Is the machine tilted or dumped? Is there any water in the tank when moving the machine? Has the floating ball in the water tank fallen off?
Still working after power off	The unit continues working for 4 min after power off. This process is the delaying working setting to make the hot air come out fully. It is normal to protect the machine.
Air coming out smells	When the temperature is high between heat exchanger and the cold exchanger, the smell will be emitted temporarily. It is a normal phenomenon.

**PLUG WIRING (UK & IRELAND)**

This appliance is fitted with a BS 1363 **13-amp** plug. If you have to replace the fuse, only those that are ASTA or BSI approved to BS1362 and with a rated current of **13-amps** should be used. If there is a fuse cover fitted, this cover must be re-fitted after changing the fuse. If the fuse cover is lost or damaged the plug must not be used. Spare fuse holders and fuses are available from electrical outlets. If the socket outlets in your home or office are not suitable for this product's plug, the plug must be removed and disposed of safely. Attempts to insert the plug into the wrong socket is likely to cause electric hazard. A replacement plug should be wired according to the following instructions:

### The cable

A mains electricity cable contains two or three inner wires. Each has a core of copper and an outer layer of flexible plastic. This product is **double insulated**; the wires in the cord set are colour coded in the following way:

BLUE	NEUTRAL
BROWN	LIVE
GREEN & YELLOW	EARTH

The diagram below shows the key features of a correctly wired three-pin mains plug.

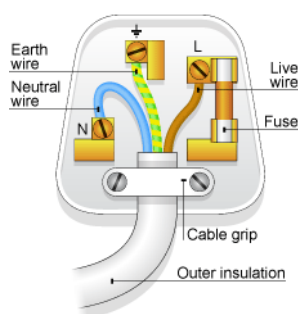

#### Note:

Double insulated appliances do not need the green & yellow Earth wire. They may only have the Brown and Blue wires.

### DISPOSAL

- Coopers of Stortford use recyclable or recycled packaging where possible.
- Please dispose of all packaging, paper, cartons, packaging in accordance with your local recycling regulations.
- Plastics, polybags – Contains the following recyclable plastic.



Code & Symbol	 OTHER
Type of Plastic	Please Specify (includes ABS, Nylon)
Commonly used for	CD's, crisp packets, various flexible packaging, baby bottles, sunglass lenses
Notes	Not often or widely recycled

- At the end of the product's lifespan please check with your local council authorised household waste recycling centre for disposal.

