

12 in 1 Steam Cleaner Max

H008 v01: 24/08/20

Please read and retain these instructions for future reference

BERGSTRÖM



Dimensions

126 high and 26cm wide (when used as a floor mop with the triangular head on)

Technical Details

220-240V, 50/60Hz, 1300 W

- A QUICK & EASY WAY TO HYGIENICALLY CLEAN WITHOUT THE NEED FOR CLEANING CHEMICALS OR AEROSOLS
- KILLS 99.9% OF GERMS, VIRUSES & BACTERIA, COMPLETELY NON-TOXIC AND PET SAFE
- WITH 1300W OF POWER IT HEATS UP IN JUST 30 SECONDS AND WITH 4 STEAM SETTINGS OR LOW, MED, HIGH AND HOT SPRAY
- CAN EASILY BE SWITCHED FROM A STEAM MOP TO HANDHELD STEAMER
- CAPACITY 400ML
- LIGHTWEIGHT AT JUST 2.75KG SO ITS EASY TO MOVE FROM ROOM TO ROOM
- STEAM TIME 15 MINUTES
- USE ON A MULTITUDE OF SURFACES FROM HARDWOOD, CARPET, TILES, LINO , STAINLESS STEEL
- GREAT FOR CLEANING GROUT, WINDOWS, KITCHEN SINKS, FLOORS, TILES, THE LIST IS ENDLESS!
- ERGONOMICALLY DESIGNED TRIANGULAR MOP HEAD SO YOU CAN REACH INTO ALL CORNERS, WHICH ALSO ROTATED 180 DEGREES
- 3.5M POWER LEAD
- MAINS POWERED
- LED INDICATOR LIGHT

Accessories

- 1pc jet nozzle
- 3 round brushes (2 nylon & 1 copper)
- 1pc triangular brush (nylon)
- 1pc scoop nozzle
- 1pc grout cleaning brush
- 1pc window cleaning tool
- 1pc carpet glider
- 1pc duster tool
- 1pc micro fibre cloth pad
- 1pc coral cloth for duster tool
- 1pc coral cloth for windows
- 1pc garment steaming cloth
- 1pc cleaning pin
- 1pc measuring cup



*Calls cost 7 pence per minute plus your telephone company's network access charge

The Enterprise Department
Head Office: 11 Bridge Street
Bishop's Stortford, CM23 2JU
Tel: 0844 482 4400*
Fax: 01279 756 595
www.coopersofstortford.co.uk

Contents

Technical Details	1
WARNINGS AND SAFETY INSTRUCTIONS:	3
Parts.....	4
Accessories	5
How to assemble the steam mop.....	5
How to use the steam cleaner	7
How to assemble hand-held steamer.....	11
Garment Steaming Tool	13
Duster	13
How to use hand-held steamer.....	14
How to use Optional Accessories	16
Window Cleaning Tool	16
Garment Steamer	16
Duster	18
Coral Cloth for Mop Head.....	19
Cleaning and Maintenance	20
Troubleshooting.....	23
DISPOSAL.....	24

WARNINGS AND SAFETY INSTRUCTIONS:

WHEN USING ELECTRICAL APPLIANCES, BASIC SAFETY PRECAUTIONS SHOULD ALWAYS BE FOLLOWED:

- READ ALL INSTRUCTIONS BEFORE USE.
- FOR DOMESTIC INDOOR USE ONLY.
- DO NOT USE OUTDOORS OR FOR COMMERCIAL USE.
- BEFORE USE, CHECK THOROUGHLY FOR ANY DEFECTS AND DO NOT USE IF DEFECTS ARE FOUND. TAKE CARE NOT TO DROP THE APPLIANCE AS HEAVY IMPACTS MAY CAUSE INTERNAL DAMAGE.
- BEFORE CONNECTING THE APPLIANCE, CHECK IF THE VOLTAGE INDICATED ON THE BOTTOM OF THE APPLIANCE IS IN ACCORDANCE WITH THE MAINS VOLTAGE IN YOUR HOME.
- CHECK THE APPLIANCE AND POWER CABLE CAREFULLY FOR DAMAGE BEFORE EACH USE.
- THIS APPLIANCE CAN BE USED BY CHILDREN AGED FROM 8 YEARS AND ABOVE AND PERSONS WITH REDUCED PHYSICAL, SENSORY OR MENTAL CAPABILITIES OR LACK OF EXPERIENCE AND KNOWLEDGE IF THEY HAVE BEEN GIVEN SUPERVISION OR INSTRUCTION CONCERNING USE OF THE APPLIANCE IN A SAFE WAY AND UNDERSTAND THE HAZARDS INVOLVED. CHILDREN SHALL NOT PLAY WITH THE APPLIANCE. CLEANING AND USER MAINTENANCE SHALL NOT BE MADE BY CHILDREN WITHOUT SUPERVISION.
- CHILDREN OF LESS THAN 3 YEARS SHOULD BE KEPT AWAY UNLESS CONTINUOUSLY SUPERVISED.
- **SOME PARTS OF THIS PRODUCT CAN BECOME VERY HOT AND CAUSE BURNS. PARTICULAR ATTENTION HAS TO BE GIVEN WHERE CHILDREN AND VULNERABLE PEOPLE ARE PRESENT.**
- THE USE OF ANY ACCESSORY ATTACHMENTS NOT RECOMMENDED BY COOPERS OF STORTFORD MAY CAUSE INJURIES AND INVALIDATE ANY WARRANTY YOU MAY HAVE.
- DO NOT LET THE POWER CABLE TOUCH HOT SURFACES.
- DO NOT COVER THE ITEM IN ANY WAY WHEN IN USE AS THIS MAY CAUSE OVERHEATING.
- DO NOT USE THIS APPLIANCE FOR ANY OTHER USE THAN THE INTENDED USE IT IS DESIGNED FOR.
- TO PROTECT AGAINST ELECTRIC SHOCK, DO NOT IMMERSE POWER CABLE, PLUG OR APPLIANCE, IN WATER OR ANY OTHER LIQUID.
- UNPLUG FROM OUTLET WHEN NOT IN USE AND BEFORE CLEANING.
- NEVER DIRECT STEAM TOWARDS PEOPLE, ANIMALS OR PLANTS.
- THE LIQUID OR STEAM SHOULD NOT BE DIRECTED TOWARDS EQUIPMENT CONTAINING ELECTRICAL COMPONENTS, SUCH AS THE INTERIOR OF OVENS.
- STOP USING THE STEAM CLEANER IF YOU OBSERVE WATER LEAKAGE, AND CONTACT A QUALIFIED TECHNICIAN.
- DO NOT USE THE STEAM CLEANER IN ENCLOSED SPACES THAT ARE FILLED WITH FLAMMABLE, EXPLOSIVE OR TOXIC VAPOUR SUCH AS PAINT THINNER OR OIL-BASED PAINT.
- DO NOT USE ON LEATHER, WAX POLISHED FURNITURE OR FLOORS, UNSEALED HARDWOOD OR PARQUET FLOORS, SYNTHETIC FABRICS, VELVET OR OTHER DELICATE STEAM-SENSITIVE MATERIALS.
- DO NOT USE FOR SPACE HEATING PURPOSES.
- DO NOT PLACE ON OR NEAR A HOT GAS OR ELECTRIC BURNER, OR IN A HEATED OVEN.
- CARE SHOULD BE TAKEN WHEN USING APPLIANCE DUE TO EMISSION OF STEAM.
- TO AVOID CIRCUIT OVERLOAD, DO NOT OPERATE ANOTHER APPLIANCE ON THE SAME SOCKET (CIRCUIT) AS THE STEAM CLEANER.
- DO NOT OPERATE ANY APPLIANCE WITH A DAMAGED POWER CABLE OR PLUG OR AFTER THE APPLIANCE MALFUNCTIONS, OR HAS BEEN DAMAGED IN ANY MANNER. WE RECOMMEND THAT THE POWER CABLE IS NOT KINKED OR STORED IN A TWISTED MANNER, AND THAT YOU REGULARLY CHECK ITS CONDITION.
- ANY REPAIRS MUST BE CONDUCTED BY A QUALIFIED ELECTRICIAN OR ELECTRICAL SERVICE AGENT.



WARNING: DANGER OF SCALDING

ASSEMBLY INSTRUCTIONS / INSTRUCTIONS FOR USE:

Unpack the components carefully. Please check all parts have been removed from the packaging.

Parts

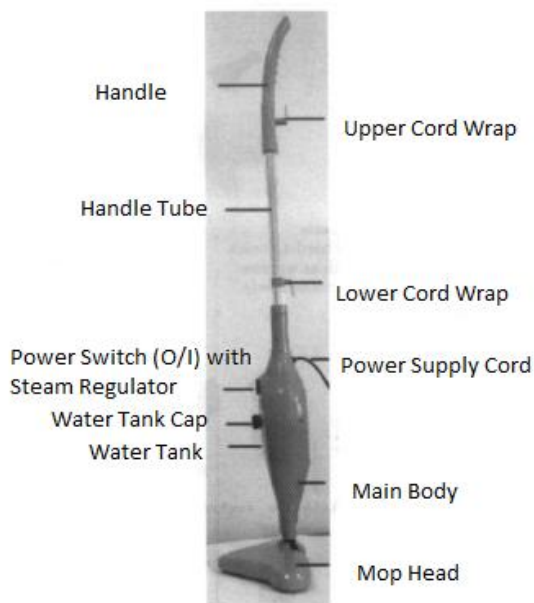

Accessories

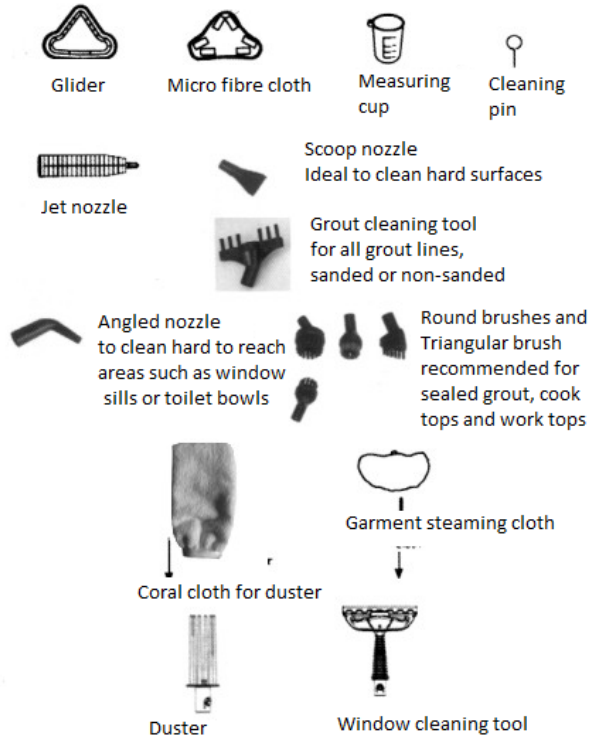

How to assemble the steam mop



Please make sure that the unit is unplugged from an electrical outlet and the power switch is in the "OFF" position (O) before assembling the unit or changing the accessories.

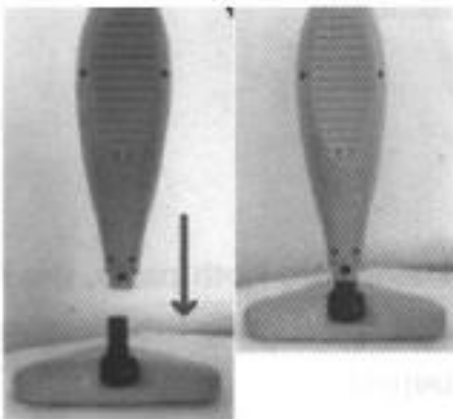

1. Attach the MOP head to the main body as follows: Insert the swivel joint into designated hole in the main body until it locks in place with the lock button on the main body (you will hear a clicking sound).

Make sure that the mop head is securely locked before usage

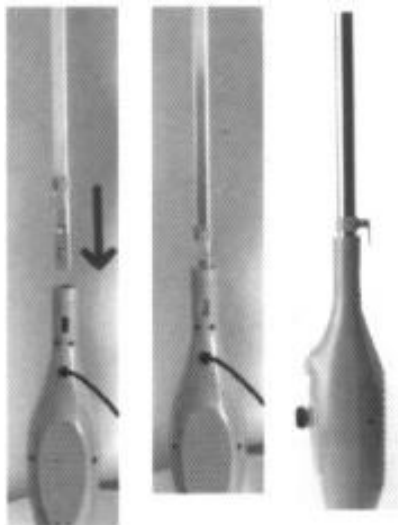

2. Insert the handle tube into the designated opening in the main body until it gets locked in place with the handle tube lock button.

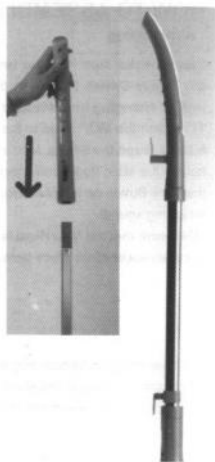

3. Insert the handle into the designated opening of the handle tube until it gets locked in place with the handle lock button.

Make sure both parts, the handle and the handle tube, are secured in place before usage.

4. Place the micro fibre cloth on the bottom of the mop head and make sure all the loops on the cloth are aligned with the gripping hooks on the bottom of the mop head then press the cloth against the mop head so the loops on the cloth catch the gripping strips on the mop head and hold the pieces together

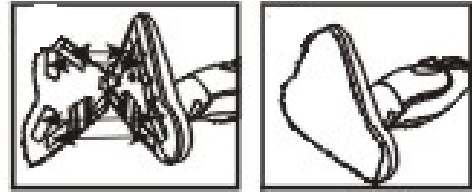

When using the steam cleaner on carpet surfaces, place the mop head with micro fibre cloth in place, on top of the carpet glider as illustrated in Fig 6a. Do not attempt to use the steam cleaner unit on carpet/rug surfaces without the carpet glider in place.

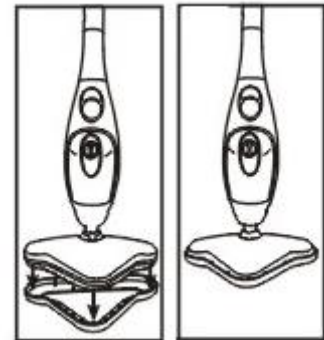

Caution: Never use the carpet glider on surfaces that are prone to scratching.

Never assemble or remove accessories while the unit is in operation.

How to use the steam cleaner

Please read before use

The Steam Cleaner is designed to thoroughly clean floor surfaces, such as marble, ceramic, carpet, stone, linoleum, and sealed hardwood floors and parquet. Not all floor types are suitable for steam cleaning.

The heat and steam action may remove the wax on surfaces treated with wax. Do not use on unsealed flooring or let unit stand on any wood or heat sensitive floor for an extended period of time. This could cause the wood grain to rise, in addition to other types of damage.

When using on vinyl, linoleum or any other heat sensitive floors, use extra caution. Too much heat can melt glue in the flooring. Use only on laminated flooring that has been laid professionally and without any gaps or cracks that would permit the entry of moisture.

Test the Steam Cleaner on a small isolated area of your flooring prior to overall use on any floor surface.

Always check the use and care instructions of your flooring manufacturer or distributor before using the

Steam Cleaner.

When in doubt, please consult a flooring specialist. Only use the carpet glider on carpeting and rugs. Use the carpet glider on other floor surfaces will cause streaking and possibly scratching.

This product emits steam and creates moisture. Water marks, discoloration or damage to the floor surface can occur if the unit is left operating too long in one place.

5. Fill the Water tank with water



Caution: Make sure the Steam Cleaner is unplugged.

Turn the water tank cap anti-clockwise approximately 90 ° to the "OPEN" position and remove the cap as illustrated below.

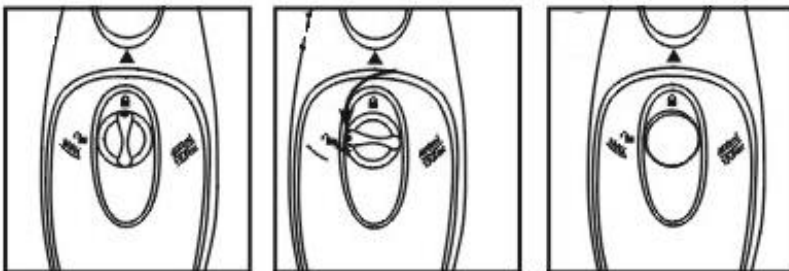

Hold the mop at 45 ° angle as illustrated and add water in the tank up to the MAX level by using the measuring cup.

Do not overfill. The maximum tank capacity is 400ml/13.5 OZ.

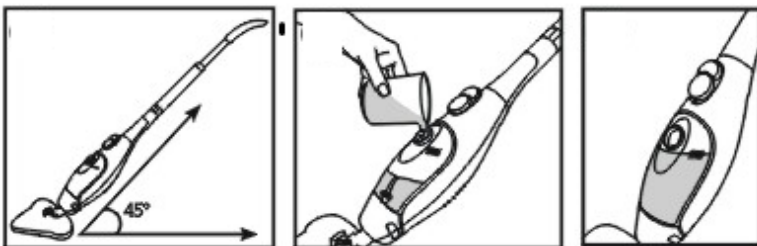

Replace the water tank cap and turn clockwise approximately 90 ° to the "CLOSE" position until the cap is tightened securely.

The Steam Cleaner uses tap water. However in areas with hard water, distilled water should be used for better performance.

Make sure the copper cone inside the water tank is always submerged in water (as illustrated) while operating the Steam Cleaner.

Note:

Never put cleaning detergent or scented products into the steam cleaner. This will make the operation unsafe and damage the unit.

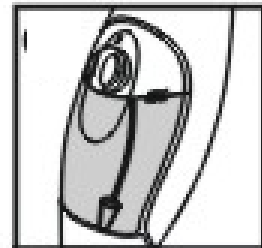
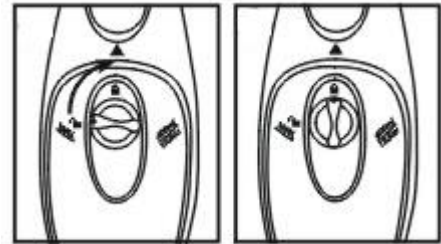

6. Once the unit has been fully assembled and filled with water, plug in the power cord to an earthed electrical outlet. The RED light – Power indicator will indicate when power is on. Power Switch (O/I) is on the OFF (O) position.

Wait for the Ready-to-use indicator to turn Green – approximately 20-30 seconds. GREEN light will turn on when the steam cleaner is ready for use.

When the Ready-to-use indicator light turns Green turn the power switch (O/I) to the ON (I) position. The steam cleaner will start emitting steam.

To stop emitting steam turn OFF (O) the unit by turning the power switch (O/I) to the OFF position again.

If the power switch (O/I) is turned prior to the Ready-to-Use light indicator turning green, water from the previous use will not be heated and will be forced out by present steam and will cause puddling.

This may also happen if the power switch was left in the ON (I) position from the previous use and the unit was disconnected by unplugging only. Make sure to turn the unit OFF after each usage and then disconnect from the electrical outlet so the unit is in the OFF (O) position when used next time.

7. Select one of the following Steam Regulator positions:

1 – Low – 2-Medium, 3-High and 4-Hot spray

1-Low and 2-Medium Setting: Ideal for cleaning all hard floors, such as linoleum, ceramic, marble, wood etc

3 High Setting: Ideal for cleaning bathrooms, kitchens, window sills, car wheels etc. You can change the steam regulator position and change the steam output while operating the steam cleaner.

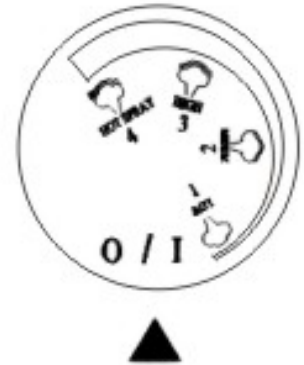

8. Slowly pass over the surface to be cleaned. The absorbent mop cloth picks up the dirt loosened by the steam. Apply steam liberally. Keep a towel handy and wipe away any excess water that may accumulate.
9. When the steam cleaner stops emitting steam, simply turn OFF and unplug the appliance, refill the water tank and continue cleaning.



WARNING

Never leave the steam cleaner unattended while plugged in.

For best results:

1. Sweep or vacuum floor prior to using the steam cleaner.
2. To avoid puddling of water, the micro fibre cloth must be clean and dry for use. To replace the cleaning cloth proceed as follows: Let the cleaning cloth cool down, remove cloth from unit, replace with a new micro fibre cloth and continue use. Select low steam regulator position.
3. To sanitize the area of your floor, leave the Steam Cleaner at high steam setting over the steam area for about 10 seconds but no longer than 15 seconds.

Note:

Do not carry out this procedure on heat and steam sensitive floors.

IMPORTANT

- Never steam at one spot for too long. This can cause floor surface damage.
- Do not put hands or feet under the steam cleaner. The unit gets very hot.

- During use a pulsing noise may be heard indicating that the mop is producing steam. This noise is normal.
- There may be some minor “spitting” of water mixed with the steam. This is also normal.
- The force and heat of the steam may adversely affect certain materials. Always check the suitability of using the steam mop on a surface by carrying out a preliminary test on a hidden area.

Hand held steamer

The hand-held steamer is an ideal portable cleaner for use on work surfaces, worktops, sinks, windows, mirror, tiles and spot cleaning on floors, carpets and rugs. Use it with the jet nozzle, brass brush or nylon brush attachments to spray away dirt, grease, mould and more.

How to assemble hand-held steamer



CAUTION

Make sure that the steam cleaner is unplugged before assembly.

1. Remove the power cord from the upper cord wrap and lower cord wrap.
2. Press the handle tube lock button and remove the handle tube from the main body.
3. Press the lock button on the main body and remove the mop head.

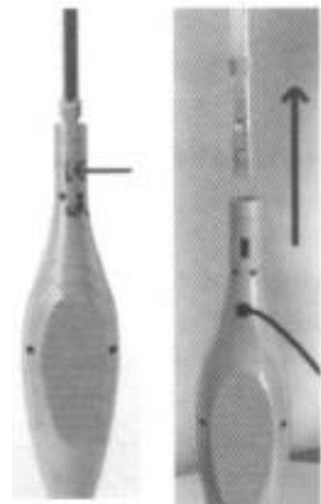
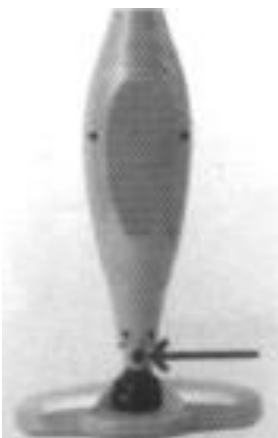
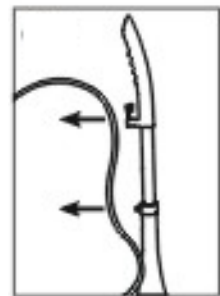

4. To attach the jet nozzle insert the jet nozzle into the designated hole in the main body until it locks in place with the lock button on the main body (you will hear a clicking sound), as illustrated.

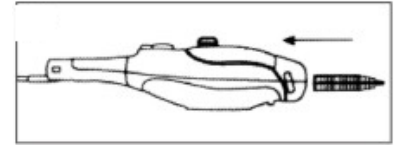

Make sure that the jet nozzle is securely locked in place before usage.

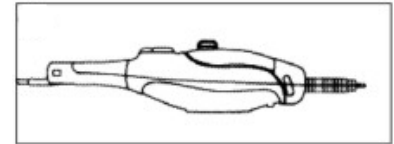

5. Push either the round nylon brush or round copper brush or triangle brush in the channel until it reaches the end of the jet nozzle as illustrated below.

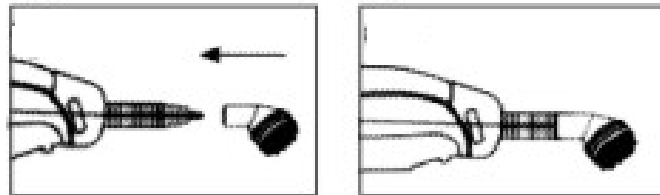

To remove either round brush, pull out from the jet nozzle.

- The round nylon brush is great for cleaning smooth hard surfaces, such as toilets, sinks and kitchen counters etc
- The round copper brush is great for cleaning coarse or metal surfaces, such as brick floors, car wheels, metal doors, and metal frames etc
- Both brushes can also effectively clean the grease on pans, stoves and ovens in the kitchen. They can be used with soap or detergent to clean dirty areas.

NOTE:

Never use the round brass brush on surfaces that are prone to scratching. Remove the mop head by pressing the lock button on the main body or remove the jet nozzle following the same procedure.

Garment Steaming Tool

To use the window cleaning tool as a garment steamer install the micro fibre cloth or the lint cloth over the window/cleaner garment steamer (as illustrated)

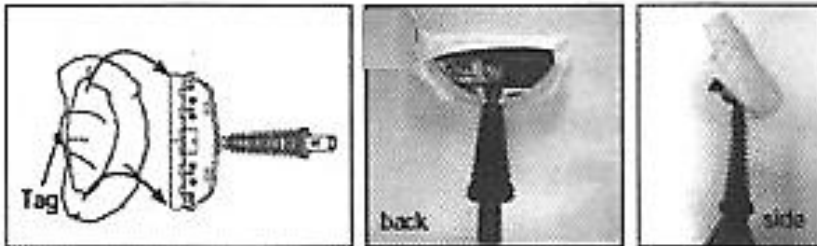

Insert the window cleaning tool in the designated hole in the main body until it locks in place with the lock button on the main body (you will hear a clicking sound).

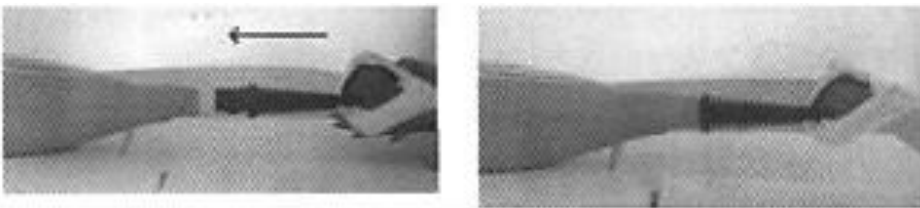

To remove or replace, press the lock button on the main body and remove it.

Duster

Install the cleaning coral cloth onto the duster frame (as illustrated).

Insert the duster into the designated hole in the main body until it locks in place with the lock button on the main body (you will hear a clicking sound).

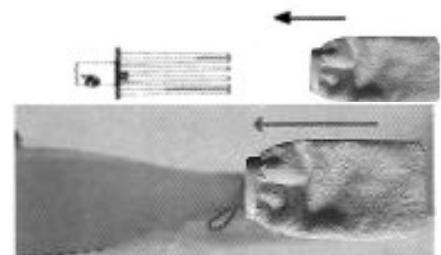

To remove or replace, press the lock button on the main body and remove the duster.

How to use hand-held steamer**CAUTION****Make sure that the steam Cleaner is unplugged.**

1. Fill the water tank with water. Please refer to the “HOW TO USE THE STEAM CLEANER” section in this manual.

Attach either the round nylon brush or the round copper brush as explained in the “How to assemble h and held steam cleaner” section in this manual.

2. Once the unit has been fully assembled and filled with water, plug in the power cord into an earthed electrical outlet.

RED light – Power indicator will indicate when power is on.

GREEN light will turn on when the steam cleaner is ready for use.

When the ready-to-use indicator light turns green turn the power switch (O/I) to the ON (I) position. The hand held steam cleaner will start emitting steam.

3. Select one of the following steam regulator option:

1 – Low, 2 – Medium, 3 – High or 4 – Hot Spray.

You can change the steam regulator position and the steam output while operating the steam cleaner.

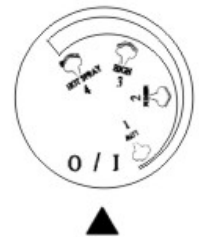

To stop emitting steam, turn OFF the unit by turning the power switch (O/I) to the

OFF (O) position. If the power switch is turned prior to the Ready-to-Use light indicator turning green, water from previous use will not be heated and will be forced out by present steam.

This may also happen if the Power Switch (O/I) was left in the ON (I) position after previous use and the unit was disconnected by unplugging only.

Make sure to turn the unit off after each use and then disconnect from the electrical outlet so the unit is in the OFF (O) position when used next time.

4. Slowly pass over surfaces to be cleaned. Apply steam liberally. Keep a towel handy and wipe away any excess water that may accumulate.
5. When the hand held steam cleaner stops emitting steam, simply turn OFF and unplug the unit, refill the water tank and continue cleaning.

To sanitize your work surfaces, kitchen countertops, sinks, bathrooms, etc use the hand-held steam cleaner over the same area for about 15 seconds.

NOTICE

Do not carry out this procedure on heat and steam sensitive surfaces. The force and heat of the steam cleaner may adversely affect certain materials. Always check the suitability of using the steam cleaner on a particular surface by first testing a hidden area.



WARNING

Never direct steam towards people, animals or plants.

NOTICE

Do not use the steam cleaner to clean frozen windows.

Be careful when using the steam cleaner on glass, as it may break.

Do not use steam cleaner on leather, wax polished furniture or waxed floors, synthetic fabrics, velvet or other delicate steam sensitive materials.

How to use Optional Accessories

Window Cleaning Tool

Make sure the Steam Cleaner is unplugged.

1. Fill the water tank with water. Please refer to the "How to use the steam cleaner" section in this manual.
2. Install the coral cloth onto the window cleaning tool and attach the window cleaning tool to the main body as described in "How to assemble the optional accessories" section in this manual.
3. Follow Steps 2 and 3 described in the "How to use the hand-held steam cleaner" section in this manual.
4. Hold the hand-held steamer in one hand as illustrated.
5. Slowly pass over glass (or other similar) surface to be cleaned. Apply steam liberally.
6. When the hand-held steam cleaner stops emitting steam, simply turn off and unplug the unit, refill the water tank and continue cleaning.
7. Once you finish cleaning, allow the coral cloth to cool down and carefully remove it from the window cleaning tool, as cleaning cloth could still be hot.

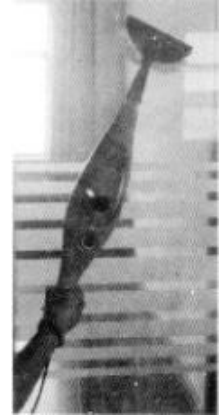

NOTICE

Do not use the steam to clean frozen windows.

Be careful when using the steam cleaner on glass, as it may break.

Garment Steamer

Make sure the steam cleaner is unplugged.

1. Fill the water tank with water. Please refer to the "How to use the steam mop" section in this manual.
2. Install the garment steamer cloth onto the window cleaning/garment steaming tool and attach the window cleaning/garment steaming tool to the main body as described in the "How to Assemble the optional Accessories" section in this manual.
3. Select one of the following steam regulator position:

1 Low or 2 – Medium when using the garment steamer.

Do not use 3 – High and 4 – Hot Spray steam settings when using the garment steamer.

You can change the steam regulator position and steam output while operating the steam cleaner.

4. Follow Step 3 described in the “How to Use the Hand-Held Steamer” section in this manual.
5. To steam garment, place item of clothing on the hanger and steam the garment directly.

Slowly slide the garment steamer head vertically from the top to the bottom of the garment. You may also reverse this motion and steam from the bottom to the top.

Curtains and draperies can be steamed while they are hanging.



NOTICE

Please refer to the label on item of clothing to check if garment can be steamed.

Some fabrics like leather, suede, and velvet may not be suitable for steaming.

If you are not sure then steam a small part of the inside of the garment to test that it does not damage the fabric before steaming the entire garment or fabric.



DANGER OF SCALDING

Do not touch the garment steamer tool/cloth during usage, as these components can get extremely hot.

Keep the extension hose away from your body and avoid touching the hose as it can get hot.

6. When the hand-held steamer stops emitting steam, simply turn off and unplug the unit, refill the water tank and continue cleaning.
7. Once you finish cleaning allow the garment steamer cloth to cool down and carefully remove it from the window cleaning tool, as the garment steamer cloth could still be hot.

Duster

Make sure the steam cleaner is unplugged.

1. Fill the water tank with water. Please refer to the "HOW TO USE THE STEAM CLEANER" section in this manual.
2. Install the coral cloth onto the duster frame and attach the duster to the main body as described in "How to Assemble the Optional Accessories" section in this manual.
3. Select one of the following steam regulator positions
1 – Low, 2 – Medium or 3 – High

Do not use 4 – Hot Spray steam setting when using the Duster.

You can change the steam regulator position and change the steam output while operating the Steam Cleaner.

4. Follow Step 3 described in the "How to Use the Hand-Held Steamer" section in this manual.

Slowly pass over surface to be cleaned. The absorbent coral cloth picks up the dirt loosened by the steam. Keep a towel handy and wipe away any excess water that may accumulate.



DANGER OF SCALDING

Do not touch the duster/coral cloth during usage, as these components can get extremely hot.

Keep the extension hose away from your body and avoid touching the hose as it can get hot.

5. When the hand-held steamer stops emitting steam, simply turn off and unplug the unit, refill the water tank and continue cleaning.



WARNING DANGER OF SCALDING

Do not touch the window cleaning/garment steamer tool or the lint cloth during usage, as these components can get extremely hot.

Keep the main body away from your body and avoid touching the hose, as it can get hot.

6. When the hand-held steamer stops emitting steam, simply turn off and unplug the unit, refill the water

tank and continue cleaning.

7. Once you finish cleaning allow the lint cloth to cool and carefully remove it from the window cleaning tool as the lint cloth could still be hot.

Coral Cloth for Mop Head

Attach the triangle shaped coral cloth to the mop head following the same instructions as provided for the micro fibre cloth with hook and loop tape in the “How to assemble the steam cleaner” section in this manual.

The coral cloth is soft and durable with hundreds of absorbing fringes, ideal for your sealed hardwood, ceramic and other types of flooring.

After use

1. Unplug power cord from outlet.
2. Allow mop pad/cloths to cool down and carefully remove cleaning cloth from mop head, as cleaning cloth could still be hot.
3. Any water remaining in the water tank should be emptied prior to appliance storage. Always empty the water tank at the end of each use.
4. Let any water (that may remain as a product of condensation) drain from the steam opening prior to storing the appliance.
5. Wrap power cord around upper and lower cord wrap.
6. Wipe all surfaces of the steam cleaner with a soft cloth. Store in a protected, dry area.
7. Please store the unit in a cool and dry place when not in use. Do not leave it exposed to sunlight or rain.
8. Upright storage of the steam cleaner with a wet mop pad/cloth may result in the formation of white marks on your floor. To remove the white marks, clean area with vinegar. Make sure to remove the mop pad/cloth before storage.

Cleaning and Maintenance



Warning

Be sure that the unit is disconnected from the power outlet when performing cleaning.

Drain the remaining water in the water tank and clean the tank after every use.

Please use detergent to clean the accessories (jet nozzle and round brush)(when they are dirty, then wash with clean water and air dry.

How to descale the water tank interior:

To clean calcium deposits that build up inside the water tank, add one or two tablespoons of white vinegar to a full water tank, close the water tank cap and shake the contents. **DO NOT TURN THE STEAM CLEANER ON.**

Let the unit sit for a few hours. Then, empty the water tank and refill with clean water and empty until it rinses clear.



WARNING

DO NOT IMMERSE THE STEAM CLEANER IN WATER.

Cleaning procedures to remove lime scale

If your Steam Cleaner begins to product steam more slowly than usual or stops producing steam you may need to remove the lime scale. Lime scale can develop over time on the metal parts and greatly affect mop performance.

It is necessary to remove lime scale on a regular basis, every 25-50 times you use a full tank of water or at least once a month, especially in areas with hard water.

The frequency of lime scale removal depends upon the hardness of your tap water and how often you use the steam cleaner.

The steam cleaner uses tap water. However, in areas with hard water, distilled water should be used for better performance.

To remove lime scale from the steam cleaner, please follow these procedures:

By using scraper

1. Make sure that the steam cleaner is disconnected from the power supply before maintenance.
2. Use the cleaning pin to remove scale deposits from the small hole of the steam outlet in the main body, as illustrated. By swirling and pushing the pin up and down you will clean the steam outlet. Always ensure that all scale debris has been removed from the steam outlet before reassembling. Continue swirling cleaning pin until no further debris is evident.

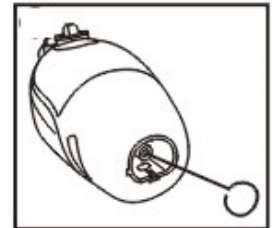

By using cleaning solution

1. Prepare a solution of 1/3 white vinegar and 2/3 tap water and add to the water tank.
2. Secure and position the unit to ensure steam released is aimed away from the floor or surrounding objects and surfaces. Plug the unit in, turn the unit ON by pressing the power switch (O/I) and allow the unit to produce steam until the vinegar/water solution is used up.
3. Repeat the above procedure as many times as necessary until a normal steam flow rate is achieved.
4. Fill the water tank with fresh water and rinse out.
5. Fill the water tank with fresh water, attach to the unit and release steam through the system until the water tank is empty.



WARNING

Do not leave the steamer unattended during the lime scale removal process and/or while in use.

NOTICE

Perform a test cleaning on a suitable isolated area after each lime scale removal to ensure that there is no debris left in the system.



WARNING DANGER OF SCALDING

Cleaning blocked steamer accessories

Due to the high mineral content of water in some areas, you may notice that less steam comes out from the hand-held steamer accessories.

This may be caused by calcium build-up inside the tip of the nozzle.

How to clean calcium build-up:

We recommend using a spray lubricant. Spray a small burst or two of the lubricant inside the tip of the jet nozzle. After spraying lubricant inside the component, fill the steamer with water according to the directions and run a continuous jet of steam through the affected accessory for several minutes to remove the deposit. Once the steam pathway is clear, aim the steamer at a neutral surface or a cleaning cloth to make sure no debris is emitted.

WE RECOMMEND PERFORMING THIS PROCEDURE IN A PROTECTED AND WELL-VENTILATED AREA.

Micro fibre cloth care:

- Machine wash at 60 °C
- Do not bleach
- Do not use fabric softener

Troubleshooting



WARNING

TO REDUCE THE RISK OF FIRE, ELECTRIC SHOCK OR INJURY, UNPLUG APPLIANCE FROM OUTLET BEFORE SERVICING.

Problem	Possible Cause	Solution
The unit does not power on	The unit is not plugged in or turned ON	Make sure the unit is plugged into a proper outlet and the switch is ON (I).
Reduced steam or no steam	Water tank empty	Fill water tank
	Blocked steam nozzle	Remove mop head and clean the nozzle.
	Lime scale deposit	Follow the cleaning procedure in this User's Guide to remove the lime scale.
Steam escapes from connections	Attachment is not connected properly	Turn the unit OFF, allow it to cool down, disconnect the accessories and reattach them properly.
	Debris or obstructions	Remove the accessory and check and clean connection points
The cleaning cloth becomes wet	The cloth gets saturated with water	Remove wet cloth and replace with a new cleaning cloth (optional item) or allow cloth to cool, then wring out and re-attach.

PLUG WIRING (UK & IRELAND)

This appliance is fitted with a BS 1363 **13-amp** plug. If you have to replace the fuse, only those that are ASTA or BSI approved to BS1362 and with a rated current of **13-amps** should be used. If there is a fuse cover fitted, this cover must be re-fitted after changing the fuse. If the fuse cover is lost or damaged the plug must not be used. Spare fuse holders and fuses are available from electrical outlets. If the socket outlets in your home or office are not suitable for this product's plug, the plug must be removed and disposed of safely. Attempts to insert the plug into the wrong socket is likely to cause electric hazard. A replacement plug should be wired according to the following instructions:

The cable

A mains electricity cable contains two or three inner wires. Each has a core of copper and an outer layer of flexible plastic. This product is **earthed**; the wires in the cord set are colour coded in the following way:

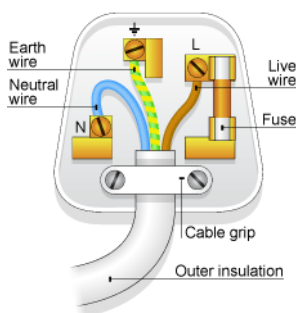



BLUE	NEUTRAL
BROWN	LIVE
GREEN & YELLOW	EARTH

The diagram below shows the key features of a correctly wired three-pin mains plug.

DISPOSAL

- Coopers of Stortford use recyclable or recycled packaging where possible.
- Please dispose of all packaging, paper, cartons, packaging in accordance with your local recycling regulations.
- Plastics, polybags – Contains the following recyclable plastic.



Code & Symbol		
Type of Plastic	Polypropylene	Please Specify (includes ABS, Nylon)
Commonly used for	Microwaveable food containers, yoghurt pots, butter tubs, disposable plates and cups	CD's, crisp packets, various flexible packaging, baby bottles, sunglass lenses

Notes	Commonly recycled and collected from household recycling bins (packaging tape itself not recyclable but does not interfere with cardboard)	Not often or widely recycled
-------	--	------------------------------

- At the end of the product's lifespan please check with your local council authorised household waste recycling centre for disposal.

