



Dimensions

Strap size: 24 x 3.2 x 2.0cm

- FITS MOST WRISTS
- EASY TO READ NUMBERS
- TRACKS MILES, STEPS AND CALORIES
- BPA FREE RUBBER
- CHOOSE YOUR COLOURS
- USES 1 BUTTON-CELL BATTERY (LR1130) (included)

ASSEMBLY INSTRUCTIONS / INSTRUCTIONS FOR USE:

Unpack the components carefully. Please check all parts have been removed from the packaging.

1. Function Description

1. Real time display(12-hour System)
2. Step counting ranging from 0 to 99999 steps.
3. Calorie calculation ranging from 0 to 999.9 KCAL.
4. Distance calculation ranging from 0 to 999.99 KM/Mile.
5. Body weight and Stride length setting:
Metric System (30 KG to 120 KG,30CM to200CM)
British System (70 LB to 250 LB,10 Inch to 80 Inch)
6. To shift between the metric and British system, just press and hold for 6 seconds under any mode.
7. Battery: LR1130 (included)



Set/Clear button Function switch button

Recommended to use on left wrist

Operations Description

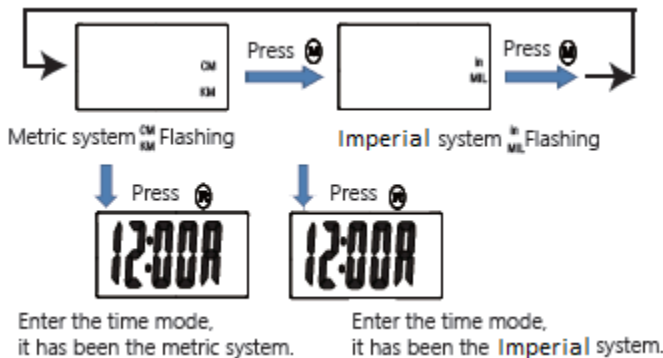

1. Shift between metric and Imperial settings.

2. Mode shifting and setting of body weight/stride length/time

Press [Mode] to shift the following modes in turn:

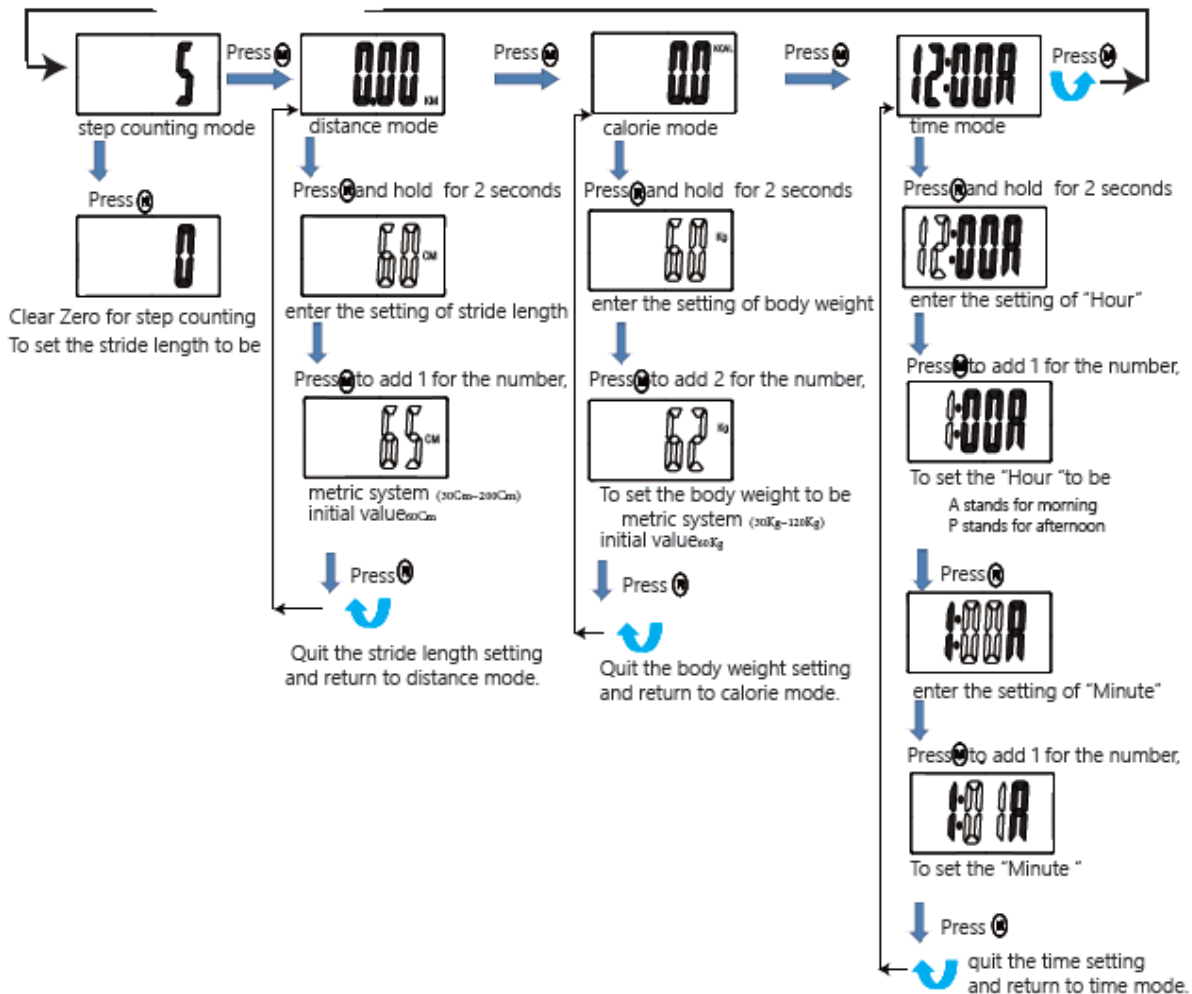

CARE AND CLEANING INSTRUCTIONS:

- Wipe with a clean dry cloth.

REPLACING THE BATTERY

Remove the black part from the strap and unscrew small screws to remove the battery.

BATTERIES

- Keep batteries away from children and pets.
- Do not mix used and new batteries.
- Install batteries in accordance with its polarity symbols.
- Remove the batteries if left for long periods.
- Never dispose of batteries in a fire.
- Battery disposal, spent or expired batteries must be properly disposed of and recycled in compliance with local regulations. For detailed information, contact your local authority.
- Follow the battery manufacturer's safety, usage, and disposal instructions.

DISPOSAL

- Coopers of Stortford use recyclable or recycled packaging where possible.
- Please dispose of all packaging, paper, cartons, packaging in accordance with your local recycling regulations.
- Plastics, polybags – this is made from the following recyclable plastic.



Code & Symbol	 OTHER
Type of Plastic	ABS/Silicone
Commonly used for	CD's, crisp packets, various flexible packaging, baby bottles, sunglass lenses
Notes	Not often or widely recycled

- At the end of the product's lifespan please check with your local council authorised household waste recycling centre for disposal.

