

H214 Set of 3 Spare Brush Heads for Power Patio Brush H062

Instructions for Use

Please read and retain these instructions for future reference

v001: 02/10/20



Roller Plastic Brush



Narrow Nylon Brush



Narrow Wire brush



ASSEMBLY INSTRUCTIONS / INSTRUCTIONS FOR USE:

Unpack the components carefully. Please check all parts have been removed from the packaging.

Operating Controls

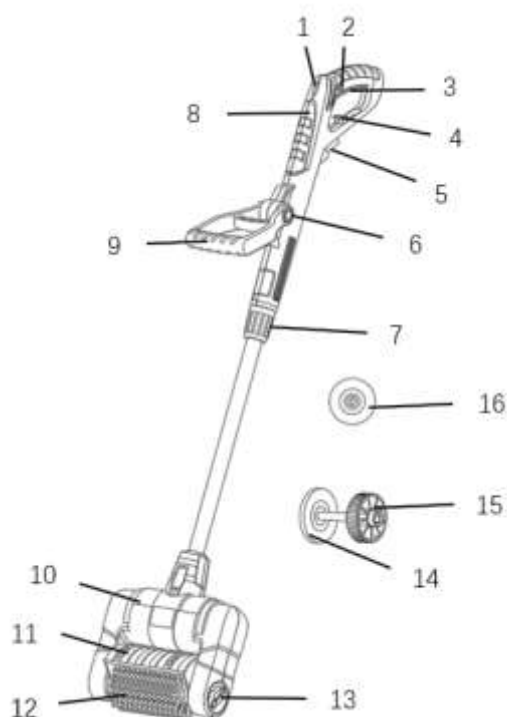

- 1 Speed regulator
- 2 Switch lock
- 3 Switch trigger
- 4 Cable holder
- 5 Cable
- 6 Angle adjustment button for auxiliary handle
- 7 Lock knob for length adjustment
- 8 Main handle
- 9 Auxiliary handle
- 10 Motor head
- 11 Splash guard
- 12 Roller plastic brush
- 13 Brush assembly knob
- 14 Narrow metal brush
- 15 Wheel
- 16 Narrow nylon brush

H214 Set of 3 Spare Brush Heads for Power Patio Brush H062

Instructions for Use

Please read and retain these instructions for future reference

v001: 02/10/20

Inserting / replacing the brush

A. Disassemble roller plastic brush (12), Refer to Fig.3

Press the knob (13) and turn it counter clockwise. You can pull out the knob and remove the roller plastic brush.

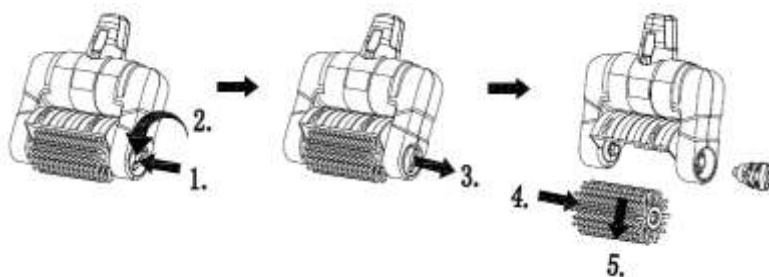

Fig. 3

B. Assemble the roller plastic brush or metal brush.



Please note that the size of hexagonal inner hole at both ends of brush is different. Refer to Fig.5

Press the knob (13) and then turn it clockwise, and release holder hand as the knob cover pops out and locks the brush.

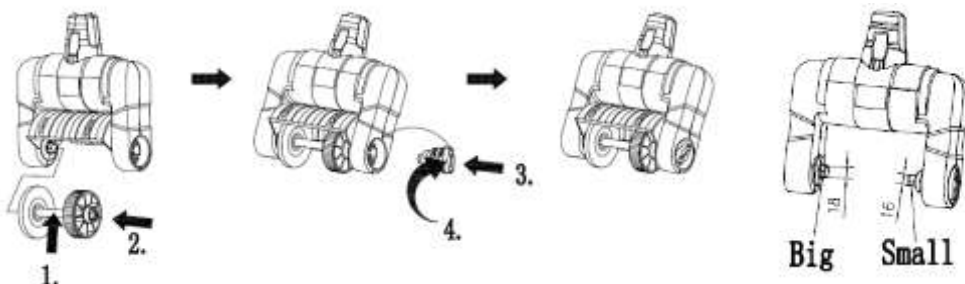

Fig. 4

Fig. 5

C. Assemble and replace the narrow metal and narrow plastic brush. Refer to Fig. 6

Use a cross screwdriver to release/fasten the screw to replace the brush.

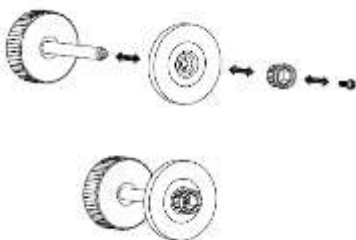

Fig. 6

H214 Set of 3 Spare Brush Heads for Power Patio Brush H062

Instructions for Use

Please read and retain these instructions for future reference

v001: 02/10/20

OPERATION



Caution, risk of injury!

Always check whether the device function correctly before using it.

Always wear eye protection when operating the device.



Always unplug the device before working on it. There is a risk of injury.



Observe the noise protection and other local regulations.

DISPOSAL

- Dispose of all packaging, paper, cartons, plastic and plastic bags in accordance with your local recycling regulations.
- Plastics – This is made from the following plastic.



Code & Symbol	
Type of Plastic	ABS, Nylon
Commonly used for	CD's, crisp packets, various flexible packaging, baby bottles, sunglass lenses
Notes	Not often or widely recycled

- At the end of the product's lifespan please dispose of it at an authorised household WEEE waste recycling centre.