

Easy Composter

H282 v01: 14/10/20

Please read and retain these instructions for future reference

GAINSBOROUGH
Garden & Wildlife



Dimensions

(D)61 x(W)61 x(H)83cm

- A SIMPLE AND EASY COMPOSTER THAT ANYONE CAN USE
- TURNS YOUR ORGANIC WASTE INTO VALUABLE GARDEN COMPOST
- DO YOUR BIT FOR LANDFILL!
- COMPOST HELPS TO ENRICH YOUR SOIL AND KEEP IT MOIST
- ADD IN VEGETABLE WASTE, LAWN CLIPPINGS, SHREDDED PAPER ETC AND WHEN IT IS MULCHED DOWN AND READY TO USE SIMPLY REMOVE FROM THE EASY ACCESS DOOR AT THE BASE
- LARGE 300L CAPACITY
- BUILT IN VENTS FOR INCREASED AIR CIRCULATION
- EASY LIFT UP LID

ASSEMBLY INSTRUCTIONS / INSTRUCTIONS FOR USE:

Unpack the components carefully. Please check all parts have been removed from the packaging.

Parts

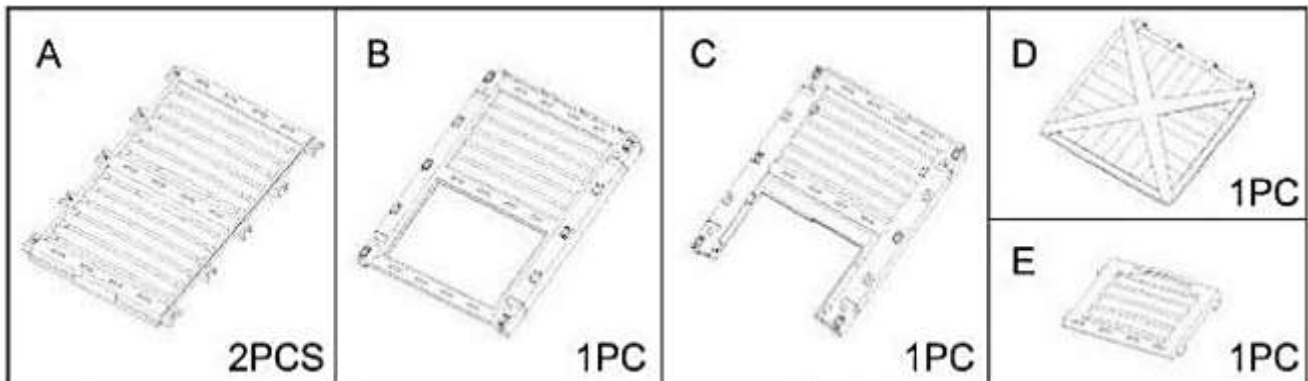

*Calls cost 7 pence per minute plus your telephone company's network access charge

The Enterprise Department
Head Office: 11 Bridge Street
Bishop's Stortford, CM23 2JU
Tel: 0844 482 4400*
Fax: 01279 756 595
www.coopersofstortford.co.uk

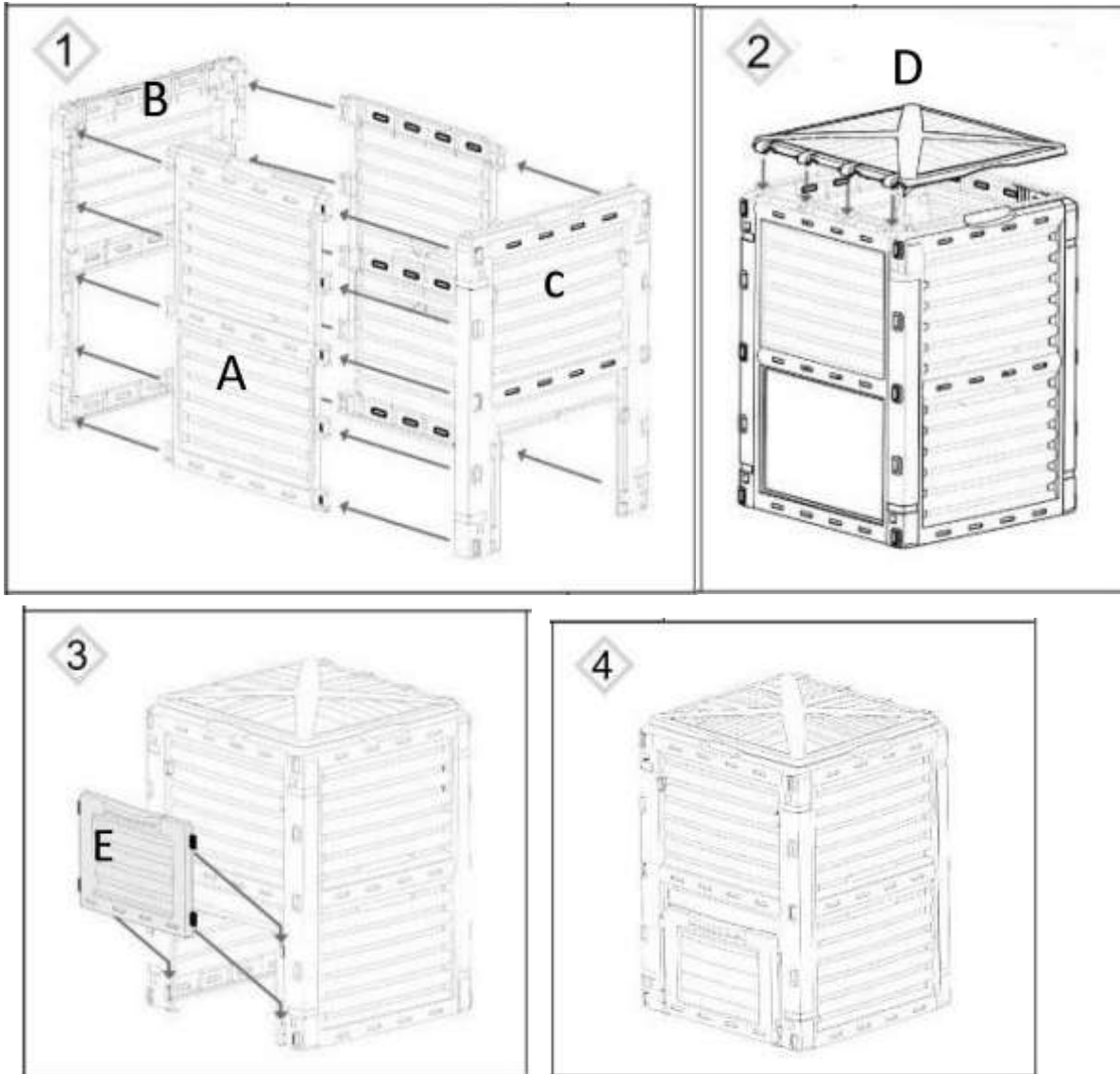

DISPOSAL

- Coopers of Stortford use recyclable or recycled packaging where possible.
- Please dispose of all packaging, paper, cartons, packaging in accordance with your local recycling regulations.
- Plastics, polybags – Contains the following recyclable plastic.



Code & Symbol	 5 PP
Type of Plastic	Polypropylene
Commonly used for	Microwaveable food containers, yoghurt pots, butter tubs, disposable plates and cups
Notes	Commonly recycled and collected from household recycling bins (packaging tape itself not recyclable but does not interfere with cardboard)

- At the end of the product's lifespan please check with your local council authorised household waste recycling centre for disposal.