



Dimensions

Size:18*16*13cm

3.7V 3000MAH 18650 liion battery (include)

Before using this product,please read it carefully and keep it properly.



Structure

Features



- 1:Indicator light
- 2:LED light touch screen
- 3:Mesh cloth
- 4:Adjusting button
- 5:Laser infrared
- 6:Vibration Area
- 7:Type-C power jack
- 8:Velcro

Button panel introduction

- LED light touch screen,clearly visible and easy to operate.
- Ergonomic design,fully wrapped to fit the knee joint.
- Vibration massage automatically shutdown within 2 minutes if no any operates.
- Built -in 3 infrared laser lights,carbon fiber hot compress.
- The buzzer prompts button is touched.
- 10 minutes timer.
- Low-grade heating 40 degrees,high-grade heating 45 degrees.

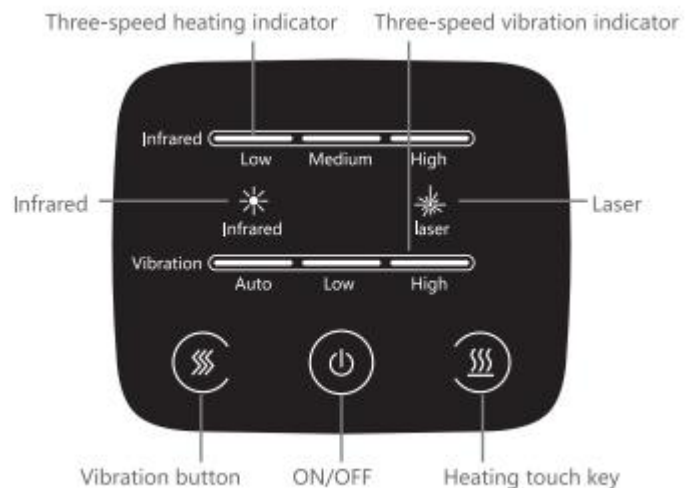

Instructions

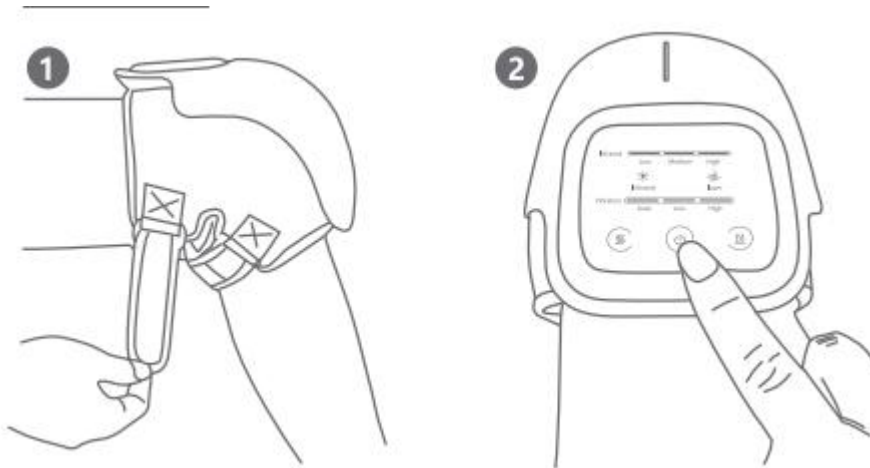

1. Put the product on your knees, fasten the product on your knees with a fixing strap, and pull the product against your knees near the fixed belt.
2. Long press "ON/OFF" to turn on the Auto mode (vibration mode, low-grade heating, infrared, and laser)
3. When powered on: Short press "vibration button" to

adjust the vibration mode (auto-low-high-turn off the vibration cycle in turn...), Light turn white.
 Short press "Heating touch key" to adjust the heating temperature (low-medium-high-close heating cycle in turn...), Light turn white.
 Short press "ON/OFF" to turn on and off the laser and infrared (turn on infrared-turn on the laser-turn off the infrared -turn off the laser cycle in turn ...), Light turn white.
 4. Long press "ON/OFF" to turn off the device.

Disposal

- Coopers of Stortford use recyclable or recycled packaging where possible.
- Please dispose of all packaging, paper, cartons, packaging in accordance with your local recycling regulations.
- Plastics, polybags-the handle is made from the following recyclable plastic.

Code & Symbol	 OTHER
Type of Plastic	ABS
Commonly used for	CD's, crisp packets, various flexible packaging, baby bottles, sunglass lenses
Notes	Not often or widely recycled

- At the end of the product's lifespan please check with your local council authorised household waste recycling centre for disposal.

