

Cordless Precision Screwdriver

H751 v01: 24/03/21

Please read and retain these instructions for future reference



Dimensions

(H) 17.5 x (W) 3.7 x(D) 3.5cm

- POWERFUL 3.6V Li-Ion RECHARGEABLE BATTERY
- HANDY FORWARD AND BACKWARD SWITCH SO YOU CAN EASILY SWITCH ROTATION FOR BOTH SCREWING AND UNSCREWING.
- USB CHARGING PORT AND CABLE (CABLE INC)
- 5 TORQUE SETTINGS
- BUILT IN LED LIGHT SO YOU CAN SEE EVEN IN THE DARKEST SPOTS
- AUTO AND MANUAL USE
- SOFT GRIP AND THANKS TO ITS STRAIGHT SHAPE IT ALSO HELPS RELIEVE HAND STRAIN
- CHARGING TIME 3 HOURS
- BATTERY INDICATOR

Technical data

CORDLESS SCREWDRIVE	KCS217
Battery	1.5Ah Lithium
Chuck Size:	1/4" (6,35mm)
No-load speed	300 RPM
Max Torque	2,5-3 Nm
Adjustable 5 torque setting	
Charge time	3~5 h
Single weight	246g
size:	17,5X3,7X3,5CM
Auto + manual use	
Manual torque	10NM

Sound power level L_{WA} (dB(A)).....: $L_{WA}=64,8$ dB(A), $k=3$ dB(A)

Sound pressure level L_{PA} (dB(A)).....: $L_{PA}=53,8$ dB(A), $k=3$ dB(A)

*Calls cost 7 pence per minute plus your telephone company's network access charge

The Enterprise Department
Head Office: 11 Bridge Street
Bishop's Stortford, CM23 2JU
Tel: 0844 482 4400*
Fax: 01279 756 595
www.coopersofstortford.co.uk

General power tool safety warnings



WARNING Read all safety warnings, instructions, illustrations and specifications provided with this power tool. Failure to follow all instructions listed below may result in electric shock, fire and/or serious injury.

Save all warnings and instructions for future reference.

The term "power tool" in the warnings refers to your mains-operated (corded) power tool or battery-operated (cordless) power tool.

1) Work area safety

- a) Keep work area clean and well lit. Cluttered or dark areas invite accidents.
- b) Do not operate power tools in explosive atmospheres, such as in the presence of flammable liquids, gases or dust. Power tools create sparks which may ignite the dust or fumes.
- c) Keep children and bystanders away while operating a power tool. Distractions can cause you to lose control.

2) Electrical safety

- a) Power tool plugs must match the outlet. Never modify the plug in any way. Do not use any adapter plugs with earthed (grounded) power tools. Unmodified plugs and matching outlets will reduce risk of electric shock.
- b) Avoid body contact with earthed or grounded surfaces, such as pipes, radiators, ranges and refrigerators. There is an increased risk of electric shock if your body is earthed or grounded.
- c) Do not expose power tools to rain or wet conditions. Water entering a power tool will increase the risk of electric shock.
- d) Do not abuse the cord. Never use the cord for carrying, pulling or unplugging the power tool. Keep cord away from heat, oil, sharp edges or moving parts. Damaged or entangled cords increase the risk of electric shock.
- e) When operating a power tool outdoors, use an extension cord suitable for outdoor use. Use of a cord suitable for outdoor use reduces the risk of electric shock.
- f) If operating a power tool in a damp location is unavoidable, use a residual current device (RCD) protected supply. Use of an RCD reduces the risk of electric shock.

3) Personal safety

- a) Stay alert, watch what you are doing and use common sense when operating a power tool. Do not use a power tool while you are tired or under the influence of drugs, alcohol or medication. A moment of inattention while operating power tools may result in serious personal injury.
- b) Use personal protective equipment. Always wear eye protection. Protective equipment such as a dust mask, non-skid safety shoes, hard hat or hearing protection used for appropriate conditions will reduce personal injuries.
- c) Prevent unintentional starting. Ensure the switch is in the off-position before connecting to power source and/or battery pack, picking up or carrying the tool. Carrying power tools with your finger on the switch or energising power tools that have the switch on invites accidents.

- d) Remove any adjusting key or wrench before turning the power tool on. A wrench or a key left attached to a rotating part of the power tool may result in personal injury.
- e) Do not overreach. Keep proper footing and balance at all times. This enables better control of the power tool in unexpected situations.
- f) Dress properly. Do not wear loose clothing or jewellery. Keep your hair and clothing away from moving parts. Loose clothes, jewellery or long hair can be caught in moving parts.
- g) If devices are provided for the connection of dust extraction and collection facilities, ensure these are connected and properly used. Use of dust collection can reduce dust-related hazards.

4) Power tool use and care

- a) Do not force the power tool. Use the correct power tool for your application. The correct power tool will do the job better and safer at the rate for which it was designed.
- b) Do not use the power tool if the switch does not turn it on and off. Any power tool that cannot be controlled with the switch is dangerous and must be repaired.
- c) Disconnect the plug from the power source and/or remove the battery pack, if detachable, from the power tool before making any adjustments, changing accessories, or storing power tools. Such preventive safety measures reduce the risk of starting the power tool accidentally.
- d) Store idle power tools out of the reach of children and do not allow persons unfamiliar with the power tool or these instructions to operate the power tool. Power tools are dangerous in the hands of untrained users.
- e) Maintain power tools and accessories. Check for misalignment or binding of moving parts, breakage of parts and any other condition that may affect the power tool's operation. If damaged, have the power tool repaired before use. Many accidents are caused by poorly maintained power tools.
- f) Keep cutting tools sharp and clean. Properly maintained cutting tools with sharp cutting edges are less likely to bind and are easier to control.
- g) Use the power tool, accessories and tool bits etc. in accordance with these instructions, taking into account the working conditions and the work to be performed. Use of the power tool for operations different from those intended could result in a hazardous situation.

5) Battery tool use and care

- a) Recharge only with the charger specified by the manufacturer. A charger that is suitable for one type of battery pack may create a risk of fire when used with another battery pack.
- b) Use power tools only with specifically designated battery packs. Use of any other battery packs may create a risk of injury and fire.
- c) When battery pack is not in use, keep it away from other metal objects, like paper clips, coins, keys, nails, screws or other small metal objects, that can make a connection from one terminal to another. Shorting the battery terminals together may cause burns or a fire.
- d) Under abusive conditions, liquid may be ejected from the battery; avoid contact. If contact accidentally occurs, flush with water. If liquid contacts eyes, additionally seek medical help. Liquid ejected from the battery may cause irritation or burns.

6) Service

- a) Have your power tool serviced by a qualified repair person using only identical replacement parts. This will ensure that the safety of the power tool is maintained.

Hold the power tool by insulated gripping surfaces, when performing an operation where the cutting accessory may contact hidden wiring.

Cutting accessory contacting a "live" wire may make exposed metal parts of the power tool "live" and could give the operator an electric shock.

Symbols



Read instruction manual.

Residual risks

Even if you use this product in compliance with all safety requirements, the potential risks of injury and damage remain. The following hazards may arise in the structure and design of this product:

- There are harmful health consequences resulting from the emission of vibrations if the product is used for long periods of time or not properly managed and properly maintained.
- There is risk of injury and property damage due to damaged attachments.

Intended use

The cordless screwdriver is designed to driving or removes screws, by using accessories. Do not use this tool for other purposes.

Parts

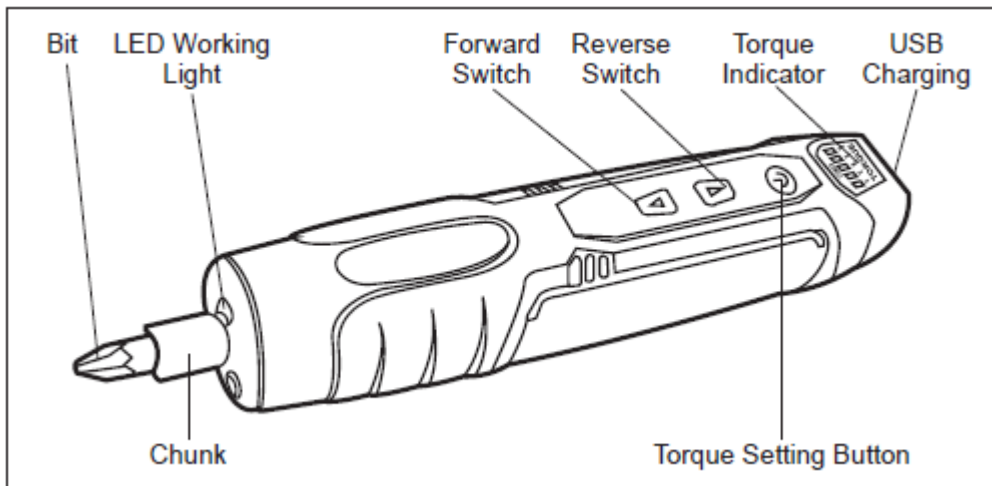

Charging

Make sure that the tool is switched off (the torque indicator is turned off).
(Please note it is forbidden to use when in charging.)

For the first use of this tool, please fully charge it for 5 hours for optimum battery power.

- Plug the USB cable into the tool.
- Plug the correct charger to a USB port. Charge will start automatically(LED red light will be on).

- Unplug the tool when the charging is finished. (all 5 LED red light will be on)

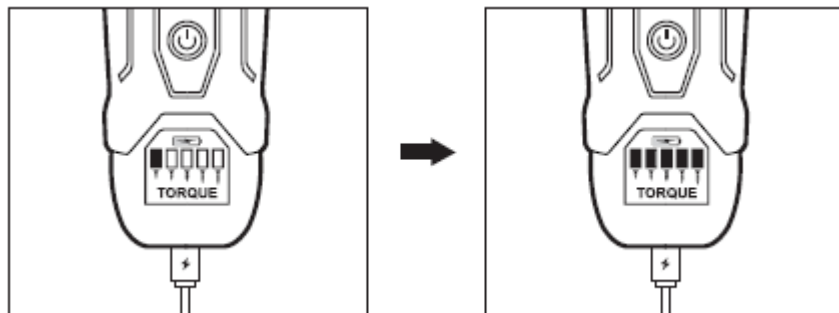

Bit installation

Put the bit into the chuck.

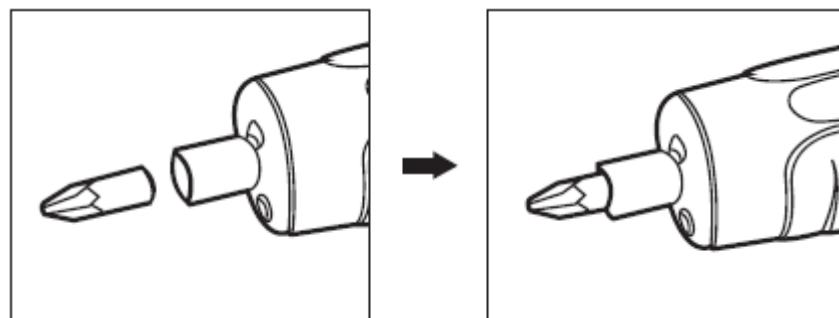

Left/Right Switch

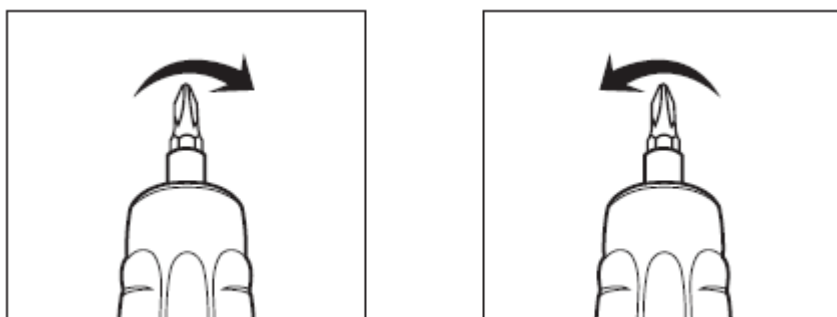

To drill / fix screws, press the switch on the top and the screwdriver will rotate to the right.
To unscrew screws, press the lower part of the switch the screwdriver will turn to the left.



Torque adjustment

There are 5 torque settings for different tasks. If you press the bottom red button that's how you change the torque the light will show which one you are using.

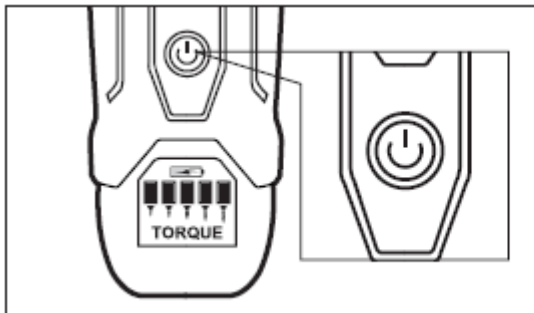

Torque setting button

LED Power indicator

Keep press the power button over 3 seconds, LED power indicator will show how charge there is left.

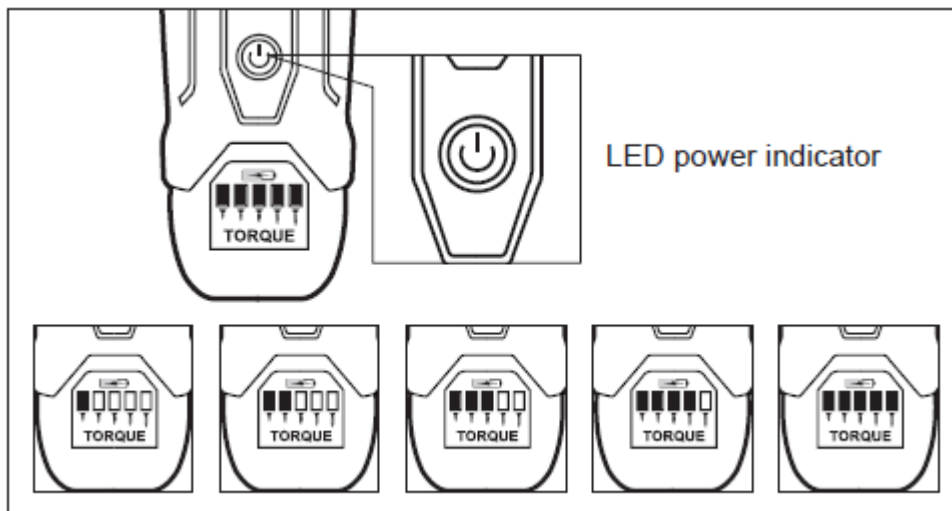

LED power indicator

The screwdriver will automatically power off after it has not been used for 5mins.

Manual Operation

Your Precision Screwdriver has an automatic "axis locking" function when the torque gear is not set. This allows you to use it as a 'manual' screwdriver to undo very tight screws.

MAINTENANCE AND STORAGE

a.Maintenance

- Clean the housing only with a damp cloth. Do not use solvents! Then wipe thoroughly.
- Check the condition of the tool. If the tool is damaged or has malfunction, do not use it and bring it to a qualified service for inspection or repair.

b.Storage

Store the tool in a dry place and protected from freezing, the ambient temperature should not Exceed 50°C. Put it out of the reach of children.



BATTERIES

- Keep batteries away from children and pets.
- Do not mix used and new batteries.
- Remove the batteries if left for long periods.
- Never dispose of batteries in a fire.
- Battery disposal, spent or expired batteries must be properly disposed of and recycled in compliance with local regulations. For detailed information, contact your local authority.
- Follow the battery manufacturer's safety, usage, and disposal instructions.

DISPOSAL

- Coopers of Stortford use recyclable or recycled packaging where possible.
- Please dispose of all packaging, paper, cartons, packaging in accordance with your local recycling regulations.
- Plastics, polybags – Contains the following recyclable plastic.



Code & Symbol	Type of Plastic	Commonly used for	Notes
 OTHER Machine	ABS (Acrylonitrile butadiene styrene) PVE (Polyvinyl ether)	CD's, crisp packets, various flexible packaging, baby bottles, sunglass lenses	Not often or widely recycled
 OTHER Bags	PE (Polyethylene)		

- At the end of the product's lifespan please check with your local council authorised household waste recycling centre for disposal.