

Drain Cleaner

H792 v01: 28/10/22

Please read and retain these instructions for future reference



Dimensions

27 x 27 x 8.5cms

- Clears blocked drains
- Comes with 4 adapters to be used for a variety of plug sizes (sink, bath, shower) and toilets
- More efficient way of drain cleaning without using harsh chemicals or risking damage to pipes
- Easy to use

Accessories: 5cm, 6cm, 11.5cm, 18cm suckers which can be used in toilet, washbasin, bathtubs, shower, sink, floor drain, blocked pipes etc. 1pc PE film size around 50 x 50cm to protect from splashing.

How to use

1. Usage should be based on the size of the blocked pipe diameter, select the appropriate attachment from the four different sizes. For the toilet choose the largest or the second largest plug mouth.
2. After the attachment is installed, you can start to inflate the air reservoir by holding the handle firmly in your left hand and pumping the air pump lever with your right hand completing several full stroke twitches at least 15-25 times until the pressure is complete.

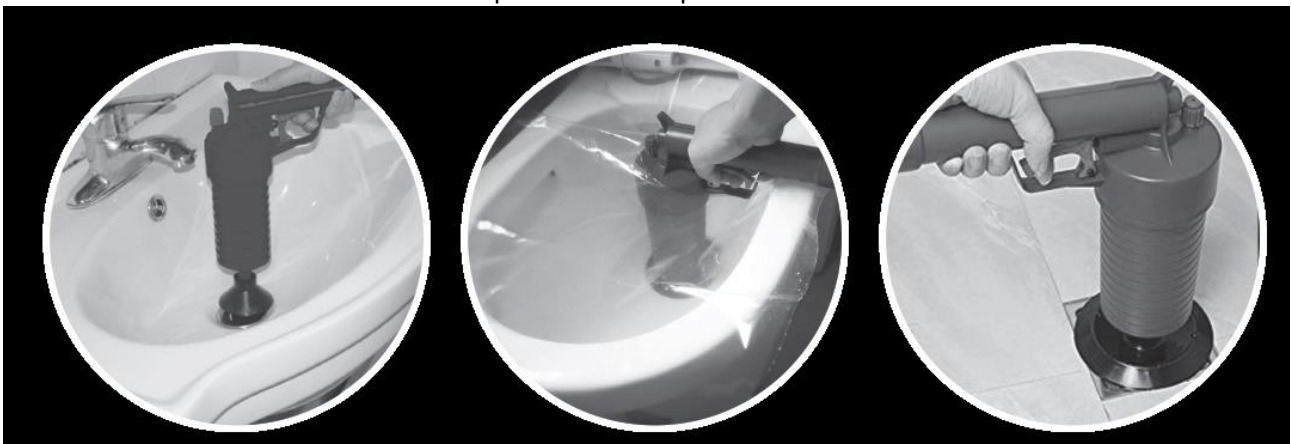

3. The attachment needs to sit tight on the small nozzle, if not closed, add water and diffuse the water through the nozzle to seal. At this point use the trigger for air flow. Obstacles in the drain should be washed away by strong air flow. This operation can be repeated several times.

**COOPERS
OF STORTFORD**

UK Head Office, 11 Bridge Street, Bishop's Stortford, CM23 2JU

Tel: 0844 4824400*, Fax: 01279 756595

www.coopersofstortford.co.uk

EU address: D.S.B. LD, 160 Bd. de Fourmies, 59100 Roubaix, France

Tel: (+44) 1279 701269

*UK Calls cost around 7 pence per minute plus your telephone company's network access.

Please check with your telephone supplier.

Important

The sucker mouth and pipe mouth or pipe mouth need to seal tightly otherwise it will leak. You can add a little water so that the sucker is completely immersed in water.



Cleaning and Maintenance

- Clean adapters after each use.

DISPOSAL

- Coopers of Stortford use recyclable or recycled packaging where possible.
- Please dispose of all packaging, paper, cartons, packaging in accordance with your local recycling regulations.
- Plastics– Contains the following recyclable plastic.



Code & Symbol	 PVC	 PP	 OTHER
Type of Plastic	Polyvinyl Chloride (black parts)	Polypropylene (item body)	ABS (Internal parts)
Commonly used for	Pipes, construction material, flooring, windows, guttering, plaster packs	Microwaveable food containers, yoghurt pots, butter tubs, disposable plates and cups	CD's, crisp packets, various flexible packaging, baby bottles, sunglass lenses
Notes	Not usually collected from household recycling bins, Sometimes recycled at local waste management centres.	Commonly recycled and collected from household recycling bins (packaging tape itself not recyclable but does not interfere with cardboard)	Not often or widely recycled

- At the end of the product's lifespan please check with your local council authorised household waste recycling centre for disposal.