

Lightweight Carpet Cleaner

K044 v02: 29/04/22

Please read and retain these instructions for future reference

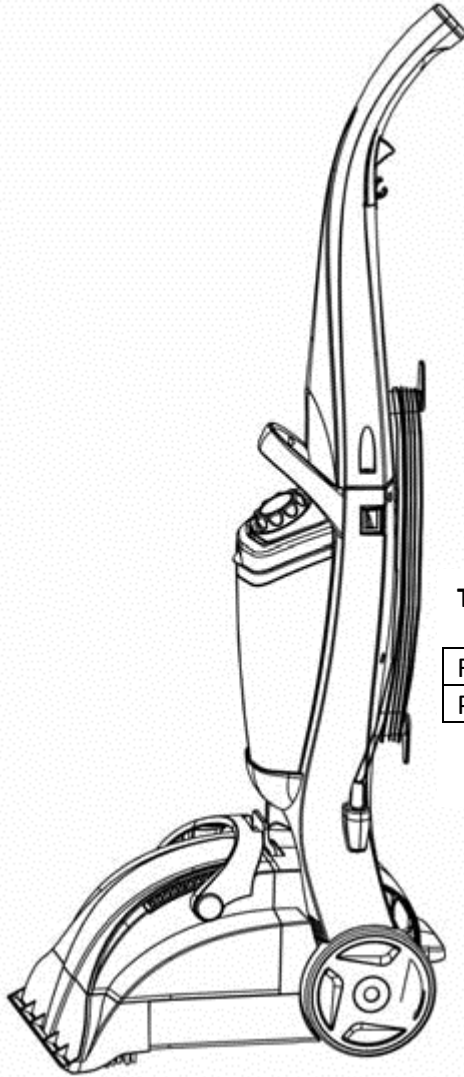

Dimensions

108 x25 x42cm

- 600W
- 2.5L CLEAN WATER TANK
- 1.5L DIRTY WATER TANK
- 6M POWER CORD
- PRODUCT WEIGHT: 5.72kg
- DETATCHABLE TANK
- LARGE TANK CAPACITY, SO YOU WON'T HAVE TO KEEP STOPPING TO REFILL OR EMPTY THE CLEANER.
- THE CLEANER IS EASY TO MOVE AROUND YOUR HOME THANKS TO ITS LIGHTWEIGHT DESIGN AND LONG POWER CORD.

Technical data

Rated Voltage	220-240V a.c. 50/60Hz
Power Consumption	600 Watts

ASSEMBLY INSTRUCTIONS / INSTRUCTIONS FOR USE:

Unpack the components carefully. Please check all parts have been removed from the packaging.

Contents:

- 1x Carpet Washer
- 1x Handle
- 1x Instruction Manual

**The Enterprise
Department**

UK Head Office, 11 Bridge Street, Bishop's Stortford, CM23 2JU

Tel: 0844 4824400*, Fax: 01279 756595

www.coopersofstortford.co.uk

EU address: D.S.B. LD, 160 Bd. de Fourmies, 59100 Roubaix, France

Tel: (+44) 1279 701269

*UK Calls cost around 7 pence per minute plus your telephone company's network access.
Please check with your telephone supplier.

WARNINGS AND SAFETY INSTRUCTIONS:

- READ ALL INSTRUCTIONS BEFORE USE
- FOR DOMESTIC INDOOR USE ONLY.
- BEFORE USE, CHECK THOROUGHLY FOR ANY DEFECTS AND DO NOT USE IF DEFECTS ARE FOUND. TAKE CARE NOT TO DROP THE APPLIANCE AS HEAVY IMPACTS MAY CAUSE INTERNAL DAMAGE.
- BEFORE CONNECTING THE APPLIANCE, CHECK IF THE VOLTAGE INDICATED ON THE BOTTOM OF THE APPLIANCE IS IN ACCORDANCE WITH THE MAINS VOLTAGE IN YOUR HOME.
- DO NOT PLACE ON OR NEAR HEAT SOURCES.
- USE ON A LEVEL, STABLE SURFACE.
- THERE ARE NO USER SERVICEABLE PARTS. IF A FAULT DEVELOPS, STOP USING THIS IMMEDIATELY AND DESTROY SAFELY. IF FAULT IS WITHIN THE GUARANTEE CONDITIONS THEN PLEASE RETURN TO THE RETAILER FOR REPLACEMENT OR REFUND.
- ROUTE THE POWER CABLE SO THAT IT WILL NOT GET WALKED ON OR PULLED TO AVOID TRIP HAZARDS.
- DO NOT ALLOW CHILDREN TO PLAY WITH THIS UNIT. IT IS NOT A TOY.
- THIS APPLIANCE CAN BE USED BY CHILDREN AGED FROM 8 YEARS AND ABOVE, AND PERSONS WITH REDUCED PHYSICAL, SENSORY OR MENTAL CAPABILITIES OR LACK OF EXPERIENCE AND KNOWLEDGE ONLY IF THEY HAVE BEEN GIVEN SUPERVISION OR INSTRUCTION CONCERNING USE OF THE APPLIANCE IN A SAFE WAY AND UNDERSTAND THE HAZARDS INVOLVED. CHILDREN SHALL NOT PLAY WITH THE APPLIANCE. CLEANING AND USER MAINTENANCE SHALL NOT BE MADE BY CHILDREN WITHOUT SUPERVISION.
- CHILDREN OF LESS THAN 3 YEARS SHOULD BE KEPT AWAY UNLESS CONTINUOUSLY SUPERVISED.
- THE UNIT IS NOT INTENDED TO BE OPERATED BY MEANS OF AN EXTERNAL TIMER, DIMMER SWITCH OR SEPARATE REMOTE-CONTROL SYSTEM.
- DO NOT COVER THE ITEM IN ANY WAY WHEN IN USE AS THIS MAY CAUSE OVERHEATING.
- DO NOT USE THIS APPLIANCE FOR ANY OTHER USE THAN THE INTENDED USE IT IS DESIGNED FOR.
- TO PROTECT AGAINST ELECTRIC SHOCK, DO NOT IMMERSE POWER CABLE, PLUG OR APPLIANCE, IN WATER OR ANY OTHER LIQUID. DO NOT ALLOW THE UNIT TO GET WET.
- UNPLUG FROM OUTLET WHEN NOT IN USE AND BEFORE CLEANING.
- DO NOT OPERATE ANY APPLIANCE WITH A DAMAGED POWER CABLE OR PLUG OR AFTER THE APPLIANCE MALFUNCTIONS, OR HAS BEEN DAMAGED IN ANY MANNER. WE RECOMMEND THAT THE POWER CABLE IS NOT KINKED OR STORED IN A TWISTED MANNER, AND THAT YOU REGULARLY CHECK ITS CONDITION.

Parts

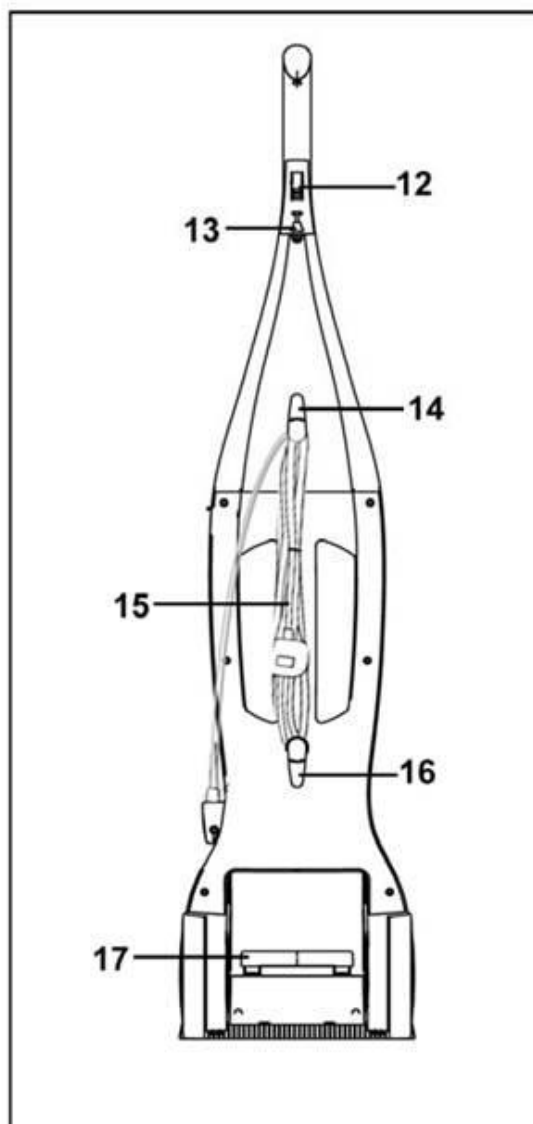
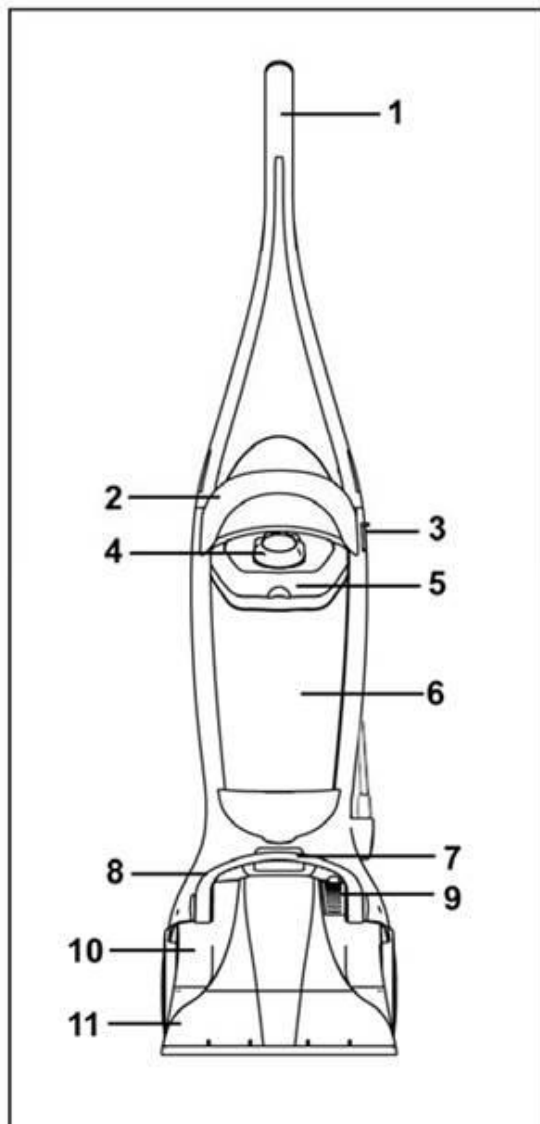

- | | |
|------------------------------------|---------------------------------|
| 1. Handle | 10. Dirty Water Tank |
| 2. Carry Handle | 11. Brush Bar |
| 3. On / Off Switch | 12. Clean Water Release Trigger |
| 4. Clean Water Tank Cap | 13. Power cord tidy |
| 5. Clean Water Tank release handle | 14. Power cord Holder Upper |
| 6. Clean Water Tank | 15. Power Cord |
| 7. Dirty Water Tank Locking Latch | 16. Power Cord Holder Lower |
| 8. Dirty Water Tank Handle | 17. Handle Release pedal |
| 9. Exhaust Filter | |

**The Enterprise
Department**

UK Head Office, 11 Bridge Street, Bishop's Stortford, CM23 2JU

Tel: 0844 4824400*, Fax: 01279 756595

www.coopersofstortford.co.uk

EU address: D.S.B. LD, 160 Bd. de Fourmies, 59100 Roubaix, France

Tel: (+44) 1279 701269

*UK Calls cost around 7 pence per minute plus your telephone company's network access.
Please check with your telephone supplier.

Assembly

Note: Do not plug the power cord into an electrical outlet until the machine is fully assembled.

1. Carefully unpack all components and set aside the packaging.
2. Lift the carpet washer to the upright position.
3. Align the handle with the groove and insert onto body. If necessary, use thumb and finger pressure to slide handle into position.
4. Once the handle is in place, secure the handle to the body with the two screws supplied (Fig. 1)

Caution: Do not over tighten. Over tightening could strip the screw holes. Do not operate the vacuum without the handle screws in place.

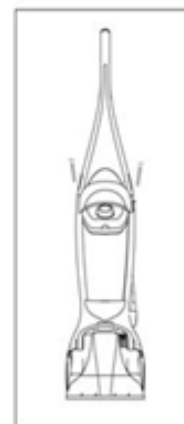

Figure 1

CARPET PREPARATION

IMPORTANT: Do not use the carpet washer as a dry vacuum.

1. Vacuum your carpet thoroughly. Ensure it is cleaned before you shampoo.
2. Remove as much furniture from the room as possible. If unable to remove the furniture, place plastic or foil under and around

HELPFUL HINTS FOR CLEANING CARPET:

1. Use only Low Foaming Cleaning solution with this carpet washer.
2. Do not over saturate the carpet with cleaning solution while using the carpet washer.
3. For heavily soiled areas, additional applications may be necessary.
4. Allow plenty of time to dry the carpet thoroughly.
5. Wipe the cleaning solution from woodwork and furniture to prevent any damage.
6. Try not to walk on the carpet until after the carpet is thoroughly dry, vacuum the carpet using a vacuum cleaner with a revolving brush bar.
7. Before cleaning, determine where to start and end, making sure not to walk over previously cleaned areas.

CHECK FOR COLOUR FASTNESS:

Before cleaning the carpet, test for colour fastness. Dampen a white cloth with solution and test a small area in a closet. Gently rub the cloth over the area. Check each colour for colour bleeding. If the cloth remains clean, it should be safe to clean the carpet.

AFTER CLEANING:

Allow the carpet to dry completely. Try not to walk on the carpet until it is dry. If it is necessary to walk on the carpet, place white towels on the areas to be walked on. If the carpet is not dry and the furniture must

be placed back in the room, use plastic or foil under the furniture to prevent staining the carpet. Thoroughly clean the dirty water tank with warm (max 40°C) tap water.

OPERATION

Operating Instructions

1. Hold the clean water tank and lift the Water Tank Release Handle' upwards. Tilt the Water Tank away from the carpet washer and remove.

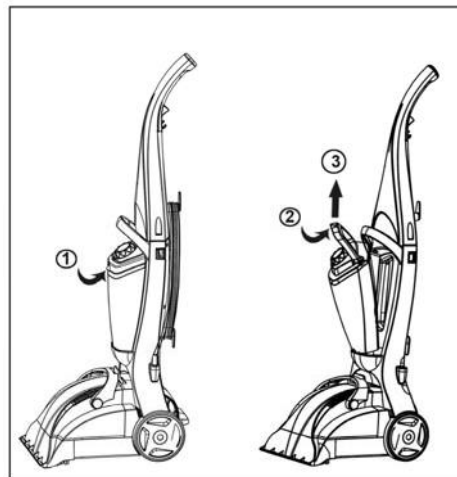

2. Unscrew the filler cap and add cleaning solution and water. Use only 1 capful of cleaning solution per full tank.

IMPORTANT: Use only suitable Carpet Cleaner solution. Using incorrect cleaning solutions may cause excess foaming. Excessive foam will prevent the machine from working effectively

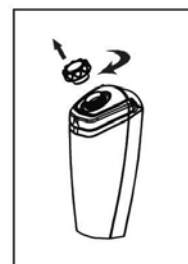

3. Fill remainder of clean water tank with warm (max 40°C) tap water. Replace cap.
4. Place Clean Water Tank back to original position and press down release handle for security.



Caution: Do not use the Carpet Washer without the Clean Water Tank in position

Carpet Cleaner Use

1. Plug cord into electrical socket. Turn on the machine by using the on/off switch located on the side of the machine.

IMPORTANT: Never leave unit unattended with power on. Turn off when emptying and filling tanks. Do not over-saturate the carpet.

Step on the handle release pedal to lower the machine into the cleaning position. While pressing the trigger, pull carpet washer in a backward motion. Release the trigger and push the unit forward in the same path to agitate and remove dirty water and solution from the carpet. (For heavily soiled areas, repeat if necessary).



IMPORTANT:

- For best cleaning results use a steady, moderate, forward and backward motion. Always work from back to front across the room to avoid stepping on wet carpet and lowering the pile.
- Do not make the carpet too wet! Use no more than two sets of forward and backward strokes while releasing solution. Always follow with dry strokes; the more the better
- Allow carpet to dry. Avoid walking on the carpet until it is dry. Increased air circulation (open doors, turn on fans, etc.) or use of a dehumidifier will help carpet dry thoroughly and prevent the growth of mould or mildew.
- Vacuum the carpet thoroughly before washing the carpet and after it has dried.

Emptying the Recovery Tank

An automatic shut-off device prevents the extractor from picking up more dirty water than it can hold in the recovery tank. You will know the tank needs to be emptied:

- When the motor sound rises in pitch.
- You do not see dirty solution coming up through the recovery tank lid.
- The float inside the recovery tank has risen to the top of the tank and is visible through the transparent tank.

1. Unplug the appliance from the electrical outlet.
2. Unlock the Recovery tank by lifting the dirty water tank latch and remove from the base unit using the handle

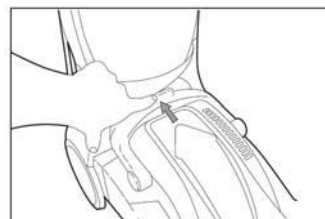

1. Twist the outlet cap to the left and remove, empty, rinse and replace.

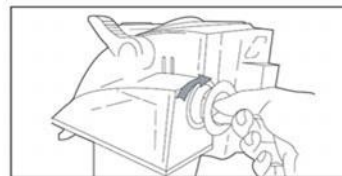

Maintenance of Filters

1. Always disconnect from the power supply when not in use. Always empty and rinse out the solution tank and recovery tanks after use. Remember to refit the filler cap to the solution tank. Do not allow water to sit in any of the tanks when not in use.
2. Remove the dirty water tank, rinse with warm water and allow it to dry before storage. Also, remove the exhaust filter (as shown) rinse with warm water and allow it to dry thoroughly before storing.

IMPORTANT: Do not use chemicals when cleaning this filter and clean after each use.

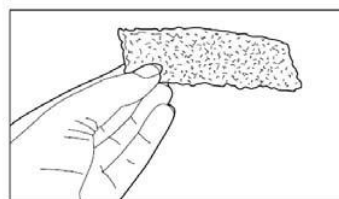
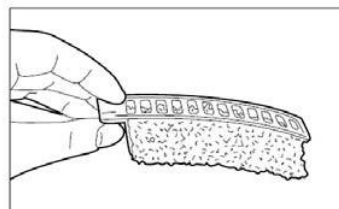
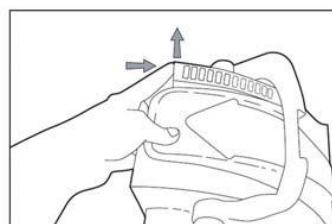

3. Remove the recovery tank, to access the motor filter. Remove the motor filter and rinse with warm water. Dry thoroughly before replacing.

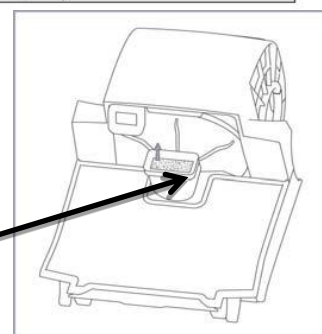

MAINTENANCE

Regular maintenance of your appliance will keep it safe and in proper operational order.

**The Enterprise
Department**

UK Head Office, 11 Bridge Street, Bishop's Stortford, CM23 2JU

Tel: 0844 4824400*, Fax: 01279 756595

www.coopersofstortford.co.uk

EU address: D.S.B. LD, 160 Bd. de Fourmies, 59100 Roubaix, France

Tel: (+44) 1279 701269

*UK Calls cost around 7 pence per minute plus your telephone company's network access.
Please check with your telephone supplier.

Before Cleaning

When not in use or before cleaning, always disconnect the appliance from the mains supply.

Never immerse the motor unit in water or any other fluid, not rinse it under the tap. Use only a moist cloth to clean the motor unit.

Cleaning

- Regularly clean the outside of the appliance with a soft damp cloth and dry it with a dry towel.
- Do not use harsh solvents to clean the plastic.
- Do not store the cleaner with solution in the clean water tank or dirty water in the dirty water tank. Mineral deposits and mildew can form which will affect the performance of the carpet washer on next use.
- After cleaning, let them dry by air, and then store your appliance and all its accessories and instruction manual in a safe and dry place

CARPET CLEANING SOLUTION

Use any commonly available low foaming carpet cleaner, shampoo or detergent suitable for use in carpet extraction cleaning machines and follow the manufacturer's instructions on the bottle.

CAUTION: Do not use any solvents, cleaners with strong acidic or strong alkali formulas or any type of cleaning solution not specifically for use in carpet extraction cleaning machines.

CAUTION: Keep Carpet Cleaning Solution out of reach of children.

In case of contact with eyes, rinse immediately with plenty of water and seek medical advice. As with all detergents, people with sensitive or damaged skin should avoid prolonged contact with the product.

TROUBLESHOOTING

Problem	Solution
Cleaner won't run	1. Check electrical plug.

	2. Check the fuse or breaker.
Lower suction during floor cleaning	1. Empty the recovery tank; it may be full and the automatic shut-off engaged. 2. Make sure recovery tank is properly installed.
Cleaning solution won't dispense	1. Make sure solution tank is fully inserted and securely in place. 2. Refill the solution tank if it is empty

PLUG WIRING (UK & IRELAND)

This appliance is fitted with a moulded BS 1363 13-amp plug. This is fitted with a 13 amp fuse. If you have to replace the fuse, only those that are ASTA or BSI approved to BS1362 should be used. If there is a fuse cover fitted, this cover must be re-fitted after changing the fuse. If the fuse cover is lost or damaged the plug must not be used. Spare fuse holders and fuses are available from electrical outlets. If the socket outlets in your home or office are not suitable for this product's plug, the plug must be removed and disposed of safely. Attempts to insert the plug into the wrong socket is likely to cause electric hazard.

DISPOSAL

- Coopers of Stortford use recyclable or recycled packaging where possible.
- Please dispose of all packaging, paper, cartons, packaging in accordance with your local recycling regulations.
- Plastics, polybags – Contains the following recyclable plastic.



Code & Symbol	 OTHER
Type of Plastic	ABS
Commonly used for	CD's, crisp packets, various flexible packaging, baby bottles, sunglass lenses
Notes	Not often or widely recycled

- At the end of the product's lifespan please check with your local council authorised household waste recycling centre for disposal.

