

Bronze Solar Light Up Bird Feeder

K214 v001: 09/08/21

Please read and retain these instructions for future reference

GAINSBOROUGH
Garden & Wildlife



ALWAYS POSITION IN DIRECT SUNLIGHT

Dimensions

(H) 21 x (W) 19 x (D) 19cm

Composition: Metal with powder coating

- PEANUT BIRD FEEDER
- DRAINAGE HOLES
- SOLAR LIGHT
- AMORPHOUS SILICON SOLAR PANEL – 1.2V AA 300MAH NI-MH
- (OFFERS HIGHER EFFICIENCY, CAN STAND HIGHER TEMPERATURES WITHOUT BEING AFFECTED AND PREFORMS BETTER IN LOW LIGHT CONDITIONS)
- WARM WHITE LED (not replaceable)
- CHAIN IS 19 CM LONG
- 18 X 18 X 38 CM FULL DIMENSION

Requires: 1.2V AA 300 mAh NI-MH battery (included)

ASSEMBLY INSTRUCTIONS / INSTRUCTIONS FOR USE:

Unpack the components carefully. Please check all parts have been removed from the packaging.

Find an ideal Place for the Solar Light.

Place the solar light in an area where it will receive direct sunlight for at least 8 hours per day. The number of hours the light will illuminate is directly proportional to the hours of sunlight it receives. If the light is placed in a shaded area, it will not be able to fully charge and its illumination time will be limited. Do not place the light near other outdoor lighting like porch or streetlights. These may fool the sensor and keep the light from coming on, or cause it to turn off automatically.

- Place your feeder in a quiet place where it can be seen and is easy to refill.
- Place your feeder near trees or shrubs to have birds rest between meals.
- Hang feeder at least 1m from windows to prevent birds from accidentally colliding into windows.
- Outdoor use only.

*Calls cost 7 pence per minute plus your telephone company's network access charge

The Enterprise Department
Head Office: 11 Bridge Street
Bishop's Stortford, CM23 2JU
Tel: 0844 482 4400*
Fax: 01279 756 595
www.coopersofstortford.co.uk

Bronze Solar Light Up Bird Feeder K214 Instructions for Use

Please read and retain these instructions for future reference

v001: 09/08/21

Instructions

- When using the solar light for the first time, please turn on the switch, and then put it in the sun for 6-8 hours to charge.
- The feeder has a light sensor, the light will automatically turn on at night. Please do not place it in a bright area at night, as this will affect the automatic light-on function of the feeder at night.
- To fill the feeder with bird food, lift up and open the upper lid first, then put the food into the iron net tube and then close the lid. Food will leak out from the three holes at the bottom, so that the birds can eat the food when standing on the edge of the iron ring.

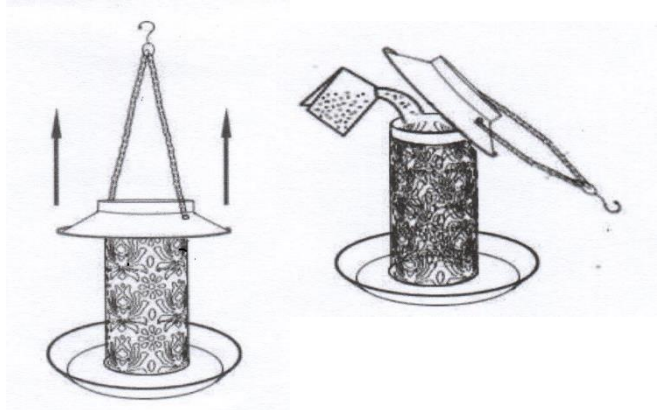

Care and Maintenance Recommendations

1. Clean solar panel with a soft sponge every couple of weeks.
2. Make sure all connectors are still tight and no water getting in.
3. Clear away droppings and spilled seed around your feeder on the ground.
4. A clean feeder reduces the spread of disease among bird and also prevents mould growth on seeds.
5. Clean your feeder with a brush and mild disinfectant about once a week.

BATTERIES

- Keep batteries away from children and pets.
- Do not mix used and new batteries.
- Remove the batteries if left for long periods.
- Never dispose of batteries in a fire.
- Battery disposal, spent or expired batteries must be properly disposed of and recycled in compliance with local regulations. For detailed information, contact your local authority.
- Follow the battery manufacturer's safety, usage, and disposal instructions.

DISPOSAL

- Coopers of Stortford use recyclable or recycled packaging where possible.
- Please dispose of all packaging, paper, cartons, packaging in accordance with your local recycling regulations.
- Plastics, polybags – this is made from the following recyclable plastic.
- At the end of the product's lifespan please check with your local council authorised household waste recycling centre for disposal.



*Calls cost 7 pence per minute plus your telephone company's network access charge

The Enterprise Department
Head Office: 11 Bridge Street
Bishop's Stortford, CM23 2JU
Tel: 0844 482 4400*
Fax: 01279 756 595
www.coopersofstortford.co.uk