

Plastic Rattan Furniture Set

K234 v001: 23/08/21

Please read and retain these instructions for future reference

GAINSBOROUGH
Garden & Wildlife

Parts (Chairs)

1 PC

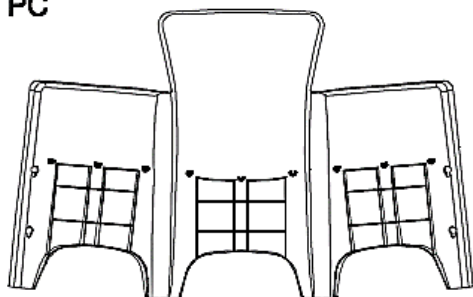

1 PC

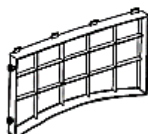

1 PC

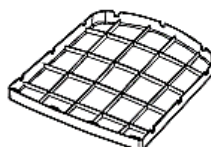

Chair Dimensions:
57 x 55 x 86 CMS

Chair Max load:
160Kg

**IMPORTANT! PLEASE READ AND RETAIN THESE INSTRUCTIONS FOR FUTURE REFENCE.
FOR DOMESTIC USE ONLY**

3 piece garden furniture set made up of 2 chairs with a high back and arms and a table.

- Made from durable plastic that looks just like rattan, but you don't have to worry about leaving this out all year round!
- Lightweight so you can move to the best spot in your garden with ease
- If you did want to store it away its easy as you can take them apart and they go completely flat, perfect if you only have a small shed or garage
- Comes complete with 2 cream cushions.

WARNING:

- Peg and slot assembly.
- Ensure pegs are properly inserted and seated. Tap firmly into position. Do not use a hammer or force parts together.
- Use on a flat surface.
- Take care when opening or folding up: risk of finger entrapment.

3PC Plastic Rattan Furniture Set K234 Instructions for Use

Please read and retain these instructions for future reference

v001: 23/08/21

CHAIR ASSEMBLY:

Step 1

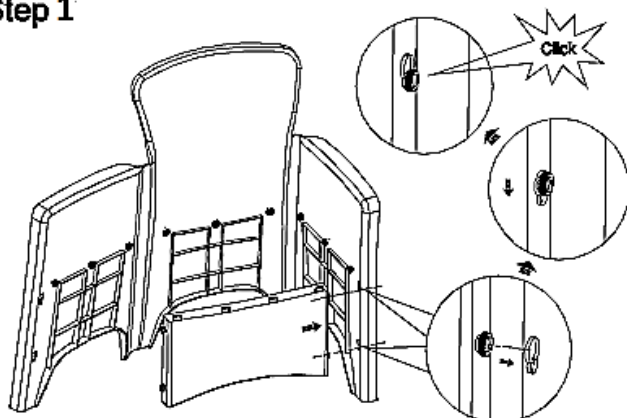

Fold side panels in by 90° and connect with front panel.
Align pegs with slots.
Insert pegs into slots and push down until it clicks and locks in place.
Do not use hammer.
Repeat on the other side.



Helpful Tips

If you lay the chair on its back and connect the front section of the chair (as seen in the photograph) push align the pegs with the slot and push together. Then bring the whole chair round align the pegs and push down. Put the chair upright so it is on 4 legs then push down in the front section to click in place.

Step 2

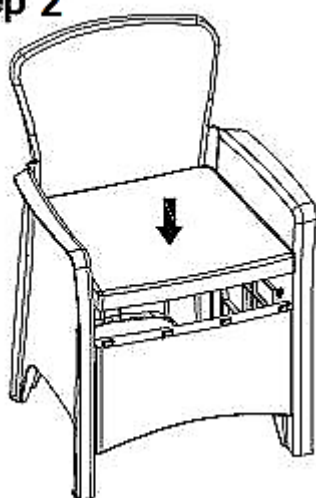

Place seat pad on top.
Align pegs with slots.
There are 8 to line up.
If you line up the back 2 first and push into the back and push down then line up the front and click into place the side one will line up. Then go round and push down they will click in place. Then put the cushion over the top.

*Calls cost 7 pence per minute plus your telephone company's network access charge

Head Office, 11 Bridge Street,
Bishop's Stortford CM23 2JU
Tel: 0844 482 4400*
Fax: 01279 756 595
www.coopersofstortford.co.uk

Coopers
OF STORTFORD

3PC Plastic Rattan Furniture Set K234 Instructions for Use

Please read and retain these instructions for future reference

v001: 23/08/21

Step 3

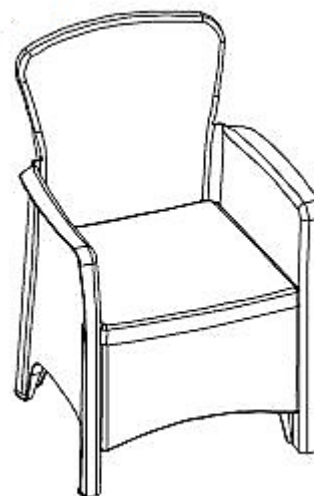
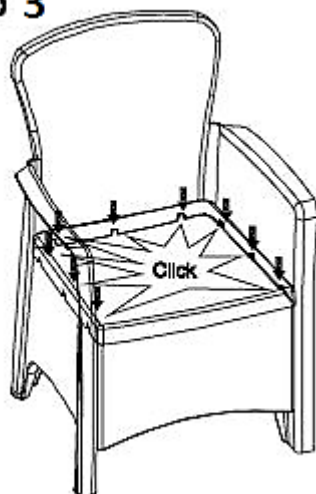

Tap firmly into position where indicated until pieces click together.

TABLE ASSEMBLY

Parts (Table)

1 PC

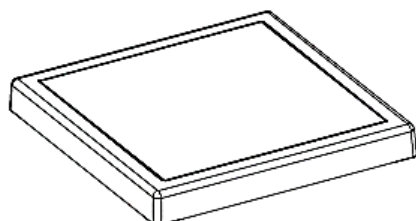

4 PCS

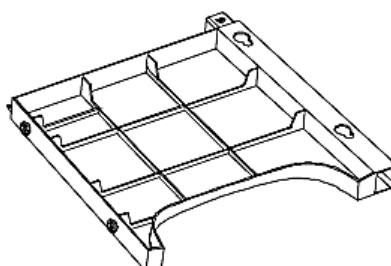
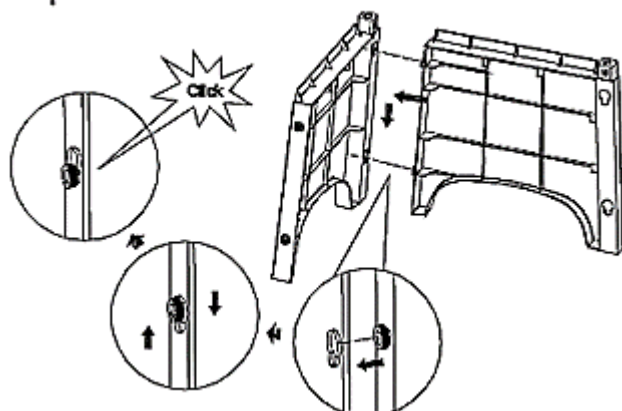

Table Dimensions:
39 x 39 x 39 CMS.,

Table Max load: 20 Kg

**Not designed for
sitting on.**

Step 1.



Align pegs with slots, insert pegs into slots and push down until it clicks and locks.

Repeat until all side panels are connected.

Follow the **Helpful Tips** under **Chair Assembly**.

*Calls cost 7 pence per minute plus your
telephone company's network access charge

Head Office, 11 Bridge Street,
Bishop's Stortford CM23 2JU
Tel: 0844 482 4400*
Fax: 01279 756 595
www.coopersofstortford.co.uk

Coopers
OF STORTFORD

3PC Plastic Rattan Furniture Set K234 Instructions for Use

Please read and retain these instructions for future reference

v001: 23/08/21

Step 2

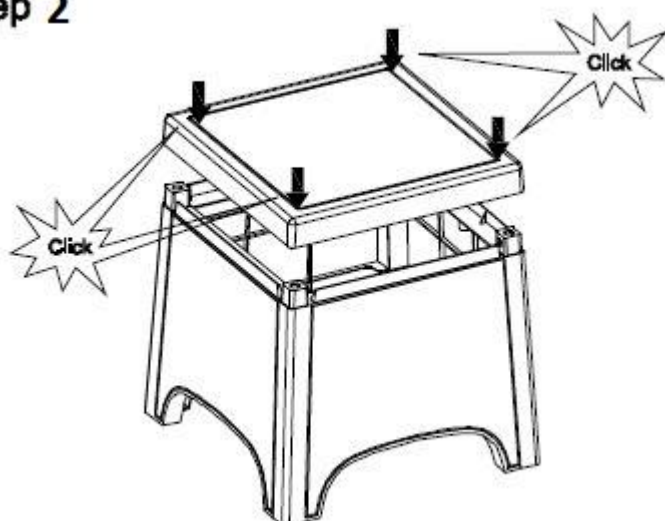

Align pegs with slots, insert pegs into slots and push down where indicated until it clicks and locks.

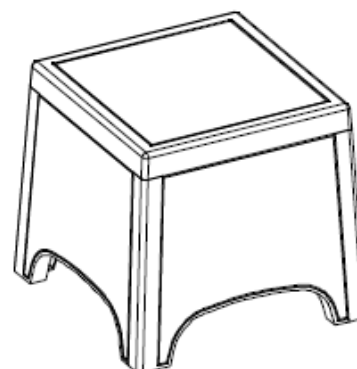

MAINTENANCE & CLEANING INSTRUCTIONS:

- Check all fixings, pegs are secure, and all parts are firmly on place before each use.
- Hand push until secure. Do not use a hammer,
- Protect from adverse weather.
- Gently wipe clean with a damp cloth.
- Store in a dry place.
- Do not store when wet.

DISPOSAL

- Coopers of Stortford use recyclable or recycled packaging where possible.
- Please dispose of all packaging, paper, cartons, packaging in accordance with your local recycling regulations.
- Plastics, polybags – this is made from the following recyclable plastic.



Code & Symbol	 PP
Type of Plastic	Polypropylene
Commonly used for	Microwaveable food containers, yoghurt pots, butter tubs, disposable plates and cups
Notes	Commonly recycled and collected from household recycling bins (packaging tape itself not recyclable but does not interfere with cardboard)

- At the end of the product's lifespan please check with your local council authorised household waste recycling centre for disposal.