

# Copper Flower Solar Stake Lights Set 2

K323 v001: 11/10/21

Please read and retain these instructions for future reference

**GAINSBOROUGH**  
Garden & Wildlife

ALWAYS POSITION IN DIRECT SUNLIGHT



## Dimensions

(H) 93 x (W) 28 x (D) 13.5cm

## Material

Iron and Plastic

- STANDING AT 93CM TALL THESE SOLAR FLOWER LIGHTS WILL MAKE AN IMPRESSIVE ADDITION TO YOUR GARDEN
- THE FLOWER HEAD HAS AN INTRICATE CUT OUT DESIGN ALONG ITS PETALS CREATING A BEAUTIFUL LIGHT PATTERN WHEN ILLUMINATED
- FINISHED IN A COPPER BRONZE LOOK FINISH
- INTEGRAL SOLAR PANEL SO NO TRAILING WIRES
- STAKE IN FLOWER BEDS FOR NIGHTTIME ILLUMINATION OR ALONG A PATH MARKING THE WAY

## ASSEMBLY INSTRUCTIONS / INSTRUCTIONS FOR USE:

Unpack the components carefully. Please check all parts have been removed from the packaging.

### Before using first time

Step 1:

Fully charge the battery before first use. Charge under direct sunlight in the <ON> position for 2 days.

Step 2:

Your solar light will automatically turn on once it gets dark.

### CHANGING THE BATTERY

Step 1:

Push the switch to the <OFF> position (Figure 1).

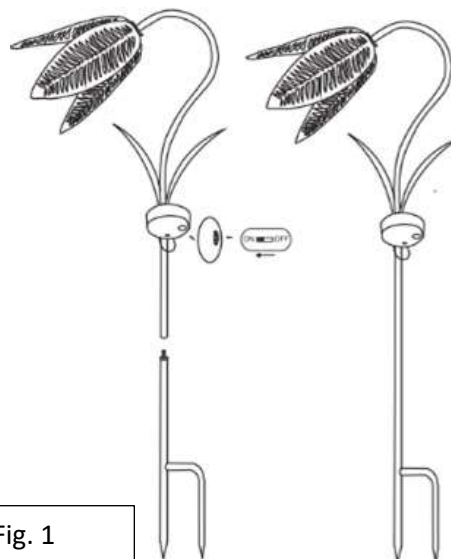

Fig. 1

\*Calls cost 7 pence per minute plus your telephone company's network access charge

The Enterprise Department  
Head Office: 11 Bridge Street  
Bishop's Stortford, CM23 2JU  
Tel: 0844 482 4400\*  
Fax: 01279 756 595  
www.coopersofstortford.co.uk

## Step 2:

Remove the screws from the battery cover (Figure 2).

## Step 3:

Carefully lift the cover to access the battery compartment, being sure not to detach any of the connected wires (Figure 2).

## Step 4:

Replace the battery with an equivalent new solar rechargeable battery (1x AAA NI-MH); ensuring the correct polarity is observed (Figure 2).

## Step 5:

Reassemble the unit by reversing the above procedure.

Charge under direct sunlight in the <ON> position for 2 days.

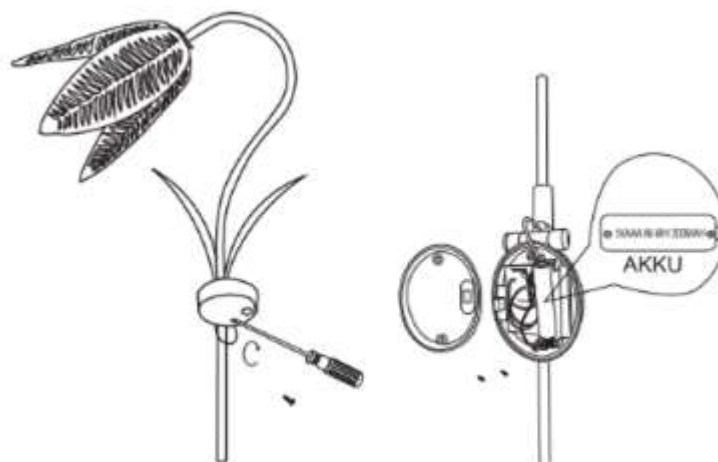

Fig. 2

## Find an ideal Place for the Solar Light.

Place the solar light in an area where it will receive direct sunlight for at least 8 hours per day. The number of hours the light will illuminate is directly proportional to the hours of sunlight it receives. If the light is placed in a shaded area, it will not be able to fully charge and its illumination time will be limited. Do not place the light near other outdoor lighting like porch or streetlights. These may fool the sensor and keep the light from coming on, or cause it to turn off automatically

## TROUBLE SHOOTING TIPS

If your solar light does not come on at dusk despite following all instructions please try the following steps:

1. Make sure that the solar light is not affected by any other light source.
2. Ensure the solar light does not stand in the shade all day.
3. Check to see if the batteries are installed correctly.
4. If there is a protective film on the solar panel remove it.

## CARE INFORMATION

- Clean any dirt and debris from the solar panel. The panel cannot recharge if the light is obstructed. Use a soft cloth to clean the panel. Do not use abrasives or chemicals that might scratch or damage the UV coating.
- In a region where snow and ice are likely and the light assembly is covered with snow for an extended period of time the batteries will require a recharge for at least 8 hours.
- Make sure all connectors are still tight and no water getting in.



## BATTERIES

- Keep batteries away from children and pets.
- Do not mix used and new batteries.
- Remove the batteries if left for long periods.
- Never dispose of batteries in a fire.
- Battery disposal, spent or expired batteries must be properly disposed of and recycled in compliance with local regulations. For detailed information, contact your local authority.
- Follow the battery manufacturer's safety, usage, and disposal instructions.

## DISPOSAL

- Coopers of Stortford use recyclable or recycled packaging where possible.
- Please dispose of all packaging, paper, cartons, packaging in accordance with your local recycling regulations.
- Plastics, polybags – this is made from the following recyclable plastic.



Code & Symbol		
Type of Plastic	Polystyrene	ABS
Commonly used for	Insulation boxes, water cups, protective packaging inserts, take away containers	CD's, crisp packets, various flexible packaging, baby bottles, sunglass lenses
Notes	Not commonly recycled but waste management centres will recycle it.	Not often or widely recycled

- At the end of the product's lifespan please check with your local council authorised household waste recycling centre for disposal.

