

Motion Light up Door Canopy

Instructions for Use

Item No: P074

v001: 19/06/24

Please read and retain these instructions for future reference

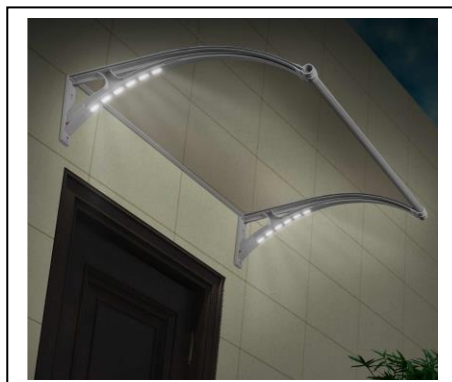

Product parameters

Type of light	SMD2835-48PCS
LED Power	2.5W
Solar Panel Rated Voltage	DC6V
Rated Battery Voltage	3.7V
Color Temperature	3000K /4000K /6000K
Battery Specifications	Lithium iron phosphate 2000mAh with overvoltage protection and overcharge protection
Solar Panel Power	Class A 3W
Operating mode	Light control + radar sensing
Maximum temperature rise	≥50 degrees, rated load
Operating hours	3-5 days
Radar sensing range	4-7m
Radar sensor angle	1200
Lighting Time	15S
Charging Time	Sunshine for 8 hours
Operating temperature range	-20 ~ +500C
Waterproof Level	IP65



Components

	Drawing	Number	Item Name
①		1	Board
②		2	Bracket
③		1	Water gutter

	Drawing	Number	Item Name
④		1	Back Fixing Bar
⑤		4	Setscrew
⑥		4	Screw

Assembly Instructions

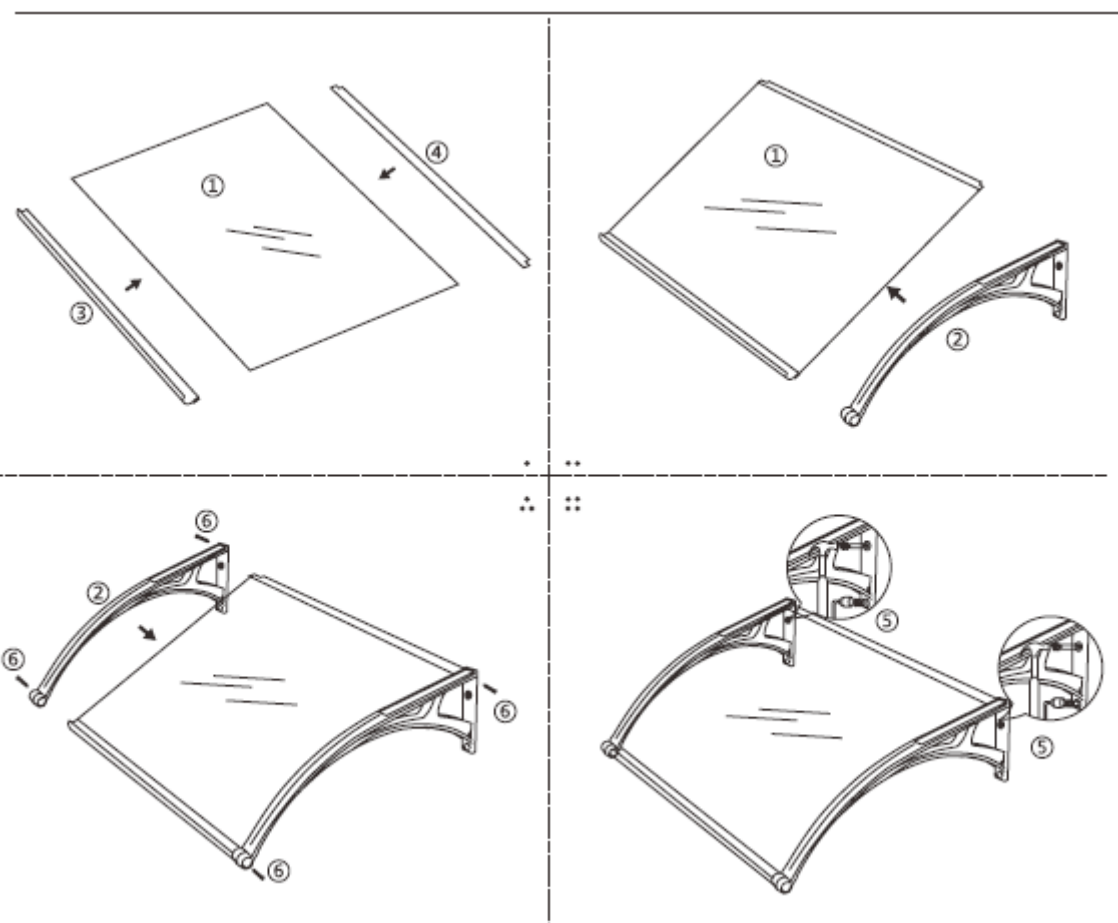

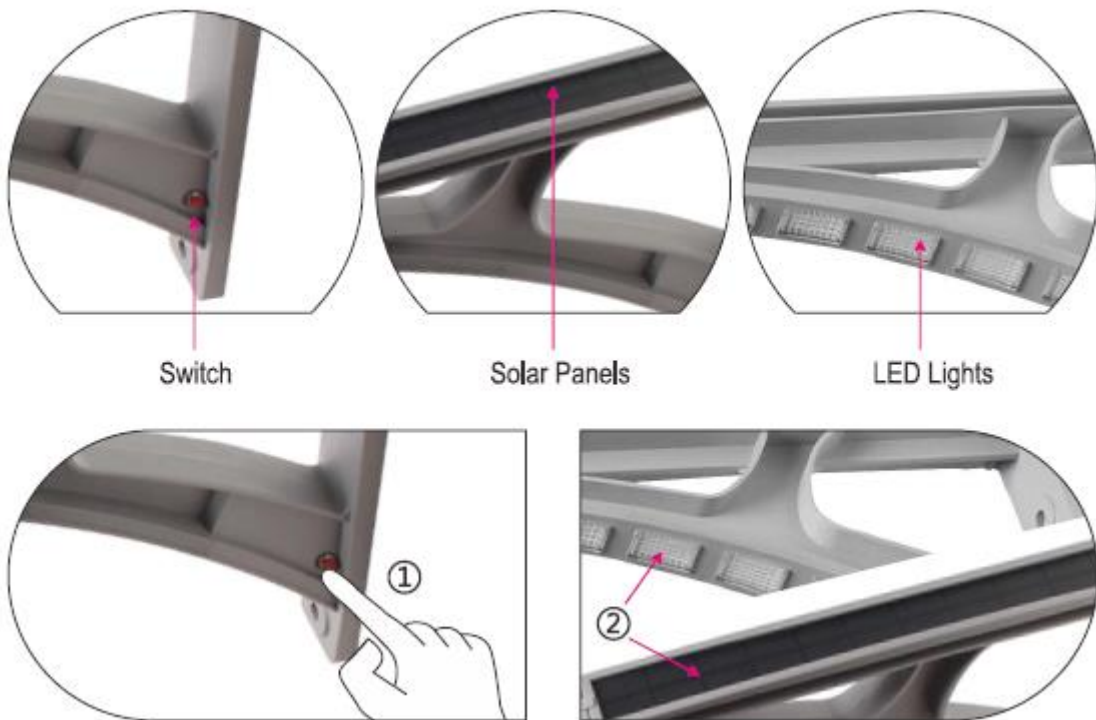

① SWITCH

After installation, press the button to turn on the light

② No light

After turning on the switch, if the light does not light up, it may be insufficient power. Turn off the switch and let the solar panel charge in the sun for more than 2 hours, and then press the switch.

⚠ BE CAREFUL

- Solar panel will charge and inner battery storage automatically in the daytime.
- When an object moving near the canopy (illuminance < 20lux at night), it will light up automatically.
- 15s later, the light will turn off automatically if no sensing object moving.
- Avoid metal objects shielding the sensing surface directly , the sensor head can penetrate the non-metallic objects, such as glass, wood and gypsum board;
- Avoid covering solar panels, such as too much dust, please clean up in time.

ALWAYS POSITION THE SOLAR PANEL IN DIRECT SUNLIGHT

WARNINGS AND SAFETY INSTRUCTIONS:

WHEN USING ANY APPLIANCE, BASIC SAFETY PRECAUTIONS SHOULD ALWAYS BE FOLLOWED:

- READ ALL INSTRUCTIONS BEFORE USE.
- FOR DOMESTIC OUTDOOR USE ONLY.
- BEFORE USE, CHECK THOROUGHLY FOR ANY DEFECTS AND DO NOT USE IF DEFECTS ARE FOUND. TAKE CARE NOT TO DROP THE APPLIANCE AS HEAVY IMPACTS MAY CAUSE INTERNAL DAMAGE.
- THE USE OF ANY ACCESSORY OR ATTACHMENTS NOT RECOMMENDED BY COOPERS OF STORTFORD MAY CAUSE INJURIES AND INVALIDATE ANY WARRANTY YOU MAY HAVE.
- REPLACE THE BATTERIES IF LEFT FOR LONG PERIODS OR NO LONGER CHARGING.



CHECK CORRECT POLARITY



DO NOT MIX NEW
AND USED BATTERIES



DO NOT DISPOSE
IN FIRE



SEEK MEDICAL ASSITANCE
IF SWALLOWED

- DO NOT SHORT CIRCUIT THE BATTERY TERMINALS.
- ENSURE THE BATTERY COMPARTMENT IS RE-SECURED BY THE SCREW OR SECURING DEVICE.
- BATTERY DISPOSAL: SPENT OR EXPIRED BATTERIES MUST BE DISPOSED OF AND RECYCLED IN COMPLIANCE WITH YOUR LOCAL AUTHORITY REGULATIONS.
- **KEEP BATTERIES AWAY FROM CHILDREN AND PETS.**

CARE AND CLEANING INSTRUCTIONS

- REGULARLY CHECK AND WIPE CLEAN THE SOLAR PANEL AND REMOVE ANY OBSTRUCTIONS.
- DO NOT USE ABRASIVE CLEANERS OR SHARP UTENSILS TO CLEAN THIS APPLIANCE.
- WIPE SURFACES WITH A SOFT DRY CLOTH. DRY THOROUGHLY BEFORE FURTHER USE.
- DO NOT IMMERSE IN WATER.
- STORE THE APPLIANCE IN A COOL, DRY PLACE.





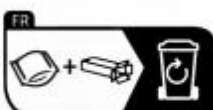

DISPOSAL

- Coopers of Stortford use recyclable or recycled packaging where possible.
- Please dispose of all packaging, paper, cartons in accordance with your local authority recycling regulations.
- At the end of the product's lifespan please check with your local council authorised household waste recycling centre for disposal.
- Plastics, polybags – this is made from the following recyclable plastic.



Points de collecte sur www.quefairedemesdechets.fr
Privilégiez la réparation ou le don de votre appareil !



Code & Symbol	 PETE	 HDPE	 PVC	 LDPE	 PP	 PS	 OTHER
Type of Plastic	Polyethylen e Terephthala te	High- Density Polyethylen e	Polyvinyl Chloride	Low Density Polyethylen e	Polypropylen e	Polystyrene	Please Specify (includes ABS, Nylon)

Distributed by / Verteilt durch / Distribué par.

UK:

The Enterprise Department Ltd.

11 Bridge Street, Bishops Stortford

Herts, UK, CM23 2JU

Tel: 0330 331 0300

NI/EU:

D.S.B. LD, 160 Bd. de Fourmies, 59100 Roubaix, France

Tel: (+44) 1279 701269

DE/FR/CZ/SK:

hergestellt für 3Pagen

Sankt-Joeris-Strasse 16-28

53477 Alsdorf

Tel: +49(0)2404/980-204

kontakt@3pagen.de

