

# FLY AND WASP GLUE TRAP

Item No: R166

Instructions for Use v001: 03/12/2025

Please read and retain these instructions for future reference

**GAINSBOROUGH**  
Garden & Wildlife



## INSTRUCTIONS FOR USE:

Can be used in all rooms indoors and outdoors.

**Handling:** Hold the product using the rope located the top.

## Installation & Replacement Steps:

**Disassemble:** Pull up the top cover and remove the black mesh components one by one.



**Replace Glue Traps:** Take off the old glue traps that need to be replaced. Take out two new glue traps (Please note: the two items are different and together make a complete set).



**Assemble Glue Traps:** Interlock the two new glue traps to form a three-dimensional structure like below.



**Secure Glue Traps:** Clip the bottom of the assembled glue traps into the cross slot at the bottom of the device and carefully peel off the backing paper once secured.

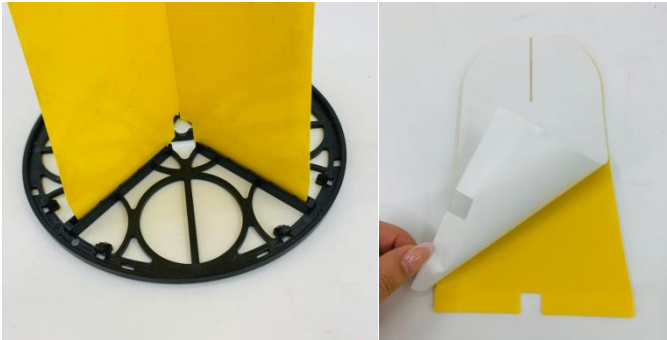

**Install Mesh Components:** Assemble the black mesh components according to the slots at the bottom and re-connect the top cover.



**Install Bait Ball:** Fill the bait ball with some soft fruits & hang the bait ball at the bottom.

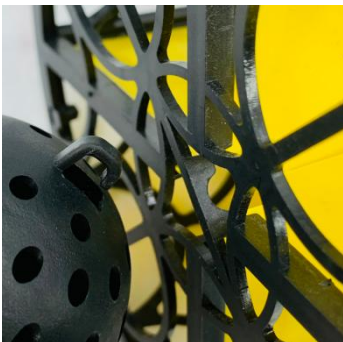

### Safety Precautions

1. If the glue comes into contact with the skin, rinse thoroughly with soap and warm water.
2. Be sure to wash your hands after handling.
3. Bait solutions (such as honey, fruit syrup) need to be prepared by yourself. When using, add a spoonful to the bottom ball.

### Maintenance Tips

Replace the glue traps every 3 months or when too many insects are trapped on them. Wrap the used glue traps in paper before discarding them.

### CARE AND CLEANING INSTRUCTIONS:

- Do NOT use abrasive cleaners or sharp utensils to clean this product.
- Store the item in a cool, dry place.
- Wipe with a clean dry cloth.

### DISPOSAL

We use recyclable or recycled packaging where possible

Please dispose of all packaging in accordance with your local authority's recycling regulations

At the end of the product's lifespan check with your local council authorized household waste recycling centre for disposal.

Plastic Polybags – this is made from the following recyclable plastic

Code & Symbol	 <b>OTHER</b>
Type of Plastic	Please Specify (includes ABS, Nylon)

**Distributed by / Verteilt durch / Distribué par/ Distribútor / Distribuuje.**

The Enterprise Department Ltd, Trading as Coopers of Stortford.

**UK address:** 11 Bridge Street, Bishops Stortford, Herts, UK, CM23 2JU

**EU address:** D.S.B. LD, 160 Bd. De Fourmies, 59100 Roubaix, France



0330 331 0300



[enquiries@coopersofstortford.co.uk](mailto:enquiries@coopersofstortford.co.uk)



<https://www.coopersofstortford.co.uk>

### 3Pagen

Hergestellt für 3Pagen

Sankt-Joeris-Strasse 16-28

52477 Alsdorf



+49 (0) 2404/980-204



[kontakt@3pagen.de](mailto:kontakt@3pagen.de)



[www.3pagen.de](http://www.3pagen.de)

