

Read carefully before use and retain for future reference.

PARTS

MAIN FRAME

1. Trolley Base	1
2. Side Panel	2
3. Front panel	1
4. Back panel	1
5. Wheels	4

REAR AXLE

6. Rear axle support	1
7. Left rear axle brace	1
8. Right rear axle brace	1

FRONT AXLE (pre-assembled)

9. Front axle support	1
10. Centre front axle support	1
11. Yoke	1
12. Steering link connector	1

HANDLE (pre-assembled)

13. Plastic coupling	1
14. Handle	1
15. Trailer hitch	1
16. Tarpaulin	1

FIXINGS

17. Fence pins	8
18. Handle pin	1
19. Clevis pin	1
20. Lock handles 8mm	4
21. Washers 8mm	11
22. Locking nuts 8mm	11
23. Wheel spacers	4
24. Wheel locking nuts 12mm	4
25. Wheel washers 12mm	4
26. Carriage bolts 8x20mm	10
27. Handle bolt 8x60mm	1
28. Shoulder bolt 8x15mm	3
29. Washers 6mm	4
30. Locking nuts 6mm	4
31. Shoulder bolt 8x20mm	1

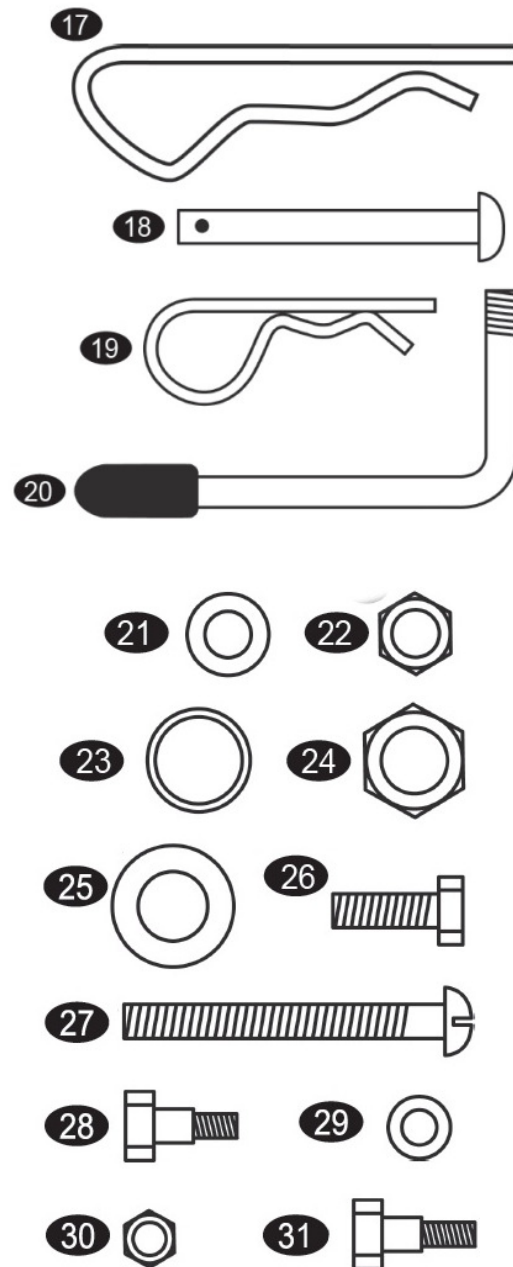

TOOLS REQUIRED (not supplied)

Medium flathead screwdriver and 10mm, 13mm & 19mm open end wrenches or 2x medium adjustable wrenches.

ASSEMBLY

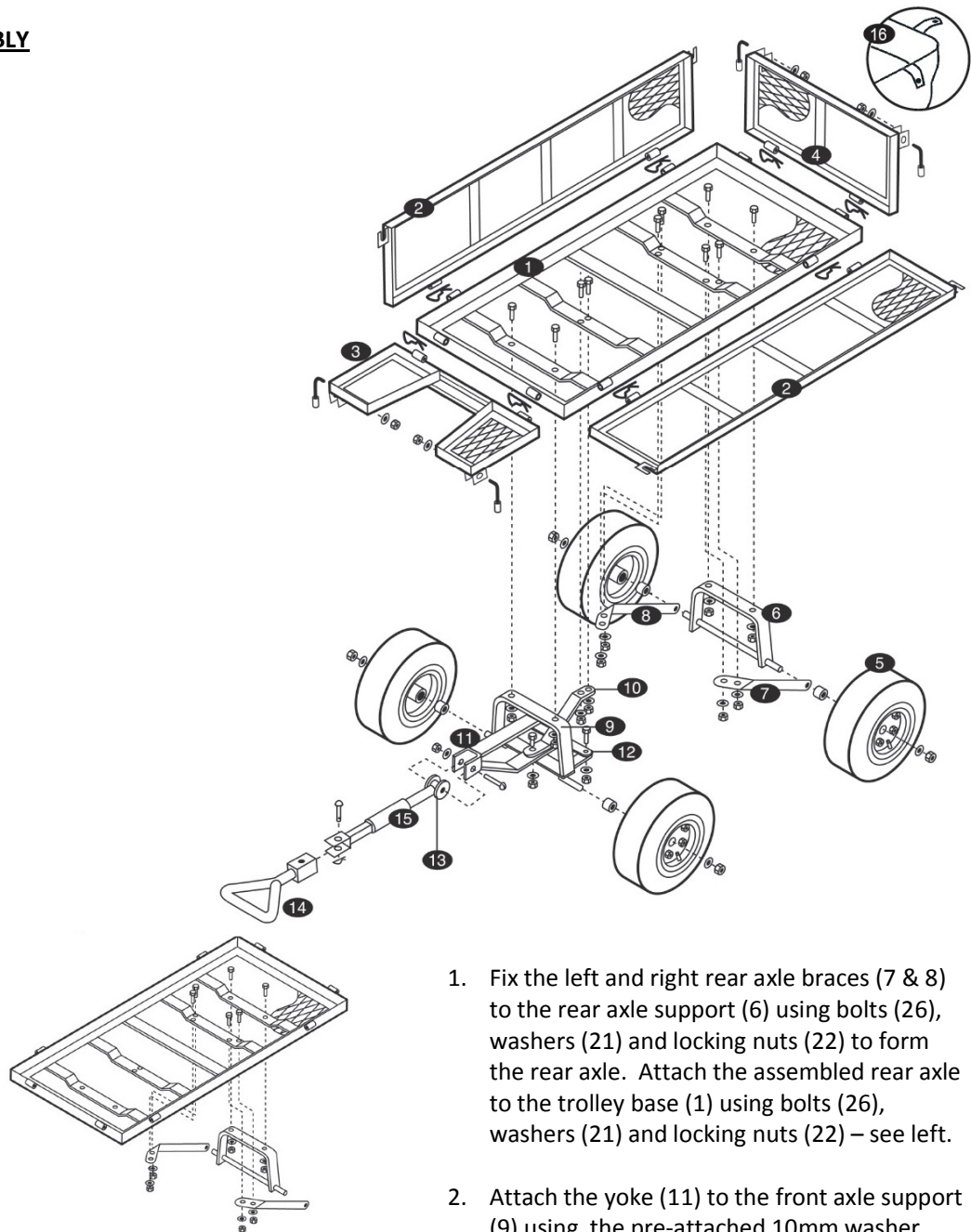

1. Fix the left and right rear axle braces (7 & 8) to the rear axle support (6) using bolts (26), washers (21) and locking nuts (22) to form the rear axle. Attach the assembled rear axle to the trolley base (1) using bolts (26), washers (21) and locking nuts (22) – see left.

2. Attach the yoke (11) to the front axle support (9) using the pre-attached 10mm washer

(and cotter pin. Attach the centre front axle brace (10) to the yoke (11) using 8x20mm shoulder bolt (31), 6mm washer (29) and 6mm locking nut (30). Attach the yoke (11) to the steering link connector (12) using 1x 8x15mm shoulder bolt (28), 6mm washer (29) and 6mm locking nut (30).

Insert the remaining 2x 8x15mm shoulder bolts (28) into the ends of the steering link connector (12) and secure using 6mm washer (29) and 6mm locking nut (30) – see right.

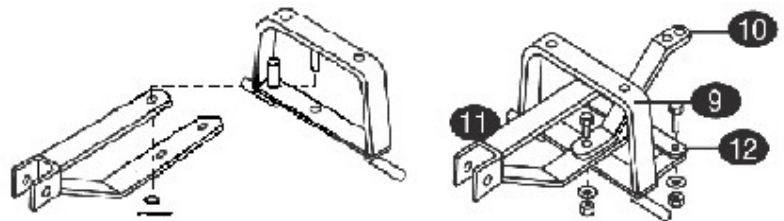

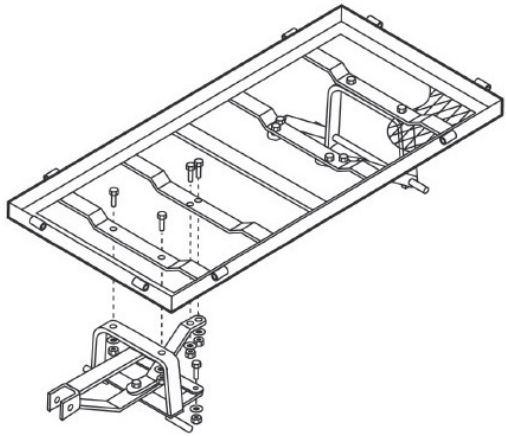

3. Attach the front axle support (9) to the trolley base (10) using 8x20mm carriage support bolts (260), washers (21) and locking nuts (22) – see left.

4. Attach the wheels by fitting the wheel spacers (23) onto the axles before attaching the wheels (5) ensuring the valve stems are facing outwards. Secure using 12mm wheel washers (25) and 12mm wheel locking nuts (24) – see right.

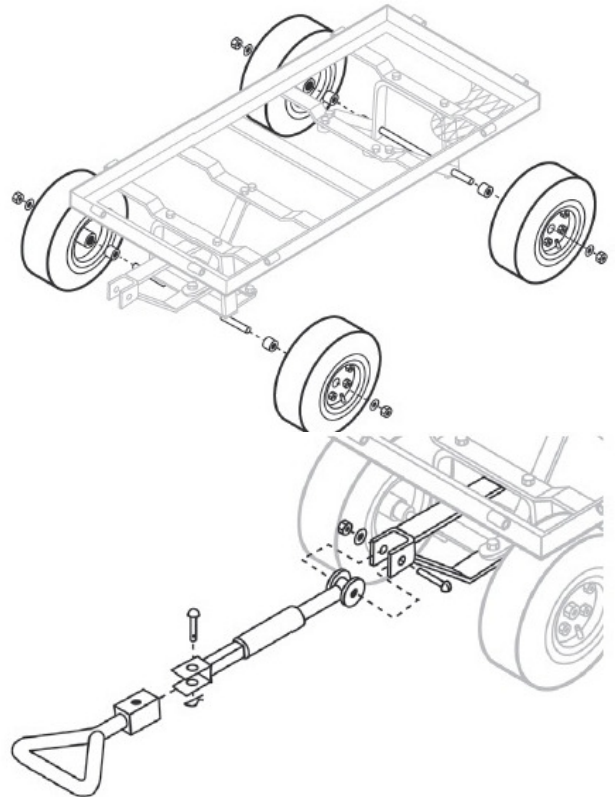

5. Attach the handle to the yoke (11) and the plastic coupling (13) using 8X60mm handle bolt (27), washer (21) and locking nut (22). Attach the handle (14 or trailer hitch (15) using the handle pin (18) and clevis pin (19) – see right.

6. Attach the front panel (3) back panel (4) and side panels (2) to the trolley base (1) using the fence pins (8). Use the locking handles (20) to attach the front and back panels to the side panels. Secure using locking nuts (22).

7. Fit the tarpaulin and secure using the press studs.

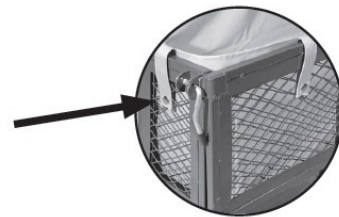
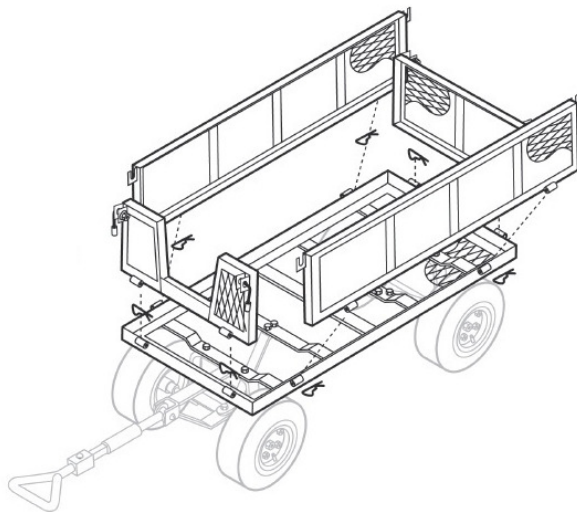

WARNING

- Maximum weight load limit 227kg.
- The garden Cart is not a toy. Do NOT allow children to play in, on, or with this item.
- Always distribute weight load evenly.
- Do not load any items on top of the front, back or side panels. Lower the panels if necessary to load oversized items.
- Before use, check all fixings are secure and tighten if necessary.
- Before use, check all parts for damage, including tyres.
- Do NOT use if damaged.
- Do not inflate the tyres to more than 30 PSI.
- Do NOT use on surfaces that may cause damage to the tyres or inner tubes. Always check the transport route for sharp objects before transporting items in the Garden Cart.

PACKAGING

- Dispose of packaging at your local recycling centre.
- Dispose of paper and carton separately from plastic bags at your local recycling centre.
- Dispose of item at the end of its lifespan at your local authorised household waste recycling centre.