

**Power Details:**

Voltage:	230V-240V, 50Hz
Power consumption:	750W
Idle speed:	380min ⁻¹
Working width:	320mm
Tines diameter:	max 205mm
Working depth max.:	200mm
Noise pressure level LpA:	79dB(A) k=3dB(A)
Noise power level LwA:	93dB(A) k=3dB(A)
Vibration:	
Left handle:	1,153m/s ²
Right handle:	1,158m/s ²
	K=1,5m/s ²

**Description of the symbols**

The use of symbols in this manual is intended to draw your attention to possible risk. The safety symbols and the explanations that accompany them must be perfectly understood. The warnings in themselves do not remove the risks and cannot replace correct action for preventing accidents.



This symbol, before a safety comment, indicates a precaution, a warning or a danger. Ignoring this warning can lead to an accident for yourself or for others. To limit the risk of injury, fire, or electrocution always apply the recommendations indicated.



Read the operator's manual. Before any use, refer to the corresponding paragraph in the present manual.

Head Office, 11 Bridge Street,
Bishop's Stortford CM23 2JU
Tel: 0844 482 4400*
Fax: 01279 756 595
www.coopersofstortford.co.uk

*Calls cost 7 pence per minute plus your
telephone company's network access charge

Coopers
OF STORTFORD



Conforms to relevant European regulations.



This class II symbol indicates that the product is correctly insulated. Earthing this machine is therefore unnecessary.

IPX4

Splash-proof.



Wear ear protection.



Wear eye protection.



Danger of injury from flying parts! Always maintain a sufficiently safe distance. Beware of thrown objects. The distance between the machine and bystanders should be at least 15 meters.



Disconnect the mains plug if the cable is damaged or entangled.



SWITCH OFF: Remove plug from mains before cleaning or maintenance.



Keep hands and feet away from cutting equipment!



Do not use in the rain or leave outdoors while it is raining.

List of main parts

Description (Fig. 1)

1. Safety switch
2. Trigger lever
3. Cable relief
4. Guide bar upper section
5. Carrying handle
6. Guide bar lower section (2 pieces)
7. Motor housing
8. Fender
9. Protective shield
10. Tines
11. Cable clip
12. Bolt M6x45
13. Swing nut
14. M4x20 Screws (Please see Fig 2)
15. ST4x20mm x 2 (Please see Fig 2)

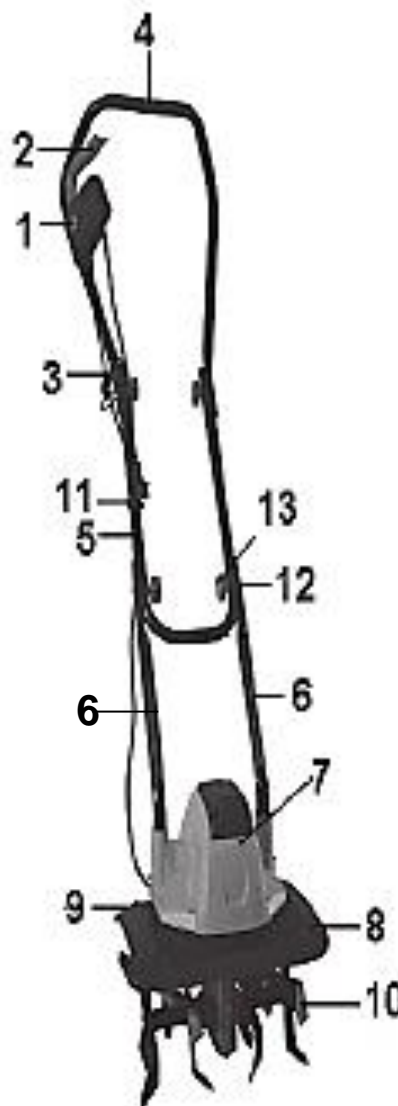

Fig. 1

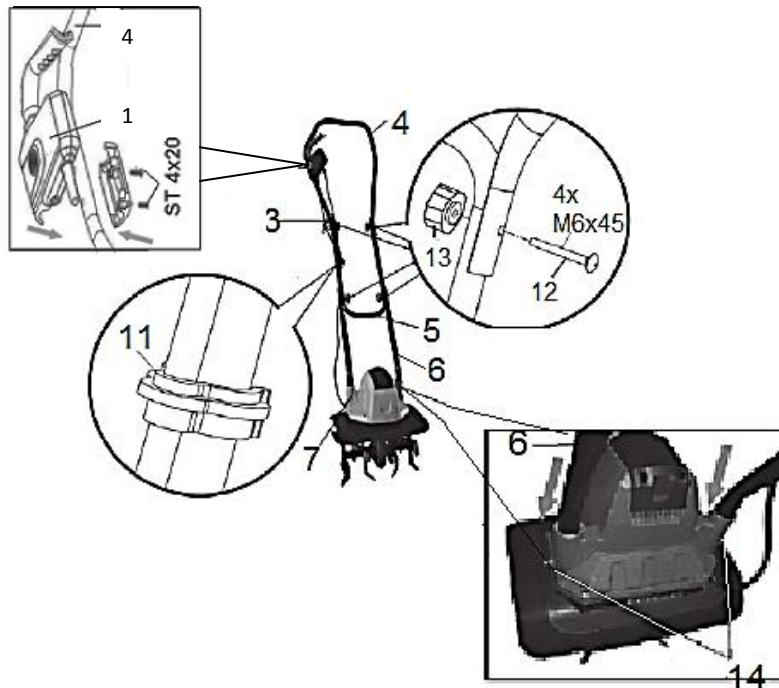

Fig. 2

Attaching the guide bar lower section

Insert the two lower section guide bars (6) into the motor housing (7) and fix it with the two supplied screws M4x20 (14).

Attaching the carrying handle

Fix the two lower section guide bars (6) and carrying handle (5) by inserting the supplied bolts (12) and swing nut (13) on both sides.

Attaching Upper guide bar

Slide the cable relief (3) onto the guide bar upper section (4).

Fit the supplied bolts (12) through both the guide bar upper section (4) and carrying handle (5) and secure with the 2 swing nuts (13) and tighten.

Attaching safety switch

Ensure the plastic cable relief guide is located below the Safety Switch (1) before this switch is fitted.

Insert the safety switch (1) to the guide bar upper section (4) by clipping the 2 sections of the safety switch onto the guide bar upper section (4) and secure with the two screws ST4x20 and tighten. Then fit the two cable clips (11) to hold the cable, as shown in Fig 2.

Operation

Connection to the mains (Fig. 3)

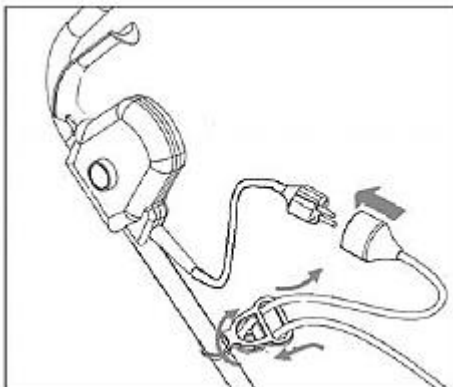

Fig. 3

Plug the appliance connection line into the power plug and secure it with the cable relief.

Starting up (Fig. 4)

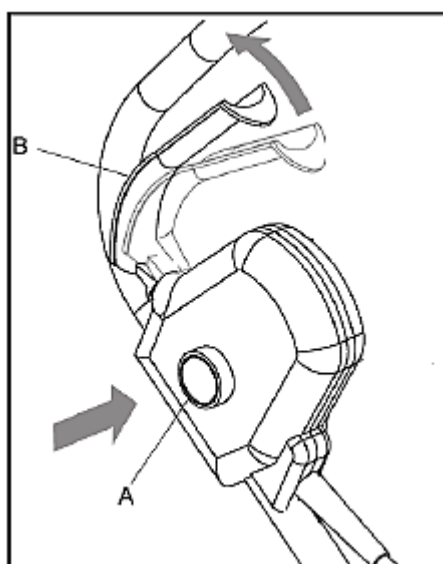

Fig. 4

- Press the safety lock button A of the switch/plug combination and then pull the trigger lever B against the bar. The motor will start and the tines will begin to rotate.
- Hold the trigger lever while releasing the safety lock button.
- To stop the appliance, release the trigger lever and it will automatically return to its start position.

Use the tiller for breaking soil, preparing seed beds, and for cultivating gardens and flower beds. The tiller can also dig small holes for planting saplings or potted plants.

Tips

- Move the appliance to the work area prior to starting the motor.
- Hold the appliance firmly while switching it on.
- The tines will pull the tiller forward during operation, press the guide bar to lower the tines slowly.
- By pulling the tiller back towards yourself, the tines will dig deeper and more aggressively.

- For breaking soil or deep tilling, allow the tines to pull the tiller forward to the end of your arm's reach, then firmly pull the tiller back towards you. By repeatedly allowing the tiller to move forward and then pulling back to you, the tiller will be most effective.
- If the tiller digs deep enough to stay in one spot, gently rock the tiller side to side to start the tiller moving forward again.
- For preparing seed beds, we recommend using one of the tilling patterns shown in Fig. 5.

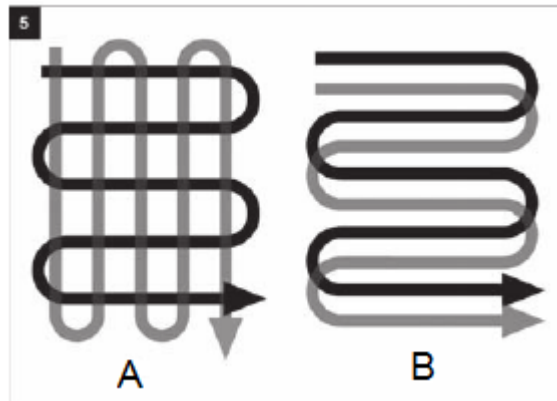

Fig. 5

Tilling Pattern A – Make two passes over area to be tilled, the second at a right angle to the first.

Tilling Pattern B – Make two passes over area to be tilled, the second overlapping the first.

- To prevent tripping take particular care when moving backwards and when pulling the tiller.
- Always let the tines rotate at top speed; do not work in such a way as to overload the appliance.
- Never pass the tiller over the extension cord; make sure it is always in a safe position behind your back.
- When working on inclines always stand diagonally to the incline in a sturdy, safe stance. Do not work on extremely steep slopes.

Transport

Caution! Before transporting the appliance, switch off the motor and unplug it.

The tines and the unit may be damaged even if you move the appliance with the motor switched off, e.g. over solid ground. Prevent the tines from touching the ground by carrying the appliance by its guide bar.

Cleaning tines and foreign objects

During operation, a stone or root could become lodged in the tines, or tall grass or weeds may become wrapped around the tine shaft.

To clear the tines, release the trigger lever. Unplug the tiller, and dislodge or remove any obstacles from the tines or tine shaft.

To ease removal of tall grass or weeds that are wrapped around the tine shaft, remove one or more of the tines from the tine shaft. See tine removal and Installation in this manual.

Tines removal and Installation (Fig. 6)

Fig. 6

Worn tines invite poor performance and overload of the motor.

Check the tines before each use. Sharpen or replace the tines with new ones when necessary. It is recommended to have this done by a specialist.

Caution! Disconnect from the mains and wear protective gloves.

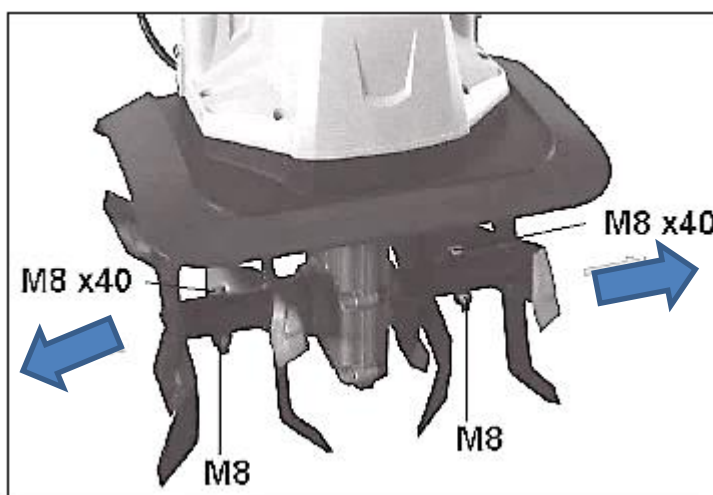
To remove the complete tines from the shaft:

- Remove the M8x40 hex head bolt from the end of the shaft.
- Take off the tine set from shaft.
- Reverse the above steps to re-install tines.

Checking transmission lubricant (Fig. 7)

Fig. 7

The drain screw plug (15) is located on the right side of the transmission housing.

- Lay the tiller on its left side and clean the transmission to prevent dirt and debris before removing the drain screw.
- Using a 5mm hex key unscrew the plug and empty the oil from the transmission.
- Fill up by using a grease gun with a high-quality automotive-grade grease until it begins to seep out around the edge of the hole of the nozzle.
- If necessary, disassemble tines.
- Reinstall the drain screw plug.

Maintenance:

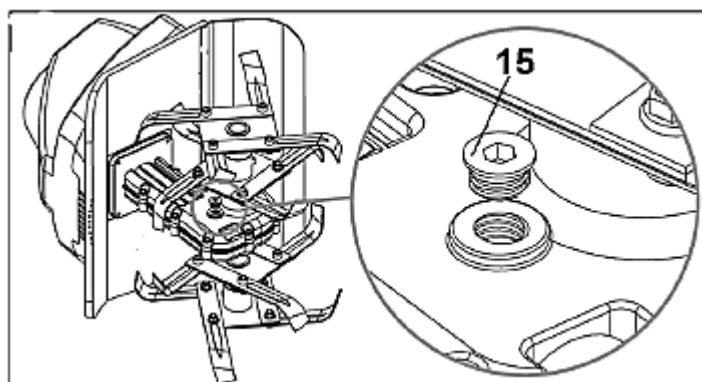
Before carrying out any maintenance operations, cut off the electric power supply by disconnecting the plug from the extension cable.

Prior to each time the appliance is used

- Check the connecting cable for signs of damage or ageing. Replace the cable if it is cracked, split or otherwise damaged.
- Check the condition of the cutting cylinder, and ensure that all threaded connections are securely tightened.
- If the tines are blunt, take it to a specialist workshop for repair if necessary.

Once per season

- Lubricate the tines and shaft.
- At the end of the season, have the appliance checked and serviced in a specialist workshop.

Cleaning:

Caution! Always clean the appliance after use.

Failure to carry out proper cleaning can result in damage to the appliance or cause it to malfunction.

Warning! Injury can occur during work on the tines. Wear protective gloves.

Whenever possible, clean the appliance straight after you have finished working on the lawn.

Clean the underside of the housing around the tines and the protective shield and fender with a scrubbing brush, and brush or soft cloth dampened with a mild soap and water mixture. Never splash with water!

To remove soil and debris from the tines and transmission, use a stiff brush or a dampened cloth.

Clean the ventilator, and remove any remaining grass or dirt.

Once cleaned, wipe the tine and shaft dry and apply a light coat of oil.

Storing:

The appliance should be stored in a dry and clean room and out of reach of children.

During extended periods of storage, during the winter for example, ensure that the appliance is protected against corrosion and frost.

At the end of the season, or if the appliance is not to be used for longer than a month:

Clean the appliance.

Wipe over all metal surfaces with an oil-impregnated cloth to protect them from corrosion (non-resinous oil), or spray a fine coat of oil onto them from a can.

Fold the guide bar down, and store it in a suitable place.

Troubleshooting;

Breakdown service

The following table shows the types of breakdowns and indicates how you can correct it if your machine does not function correctly. If in spite of this, you do not manage to locate the problem and solve it, contact customer services.

Caution! Before starting troubleshooting, stop the appliance and disconnect the power plug.

Problem	Possible cause	Remedy
Motor does not start	No electricity	Check mains connection.
	Defective cable	Check cable, plug in, replace if required, or have it repaired by a qualified person.
	Defective safety switch/plug combination	Arrange for repair in a specialist workshop.
	Overheating protection activated	1. Working depth too large, set to shorter depth. 2. Blades blocked, remove the blockage. 3. Soil too hard, select correct work depth and forwards and backwards several times while slowing down the operation speed. Wait until the motor cools down for around 15 minutes before restarting.
Abnormal noises	Blade is jammed	Switch off. Wait until completely stopped. Remove the object(s).
	Lubrication running out	Arrange for repair in a specialist workshop.
	Loose bolts, nuts or other securing components	Tighten all components, contact specialist workshop if noises prevail.
Abnormal vibrations	Blades damaged or worn	Replace or have it checked by a specialist workshop
	Working depth too deep	Set to correct working depth.
Poor results	Working depth too shallow	Set to correct working depth.
	Worn blades	Replace or have it checked by a specialist workshop.

Safety Warnings:

This appliance is not intended for use by persons (including children) with reduced physical, sensory or mental capabilities, or lack of experience and knowledge, unless they have been given supervision or instruction concerning use of the appliance by a person responsible for their safety.

Children should be supervised to ensure that they do not play with the appliance.

1. Training:

- Read the instructions carefully. Be familiar with the controls and the proper use of the equipment.
- Never allow children or people unfamiliar with these instructions to use the machine. Local regulations can restrict the age of the operator.
- Never work while people, especially children, or pets are nearby.
- Keep in mind that the operator or user is responsible for accidents or hazards occurring to other people or their property.

Head Office, 11 Bridge Street,
Bishop's Stortford CM23 2JU
Tel: 0844 482 4400*
Fax: 01279 756 595

www.coopersofstortford.co.uk

*Calls cost 7 pence per minute plus your
telephone company's network access charge

Coopers
OF STORTFORD

2. Preparation:

- a) While working always wear substantial footwear and long trousers. Do not operate the equipment when barefoot or wearing open sandals.
- b) Thoroughly inspect the area where the equipment is to be used and remove all objects which can be thrown up by the machine.
- c) Before using, always visually inspect to see that the tools are not worn out or damaged. Replace worn out or damaged elements and bolts in sets to preserve balance.

3. Operation;

- a) Wear protective glasses or goggles.
- b) Work only in daylight or in good artificial light.
- c) Always be sure of your footing on slopes.
- d) Walk, never run with the machine.
- e) For wheeled rotary machines, work across the slopes, never up or down.
- f) Exercise extreme caution when changing direction on slopes.
- g) Do not work excessively steep slopes.
- h) Use extreme caution when reversing or pulling the machine towards you.
- i) Start the engine carefully according to manufacturer instructions and with feet well away from the tool.
- j) Do not put your hands or feet near or under rotating parts.
- k) Never pick up or carry a machine while the machine is running.
- l) Never operate the machine with damaged guard or without the guards in place.
- m) Use only manufacturer's recommended replacement parts and accessories.
- n) Disconnect the machine from the mains before checking, cleaning or working on the machine and when it is not in use.

4. Maintenance and storage:

- a) Keep all nuts, bolts and screws tight to ensure the equipment is in safe working condition.
- b) Replace worn and damaged parts for safety.

Warning: When using the machine, the safety rules must be followed. For your own safety and that of bystanders please read these instructions before operating the machine. Please keep the instructions safe for later use.

Before operation:

- The appliance must be assembled correctly before use.
- The appliance should be checked carefully before use. You should only work with an appliance that is in good condition. If you notice any defect on the machine that may cause danger to the operator, do not operate the appliance until defects are rectified.
- Replace worn or damaged parts for safety. Use only original spare parts. Parts not produced by manufacturer may cause poor fit and possible injury.
- Before use, all foreign bodies must be removed from the lawn, also pay attention to foreign bodies during the operation.
- Dress properly. Wear the following clothing while using the appliance:
 - Use of rubber gloves and substantial footwear is recommended.
 - Wear protective hair covering to contain long hair.
 - Avoid wearing loose clothing or jewellery that could get caught in the rotating tines.

Proper use:

The user is responsible for third parties while working with the appliance.

- Only use the appliance for its designed purposes.
- Do not operate the appliance near underground electric cables, telephone lines, pipes or hoses.
- Before inserting the plug in the mains socket, make sure that the socket ratings are correct and correspond to those indicated on the rating label on the appliance.
- The use of the appliance is only permitted if the safety distance provided by the guide bar is complied with.
- Do not operate the appliance on a slope that is too steep for safe operation. When on slopes, slow down and make sure you have good footing.
- Before starting the appliance make sure the tines are not touching foreign objects and must be completely free to move.
- Grip guide bar firmly with both hands. Never operate the appliance with one hand.
- Be aware that the appliance may unexpectedly bounce upward or jump forward if the tines should strike extremely hard, packed soil, frozen ground, or buried obstacles such as large stones, roots or stumps.
- Do not put hands, feet or any body part or clothing in the vicinity of the rotating tines.

**Caution! Risk of injury!**

Only guide the appliance at a walking pace. Do not over reach. Maintain proper footing and balance at all times.

Be aware of the extension cable during operation. Be careful not to trip over the cable. Always guide the cable away from tines at all times.

If the appliance strikes a foreign body, examine the appliance for signs of damage and carry out any necessary repairs before restarting and continuing to work.

If the appliance should start to vibrate abnormally, switch off the motor and check for the cause immediately. Vibration is generally a warning of trouble.

Hold the guide bar and lift the application to move it from one place to another.

Always switch off the appliance, disconnect the plug and wait until the appliance stops before carrying out checking, cleaning, maintenance, or when it is not in use.

**Caution! Tines do not stop immediately after switching off.****Electrical safety:**

If the supply cable is damaged, it must be replaced by the manufacturer, its service agent or similarly qualified persons in order to avoid a hazard.

- The mains voltage must correspond to the one marked on the techN1Cal data plate (230V-50Hz). Do not use other sources of power.
- The use of a safety circuit-breaker is recommended for the power cable for an intervention range of 10 to 30mA. Consult a reliable electrician.
- Never pass the appliance over the extension cable that the appliance is working, as this could cut the cable. Make sure you always know where the cable is.
- Use the special cable holder for the connection of the extension cable.

Head Office, 11 Bridge Street,
Bishop's Stortford CM23 2JU
Tel: 0844 482 4400*
Fax: 01279 756 595

www.coopersofstortford.co.uk

Coopers
OF STORTFORD

*Calls cost 7 pence per minute plus your
telephone company's network access charge

- Never use the appliance when it is raining. Try to prevent it from getting wet or being exposed to humidity. Do not leave it outside overnight. Do not cut damp or wet grass.
- The power supply cable should be checked regularly and before using it each time, make sure the cable is not damaged or worn. If the cable is not in good condition, do not use the appliance; take it to an authorized service centre instead.
- Only use an extension cable that is suitable for outdoor work. Keep it away from the cutting area, from damp, wet or oily surfaces or with sharp edges and away from heat and fuels.
- The mobile socket of the extension cable should be in compliance with related regulation; use harmonized rubber cable (H07RN-F) with at least 1.5mm² cross-section and sufficient length.

Intended Use:

This appliance is only intended as an electric tiller for lawns and grassy areas in private domestic and hobby gardens.

It is not designed for use in public areas, parks, sports areas, and in agriculture and forestry.

Using the appliance for any other purpose is considered incorrect and unapproved. The manufacturer is not liable for any damage or injury resulting from such use. The user is entirely responsible for any associated risks.

Double insulation:

The electric tiller has double insulation. This means that all external metal parts are insulated from the electrical supply.

This is achieved by introducing an insulation layer between electrical and mechanical parts. The double insulation guarantees you the greatest possible safety.

Overheat protection:

If the appliance is blocked by a foreign object or if the motor is overloaded, the motor will switch off automatically by the protection device. Release the trigger level and wait until the motor cools down (approx. 15 minutes) then start the appliance again.

Noise/vibration information:

Measured sound values determined according to EN 709.

The vibration emission level given in this information sheet has been measured in accordance with a standardised test given in EN 709 and may be used to compare one tool with another.

It may be used for a preliminary assessment of exposure.

The declared vibration emission level represents the main application of the tool. However if the tool is used for different applications, with different accessories or poorly maintained, the vibration emission may differ. This may significantly increase the exposure level over the total working period.

An estimation of the level of exposure to vibration should also take into account the times when the tool is switched off or when it is running but not actually doing the job. This may significantly reduce the exposure level over the total working period.

Identify additional safety measures to protect the operator from the effects of vibration such as: maintain the tool and the accessories, keep the hands warm, organisation of work patterns.

PLUG WIRING (UK & IRELAND)

This appliance is fitted with a BS 1363 **13-amp** plug. If you have to replace the fuse, only those that are ASTA or BSI approved to BS1362 and with a rated current of **13-amps** should be used. If there is a fuse cover fitted, this cover must be re-fitted after changing the fuse. If the fuse cover is lost or damaged the plug must not be used. Spare fuse holders and fuses are available from electrical outlets. If the socket outlets in your home or office are not suitable for this product's plug, the plug must be removed and disposed of safely. Attempts to insert the plug into the wrong socket is likely to cause electric hazard. A replacement plug should be wired according to the following instructions:

The cable

A mains electricity cable contains two or three inner wires. Each has a core of copper and an outer layer of flexible plastic. This product is double insulated; the wires in the plug are colour coded in the following way:

BLUE	NEUTRAL
BROWN	LIVE
GREEN & YELLOW	EARTH

The diagram below shows the key features of a correctly wired three-pin mains plug.

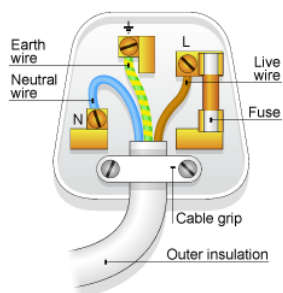
**Note:**

Double insulated appliances do not need the green & yellow Earth wire. They may only have the Brown and Blue wires.

DISPOSAL

- Dispose of all packaging, paper, cartons, plastic and plastic bags in accordance with your local recycling regulations.
- At the end of the product's lifespan please dispose of it at an authorised household WEEE waste recycling centre.

