

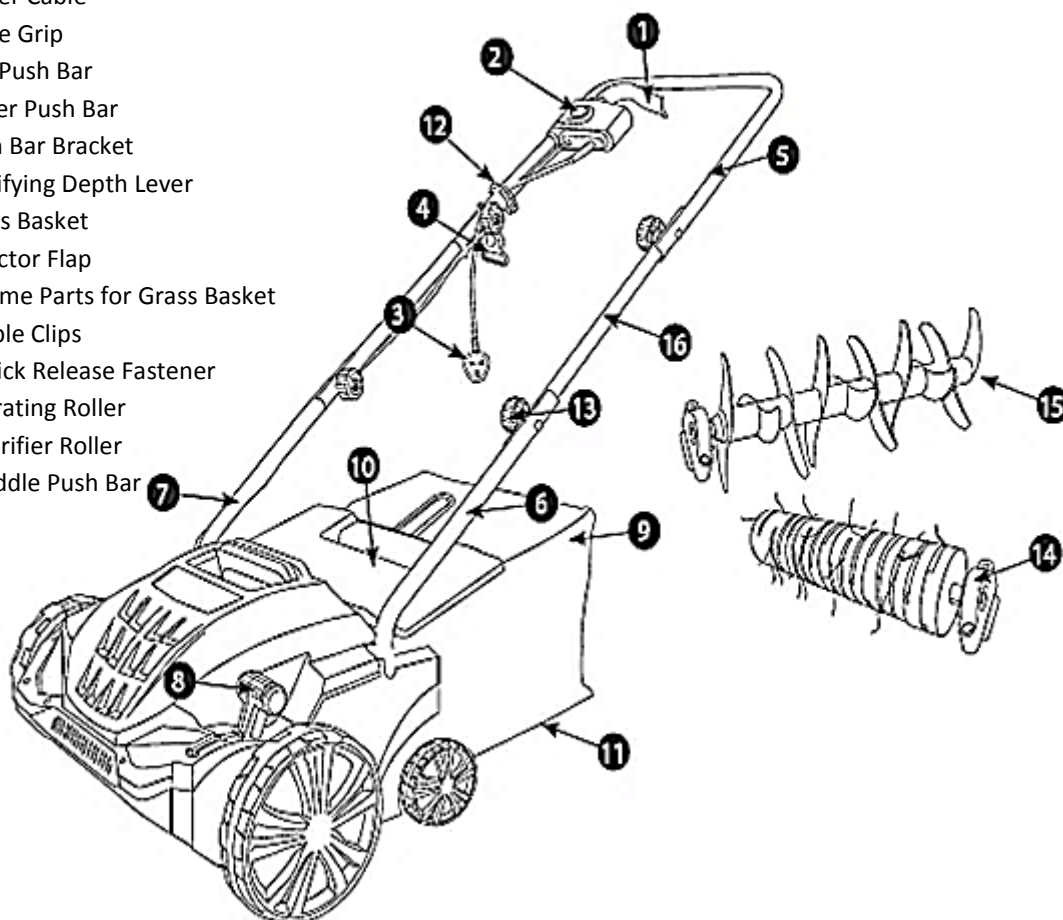

## PARTS

- 1.ON/OFF Switch
- 2.Safety Lock-Off
- 3.Power Cable
- 4.Cable Grip
- 5.Top Push Bar
- 6.Lower Push Bar
- 7.Push Bar Bracket
- 8.Scarifying Depth Lever
- 9.Grass Basket
- 10.Ejector Flap
- 11.Frame Parts for Grass Basket
- 12.Cable Clips
- 13.Quick Release Fastener
- 14.Aerating Roller
- 15.Scarifier Roller
- 16.Middle Push Bar



Head Office, 11 Bridge Street,  
Bishop's Stortford CM23 2JU  
Tel: 0844 482 4400\*  
Fax: 01279 756 595  
[www.coopersofstortford.co.uk](http://www.coopersofstortford.co.uk)

**Coopers**  
OF STORTFORD

\*Calls cost 7 pence per minute plus your  
telephone company's network access charge

**PRODUCT SPECIFICATION**

Rated Voltage:	230-240V
Rate Frequency:	50Hz
Input Power:	1500W
Working Width:	320mm
Working Depth (Rake):	-13mm to -5mm to -1mm to 3mm
Working Depth (Scarifier):	-4mm to 4mm to 8mm to 12mm
Grass Basket Capacity:	30L
Weight:	8.5kg
Measured Sound Power (Scarifier):	84.3dB
Measured Sound Power (Rake):	96.7dB
Measured Sound Pressure (Rake):	83.9dB
Measured Sound Power (Rake):	96.7dB
Guaranteed Sound Power Level:	97.3dB
Hand Arm Vibration (Rake):	3.7 m/s <sup>2</sup>
Hand Arm Vibration (Scarifier):	4.2 m/s <sup>2</sup>

**WARNING! PLEASE READ THESE INSTRUCTIONS CAREFULLY AND KEEP FOR FUTURE REFERENCE****INTENDED USE:**

Only operate the Rake & Scarifier for its intended purpose and within the parameters specified in this manual.

- This appliance is intended for domestic use only. It is not for commercial use.
- This appliance is not intended for use in wet or damp conditions.
- This appliance is not intended for use by persons with reduced physical, sensory or mental capabilities, or lack of experience and knowledge, unless supervised or given appropriate instruction concerning the product's use by a person responsible for their safety.
- This appliance is not a toy and is not for use by children. Keep the appliance, any attachment and its power cable out of reach.

**ASSEMBLY:**

The Rake & Scarifier is delivered unassembled. The grass basket and the complete push bar must be assembled and mounted before using the scarifier. Follow the operating instructions step-by-step.

**BEFORE USE:**

- Do not wear loose-fitting items of clothing and remove any jewellery which may be caught by the appliance. Long hair should be tied back.
- Always ensure you are wearing appropriate protective safety equipment (safety gloves and eye goggles) when operating this appliance. Failure to do so can result in serious injury.
- Ensure all parts are securely attached before use.
- Only operate the appliance in daylight or good artificial light.
- The appliance should only be used as rated. Preferably, the socket outlet should be protected by a Residual Current Device (RCD) with a tripping current of no more than 30mA.

Head Office, 11 Bridge Street,  
Bishop's Stortford CM23 2JU

Tel: 0844 482 4400\*

Fax: 01279 756 595

[www.coopersofstortford.co.uk](http://www.coopersofstortford.co.uk)

**Coopers**  
OF STORTFORD

\*Calls cost 7 pence per minute plus your  
telephone company's network access charge

**ASSEMBLING THE PUSH BAR:**

1. Insert the Lower Push Bar (6) into the slots on the body of the appliance and attach with screws provided.
2. Attach the Middle Push Bar (16) TO THE Lower Push Bar (6) using the Quick Release Fasteners (13) and screws.
3. Position and attach the Top Push Bar (5) to the Middle Push Bar (16).
4. Attach the cable using the Cable Clips (12) provided.

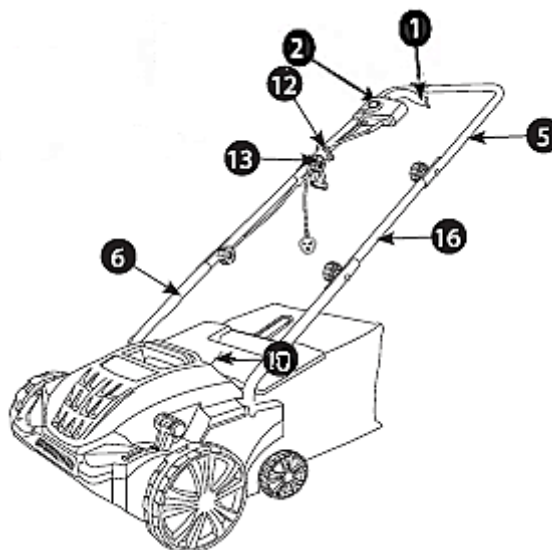
**ASSEMBLING THE GRASS BASKET:**

**WARNING!** Ensure the motor is switched off, unplugged and the cutting unit is not rotating before attempting to hook the Grass Basket onto the Scarifier.

To hook the Grass Basket on the Scarifier, lift the Ejector Flap (10) with one hand and, using the other hand, take hold of the Grass Basket by the handle and hook it into the Scarifier from above.

**OPERATION:**

**CAUTION:** To prevent accidental start-up, the Push Bar is equipped with a Safety Lock-Off (2) which must be pressed before the ON/OFF Trigger Lever (1) can be pressed. If the Trigger Lever is released, the appliance will switch itself off. Repeat this process several times so that you are sure the machine functions properly.

**WARNING!** Never open the Ejector Flap (10) while the motor is running. A rotating cutting unit can cause severe injuries.

**CAUTION:** Always fasten the Ejector Flap carefully. The Flap flips back to the "closed" position by the tension springs. Always ensure that the safe distance (provided by the long handles) is maintained between the user and the housing.

**CAUTION:** Be especially careful when scarifying and changing direction on slopes and inclines.

**IMPORTANT:** Remember to empty the Grass Basket regularly to maintain efficiency of the appliance.

**CAUTION:** Before removing the Grass Basket, ensure you have switched off, unplug the motor and wait until the Roller has come to a complete stop.

**TO REMOVE THE GRASS BASKET:**

Lift the Ejector Flap with one hand, while unhooking the Grass Basket with the other.

**HOW OFTEN SHOULD I SCARIFY MY LAWN?**

This is dependant upon on how quickly your grass takes for regrowth and the hardness of the soil.

**WARNING!** Before you perform any repair or maintenance work on the machine, ensure that the cutting unit is not rotating and that the power supply is disconnected.

**ADJUSTING THE DEPTH:**

The Scarifier depth is set with the adjustment mechanism. Pull the Scarifying Depth Lever (8) in the direction indicated by the arrow and adjust to the required position (1/2/3/4). Make sure that the Lever latches into place correctly.

- 1 = Scarifier depth 12mm
- 2 = Scarifier depth 8mm
- 3 = Scarifier depth 4mm
- 4 = Drive/Transport Position

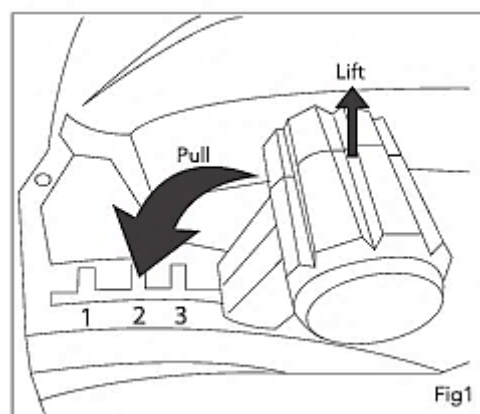
**MAINTENANCE:**

Always switch OFF and disconnect from the power supply and check the appliance and all moving parts have come to a complete stop before carrying out any servicing, inspection, storage, or to change an accessory.

Allow the machine to cool before making any inspections or adjustments and before storing.

- Maintain the machine with care and keep it clean.
- Keep all nuts, bolts and screws tight to be sure the equipment is in a safe working condition.
- Check the Grass Basket frequently for wear or deterioration.
- On machines with multiple assemblies, take care as rotating one tine assembly can cause another tine assembly to rotate.

**WARNING!** When adjusting the machine, be careful to prevent extremities becoming trapped between moving rollers and fixed parts of the machine.

**CAUTION:** When servicing the Roller assembly be aware that, even though the power source is switched off, the rollers can still be moved.

Replace worn or damaged parts for safety. Use only genuine replacement parts and accessories.

## CHANGING THE ROLLERS:

**CAUTION:** Before changing the rollers, first ensure that the appliance is switched off, disconnected from the mains power supply and that all moving parts have come to a complete stop.

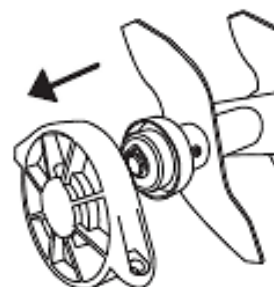
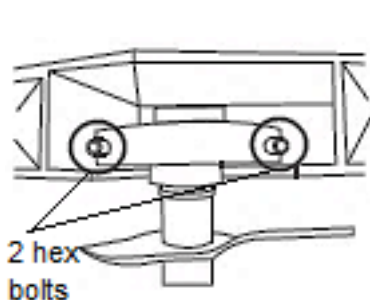

1. Gently turn the Rake & Scarifier on its side and locate the 2 hex bolts securing the roller. Exercising caution around the blades, remove the hex bolts using the hex key supplied and retain for future reference.

**IMPORTANT:** Ensure the roller is set to the lower position for easier removal.

2. Lift away the roller from the capped end.

3. Remove the cap located on the end of the roller by pulling in the direction shown.

**NOTE:** it may be necessary to use leverage to remove.

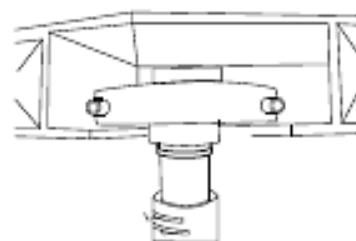
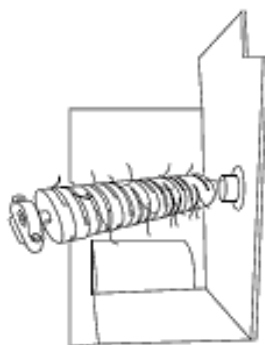
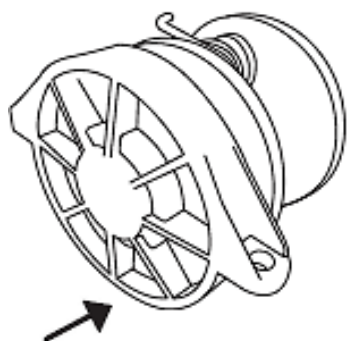

4. Simply push the cap on the end of the selected roller you are changing to.  
**NOTE:** Be sure to press on the cap firmly.

5. Replace the roller by aligning with the exposed pins on the body and slotting into place.

6. Secure the roller assembly back onto the body by reinserting and retightening the hex bolts. Once firmly in place, gently upright the Rake & Scarifier before turning the appliance on again.

**WARNINGS AND SAFETY INSTRUCTIONS:**

**When using any electrical powered appliance, these basic safety precautions should always be followed to reduce risk of fire, electrical shock, or injury to persons or property.**

- DO NOT USE THE RAKE & SCARIFIER IF ANY CRITICAL COMPONENTS SUCH AS MOVING OR ACTIVE PARTS APPEAR TO BE DAMAGED, LOOSE OR MISSING. SEEK ADVICE AND REPAIRS FROM A QUALIFIED ELECTRICIAN OR SERVICE PERSONNEL.
- BEFORE USE, CHECK THOROUGHLY FOR ANY DEFECTS AND DO NOT USE IF DEFECTS ARE FOUND. TAKE CARE NOT TO DROP THE APPLIANCE AS HEAVY IMPACTS MAY CAUSE INTERNAL DAMAGE.
- BEFORE CONNECTING THE APPLIANCE, CHECK IF THE VOLTAGE INDICATED ON THE BOTTOM OF THE APPLIANCE IS IN ACCORDANCE WITH THE MAINS VOLTAGE IN YOUR HOME.
- CHECK THE APPLIANCE AND POWER CABLE CAREFULLY FOR DAMAGE BEFORE EACH USE.
- BEFORE STARTING THE APPLIANCE, MAKE SURE THE TINES ARE NOT TOUCHING ANY OBJECT AND ARE FREE TO MOVE.
- GRIP THE PUSH BAR FIRMLY WITH BOTH HANDS. NEVER OPERATE WITH ONE HAND.
- DO NOT OVERREACH – KEEP PROPER FOOTING AND BALANCE AT ALL TIMES.
- DO NOT USE THE APPLIANCE ON A SLOPE THAT IS TOO STEEP FOR SAFE OPERATION. WHEN ON SLOPES, OPERATE THE APPLIANCE SLOWLY AND ENSURE YOU HAVE GOOD FOOTING.
- DO NOT OPERATE THE APPLIANCE WHILST TIRED OR UNDER THE INFLUENCE OF ALCOHOL, DRUGS OR MEDICATION.
- KEEP CHILDREN, PETS AND BYSTANDERS AWAY WHILE OPERATING THE APPLIANCE. DISTRACTIONS CAN CAUSE ACCIDENTS OR INJURY.
- WALK, NEVER RUN WITH THE APPLIANCE.
- DO NOT LUBRICATE ANY PARTS OR CARRY OUT ANY MAINTENANCE OR REPAIR WORK OTHER THAN THAT SHOWN IN THIS MANUAL.
- DO NOT INSERT ANY FOREIGN OBJECTS INTO THE APPLIANCE.
- ALWAYS WEAR SUITABLE GLOVES WHEN CLEANING OR PERFORMING MAINTENANCE.
- DO NOT EXPOSE THE APPLIANCE TO RAIN OR WET CONDITIONS AS WATER ENTERING THE APPLIANCE WILL INCREASE THE RISK OF ELECTRIC SHOCK.
- DO NOT OPERATE THE APPLIANCE IF IT HAS BEEN SUBMERGED IN WATER OR ANY OTHER LIQUID AS THIS MAY CAUSE ELECTRIC SHOCK, POTENTIAL INJURY OR DAMAGE TO THE APPLIANCE.
- DO NOT USE THE APPLIANCE FOR EXTENDED PERIODS OF TIME. USE IN SHORT PERIODS WITH REST IN BETWEEN. THE APPLIANCE PRODUCES EXCESSIVE VIBRATION WHICH CAN RESULT IN LOSS OF SENSE OF TOUCH, NUMBNESS, TINGLING AND REDUCED ABILITY TO GRIP. LONG TERM EXPOSURE MAY LEAD TO A PRELONGED AILMENT.
- IF NECESSARY, LIMIT THE AMOUNT OF TIME EXPOSED TO VIBRATION AND USE ANTI-VIBRATION GLOVES.
- DO NOT OPERATE THE APPLIANCE WITH HANDS BELOW A NORMAL COMFORTABLE TEMPERATURE AS VIBRATION WILL HAVE GREATER EFFECT.



- DO NOT MODIFY OR TAMPER WITH PARTS.
- USE ONLY AS DESCRIBED IN THIS MANUAL.
- IF THE APPLIANCE STARTS TO MALFUNCTION OR OPERATES IN A WAY DEEMED ABNORMAL BY THE USER, STOP USING THE APPLIANCE IMMEDIATELY. REFER TO THE TROUBLESHOOTING SECTION FOR GUIDANCE OR SEEK ADVICE FROM A QUALIFIED ELECTRICAL OR SERVICE ENGINEER. DO NOT ATTEMPT TO REPAIR THE APPLIANCE YOURSELF AS IMPROPER REPAIRS MAY PLACE THE USER AT SERIOUS RISK.
- DO NOT USE WITH DAMAGED CABLE OR PLUG. IF THE SUPPLY CABLE IS DAMAGED, IT MUST BE REPLACED BY A QUALIFIED ENGINEER OR AUTHORISED SERVICE AGENT IN ORDER TO AVOID A HAZARD.
- USE ONLY CABLE OF 1MM<sup>2</sup> WIDTH AND A MAXIMUM LENGTH OF 40M.
- TAKE CARE WHEN USING AN EXTENSION CABLE WHILE OPERATING THE APPLIANCE. BE CAREFUL NOT TO TRIP OVER THE CABLE AND ALWAYS GUIDE IT AWAY FROM THE BLADES. ONLY USE AN EXTENSION CABLE OF SUITABLE CURRENT.
- DO NOT PULL THE CABLE AROUND SHARP EDGES OR CORNERS.
- DO NOT CARRY THE APPLIANCE BY THE CABLE.
- DO NOT HANDLE THE PLUG OR APPLIANCE WITH WET HANDS.
- ALWAYS DIRECT THE CABLE TO THE REAR, AWAY FROM THE RAKE & SCARIFIER.
- DO NOT LEAVE UNATTENDED WHEN PLUGGED IN. UNPLUG FROM OUTLET WHEN NOT IN USE.
- TURN OFF ALL CONTROLS BEFORE UNPLUGGING.
- DO NOT UNPLUG BY PULLING ON THE CABLE. TO UNPLUG, GRASP THE PLUG, NOT THE CABLE.
- ALWAYS UNPLUG BEFORE PERFORMING USER MAINTENANCE, CONNECTING OR DISCONNECTING ATTACHMENTS OR CHANGING ACCESSORIES.
- ENSURE THE CABLE IS STORED SAFELY TO PREVENT HAZARDS.
- ALWAYS USE WITH A RESIDUAL CURRENT DEVICE (RCD) WITH A TRIPPING CURRENT OF NO MORE THAN 30MA.

**CAUTION:** Tines do not stop immediately after the appliance is turned off.

**CAUTION:** The appliance may bounce upward and/or jump forward if the tines strike extremely hard-packed soil, frozen grounds or buried obstacles such as large stones, roots or stumps. If the appliance strikes a foreign body, turn it off immediately and check for the cause. Repair before restarting.

**WARNING!**

Do not operate the appliance near underground electrical cables, telephone lines, pipes or hoses. Keep the supply cable away from the tines at all times.

**DANGER!** Failure to adhere to the safety instructions, operational guidelines and general safety procedures can result in serious injury or severe damage.

Head Office, 11 Bridge Street,  
Bishop's Stortford CM23 2JU  
Tel: 0844 482 4400\*  
Fax: 01279 756 595  
www.coopersofstortford.co.uk

**Coopers**  
OF STORTFORD

\*Calls cost 7 pence per minute plus your  
telephone company's network access charge

**OVERHEAT PROTECTION:**

If the motor is overloaded or the appliance is blocked by a foreign object, the protection device will switch the motor off automatically. Should this happen, release the ON/OFF trigger lever and wait for the motor to cool down for approximately 15 minutes before starting again.

**SAFETY SYMBOLS:**

The following safety symbols appear on this product. Please ensure you understand their meanings before operating this product in order to prevent personal injury and avoid damage to the appliance.



WARNING! Pay attention to all safety and guidance



Read manual before use



Wear eye and ear protection



Wear a dust mask



Wear protective gloves



Danger of being hit by thrown objects



DANGER! Rotating blades. Keep hands and feet at a safe distance.

**TROUBLESHOOTING**

Store this appliance carefully in a secure, dry place, out of reach of children.

**STORAGE**

Problem	Solution
Motor does not start.	Check the cable and fuse. Check the switches and seek repairs if necessary. Housing may be clogged. Clean the housing or adjust working depth. Connections may have been disconnected.
Engine performance drops.	Soil may be too firm. Change working depth. Housing may be clogged. Clean as necessary. Roller may be worn. Replace with a suitable replacement following the instructions in the "Changing the Rollers" section.
Imprecise scarifying results.	Roller may be worn. Replace with a suitable replacement. Wrong working depth. Adjust accordingly.
Motor is running but roller is not rotating.	Tooth belt is worn.

Head Office, 11 Bridge Street,  
Bishop's Stortford CM23 2JU

Tel: 0844 482 4400\*

Fax: 01279 756 595

www.coopersofstortford.co.uk

\*Calls cost 7 pence per minute plus your telephone company's network access charge

**Coopers**  
OF STORTFORD



**PLUG WIRING (UK & IRELAND):**

This appliance is fitted with a moulded BS 1363 **13-amp** plug. If you have to replace the fuse, only those that are ASTA or BSI approved to BS1362 and with a rated current of **13-amps** should be used. If there is a fuse cover fitted, this cover must be re-fitted after changing the fuse. If the fuse cover is lost or damaged the plug must not be used. Spare fuse holders and fuses are available from electrical outlets. If the socket outlets in your home or office are not suitable for this product's plug, the plug must be removed and disposed of safely. Attempts to insert the plug into the wrong socket is likely to cause electric hazard.

**CARE AND CLEANING INSTRUCTIONS:**

Caution! Always clean the appliance after each use. Failure to carry out proper cleaning can result in damage to the application or cause it to malfunction.

**Warning!** Injury can occur during work on the cutting blades. Wear protective gloves.

- Always switch off and unplug before cleaning.
- Do NOT immerse in water. Risk of electric shock.
- Do NOT use abrasive cleaners or sharp utensils to clean this appliance.
- Wipe surfaces with a soft dry cloth.
- Allow to dry thoroughly before further use.
- Store the appliance in a cool, dry place.

**DISPOSAL:**

- Dispose of all packaging, paper, cartons, plastic and plastic bags in accordance with your local recycling regulations.
- At the end of the product's lifespan please dispose of it at an authorised household WEEE waste recycling centre.

