

# Instructions for Hearing Amplifier

## Location of parts and controls

1. Microphone
2. Treble Booster
3. Bass Booster
4. Power off/Volume control
5. Phone Jack
6. Neck-Strap Holder
7. Battery Door
8. Belt Clip
9. Neck-Strap
10. Ear-Bud
11. Stereo Earphone

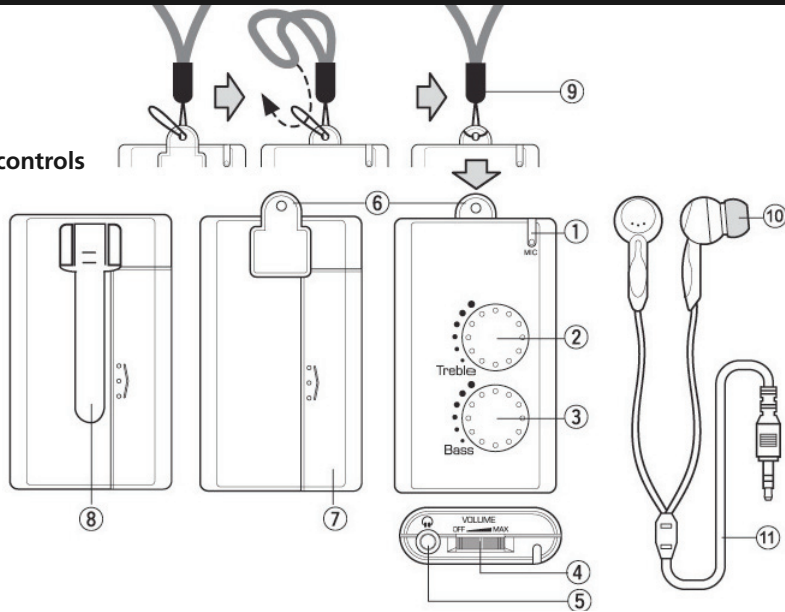

The Hearing Amplifier is a reliable personal amplifier that comes with volume control and High/Low frequency booster. This amplifier allows the listener to increase the sound level and adjust the frequency to assist with mild hearing loss (not intended as a medical device). It's ultra-sensitive directional microphone allows you to use the system to listen to lectures, conversations, TV and other forms of entertainment.

## Installation

- Lift the battery door (7) on back of the unit
- Place 1x UM-4 (AAA size or equivalent) battery inside the battery compartment (make sure the polarity is correct). Remove the battery when the unit is not used for a long time
- Insert the Stereo Earphone (11) to the Phone Jack (5)
- Place the Ear-Buds (10) comfortably into your ears
- Turn the Power on and adjust to the desired sound level with the Volume control (4). Set the power switch to off when the unit is not in use
- Adjust the Treble Booster (2) or Bass Booster (3) to optimise the listening level
- Replace the Neck-Strap Holder (6) with the Belt Clip and then clip the unit on a shirt pocket or belt