

# 4-WHEELED DUMPER TRUCK Instructions

8103

## Parts & Assembly

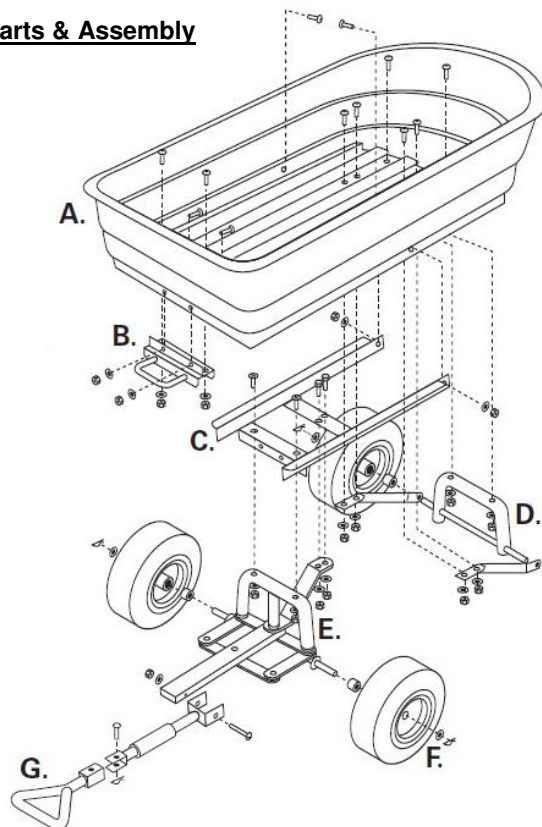

## Parts List (Qty)

- A. Tray (1)
- B. Lock Assembly (1)
- C. Front Frame (1)
- D. Rear Axle Assembly (1)  
(includes rear axle and left and right struts)
- E. Front Axle Assembly (1)
- F. 10 inch wheel (4)
- G. Handle (1)

## Fixings List (Qty)

- A. M8x60 Bolt (1)
- B. M8x40 Flat Head Bolt (2)
- C. M8x45 Truss Head Bolt (2)
- D. M8x20 Truss Head Bolt (10)
- E. M8x20 Hex Head Bolt (2)
- F. M8 Lock Nut (17)
- G. M8 Washer (17)
- H. Wheel Spacers (4)
- I. 16mm Washers (4)
- J. Cotter Pin (4)

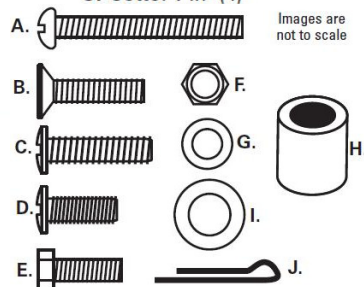

## Tools required (not supplied)

- 1 x Flat-head screwdriver
- 1 x Cross-head screwdriver
- 1 x Socket set or 2 x Adjustable Wrenches

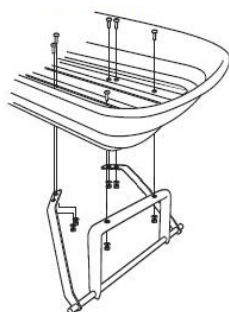

1. Attach pre-assembled rear axle section (Part D) to Tray (Part A) using 2 x Fixings C, F & G. Attach the struts using 2 x Fixings D, F & G. (left)
2. Attach the lock assembly (Part B) using 4 x Fixings D, F & G. (below)

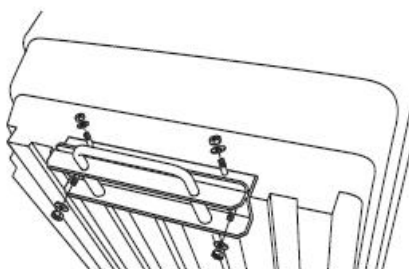

3. Join the front axle (Part E) to the front frame (Part C) using 2 x Fixings B, F & G. (far right)

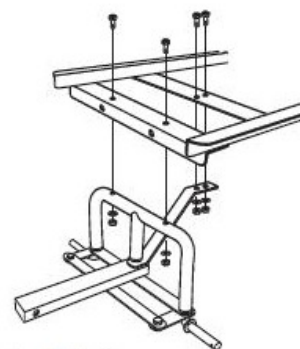

4. Attach rear axle assembly (Part D) to the tray (Part A) using 2 x Fixings E, F & G. (right)
5. Place 1 x wheel spacer (Fixing H) onto each axle. Put wheels (Part F) and each axle and secure with 1 x Fixing I and 1 x Fixing J. Bend out the ends of Fixing J to secure in place. (below)

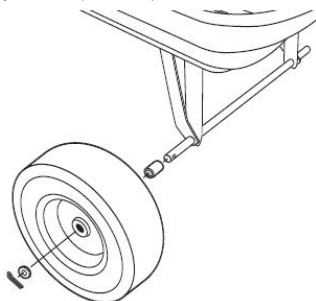

6. Attach the handle to the bar at the back of the rear axle using Fixings A, F & G. (right)

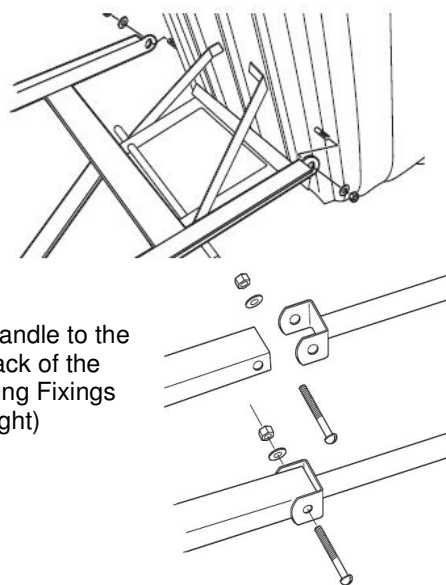

### **Operation**

To raise the dumper, pull the handle outwards to release the tray, and lift the handle to empty dumper. (see right)

When finished, lower the dumper back to its lowered position, ensuring the release handle is locked back into place. (see below)

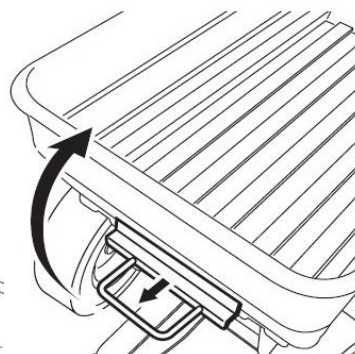

### **Packaging**

Dispose of the packaging at your local recycling centre.  
Dispose of paper and carton separately from plastic bags at your local recycling centre.  
Dispose of the item at the end of its lifespan at your local authorised household waste recycling centre.

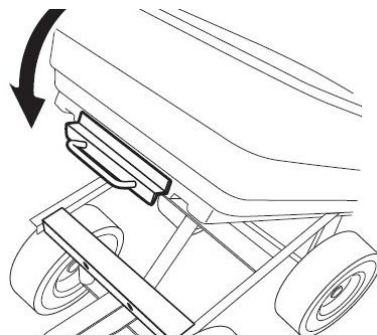

### **WARNING**

- Maximum load capacity: 270kg
- Maximum dumping load capacity: 135kg
- Ensure load is evenly distributed when in use.
- Periodically check tyres to ensure pressure is maintained.

**Head Office:**  
11 Bridge Street  
Bishops Stortford  
Hertfordshire  
CM23 2JU

**Customer Services:**  
Tel: 0844 482 4400  
Fax: 01279 756595

**Coopers**  
OF STORTFORD