

# Bath & Shower Caddy 9357

## Instructions

### PARTS

Check that all parts are present before assembly:

Shelves	x3
Extension Pole	x1
Long Poles	x2
Short Pole	x1
Top fitting	x1
Base fitting	x1
Shelf support washers	x3

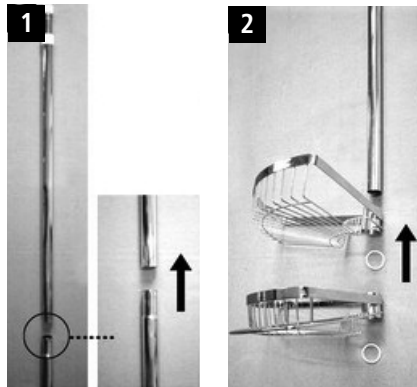
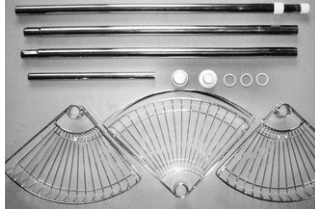

### ASSEMBLY

- Attach one of the long poles to the base of the extension pole. (see fig.1)
- Slide 2x shelves up the pole, with a shelf support washer underneath each shelf. (see fig.2)
- Attach the second long pole to the base of the assembled section. (see fig.3)
- Slide the third shelf up the pole to the desired height with a shelf support washer underneath the shelf. (see fig.4)
- Attach the base fitting to the base of the assembled section. (see fig.5)
- Attach top fitting to short pole and fit short pole. (see fig.6)
- To loosen the extension pole, twist upper section in an anti-clockwise direction and extend. To secure in position, twist in a clockwise direction. (see fig.7)

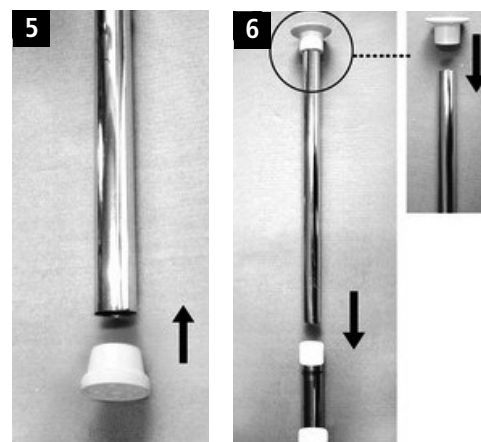
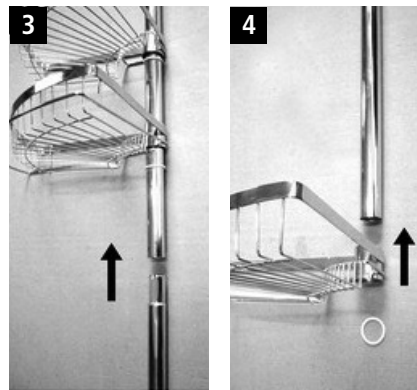

### USE

- Maximum weight load limit: 3kg per shelf.
- Do not exceed maximum weight load limit.
- Extendable from 145cm to 250cm.
- Position assembled pole and secure the extending pole.

### CLEANING

- Clean using a diluted neutral detergent and dry fully with a soft cloth.
- To prolong the life of the product, dry fully after showering.

### PACKAGING DISPOSAL:

- Dispose of all paper, cartons and plastic in accordance with your local recycling regulations. At the end of the product's lifespan please dispose of it at an authorised household waste recycling centre.



Please read carefully before use and retain for future reference.

Head Office, 11 Bridge Street,  
Bishop's Stortford CM23 2JU  
Tel: 0844 482 4400  
Fax: 01279 756595  
www.coopersofstortford.co.uk

**Coopers**  
OF STORTFORD