

PARTS

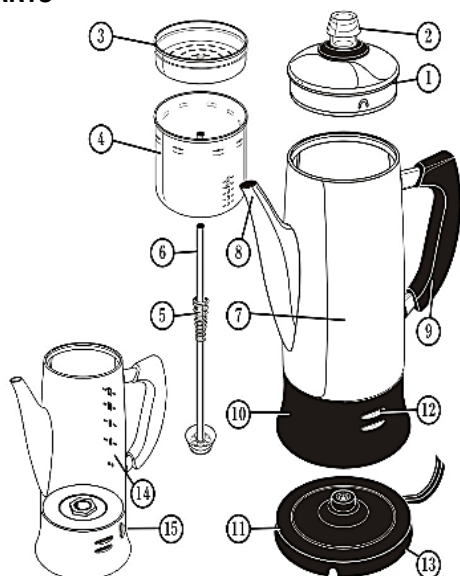

1. Stainless Steel Cover - lock-down cover to ensure safe pouring.
2. Transparent Percolator Knob – allows you to see the percolating process.
3. Coffee Basket Lid
4. Coffee Basket – holds ground coffee to make 4-12 cups of coffee.
5. Spring
6. Pump Tube – delivers the water automatically from the carafe to the basket.
7. Stainless Steel Body – holds from 4 to 12 cups coffee.
8. Tapered Spout – for no-mess, drip-less pouring.
9. Comfort Grip Handle – ergonomically designed for easy pouring.
10. Stay-Cool Base – prevents heat damage to tables and counters.
11. Power Base – the percolator is removed from the power base for cordless convenience when serving.
12. Indicator Lights– green light illuminates to indicate that the brewing cycle has begun. Then red light illuminates when the warming cycle begins.
13. Cord Wrap – located under base, keeps counter clutter free and is ideal for storage.
14. Water Level Markings - Convenient and easy to see measurement marks. Note: The 4 cup water line is level with the bottom handle weld mark.
15. ON / OFF Power Switch

BEFORE USE

- Check all parts, including the power cable, for damage and retain for future reference.
- Clean thoroughly before first use.

USE

- Remove the cover, basket, lid & pump tub.
- Fill the percolator with water based on the number of cup (see Brewing guide). Do not fill water above the max water level.
- To prevent small coffee granules from sifting through the basket, run cold water over the basket.
- Add the desired amount of coffee to the basket.
- Place the basket and pump assembly into the Percolator and put on the lid. Ensure the steam vents in the lid are facing away from the handle.
- Make sure the power switch is in off position.
- Place the percolator onto the base and plug into the mains.
- Press the switch to on position. The green LED indicator will illuminate showing that the power is on.
- Brewing will begin shortly after powering up and will continue at approximately one cup per minute.
- Once brewing is complete, the red LED indicator will illuminate signalling the coffee is ready. The percolator will continue to keep the coffee warm when the red LED indicator is illuminated.
- Remove the cover carefully and remove the basket and pump tube before serving. Always use an oven glove when handling the basket and pump tube.
- After use replace the cover

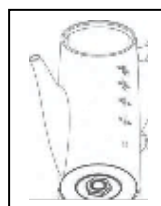
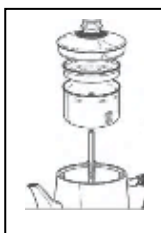

BREWING GUIDE

See brewing guide below (Note: all times are approximate and can be adjusted according to personal taste, 1 coffee measure = 2 level tablespoons).

Cups	Brew Strength		
	Mild	Medium	Strong
12	6	8	10
10	5	7	9
8	4	6	8
6	3	4	6
4	2	3	4

WARNING

- CHECK ALL PARTS FOR DAMAGE BEFORE USE. DO NOT USE IF DAMAGED IN ANY WAY.
- CHECK THE VOLTAGE SHOWN ON THE UNIT MATCHES THE MAINS VOLTAGE IN YOUR HOME.
- DO NOT TOUCH HOT SURFACES SUCH AS THE STAINLESS STEEL PARTS OF THE PERCOLATOR.
- ALWAYS USE THE HANDLES AND KNOBS.
- ALWAYS SWITCH OFF AND UNPLUG FROM THE MAINS WHEN NOT IN USE. UNPLUG BY PULLING THE PLUG ITSELF. DO NOT PULL ON THE POWER CABLE.
- DO NOT IMMERSE THE BASE OR POWER CABLE IN WATER OR ANY OTHER LIQUID.
- KEEP AWAY FROM CHILDREN.
- FOR INDOOR, DOMESTIC USE ONLY.
- KEEP AWAY FROM HEAT SOURCES.
- DO NOT ALLOW THE POWER CABLE TO HANG OVER THE EDGE OF THE WORK SURFACE OR TO TOUCH HOT SURFACES.
- ALWAYS FILL WATER ABOVE THE MINIMUM LEVEL AND BELOW THE MAXIMUM LEVEL.
- DO NOT OPERATE WHEN WATER IS BELOW THE MINIMUM LEVEL.
- ALWAYS FILL THE PERCOLATOR JUG WITH WATER AND PLACE ONTO THE BASE BEFORE PLUGGING IN AND SWITCHING ON.
- DO NOT REMOVE THE LID DURING THE BREWING CYCLE AS HOT STEAM MAY SCALD.
- ALWAYS ENSURE THE LID IS SECURE BEFORE SERVING.
- THIS UNIT SHOULD NOT BE USED BY PERSONS (INCLUDING CHILDREN) WITH REDUCED PHYSICAL, SENSORY OR MENTAL CAPABILITIES, OR LACK OF EXPERIENCE AND KNOWLEDGE, UNLESS THEY HAVE BEEN GIVEN SUPERVISION OR INSTRUCTION CONCERNING USE OF THE APPLIANCE BY A PERSON RESPONSIBLE FOR THEIR SAFETY.

PLUG WIRING (UK & IRELAND)

This appliance is fitted with a BS 1363 13-amp plug. If you have to replace the fuse, only those that are ASTA or BSI approved to BS1362 and with a rated current of 13-amperes should be used. If there is a fuse cover fitted, this cover must be re-fitted after changing the fuse. If the fuse cover is lost or damaged the plug must not be used. Spare fuse holders and fuses are available from electrical outlets. If the socket outlets in your home or office are not suitable for this product's plug, the plug must be removed and disposed of safely. Attempts to insert the plug into the wrong socket is likely to cause electric hazard. A replacement plug should be wired according to the following instructions:

The cable

A mains electricity cable contains two or three inner wires. Each has a core of copper and an outer layer of flexible plastic. This product is earthed; the wires in the cord set are colour coded in the following way:

BLUE NEUTRAL

BROWN LIVE

GREEN & YELLOW EARTH

The diagram below shows the key features of a correctly wired three-pin mains plug.

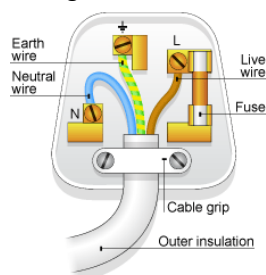
**Note:**

Double insulated appliances do not need the green & yellow Earth wire. They may only have the Brown and Blue wires.

CLEANING

- Always unplug from the mains, remove from the base and allow to cool before emptying for cleaning.
- Remove the lid, basket and basket cover. Discard the used ground coffee.
- The lid basket, basket cover and pump are all dishwasher safe. We recommend removing from the dishwasher after the washing cycle and drying by hand to prevent over-exposure to corrosive salts in the dishwasher which, over time, may tarnish these parts. Never wash percolator body or power base in dishwasher.
- Never immerse the percolator body or base in water or any other liquid.
- Wipe clean the percolator body and base with a soft, damp cloth and dry thoroughly before storing.
- Do not use abrasive cleaners or scourer pads.
- Should ground coffee become trapped around the washer, loosen and wash under a tap to clean.

DISPOSAL

- Dispose of all paper, cartons and plastic in accordance with your local recycling regulations.
- At the end of the product's lifespan please dispose of it at an authorised household waste recycling centre.

