

# Electric Nail Trimmers 9775

Please read carefully before use and retain for future reference.

## Instructions

v1.0: 08/12/14

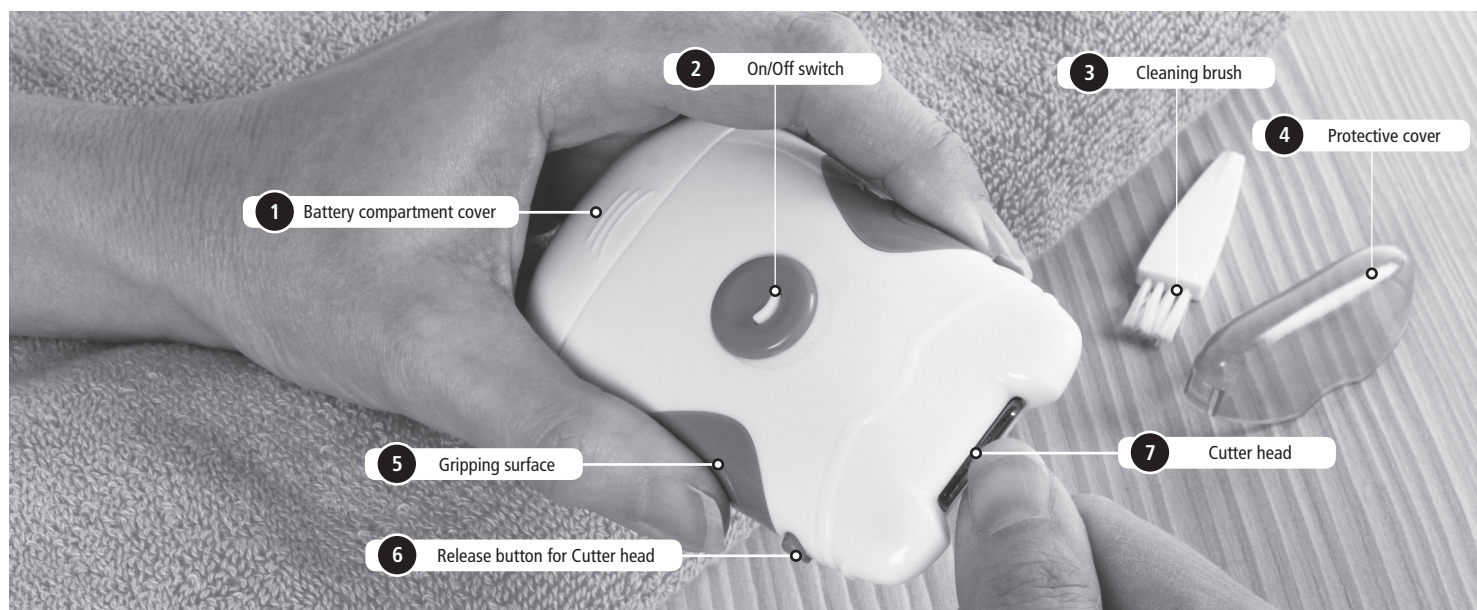

### USING

1. Remove the protective cover (4) from the trimmers.
2. Press and hold the on/off switch (2) and slide it forwards to power on the trimmers.
3. Hold the trimmers with one hand so that the cutter head (7) is parallel to the fingernail.
4. Move the cutter head evenly, slowly and with little pressure alongside the fingernail. Lead the cutter head in semi-circle movements around the fingernail to cut the nail. The cutting result depends on the speed, intensity and duration of the treatment.
5. Push the on/off switch (2) back to switch off the device.
6. After each use, put the protective cover (4) back on the cutter head.



### CLEANING

- If you do not use the trimmers for a longer period of time, remove the batteries.
- Do not clean the housing of the device with abrasive or aggressive chemicals in order not to damage the surfaces. Only clean the unit with a lightly moistened cloth.
- Make sure that no liquids can enter the interior of the device. Do not clean the cutter head with water.
- Clean the cutter head in regular intervals:

Depress both blue releasing buttons (6) that are located below the cutter head and carefully detach the cutter head (7). Use the supplied cleaning brush (3) to remove all cutting remains. Then reattach the cutter head on the device and secure it with the protective cover (4).



### STORING

- Store the device indoors in a dry place that is protected from dust, dirt and extreme temperatures.
- Store it out of reach of children.

### SAFETY NOTES

Please note the following safety notes to avoid malfunctions, damage or physical injury:

- Dispose of the packaging materials carefully; keep away from children.

- Use this device only for cutting your fingernails or toenails.
- Keep the unit out of reach of children. It is not a toy.
- If you do not plan to use the unit for some time, remove the batteries. Do not disassemble, burn, or short-circuit batteries and do not attempt to recharge non-rechargeable batteries.
- Do not expose the unit to direct sunlight, humidity, dirt, extreme temperature, strong light or strong magnetic fields. Do not allow liquids to enter the inside of the housing.
- Do not disassemble and modify the unit or attempt to repair it yourself. It does not contain serviceable parts. In case of questions or problems, contact customer services.

### INSERTING/REPLACING THE BATTERIES

1. The battery compartment is located at the bottom of the device. Press on the two ribbed areas of the battery compartment cover (1) and pull the cover from the device to open the battery compartment.
2. Insert two (AA) batteries into the battery compartment. Pay attention to the proper polarity of the batteries. The polarity is printed inside the battery compartment.
3. Close the battery compartment with the cover (1).

Replace both batteries if the performance of the device gets weaker.

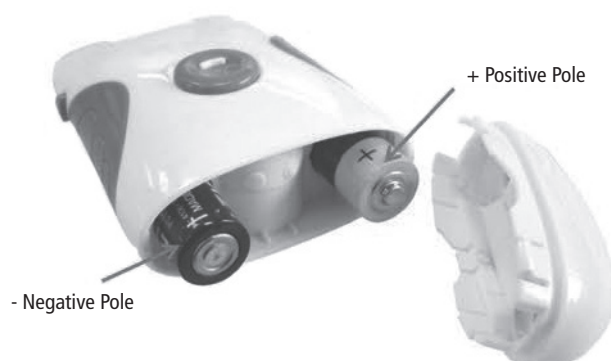

Disposal of Packaging:  
Dispose of the packaging at your local recycling centre.  
Dispose of paper and carton separately from plastic bags at your local recycling centre.  
Dispose of the unit at the end of its lifespan at your local authorised household waste recycling centre.

Head Office, 11 Bridge Street,  
Bishop's Stortford CM23 2JU  
Tel: 0844 482 4400  
Fax: 01279 756595  
www.coopersofstortford.co.uk

**Coopers**  
OF STORTFORD