

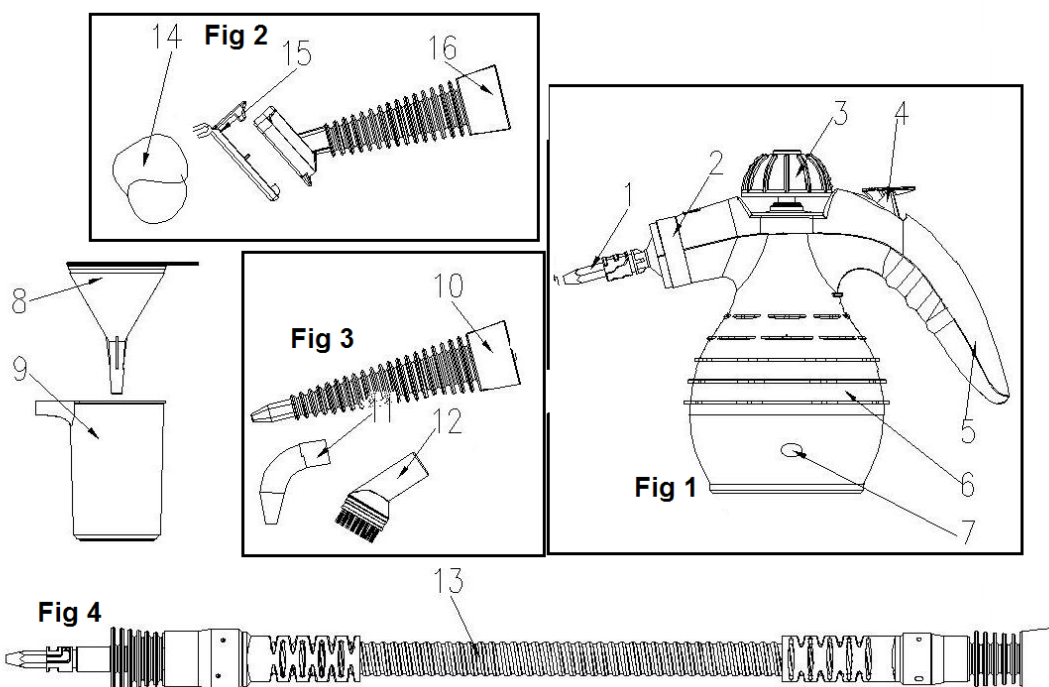

## Technical Details:

**Input voltage:** 220-240V~ 50Hz  
**Power:** 900-1050W  
**Water capacity:** 350 ml

**Autonomy:** 7 min (continue)  
**Steam rate:** 28 g/min  
**Pressure:** 2.8 bars



- |                       |                          |                                      |
|-----------------------|--------------------------|--------------------------------------|
| 1. Short spray nozzle | 7. Power indicator light | 13. Extended connecting spray nozzle |
| 2. Lock Ring          | 8. Funnel                | 14. Towel sleeve                     |
| 3. Safety cap         | 9. Measuring cup         | 15. Windows/doors spray nozzle       |
| 4. Steam button       | 10. Long spray nozzle    | 16. General spray nozzle             |
| 5. Handle             | 11. Bent Spray nozzle    |                                      |
| 6. Body               | 12. Round brush nozzle   |                                      |

The steam cleaner is designed for cleaning bathrooms, toilets, kitchens, glass and mirrors, clothes, as well as most other smooth surfaces. Hot steam cleans as it dissolves oily and greasy substances.

### IMPORTANT

1. Do not turn on power supply until the tank is full of water.
2. During operation the tank mouth must be plugged hermetically and the safety cap must be tightened in position.
3. In use, the machine body must not be inclined more than 45 degrees. Otherwise boiling water will be sprayed out together with steam.
4. Do not direct steam towards persons, animals or electrical products.
5. Never overfill the tank. The water capacity is 350mls, but we recommend filling the water tank only to 250ml to avoid the steam generator to produce too much steam during use.
6. Do not add anything to the water in the tank.
7. **WARNING:** Danger of scalding.

### Before using this unit for the first time

Unpack product, check accessories and documents supplied with the product and make sure that the product and accessories are not damaged.

Before use, please read the instruction manual carefully. The steam cleaner is only for use in households. First, place the steam cleaner on a flat surface, push down the safety cap, (Fig 5), unscrew it counter clockwise (Fig 6) and then position the funnel. Do not open the safety valve when using the appliance. Only turn on the safety valve when power is cut and the appliance is completely cooled down. Fill the measuring cup with a maximum of 175ml of clean water and add the water into the tank. Do not overfill the tank, some space must be left in the tank. Put back the safety cap and tighten it in position.

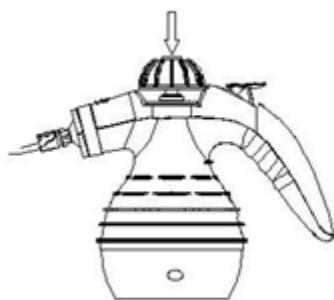

Fig.5

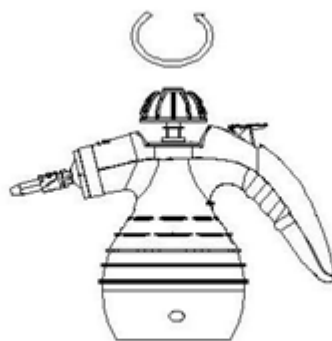

Fig.6



Fig.7

### Operation

After plugging in the unit, it will take around 4 minutes for the steam cleaner to get ready for use. The indicator light (7) will turn on and the machine immediately starts heating process.

If there is steam sprayed out, please attach accessories as required after you release the button.

Press down the steam button again in order to start cleaning operation as required.

### Installation of accessories

Install the long spray nozzle (10) or extended connecting spray nozzle (13). Hold the pipe section of the long spray nozzle in your hand, align the arrow with the single-line mark on the short spray nozzle (1) on the machine body, and insert the long spray nozzle in position. Rotate the long spray nozzle in a clockwise direction, and align the arrow on it with the double-line mark on the short spray nozzle on the machine body as shown in figure (I). To remove the long spray nozzle, rotate it counter clockwise as shown in figure (II) and align the arrow on the spray nozzle with the single-line mark on the machine body. Then the long spray nozzle can be pulled out. For the extended connecting spray nozzle (13) you have to use the same procedure as shown above. Install the spray nozzle with round brush (12) or bent spray nozzle (11). For direct installation on short spray nozzle (1), aim the spray nozzle with round brush or bent spray nozzle at the top of spray nozzle, as shown in figure (III), and push the spray nozzle upwards until it is in position.

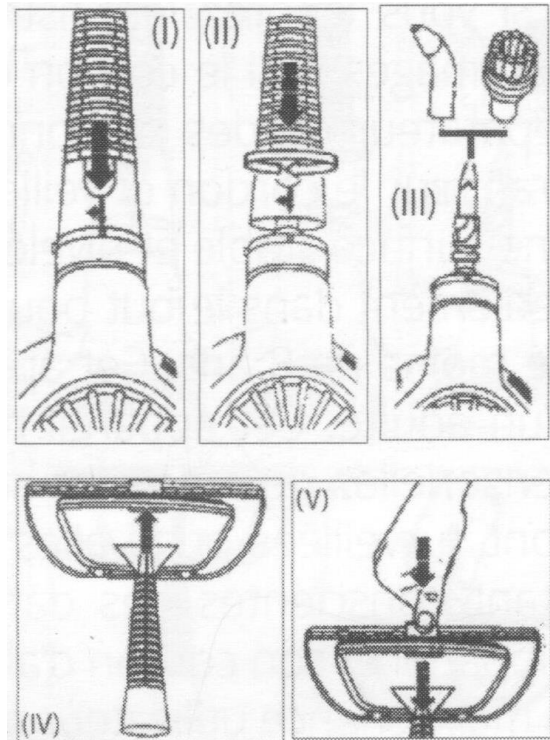

Installation of the spray nozzle for doors/windows (14 & 15). First install the general spray nozzle (16) on short spray nozzle (1), as shown in figure (IV). Install the two small hooks of the spray nozzle for doors/windows (15) onto the suspension lugs of the general spray nozzle, and then trigger the big hook of the spray nozzle for doors/windows and push the spray nozzle for doors/windows up and clutch (V) it onto the body of the general spray nozzle.

### Use

#### Disinfection and sterilization

Install the long spray nozzle (10) on the short spray nozzle (1) and aim the spray nozzle at the position that needs disinfecting, then press down the steam button. High temperature steam can kill bacteria.

#### Cleaning clothes

Install the general spray nozzle (16) on the short spray nozzle (1) and then mount the towel sleeve (14). Aim it at hanging clothes, and press down the steam button and move the general spray nozzle up and down as well as to the left and to the right at the same time to remove stains from clothes.

## Cleaning doors and windows

Install the general spray nozzle (16) on the short spray nozzle (1) and then install the spray nozzle for doors/windows (15). Aim this at the door/window and press down the steam button and move it up and down as well as to the left and right at the same time to remove stains from doors and windows.

## Cleaning floor boards

Install the bent spray nozzle (11) or round spray nozzle (12) on the long spray nozzle (10). For spots in difficult places you can also use the extended spray nozzle (13). Then aim it at the floor board, and press down the steam button to remove dirt and stains in wall corners and on the floor.

## Refilling water during operation

- Unplug the power cord and disconnect from the power supply.
- Press down the steam button to release the pressure until no more steam is ejected.
- Slowly unscrew the safety cap but do not remove it, and residual steam will be discharged slowly until no more steam comes out. Then make sure the machine cools down for about five minutes. Finally, completely remove the safety cap.
- Use the funnel and measuring cup to refill a suitable quantity of cold or hot water into the tank.
- Re-install the safety cap onto the machine body and tighten it in position.

## After use

When finished cleaning, unplug the power cord and disconnect the power supply.

Press down the steam button to release the pressure until there is no more steam ejected. (Fig 8)

Slowly unscrew the safety cap but do not remove it, and residual steam will be discharged slowly until no steam comes out. Then make sure the machine cools down for about 5 minutes. Finally, completely remove the safety cap. (Fig 9)

Empty the residual water in the tank and clean the external surface with a piece of dry cloth. (Fig 10)

Lastly, re-install the safety cap onto the machine body and tighten in position.

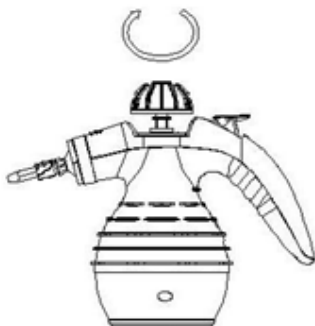

Fig.8

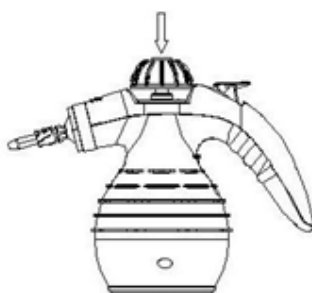

Fig.9

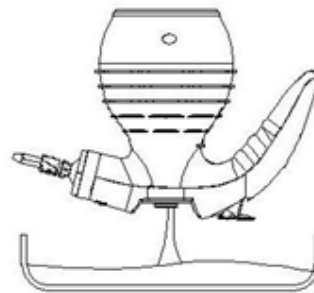

Fig.10

**Maintenance and cleaning**

In order to increase the steam cleaner's life-span, users must follow the maintenance routine.

1. Correctly use the product according to the instructions. After each use, unplug the power cord.
2. After the appliance is completely cooled down, unscrew the safety valve and pour remaining water out of the tank. Clean and dry the tank.  
Do not use abrasive sponges to clean your steam cleaner  
Clean your steam cleaner fully after every 10 uses.
3. Put all cleaned components into the carton in sequence. Then store in ventilated dry place.

**Type of water to use**

You can use normal tap water to fill the tank. However, if you live in an area where the water is very hard, it is recommended you mix it with distilled water or use distilled water only.

It is recommended to empty the tank after use in order to not create lime-scale build-up inside the tank.

Do not add anything to the water in the tank and do not use water from clothes dryers, scented or softened water, water from refrigerators, batteries or air conditioners and rain water. These contain organic waste or mineral elements that become concentrated when heated and cause spitting, brown staining or premature wear to the tank. Use of these types of water will negate the guarantee provided with the product.

**Trouble shooting**

PROBLEM	POSSIBLE REASONS	SOLUTIONS
There is no steam	No power	Verify that the socket outlet is operating and if properly plugged in
	There is no water in the unit	Fill with 175ml maximum water (see USE)
There is not enough steam	Voltage is too low or not stable enough	Verify that the socket outlet is operating and if properly plugged in
	Water level may be low	Top up/fill with water (see USE) (maximum 175ml)
Straight nozzle drips water	Steam cleaner is filled with too much water	Pour out some water. the max capacity is 175ml



PROBLEM	POSSIBLE REASONS	SOLUTIONS
	The unit incline too high	The machine body must not be inclined at more than 45 degrees. Otherwise boiling water will be sprayed out together with steam.
Pre-heating time is too long	Voltage is too low or not stable enough	Verify that the socket outlet is operating and if properly plugged in

**WARNINGS AND SAFETY INSTRUCTIONS:**

WHEN USING ELECTRICAL APPLIANCES, BASIC SAFETY PRECAUTIONS SHOULD ALWAYS BE FOLLOWED:

- READ ALL INSTRUCTIONS BEFORE USE.
- FOR DOMESTIC INDOOR USE ONLY.
- DO NOT TURN ON THE POWER SUPPLY UNTIL THE TANK IS FULL OF WATER.
- DURING OPERATION THE TANK MOUTH MUST BE HERMETICALLY SEALED AND THE SAFETY CAP MUST BE TIGHTENED IN POSITION.
- THE MACHINE BODY MUST NOT BE INCLINED AT MORE THAN 45 DEGREES. OTHERWISE BOILING WATER WILL BE SPRAYED OUT TOGETHER WITH STEAM.
- DO NOT DIRECT STEAM TOWARDS PERSONS, ANIMALS OR ELECTRICAL PRODUCTS.
- DO NOT USE OUTDOORS OR FOR COMMERCIAL USE.
- BEFORE USE, CHECK THOROUGHLY FOR ANY DEFECTS AND DO NOT USE IF DEFECTS ARE FOUND. TAKE CARE NOT TO DROP THE APPLIANCE AS HEAVY IMPACTS MAY CAUSE INTERNAL DAMAGE.
- BEFORE CONNECTING THE APPLIANCE, CHECK IF THE VOLTAGE INDICATED ON THE BOTTOM OF THE APPLIANCE IS IN ACCORDANCE WITH THE MAINS VOLTAGE IN YOUR HOME.
- CHECK THE APPLIANCE AND POWER CABLE CAREFULLY FOR DAMAGE BEFORE EACH USE.
- THIS APPLIANCE CAN BE USED BY CHILDREN AGED FROM 8 YEARS AND ABOVE AND PERSONS WITH REDUCED PHYSICAL, SENSORY OR MENTAL CAPABILITIES OR LACK OF EXPERIENCE AND KNOWLEDGE IF THEY HAVE BEEN GIVEN SUPERVISION OR INSTRUCTION CONCERNING USE OF THE APPLIANCE IN A SAFE WAY AND UNDERSTAND THE HAZARDS INVOLVED. CHILDREN SHALL NOT PLAY WITH THE APPLIANCE. CLEANING AND USER MAINTENANCE SHALL NOT BE MADE BY CHILDREN WITHOUT SUPERVISION.
- CHILDREN OF LESS THAN 3 YEARS SHOULD BE KEPT AWAY UNLESS CONTINUOUSLY SUPERVISED.
- **SOME PARTS OF THIS PRODUCT CAN BECOME VERY HOT AND CAUSE BURNS. PARTICULAR ATTENTION HAS TO BE GIVEN WHERE CHILDREN AND VULNERABLE PEOPLE ARE PRESENT.**
- THE USE OF ANY ACCESSORY ATTACHMENTS NOT RECOMMENDED BY COOPERS OF STORTFORD MAY CAUSE INJURIES AND INVALIDATE ANY WARRANTY YOU MAY HAVE.
- DO NOT LET THE POWER CABLE HANG OVER THE EDGE OF A TABLE OR COUNTER, OR TOUCH HOT SURFACES.
- DO NOT PLACE ON OR NEAR HEAT SOURCES.
- DO NOT COVER THE ITEM IN ANY WAY WHEN IN USE AS THIS MAY CAUSE OVERHEATING.
- DO NOT USE THIS APPLIANCE FOR ANY OTHER USE THAN THE INTENDED USE IT IS DESIGNED FOR.
- ENSURE THERE IS SUFFICIENT DISTANCE BETWEEN THIS APPLIANCE AND OTHER ITEMS ON THE WORK SURFACE OR WORK STATION, OR SUFFICIENT DISTANCE BETWEEN THE APPLIANCE AND THE CONFINES OF THE AREA IN WHICH IT IS SITUATED. WE RECOMMEND A MINIMUM CLEARANCE AROUND ALL FACES OF AT LEAST 10CM.

Head Office, 11 Bridge Street,  
Bishop's Stortford CM23 2JU  
Tel: 0844 482 4400\*  
Fax: 01279 756 595

[www.coopersofstortford.co.uk](http://www.coopersofstortford.co.uk)

**Coopers**  
OF STORTFORD

\*Calls cost 7 pence per minute plus your  
telephone company's network access charge

- ALLOW THE ITEM TO COOL THOROUGHLY BEFORE PUTTING ON OR TAKING OFF PARTS.
- TO PROTECT AGAINST ELECTRIC SHOCK, DO NOT IMMERSE POWER CABLE, PLUG OR APPLIANCE, IN WATER OR ANY OTHER LIQUID.
- UNPLUG FROM OUTLET WHEN NOT IN USE AND BEFORE CLEANING.
- DO NOT OPERATE ANY APPLIANCE WITH A DAMAGED POWER CABLE OR PLUG OR AFTER THE APPLIANCE MALFUNCTIONS, OR HAS BEEN DAMAGED IN ANY MANNER. WE RECOMMEND THAT THE POWER CABLE IS NOT KINKED OR STORED IN A TWISTED MANNER, AND THAT YOU REGULARLY CHECK ITS CONDITION.
- ANY REPAIRS MUST BE CONDUCTED BY A QUALIFIED ELECTRICIAN OR ELECTRICAL SERVICE AGENT.

### PLUG WIRING (UK & IRELAND)

This appliance is fitted with a BS 1363 13-amp plug. If you have to replace the fuse, only those that are ASTA or BSI approved to BS1362 and with a rated current of 13-amperes should be used. If there is a fuse cover fitted, this cover must be re-fitted after changing the fuse. If the fuse cover is lost or damaged the plug must not be used. Spare fuse holders and fuses are available from electrical outlets. If the socket outlets in your home or office are not suitable for this product's plug, the plug must be removed and disposed of safely. Attempts to insert the plug into the wrong socket is likely to cause electric hazard. A replacement plug should be wired according to the following instructions:

### The cable

A mains electricity cable contains two or three inner wires. Each has a core of copper and an outer layer of flexible plastic. This product is earthed; the wires in the cord set are colour coded in the following way:

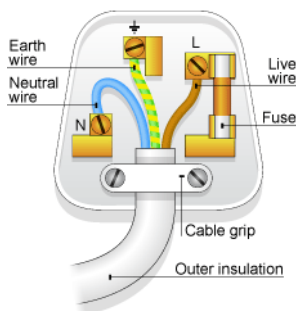

The diagram below shows the key features of a correctly wired three-pin mains plug.

BLUE	NEUTRAL
BROWN	LIVE
GREEN & YELLOW	EARTH

### DISPOSAL

- Dispose of all packaging, paper, cartons and plastic, plastic bags in accordance with your local recycling regulations.
- At the end of the product's lifespan please dispose of it at an authorised household WEEE waste recycling centre.

