



INSTRUCTIONS FOR USE:

1. Only use acrylic or water based paints (no enamel or oil-based paints.)
2. Always stir paint thoroughly before use.
3. If paint is too thick, mix in a little water as per manufacturers' instructions to achieve desired consistency.
4. For quality finish, always apply two coats.
5. Only apply the second coat when the first coat is completely dry.
6. As with all DIY/decorating activities, always make sure that you take the appropriate security precautions.
7. If edger head is loose, it has not been pushed on to the handle firmly enough. Do not be afraid to use a little force to secure the edger head.

Parts

Paint Roller & Flocked Edger

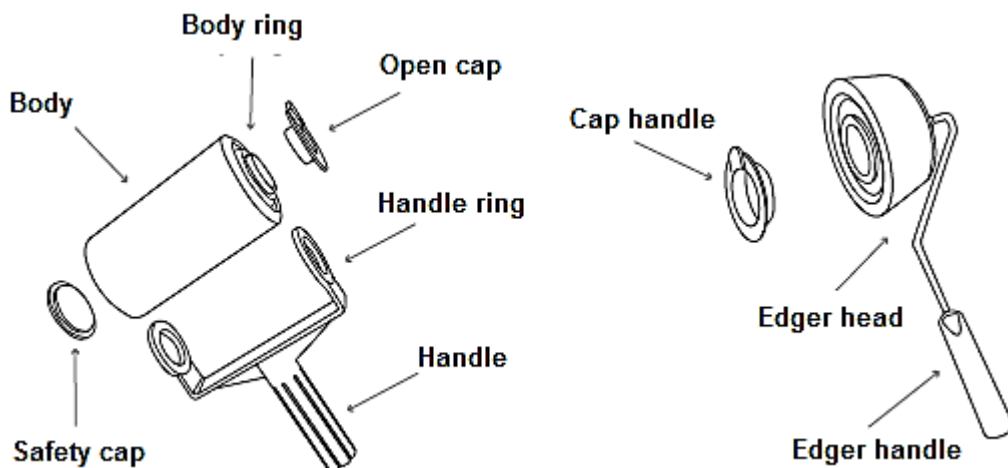

Preparing your Paint Roller for use

1. Before first use rinse the roller under a tap then dry.
2. Remove the open cap from the paint roller.
3. Pour up to 900ml of paint into the paint roller using the easy pour jug (Fig. 1).
4. Replace the open cap and make sure it is thoroughly secure (it should click into place).

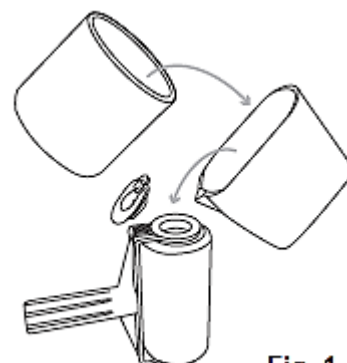
**Fig. 1**

You now need to “charge” the paint roller. Do this by rolling it on an old newspaper or roller base tray for 2-3 minutes, until paint is visible all over the roller (Fig. 2).
YOUR PAINT ROLLER IS NOW READY TO USE.

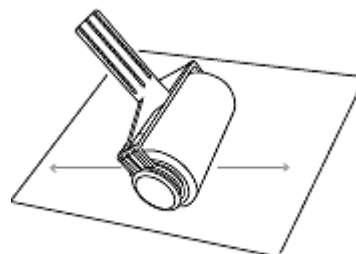
**Fig. 2**

Using the Paint Roller

1. Make sure you are happy with the weight of the paint roller. If not, carefully remove the open cap and pour paint back into the can until you can use the paint roller comfortably.
2. For ceilings and high walls you can extend your reach with a threaded pole or you can use a broom handle if you don't have a threaded pole (not included).
3. When working at height, always ensure you have a firm footing and both hands on the pole.
4. When using the pole, always ensure you are positioned directly under the weight of the roller (Fig. 3)
5. When applying paint do not press too hard. Let the paint roller do the work for you.

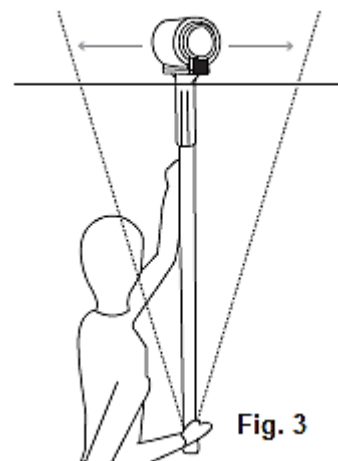
**Fig. 3**

During Intervals

If taking a short break, place the paint roller on the resting tray. If your break is likely to be longer than 2 hours, wrap tightly in plastic wrap and store in a cool, dark place (preferably the refrigerator) on top of a piece of cardboard or old newspaper to prevent drying out.

Washing the Paint Roller & changing the head

Remove the open cap from your paint roller and flush with warm water, until clean. Dry out for immediate use by rolling the paint roller on paper or cloth or air-dry for later use.

To change the head on the paint roller, remove the open cap, then the safety cap and prise the handle apart to release the head. Replace with the new head and then the safety cap and finally the open cap (Fig. 4).

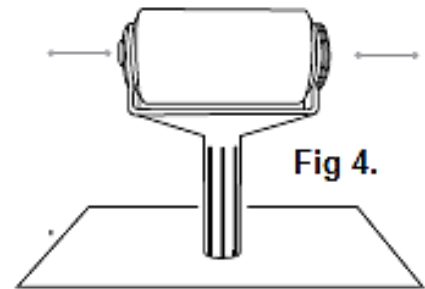

Preparing your Flocked Edger

1. Before first use rinse the roller under a tap then dry.
2. Lift the open cap handle and twist anti-clockwise to open.
3. Pour the paint into the edger head using the easy pour jug (Fig. 5).

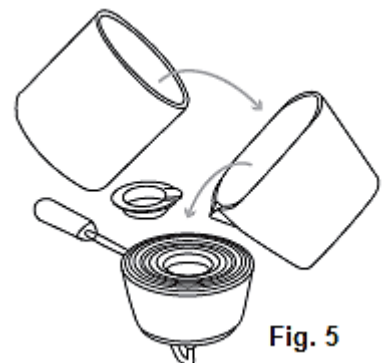

4. Replace the open cap, twist clockwise to lock and put the open cap handle down.
5. Clean the excessive paint on the edger head, if any.
6. Charge the edger head by rolling it on an old newspaper for 2 minutes or until the fully covered with paint (Fig. 6).
7. The edger head is now ready for use.

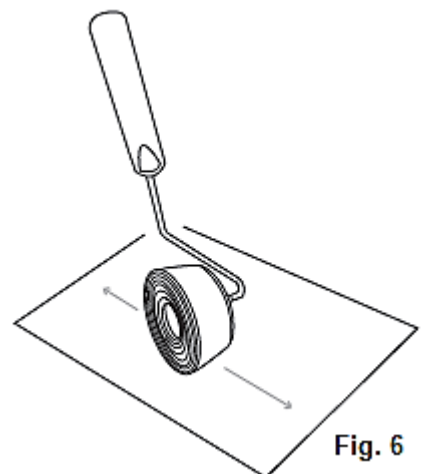

8. When painting, ensure that the edger head is tilted at an angle from the adjacent wall. The sponge portion should be seated fully on the painted wall (Fig. 7).

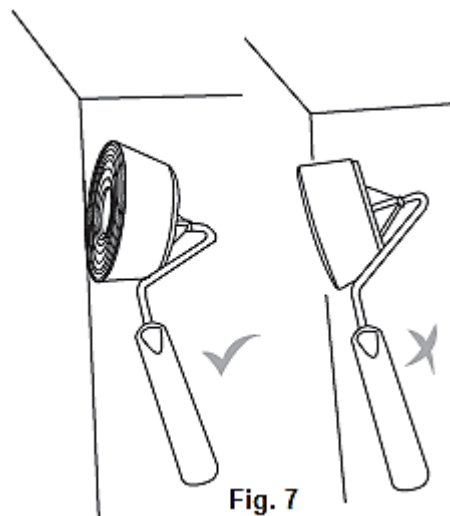

Fig. 7

Cleaning the flocked edger

1. Lift the open cap handle and twist anti-clockwise to open.
2. Dispose of significant amount of paint responsibly.
3. Remove the open cap and cover from your edger head and flush with water, until clean. Dry out for immediate use by rolling the flocked edger on old newspaper or cloth or air-dry for later use.

DISPOSAL

- Dispose of all packaging, paper, cartons, plastic and plastic bags in accordance with your local recycling regulations.
- At the end of the product's lifespan please dispose of it at an authorised household waste recycling centre.