



GH721

Hose Cart with Wheels

Fixing and Maintenance Instructions

IMPORTANT

Installer and users please note:

Please read the entire instruction manual before using the product and then save it for future reference. We reserve the right for any errors in text or images and any necessary changes made to technical data.

BEFORE USE

Inspect the product for any signs of damage. If the product is damaged, DO NOT use it, and contact your supplier immediately.

PRODUCT SAFETY

Prior to the installation of this product, the installation instructions should be read and completely understood. The installation instructions must be read to prevent personal injury and property damage. Keep these installation instructions in an easily accessible location for future reference.

PARTS

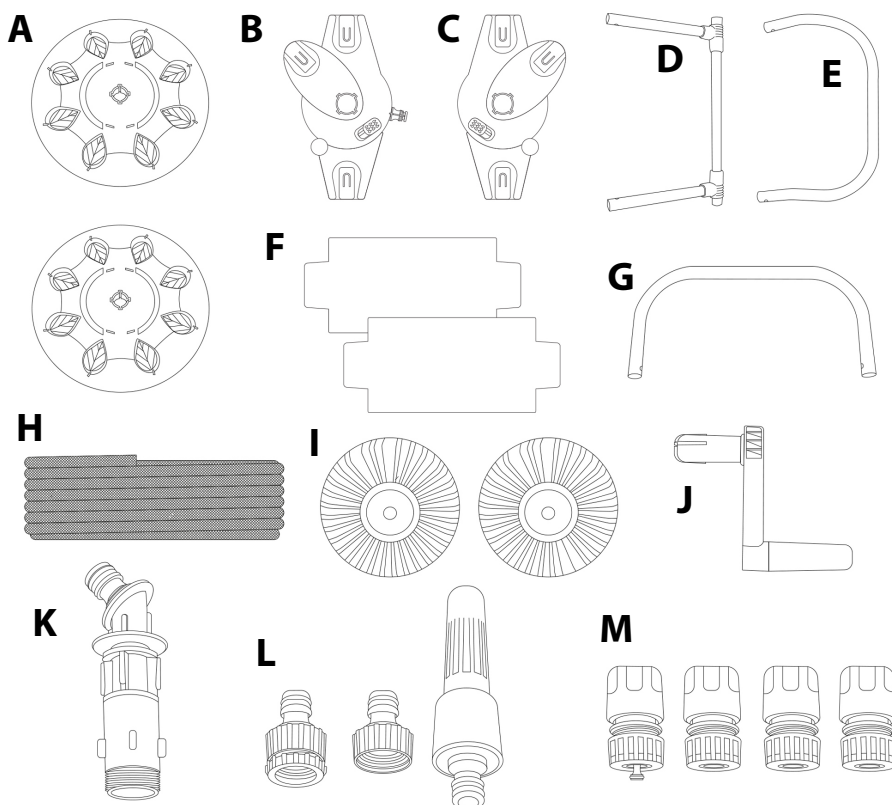

Before assembly or installation make sure that all parts are present. If any parts are missing DO NOT attempt to assemble, contact your dealer.

PARTS LIST

A - Reel
 B - Side Panel
 C - Side Panel
 D - Leg (Wheels)
 E - Leg
 F - Inner Reel
 G - Handle
 H - Hose Pipe
 I - Wheels
 J - Reel Handle
 K - Angled Connector
 L - Hose Attachments
 M - Hose Connectors

STEP 1

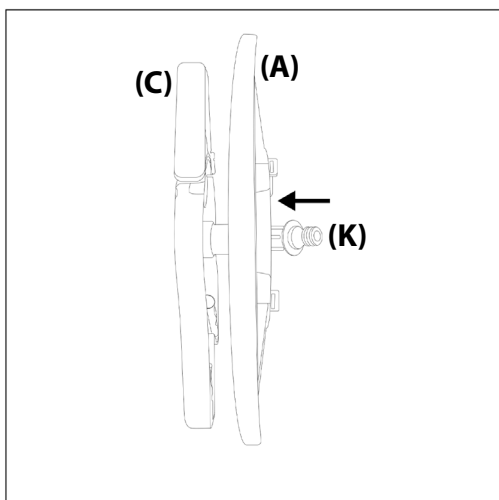

Connect angled connector set (K) through reel (A) & side panel (C)

STEP 2

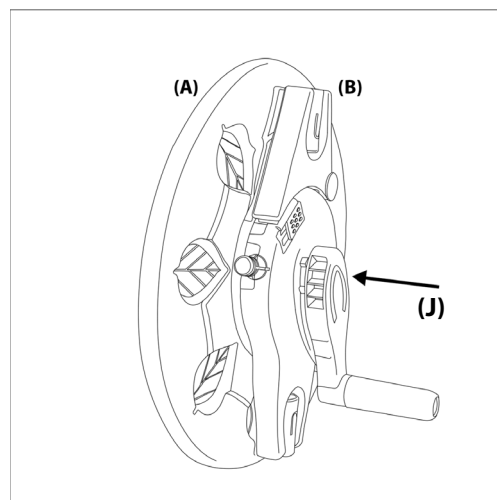

Connect reel handle (J) through side panel (B) and reel (A)

STEP 3

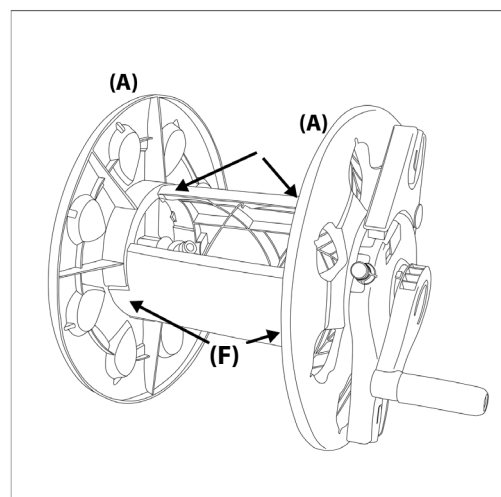

Connect Inner Reel (F) to both sides of the reel (A)

STEP 4

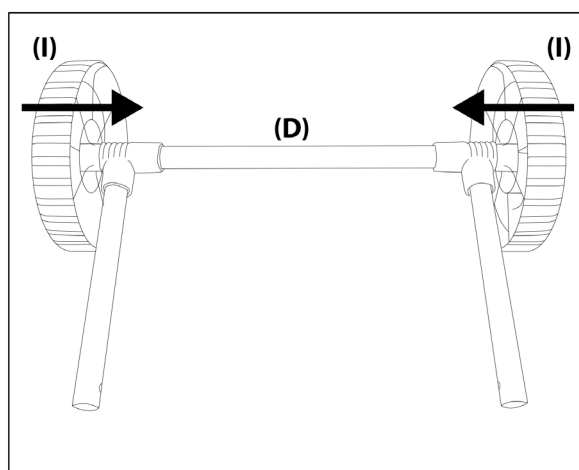

Connect wheels (I) to both sides of leg frame (D)

STEP 5

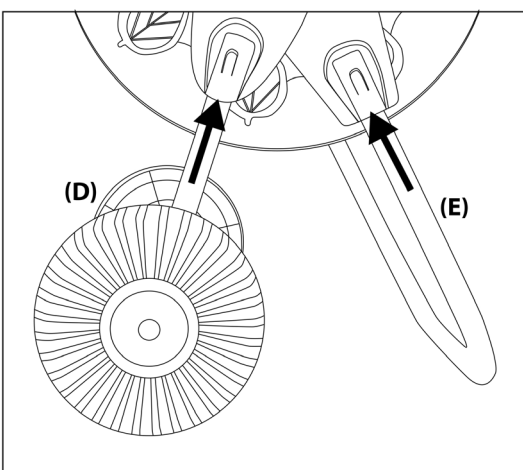

Click Wheels (D) & Leg (E) into inserts on side panels (B) & (C)

STEP 6

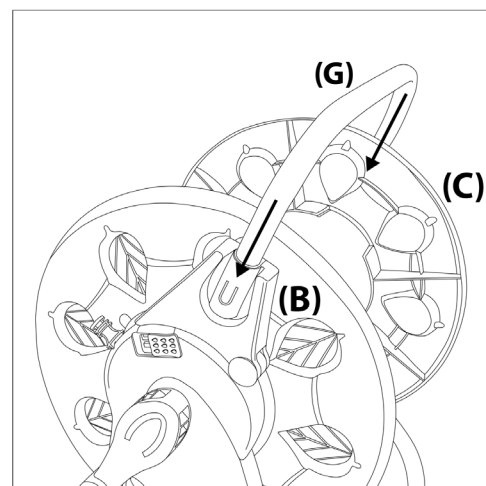

Click Handle (G) into inserts on side panels (B) & (C)

STEP 7

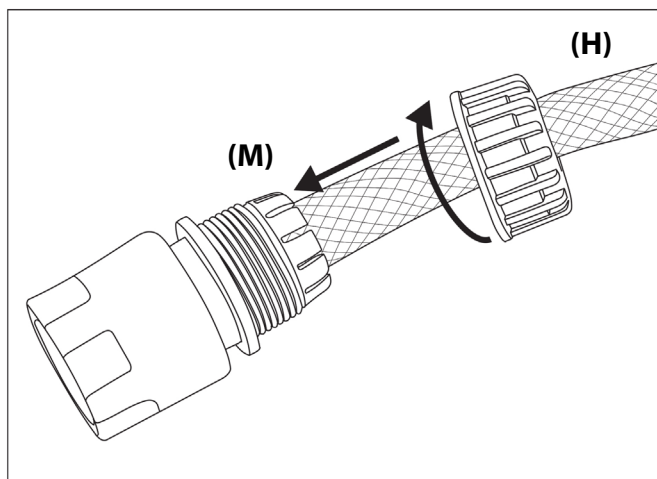

Insert end of Hose pipe (H) into Connector (M) and screw connector to lock hose in place

STEP 8

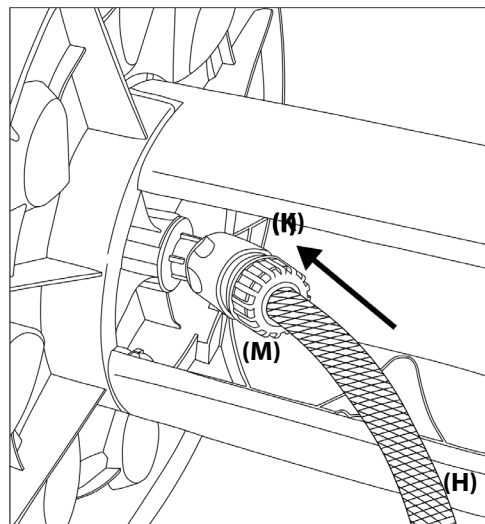

Connect Hose (H) to angled connector (K)

STEP 9

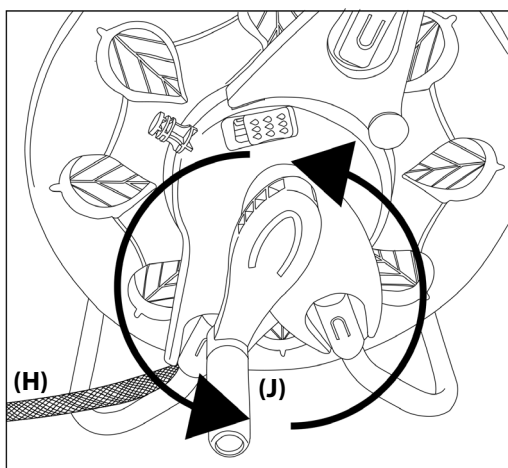

Rotate Reel handle (J) to wind in the hose pipe (H)



SERVICE WARRANTY

Electrovision guarantees the product free from defects in materials and workmanship for a period of one year. Should this unit be operated under conditions other than those recommended, at voltages other than the voltage indicated on the unit, or any attempts made to service or modify the unit, then the warranty will be rendered void. The product you buy may sometimes differ slightly from illustrations. This warranty is in addition to, and does not affect, your statutory rights.

Electrovision Ltd., Lancots Lane, Sutton Oak, St. Helens, Merseyside WA9 3EX
website: www.electrovision.co.uk