

Unscrew the 3 screws, and open the cover to replace batteries.

## Before use:

- Each unit requires **2 x AA 1.2V NI-MH rechargeable batteries** (included ).
- Choose a location with direct sunshine, where the solar panel can receive at least 6 hours of sunshine each day.
- Shady locations will influence the batteries charge and may shorten the working time of the light.
- Weather conditions and season will affect how much the batteries are able to charge during the day.
- The solar light is ideal for the night time illumination of your garden, lawn, patio and walkway.
- The surface of the solar light must be kept clean to maximise the efficiency of the light.

## Instructions for use:

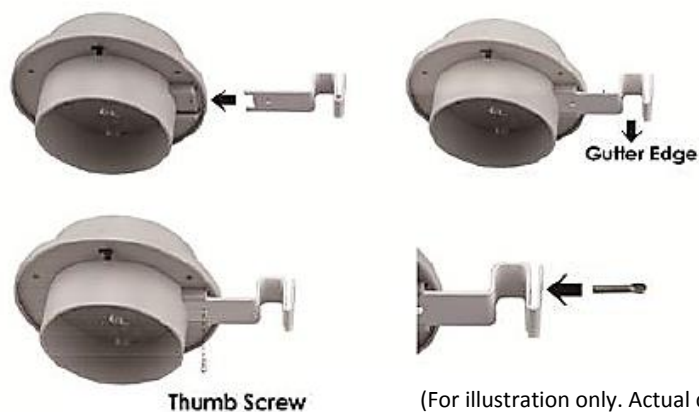

(For illustration only. Actual colour Black)

- To maximise and prolong the batteries life, please ensure the switches are on and allow the solar panel to charge in full sunlight for 1 full day before first use. The light is then ready for use.
- To affix to your gutter, unscrew the small thumb screw.
- Insert the long arm into the recess and screw the small thumb screw back into place. Position the light over the gutter and secure by tightening the long screw (twist clockwise).
- Remember to peel the protective film from the solar panel and have set the switch to ON position to activate the light.

**CARE AND CLEANING INSTRUCTIONS:**

- Always switch off and remove batteries when not in use.
- Do not shine light directly towards eyes.
- Do NOT immerse in water.
- Do NOT use abrasive cleaners or sharp utensils to clean this appliance.
- Store the item in a cool, dry place.
- Wipe with a clean dry cloth.

**BATTERIES:**

- Each light **requires 2 x AA 1.2V NI-MH rechargeable batteries (included)**
- Only use rechargeable batteries for this product.
- If the light stops working after it has been used for a long time (approx 12 months), you may need to replace the units batteries.
- Insertion, removal and disposal of batteries should be done by an adult.
- Ensure the correct polarity is observed when replacing the batteries.
- Remove batteries from product if not using for a long time.
- Store batteries in a dry place at room temperature.
- Keep batteries away from children and pets.
- Do not mix used and new batteries.
- Never dispose of batteries in a fire.
- Battery disposal, spent or expired batteries must be properly disposed of and recycled in compliance with local regulations. For detailed information, contact your local authority.
- Follow the battery manufacturer's safety, usage, and disposal instructions.

**DISPOSAL**

- Dispose of all packaging, paper, cartons and plastic, plastic bags in accordance with your local recycling regulations.
- At the end of the product's lifespan please dispose of it at an authorised household WEEE waste recycling centre.

