



Power Details: 220-240Va.c.
50Hz-60Hz
2200-2600W

Capacity: 4.0L

Accessories: 2 Water aid trays, reset key (included in the bag with this manual)

Water Filters are not included and can be purchased separately – Item Code 10747

IMPORTANT NOTES FOR YOUR INSTANT WATER BOILER.

Please read this instruction manual thoroughly before starting and ensure you are familiar with the operation of your new Instant Water Boiler.

i	<p>IMPORTANT</p> <p>Descaling:</p> <p>The Instant Water Boiler is fitted with elements that must be descaled on a regular basis (between 2 to 4 weeks). If used every day we recommend the product is descaled every 2 weeks. Scale built-up can cause the product to malfunction and may damage the Instant Water Boiler invalidating the warranty.</p>
----------	---

CONTENTS LIST:

- 1. PART DESCRIPTION 2
- 2. HOW TO USE..... 3
 - First use: 3
 - Fill with water..... 3
 - Obtain desired water 3
 - Water disposal from the water tray..... 5
 - Insert/Replace the filter 5
- 3. Cleaning and Maintenance..... 6
 - Storage 6
- WARNING 7
- TROUBLESHOOTING 7
- PLUG WIRING (UK & IRELAND)..... 8
- DISPOSAL..... 8

1. PART DESCRIPTION

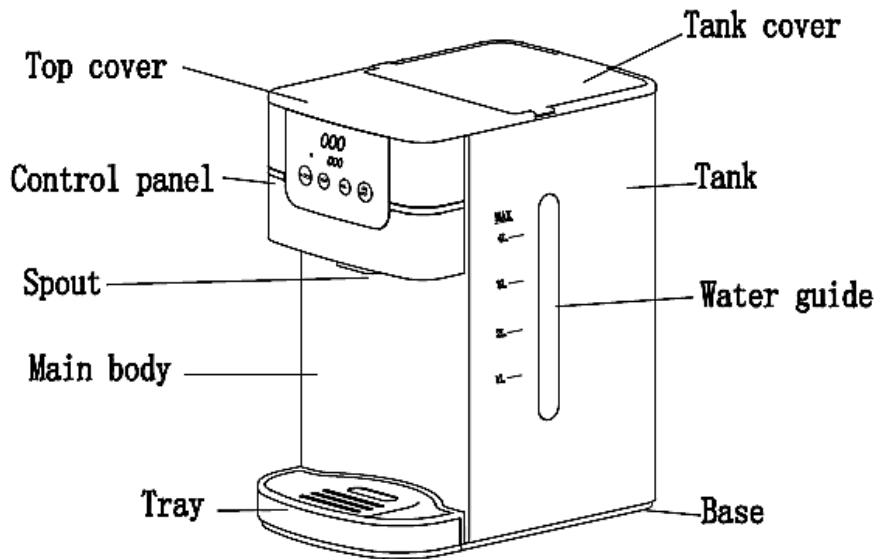

CONTROL BUTTON DETAILS

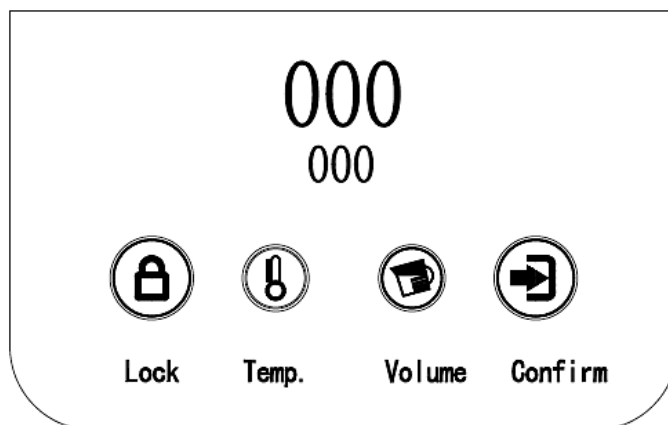

- Lock button:** Press and hold down the **Lock** button for about 3-5 seconds to unlock. This will lock if there is no activity within 10 seconds. You can unlock the screen by pressing the **Confirm** button.
- Temp. button:** Set the desired temperature to 55°C, 65°C, 75°C, 85°C, 100°C, or 000 (normal temperature water). Select 100°C for boiling water.
- Volume button:** Set the water volume to 100ml, 200ml, 300ml or 000 (continuously water flow). Select 100ml for a cup, 200ml for a mug or 300ml for a large mug.
- Confirm button:** Start and stop function setting.

2. HOW TO USE

If using the appliance for first time, please clean and rinse the water tank before use.

Setup:

- Place a receptacle onto the tray.
- Press the **Lock** button for approximately 3 to 5 second to open.
- Press the **Temp** button and select 000 degree setting
- Press the **Volume** button and select 000 volume setting
- After dispensing a quantity of normal temperature water, please press **Temp** button to 100 degree setting and **Volume** to 000 volume setting to operate the appliance for 1 minute until the detection of boiling point is finished and the unit functions.

Note: This procedure will need to be repeated after the appliance has been unplugged.

Fill with water

Open the lid, fill the water tank with the desired amount of water, and then close the lid.

Note: the water level must be below the Max level.

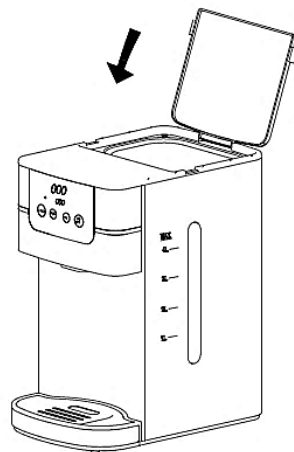

Tips: Use filtered water in the appliance.

Obtain desired water

- Make sure the plug is connected to the mains wall outlet, and the water tank is filled with the desired amount of water.
- Place your cup on the removable water tray, make sure it aligns with the spout.
- First press the **Lock** button about 3-5 seconds to open. **Temp.** and **Volume** setting indicator light up. Press the **Temp.** button to choose your desired temperature and press the **Volume** button to set right water volume. Press the **Confirm** button to operate the appliance. Water will flow out continuously from water spout after 5-10s.
- When you have obtained the desired amount of water, press the **Confirm** button to stop the appliance. Please note that this may take a few seconds so please take care not to overfill.
- As ambient temperature can change every day, the water volume dispensed can fluctuate within -15% to +15%.
- **CAUTION! Always watch the filling of your cup or mug and press the confirm button to stop the water dispensing before it reaches the rim to avoid overfilling and spillage of hot water.**

Please read and retain these instructions for future reference

v008:02/01/19

- **DO NOT leave the water boiler unattended to avoid risk of overflowing and spillage.**
- If you want to obtain water again, repeat the above procedure.

Remarks

- Do not touch the boiled water and steam in order to protect against scalding by boiled water and hot steam.
- Safety cut-out: If the appliance stops operating with beep sound and the PCB panel show E7 symbols then, there is insufficient water. Please fill the water tank below max level.
- The appliance can memorize the last operation method until the plug is disconnected.
- As the appliance has memory function when powered on please use about 60 seconds first in order to obtain desired temperature water. When switched off the memory will reset.
- As ambient temperature can change every day, the water volume dispensed can fluctuate within -15% to +15%, please take care and press the Confirm button to stop the appliance to avoid overflowing.
- This appliance has manual thermostat to recover the heating function should the appliance stop functioning, you can reset the thermostat by a **reset key**.

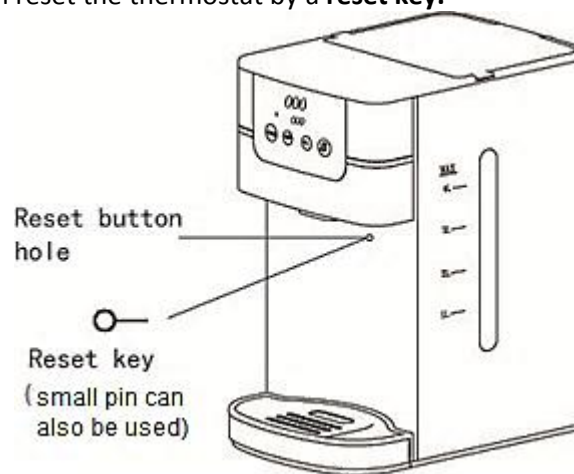

After cleaning the appliance, please open the drainage stopper in order to clean away the wastewater.
Note: Tighten the drainage stopper once water has drained and before reuse.

Drainage stopper

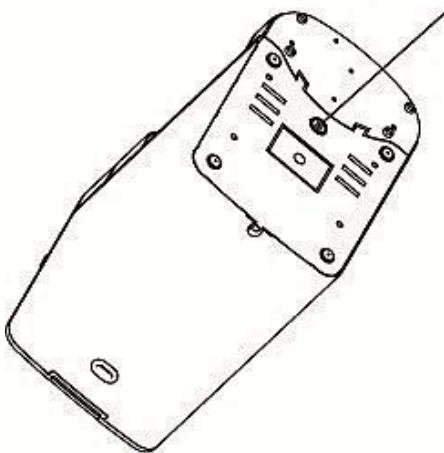

You can select the aid water tray for various size cup / mug.

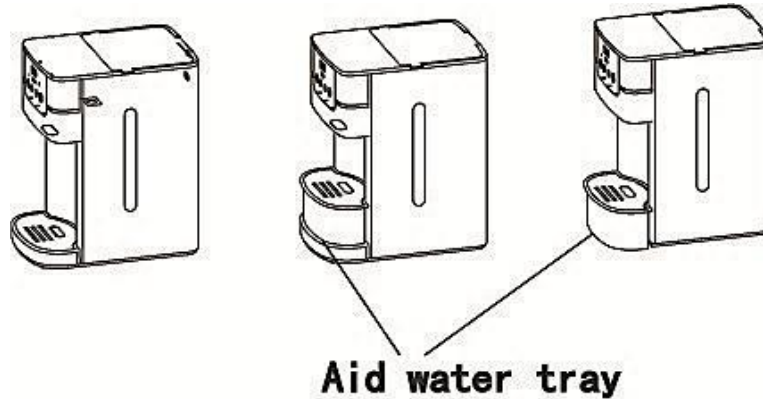

Water disposal from the water tray

When the water tray is full, grasp and stabilize the appliance by one hand, use the other hand to lift up the water tray slightly to remove it. Empty the water tray and re-insert it onto the water boiler.

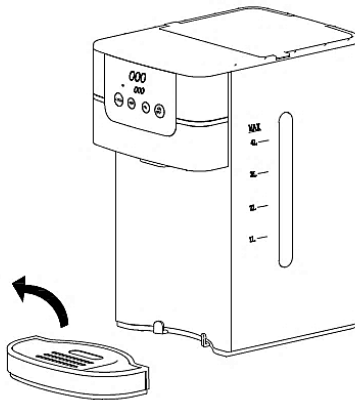

Insert/Replace the filter

Water Filters are not included and can be purchased separately – Item Code 10747

Remove and replace the filter if this becomes blocked. The filter lifetime is around 150 litres of filtered water depending on hardness of water. Open the tank cover, and take out the filter box with filter. Dispose the old filter and use the new filter instead.

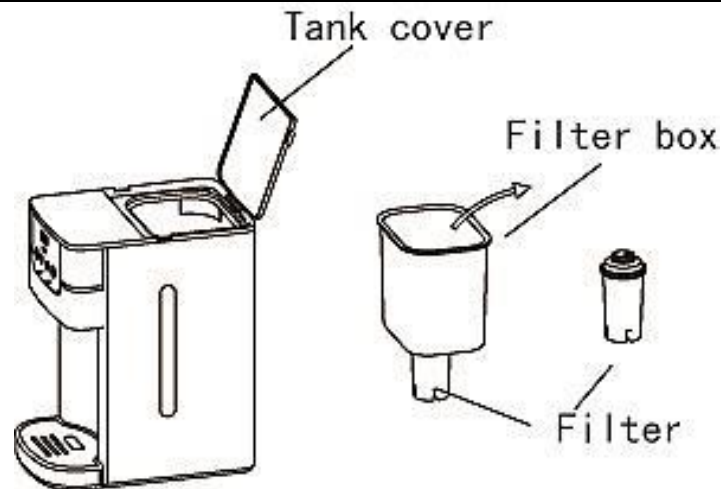

3. Cleaning and Maintenance

- Always switch off and unplug your water dispenser and allow it to cool completely before cleaning.
- Do NOT immerse in water. Risk of electric shock.
- Fill with clean water to clean, repeat the same steps for 2-3 times until water is clear, then refill with clean water to be ready for operation.
- **To maintain its performance, descale the appliance between 2 to 4 weeks. If used regularly every day it is recommended to descale the appliance every 2 weeks.**
- **Please use a toxic free descaler or detergent such as citric acid. Add some citric acid into water and always operate the appliance about three times to remove any scaling, or repeat until water flow is steady.**
- **Alternatively you can use a descaling fluid such as Mrs Cooper's Best Appliance Descaler (Item code 9958). Follow instructions on the bottle for water boilers, mix 1 part descaling liquid to 5 parts water and pour the descaling liquid into the water tank. Operate the appliance until the descaling liquid flows out of the spout (catch the liquid in a container) and repeat at least 3 times to remove the scale or repeat until the water flow is steady.**
- **After descaling, please pour out all the boiled water in the water tank and add clean water to operate the appliance twice before use.**
- Wipe the surface of the water tank with a damp cloth and polish with a soft dry cloth.
- Do not use any chemical, metal, wood or abrasive detergent to clean the appliance housing, always use a damp cloth.
- Always handle the appliance gently, do not place it near the edge of the table, worktop or counter, to prevent toppling that could result in damage.
- Do NOT use abrasive cleaners or sharp utensils to clean this appliance.
- Allow to dry thoroughly before further use.
- Store the unit in a cool, dry place.

STORAGE:

If the appliance is not used for longer periods, unplug and clean it, then put back into the original packing box to avoid the electrical components getting damp or damaged.

WARNING:

WHEN USING ELECTRICAL APPLIANCES, BASIC SAFETY PRECAUTIONS SHOULD ALWAYS BE FOLLOWED:

- READ ALL INSTRUCTIONS BEFORE USE.
- CHECK THE APPLIANCE AND POWER CABLE CAREFULLY FOR DAMAGE BEFORE EACH USE.
- BEFORE CONNECTING THE APPLIANCE, CHECK IF THE VOLTAGE INDICATED ON THE BOTTOM OF THE APPLIANCE IS IN ACCORDANCE WITH THE MAIN VOLTAGE IN YOUR HOME.
- TO PROTECT AGAINST ELECTRIC SHOCK, DO NOT IMMERSE CORD, PLUG OR APPLIANCE IN WATER OR ANY OTHER LIQUID.
- UNPLUG FROM OUTLET WHEN NOT IN USE AND BEFORE CLEANING. ALLOW THE ITEM TO COOL THOROUGHLY BEFORE PUTTING ON OR TAKING OFF PARTS.
- DO NOT OPERATE AND APPLIANCE WITH A DAMAGED CORD OR PLUG OR AFTER THE APPLIANCE MALFUNCTIONS, OR HAS BEEN DAMAGED IN ANY MANNER. WE RECOMMEND THAT THE POWER CORD IN NOT KINKED OR STORED IN A TWISTED MANNER, AND THAT YOU REGULARLY CHECK ITS CONDITION.
- THE USE OF ACCESSORY ATTACHMENTS NOT RECOMMENDED BY COOPERS OF STORTFORD MAY CAUSE INJURIES AND INVALIDATE ANY WARRANTY YOU MAY HAVE.
- DO NOT USE OUTDOORS.
- DO NOT LET CORD HANG OVER THE EDGE OF A TABLE OR COUNTER, OR TOUCH HOT SURFACES.
- DO NOT PLACE ON OR NEAR HEAT SOURCES, AND USE THE **INSTANT WATER BOILER** ON A LEVEL, STABLE SURFACE.
- NEVER COVER THE ITEM IN ANY WAY WHEN IN USE.
- DO NOT USE THIS APPLIANCE FOR ANY OTHER USE THAN THE INTENDED USE IT IS DESIGNED FOR.
- ENSURE THERE IS SUFFICIENT DISTANCE BETWEEN THE **INSTANT WATER BOILER** AND OTHER ITEMS ON THE WORK SURFACE OR WORK STATION, OR SUFFICIENT DISTANCE BETWEEN THE **INSTANT WATER BOILER** AND THE CONFINES OF THE AREA IN WHICH IT IS SITUATED. WE RECOMMEND A MINIMUM CLEARANCE AROUND ALL FACES OF AT LEAST 10CM.
- BEFORE USE, CHECK THOROUGHLY FOR ANY DEFECTS AND DO NOT USE IF DEFECTS ARE FOUND. TAKE CARE NOT TO DROP THE APPLIANCE AS HEAVY IMPACTS MAY CAUSE INTERNAL DAMAGE.
- THIS APPLIANCE CAN BE USED BY CHILDREN AGED FROM 8 YEARS AND ABOVE AND PERSONS WITH REDUCED PHYSICAL, SENSORY OR MENTAL CAPABILITIES OR LACK OF EXPERIENCE AND KNOWLEDGE IF THEY HAVE BEEN GIVEN SUPERVISION OR INSTRUCTION CONCERNING USE OF THE APPLIANCE IN A SAFE WAY AND UNDERSTAND THE HAZARDS INVOLVED.
- CHILDREN OF LESS THAN 3 YEARS SHOULD BE KEPT AWAY UNLESS CONTINUOUSLY SUPERVISED.
- CHILDREN SHALL NOT PLAY WITH THE APPLIANCE. CLEANING AND USER MAINTENANCE SHALL NOT BE MADE BY CHILDREN WITHOUT SUPERVISION.
- **SOME PARTS OF THIS PRODUCT CAN BECOME VERY HOT AND CAUSE BURNS. PARTICULAR ATTENTION HAS TO BE GIVEN WHERE CHILDREN AND VULNERABLE PEOPLE ARE PRESENT.**
- DO NOT PLACE THIS ITEM IMMEDIATELY BELOW A SOCKET-OUTLET.
- DO NOT USE IF THE POWER CORD OR PLUG IS DAMAGED. TO BE REPAIRED BY A QUALIFIED ELECTRICIAN OR TO BE REPLACED BY THE MANUFACTURER, SERVICE AGENT OR SIMILARLY QUALIFIED PERSON, IN ORDER TO AVOID A HAZARD.

TROUBLESHOOTING

Problem	Solution
Appliance stops working.	The appliance has a safety cut-out and stops operating when there is insufficient water in the tank. The Control Panel will show E7 error

	code. Fill the water tank below the max. level.
Wrong amount of water dispensed.	Select Volume 100ml for a cup 200ml for a mug 300ml for a large mug 000 for continuous flow
Water flows slowly.	The flow speed for dispensing depends on the temperature selected. Typically in one minute at room temperature 22 °C this is: 55°C – 950ml per minute 65°C - 750ml per minute 75°C - 620ml per minute 85°C - 520ml per minute 100°C - 400ml per minute
Water is splashing.	Water splashing can occur during boiling point detection. Water flow should stabilise after 1min.
Water not hot enough.	After appliance has been unplugged the boiling point detection described under Setup (page 3) needs to be repeated.

PLUG WIRING (UK & IRELAND)

This appliance is fitted with a BS 1363 **13-amp plug**. If you have to replace the fuse, only those that are ASTA or BSI approved to BS1362 and with a rated current of **13-amps** should be used.

If there is a fuse cover fitted, this cover must be re-fitted after changing the fuse. If the fuse cover is lost or damaged the plug must not be used. Spare fuse holders and fuses are available from electrical outlets. If the socket outlets in your home or office are not suitable for the plug of this product, the plug must be removed and disposed of safely as insertion of the plug into a socket is likely to cause electric hazard. A replacement plug should be wired according to the following instructions:

The cable

A mains electricity cable contains two or three inner wires. Each has a core of copper and an outer layer of flexible plastic. **This product is earthed**; the wires in the cord set are colour coded in the following way:

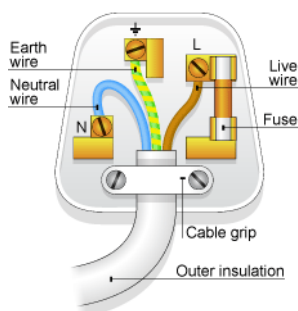

The diagram shows the key features of a correctly wired three-pin mains plug.

BLUE	NEUTRAL
BROWN	LIVE
GREEN & YELLOW	EARTH

DISPOSAL

- Dispose of all packaging, paper, cartons and plastic, plastic bags in accordance with your local recycling regulations.
- At the end of the product's lifespan please dispose of it at an authorised household WEEE waste recycling centre.

