



**Power Details:** Rated voltage (adaptor) 100 – 240v; 50/60hz, 0.65A  
Adaptor output: DC 12V 1A  
Power consumption 10W  
Audio output: 2Wx2  
Frequency details: AM: 540 - 1620KHz  
FM: 88 - 108MHz

**Accessories: AC Adaptor; 45RPM Adaptor**

**Please read this instruction manual thoroughly before starting and ensure you are familiar with the operation of your new record player & radio.**

## PRODUCT FEATURES

- 33/45/78 RPM SELECTABLE TURNTABLE
- AUTOMATIC / MANUAL STOP TURNTABLE
- BELT DRIVEN SYSTEM
- DIRECT USB/SD ENCODING FOR TURNTABLE, FM RADIO & AUX IN
- AUX IN FOR CONNECTION OF OTHER DEVICE (EG. CD & MP3 PLAYER)
- USB/SD SLOT FOR MP3 PLAYBACK
- ANALOGUE AM/FM RADIO
- RCA LINE-OUT
- STEREO BUILT-IN SPEAKER
- 45RPM ADAPTOR & EXTERNAL POWER ADAPTOR INCLUDED

## LOCATION OF CONTROL

- 1) MODE
- 2) FUNCTION KNOB
- 3) EARPHONE JACK
- 4) PLAY/PAUSE ►►
- 5) USB SLOT
- 6) STOP ■
- 7) SD/USB INDICATOR
- 8) RECORD INDICATOR
- 9) SKIP DOWN ◀◀
- 10) SD/MMC CARD SLOT
- 11) SKIP UP ►►
- 12) AUX IN
- 13) POWER / VOLUME KNOB
- 14) REC BUTTON (RECORD / DELETE FUNCTION)
- 15) SPEAKER
- 16) POWER INDICATOR
- 17) RADIO FREQUENCY DIAL SCALE
- 18) RADIO TUNING KNOB
- 19) FM STEREO INDICATOR
- 20) SPEAKER
- 21) DUST COVER

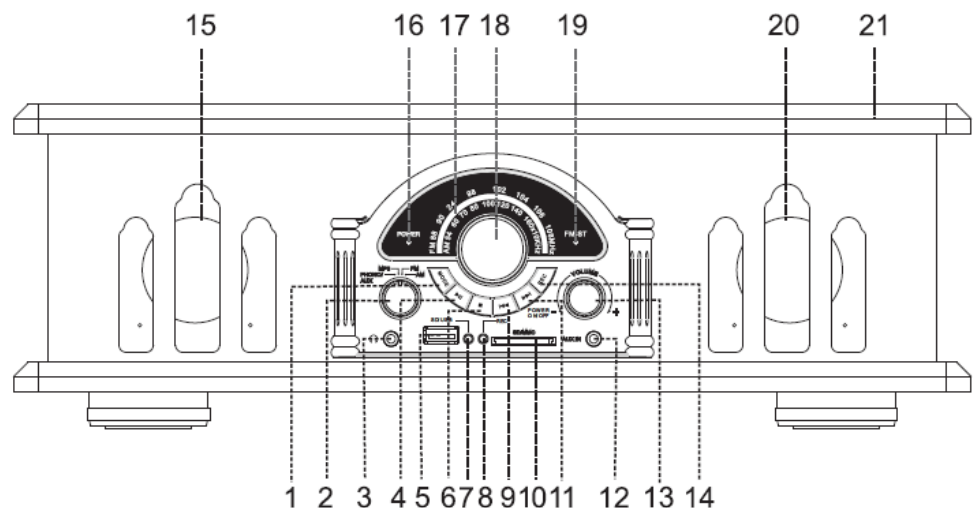

- 22) FM WIRE ANTENNA
- 23) EXTERNAL POWER ADAPTOR JACK
- 24) LINE-OUT JACK
- 25) LINE-OUT JACK

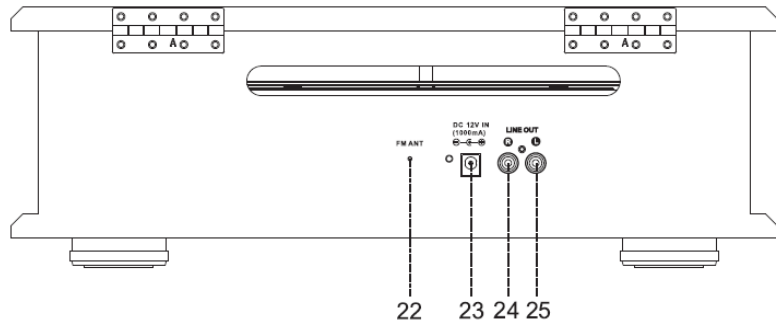

- 26) 45RPM ADAPTOR
- 27) LIFT LEVER
- 28) AUTO STOP ON/OFF BUTTON
- 29) 33/45/78 RPM SPEED SELECTOR
- 30) TONE ARM

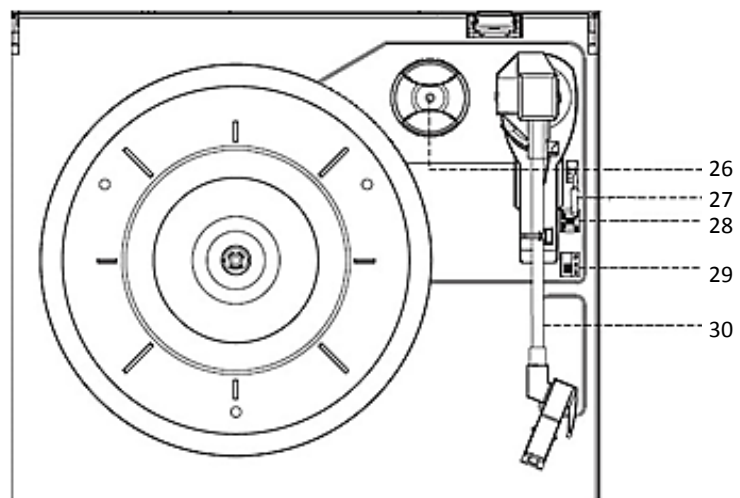

## CAUTION:

THIS UNIT SHOULD ONLY BE ADJUSTED OR REPAIRED BY A QUALIFIED SERVICE ENGINEER.

## PRECAUTIONS FOR USE

### INSTALLATION

- Unpack all parts and remove protective material.
- Do not connect the unit to the mains before checking the mains voltage and before all other connections have been made.
- Do not cover any vents and make sure that there is a space of several centimetres around the unit for ventilation.

## CONNECTION

1. Connect **external power adaptor** to **external power adaptor jack**.
2. Turn the **power knob** clockwise switch on the unit, **power indicator** will be on.

## LISTENING TO AM/FM RADIO

### AM/FM RADIO TUNING

1. Turn **function knob** to select AM or FM radio mode.
2. Select the desired band by turning **radio tuning knob**.

## FM & FM-STEREO RECEPTION

1. FM stereo indicator will light up if FM stereo mode is receiving.

## HINTS FOR BETTER RECEPTION

1. AM: there is a built-in AM bar antenna. If AM reception is weak, slightly rotating or re-positioning the unit will usually improve the AM reception.
2. FM: the receiver has a built-in FM wire antenna hanging at the rear cabinet. This wire should be completely unravelled and extended for best reception.

## FM & FM-STEREO RADIO RECORDING

1. Select FM radio mode, insert memory device (USB drive, SD or MMC card only)
2. Press the **REC button**, **record indicator** will be flashing red.
3. To finish recording, press **STOP ■ button**, **record indicator** will stop flashing.
4. To hear newly encoded track:
  - Select "MP3" by turning **FUNCTION knob**.
  - The newly recorded track is always stored as the last track in USB/SD.
  - During playback from USB or SD, press and hold **PLAY/PAUSE ►|| button** to switch between tracks recorded by this unit or other tracks stored in the USB (or SD) originally.

## REMARK:-

- The recording speed is 1:1 and according to the actual playing time of FM radio

- The recording format is pre-set at – MP3 bit rate : 128 kbps
- During FM & FM-stereo radio recording the radio frequency is fixed and cannot be tuned.

## PHONO & ENCODING

### NOTED:

- Remove the stylus protector.
- Be sure that the tone arm is lifted from the tone arm rest before operating and set back onto the tone arm rest afterwards.

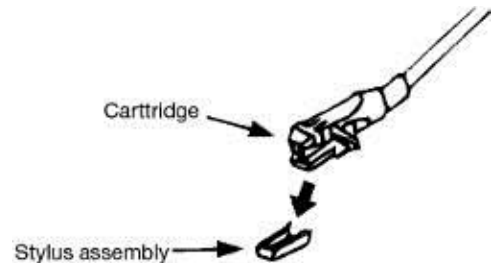

1. Turn **function knob** to select “PHONO” mode.
2. Set the **speed selector** to the correct position, depending on the record to be played.
3. Place the record on the turntable, use the 45 rpm adaptor if required.
4. Push the **lift lever** up to raise the tone arm from the arm rest, and then slowly move it to the record side. The turntable will start to rotate.
5. Put down the **lift lever** to drop the tone arm and touch the record gently. Phono playing starts now.
6. Push the **lift lever** upward to raise the tone arm from the arm rest, the turntable will still be rotating but phono playing will stop. To continue the playing, the **lift lever** needs to be put down.
7. Adjust the volume to the desired level.
8. At the end of a record, the turntable will automatically stop rotating. Push the **lift lever** upward to raise the tone arm and move it to the arm rest, and then put down the **lift lever**.
9. To stop manually, lift the tone arm from the record and return it to the arm rest.

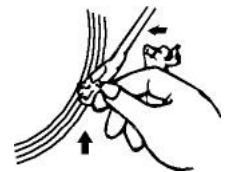

**NOTE:** On some types of records the auto-stop area is out of the unit setting, so the record will stop playing before the last track finishes. In this case, set the **AUTO-STOP switch** to “ OFF “ position for the record to run to the end but not stopping automatically (turn off the unit by **power button** or switch back the **AUTO-STOP switch** to “ ON “ position to stop the turntable rotate). Then put the tone arm back onto the arm rest.

## PHONO RECORDING

1. Select PHONO mode, insert memory device (USB drive, SD or MMC card only)
2. Press the **REC button**, **record indicator** will be flashing red.
3. To finish recording, press **STOP ■ button**, **record indicator** will stop flashing.
4. To hear newly recorded track:
  - Select "MP3" by turning **FUNCTION knob**.
  - The newly recorded track is always stored as the last track in USB/SD.
  - During playback from USB or SD, press and hold **PLAY/PAUSE▶|| button** to switch between tracks recorded by this unit or other tracks stored in the USB (or SD) originally.

## REMARK:-

- The recording speed is 1:1 and according to the actual playing time of the record
- The recording format is pre-set at – MP3 bit rate : 128 kbps

## AUX IN JACK & ENCODING

Turn **function knob** to select "aux" mode, put the **tone arm** back to arm rest, then connect the external audio device (such as CD player) through the **AUX IN jack**. Audio signal from the external audio device can be played through the system.

## AUX IN RECORDING

1. Select AUX mode, insert memory device (USB drive, SD or MMC card only)
2. Press the **REC button**, **record indicator** will be flashing red.
3. To finish recording, press **STOP ■ BUTTON**, **record indicator** will stop flashing.
4. To hear newly recorded track:
  - Select "MP3" by turning **function knob**.
  - The newly encoded track is always stored as the last track in USB/SD.
  - During playback from USB or SD, press and hold **PLAY/PAUSE▶|| BUTTON** to switch between tracks recorded by this unit or other tracks stored in the USB (or SD) originally.

## REMARK:-

- The recording speed is 1:1 and according to the actual playing time of the external audio device.
- The recording format is pre-set at – MP3 bit rate : 128 kbps

## PLAYBACK OF MP3/WMA SONG VIA USB STORAGE MEDIA OR MEMORY CARD

### CONNECTING

The system is able to record and playback all MP3 / WMA files stored in the memory media with USB connecting port or SD/MMC memory card.

1. Plug-in the USB, SD or MMC device into USB or SD/MMC slot, check to be sure the direction is correct before connection.
2. Turn **function knob** to select MP3 mode, the system will start reading the storage media automatically after function selection.
3. Then the system will start audio playback from desired device (USB or SD/MMC) automatically.
4. During playback from USB or SD, press and hold **PLAY/PAUSE" ►|| button** to switch between tracks recorded by this unit or other tracks stored in the USB (or SD) originally.
5. During playback from USB, if only USB device is inserted, then insert SD or MMC card to SD slot, playback will be switched to SD slot, and vice versa.
6. If both of the USB and SD slot are inserted, press and hold **STOP ■ button** to select playback between USB and SD slot.
7. During USB playback, SD/USB indicator will light up blue.
8. During SD playback, SD/USB indicator will light up green.

### ● **PLAY / PAUSE BUTTON ►||**

- Press the **PLAY/PAUSE" ►|| BUTTON** once to halt playing, press it again to continue.

### ● **STOP BUTTON ■**

- Press **STOP ■ BUTTON** to end up audio playback.

### ● **SKIP UP ►► / SKIP DOWN ◀◀ BUTTON**

- During MP3/WMA playback, press **SKIP UP ►► button** once to play the next file. Press and hold **SKIP UP ►► button** continuously to speed up forward selection.
- During MP3/WMA playback, press **SKIP DOWN ◀◀ button** once to play the previous file. Press and hold **SKIP DOWN ◀◀ button** continuously to speed up backward selection.

## ● REPEAT FUNCTION

During audio playback, press **MODE button** once, **SD/USB indicator** will be flashing rapidly, it will repeatedly play a single track. Press **MODE button** again, **SD/USB indicator** will be flashing normally, repeat playback is cancelled.

## REMARK

- If the system is connected to an MP3 player via the USB socket, due to variances in MP3 encoding format, some MP3 players may not be able to play via the USB socket. This is not a malfunction of the system.
- There are numerous USB and SD device producers with various solutions and formats. Therefore, we do not guarantee this unit can support all USB and SD devices from every brand.
- SD card can be supported up to 8GB.

## REMOVAL OF USB / MEMORY CARD

To remove the USB / memory card, turn off the power or turn **function knob** to other mode (turntable, AUX or radio) first, then un-plug the USB/SD device by pulling out the socket directly.

## FILE DELETE FROM USB / SD CARD

The system is able to erase files stored on the USB drive or SD card. Press and hold **REC** button for 2-3 seconds during the playback of the desired track. Then the track will stop playing and be deleted.

## EARPHONE JACK & LINE OUT SOCKET

- This system can be connected with headphone or external amplifier/speaker by 3.5mm **earphone jack**.
- This system can be connected with external device (e.g. amplifier and speaker) by **line-out socket** at rear cabinet.

## POWER SAVING FEATURE:

To save energy, if there is no audio signal from turntable / AUX IN / USB / SD for a period of over 10 minutes, then the unit will automatically switch to standby mode, and the **power indicator** will be



off. Press or turn whatever button or knob again, the unit will be back to normal operation and **power indicator** will light up.

## **SAFETY INSTRUCTIONS:**

WHEN USING ELECTRICAL APPLIANCES, BASIC SAFETY PRECAUTIONS SHOULD ALWAYS BE FOLLOWED:

- READ ALL INSTRUCTIONS BEFORE USE.
- TO PROTECT AGAINST ELECTRIC SHOCK, DO NOT IMMERSE CORD, PLUG OR APPLIANCE, IN WATER OR ANY OTHER LIQUID.
- UNPLUG FROM OUTLET WHEN NOT IN USE AND BEFORE CLEANING.
- DO NOT OPERATE ANY APPLIANCE WITH A DAMAGED CORD OR PLUG OR AFTER THE APPLIANCE MALFUNCTIONS, OR HAS BEEN DAMAGED IN ANY MANNER. WE RECOMMEND THAT THE POWER CORD IS NOT KINKED OR STORED IN A TWISTED MANNER, AND THAT YOU REGULARLY CHECK ITS CONDITION.
- THE USE OF ANY ACCESSORY ATTACHMENTS NOT RECOMMENDED BY COOPERS OF STORTFORD MAY CAUSE INJURIES AND INVALIDATE ANY WARRANTY YOU MAY HAVE.
- DO NOT USE OUTDOORS.
- DO NOT LET CORD HANG OVER THE EDGE OF A TABLE OR COUNTER, OR TOUCH HOT SURFACES.
- DO NOT PLACE ON OR NEAR HEAT SOURCES.
- USE ON A LEVEL, STABLE SURFACE.
- **DO NOT** COVER THE ITEM IN ANY WAY WHEN IN USE AS THIS MAY CAUSE OVERHEATING.
- DO NOT USE THIS APPLIANCE FOR ANY OTHER USE THAN THE INTENDED USE IT IS DESIGNED FOR.
- BEFORE USE, CHECK THOROUGHLY FOR ANY DEFECTS AND DO NOT USE IF DEFECTS ARE FOUND. TAKE CARE NOT TO DROP THE APPLIANCE AS HEAVY IMPACTS MAY CAUSE INTERNAL DAMAGE.

## **WARNING**

- CHECK THE APPLIANCE AND POWER CABLE CAREFULLY FOR DAMAGE BEFORE EACH USE.
- KEEP THE APPLIANCE AWAY FROM CHILDREN.
- BEFORE CONNECTING THE APPLIANCE, CHECK IF THE VOLTAGE INDICATED ON THE BOTTOM OF THE APPLIANCE IS IN ACCORDANCE WITH THE MAINS VOLTAGE IN YOUR HOME.

- THIS APPLIANCE CAN BE USED BY CHILDREN AGED FROM 8 YEARS AND ABOVE AND PERSONS WITH REDUCED PHYSICAL, SENSORY OR MENTAL CAPABILITIES OR LACK OF EXPERIENCE AND KNOWLEDGE IF THEY HAVE BEEN GIVEN SUPERVISION OR INSTRUCTION CONCERNING USE OF THE APPLIANCE IN A SAFE WAY AND UNDERSTAND THE HAZARDS INVOLVED. CHILDREN SHALL NOT PLAY WITH THE APPLIANCE. CLEANING AND USER MAINTENANCE SHALL NOT BE MADE BY CHILDREN WITHOUT SUPERVISION.
- CHILDREN OF LESS THAN 3 YEARS SHOULD BE KEPT AWAY UNLESS CONTINUOUSLY SUPERVISED.
- DO NOT USE IF THE POWER CORD OR PLUG IS DAMAGED. TO BE REPAIRED BY A QUALIFIED ELECTRICIAN OR TO BE REPLACED BY THE MANUFACTURER, SERVICE AGENT OR SIMILARLY QUALIFIED PERSON, IN ORDER TO AVOID A HAZARD.

## CARE AND CLEANING INSTRUCTIONS

- Always switch off and unplug before cleaning.
- Do NOT immerse in water. Risk of electric shock.
- Do NOT use abrasive cleaners or sharp utensils to clean this appliance.
- Wipe surfaces with a soft dry cloth.
- Allow to dry thoroughly before further use.
- Store the unit in a cool, dry place.

## DISPOSAL

- Dispose of all packaging, paper, cartons and plastic, plastic bags in accordance with your local recycling regulations.
- At the end of the product's lifespan please dispose of it at an authorised household WEEE waste recycling centre.

