

Wheeled Kitchen Trolley & Cabinet

10635

Instructions for Use

Please read and retain these instructions for future reference

v002: 06/04/17



*Calls cost 7 pence per minute plus your telephone company's network access charge.

Head Office, 11 Bridge Street,
Bishop's Stortford CM23 2JU
Tel: 0844 482 4400*
Fax: 01279 756595
www.coopersofstortford.co.uk

Coopers
OF STORTFORD

Parts:

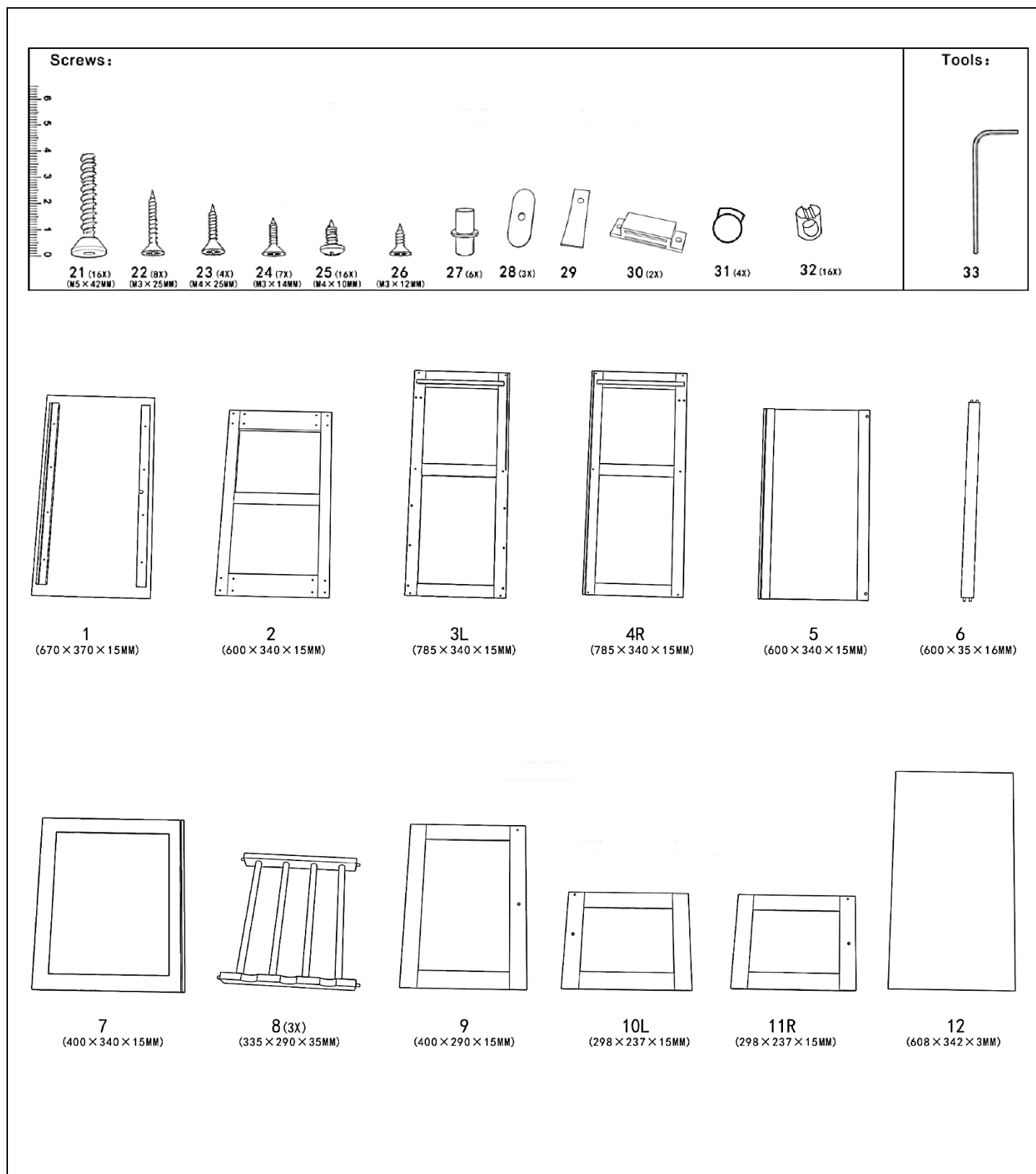

Please read and retain these instructions for future reference

v002: 06/04/17

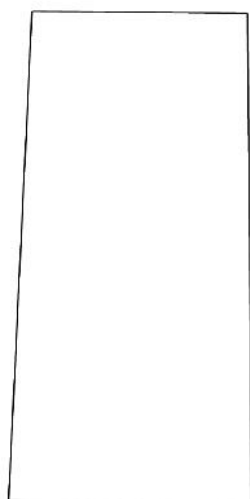

13
(580 × 265 × 3MM)

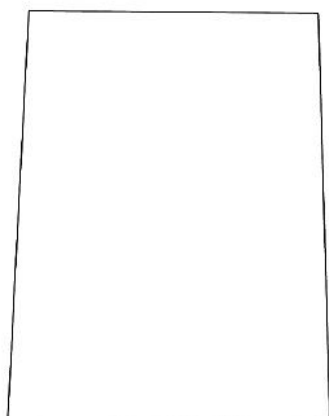

14
(412 × 302 × 3MM)



15
(600 × 72 × 15MM)

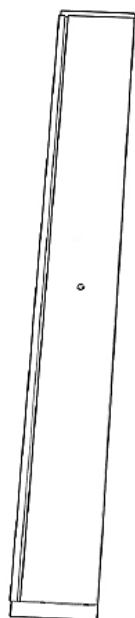

16
(572 × 72 × 15MM)

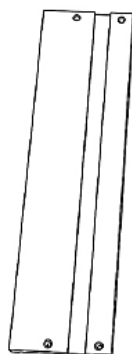

17L
(280 × 72 × 12MM)

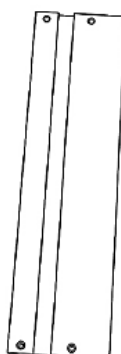

18R
(280 × 72 × 12MM)

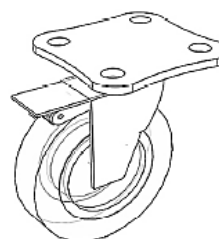

19 (2X)

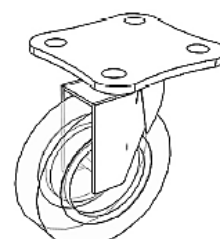

20 (2X)

Step 1:

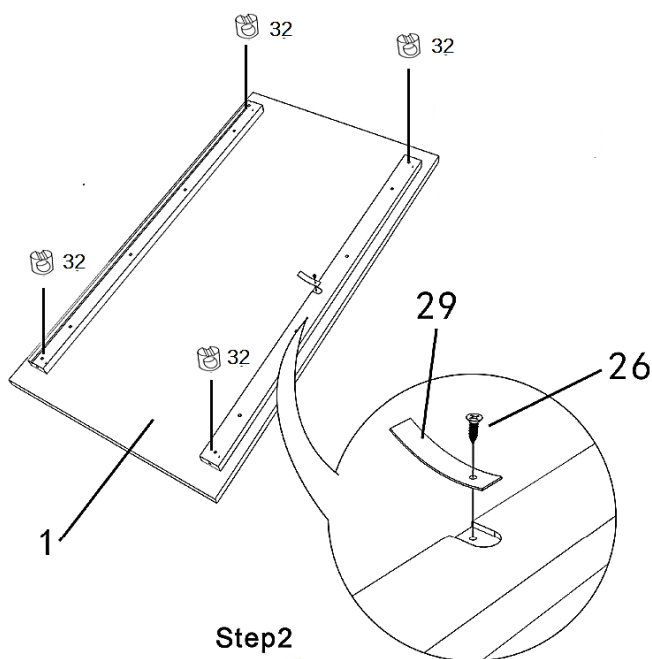
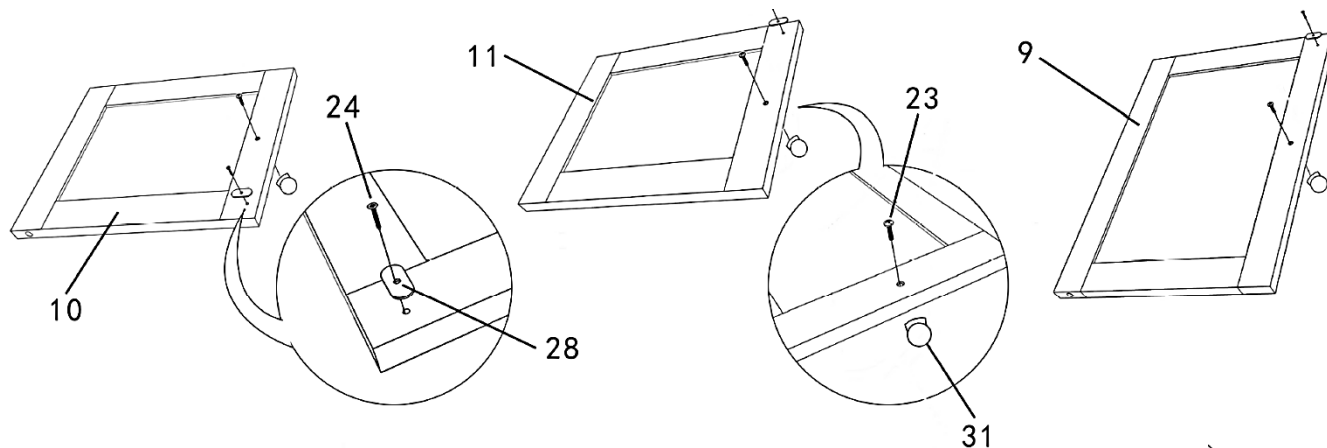

Step 2

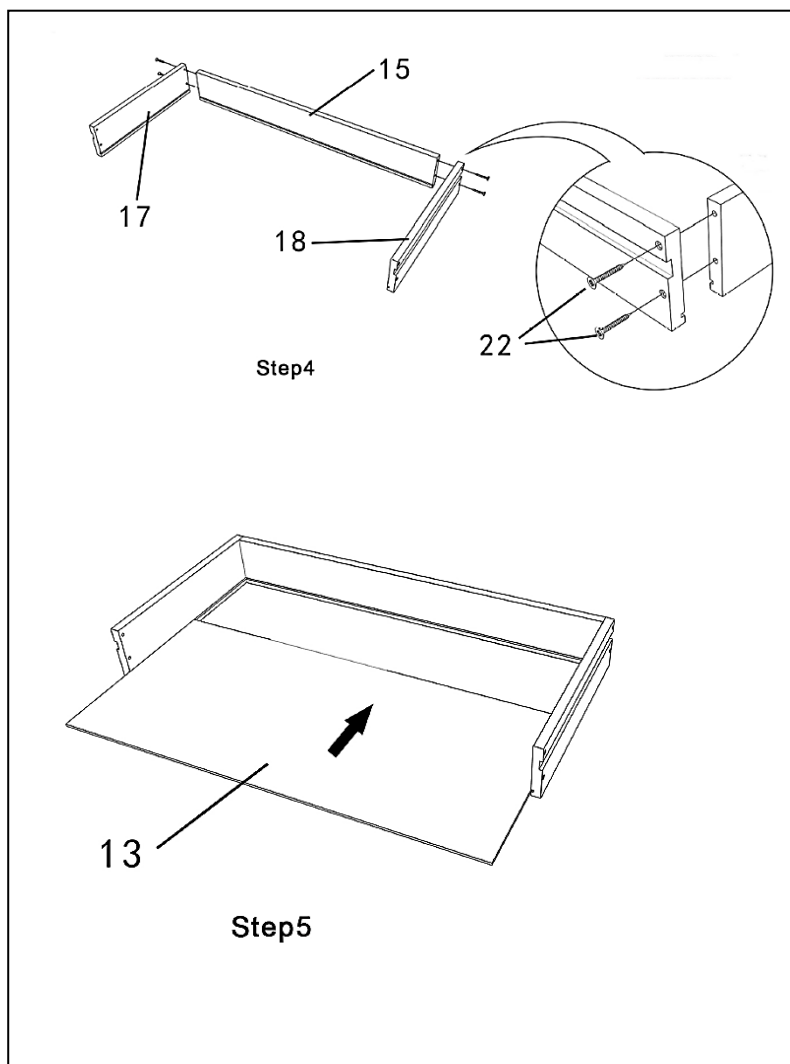
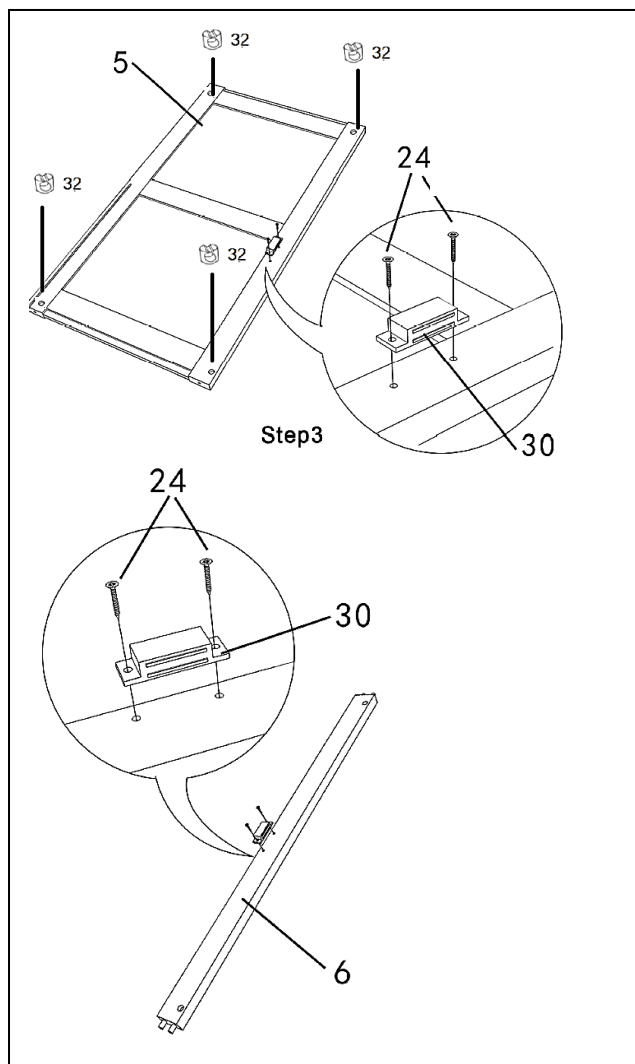

Step 6:

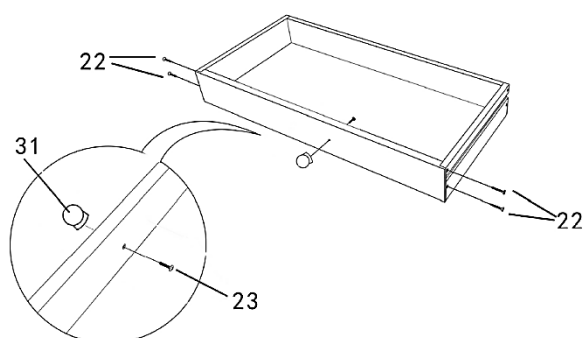

Step 7:

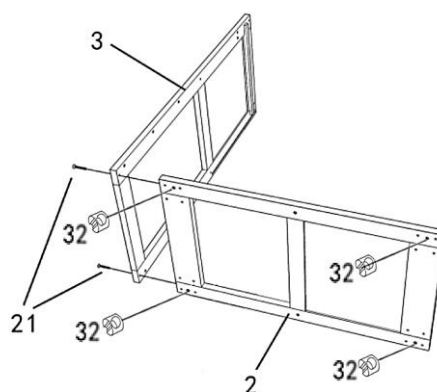

Step 8:

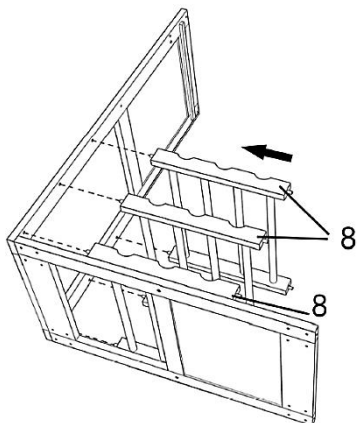

Step 9:

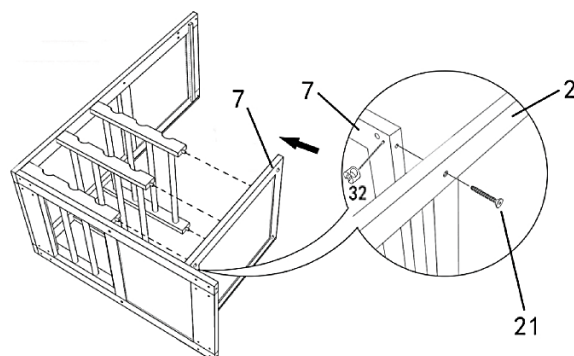

Step 10:

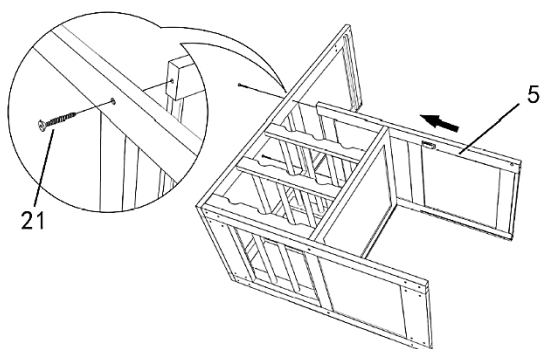

Step 11:

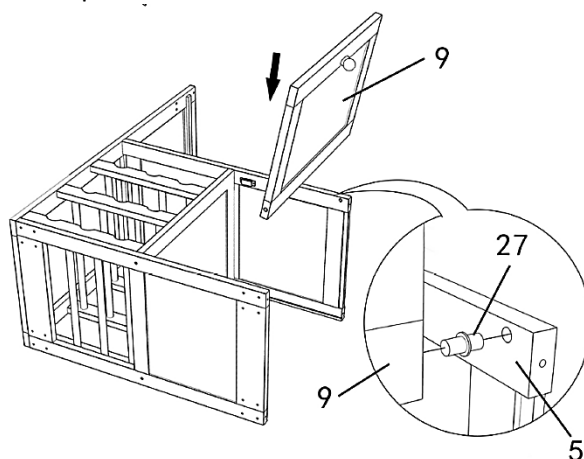

Step 12:

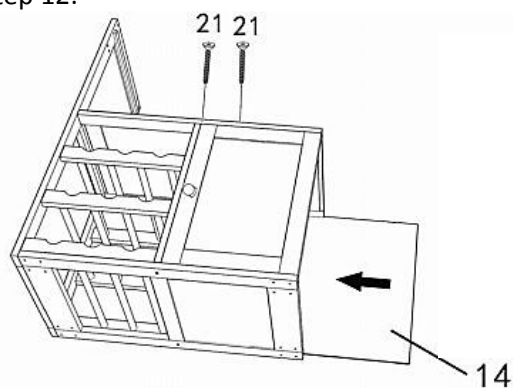

Step 13:

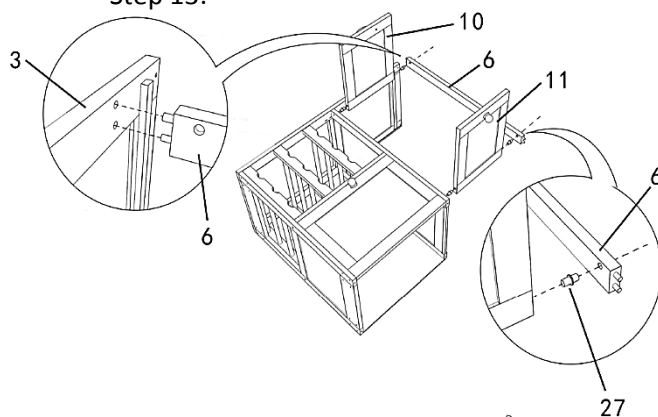

Step 14:

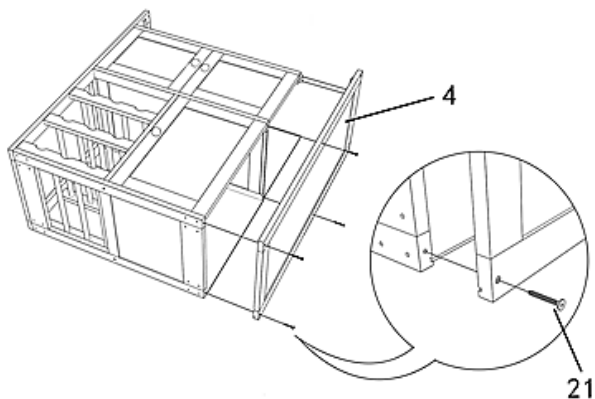

Step 15:

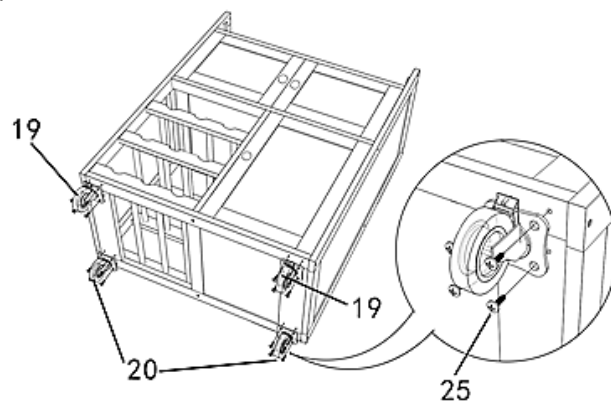

Step 16:

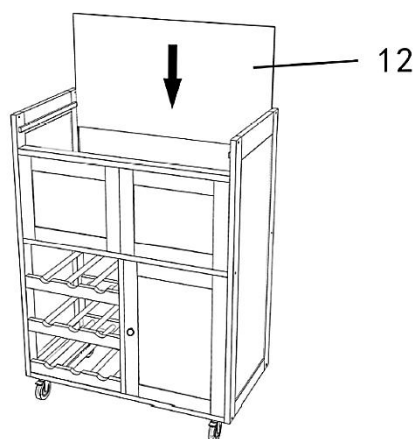

Step 17:

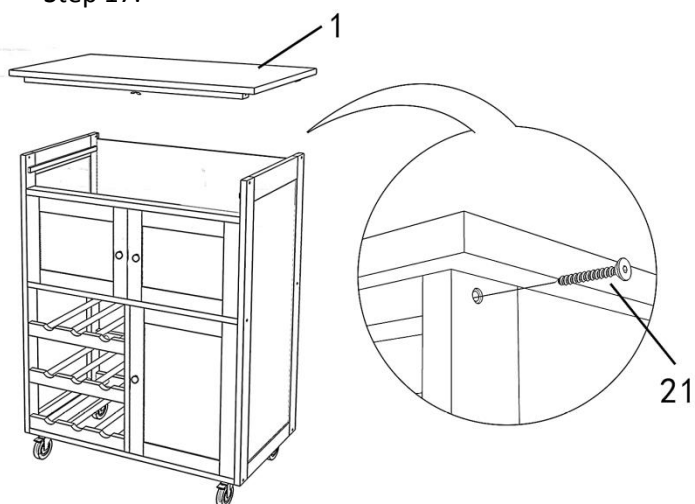

Step 18:

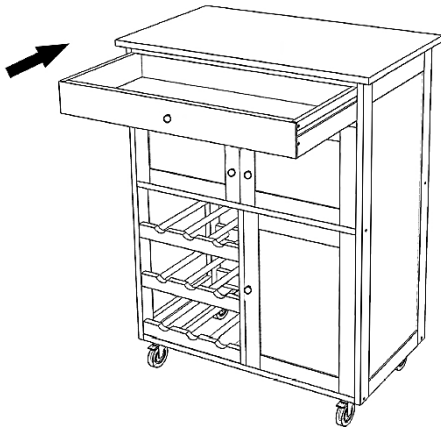

Step 19:



WARNINGS / CAUTIONS:

- Do NOT overload the drawers to avoid tipping.
- Ensure the wheels are secure and level and check regularly.
- For Indoor use.

CLEANING INSTRUCTIONS:

- Wipe clean with a soft damp cloth.

DISPOSAL:

- Dispose of all packaging, paper, cartons and plastic, plastic bags in accordance with your local recycling regulations.
- At the end of the product's lifespan please dispose of it at an authorised household waste recycling centre.