

# Wireless Receiver w/Doorbell 10708 Instructions for Use

Please read and retain these instructions for future reference

v001: 23/11/16

## Receiver

### PARTS & FUNCTION DOOR BELL

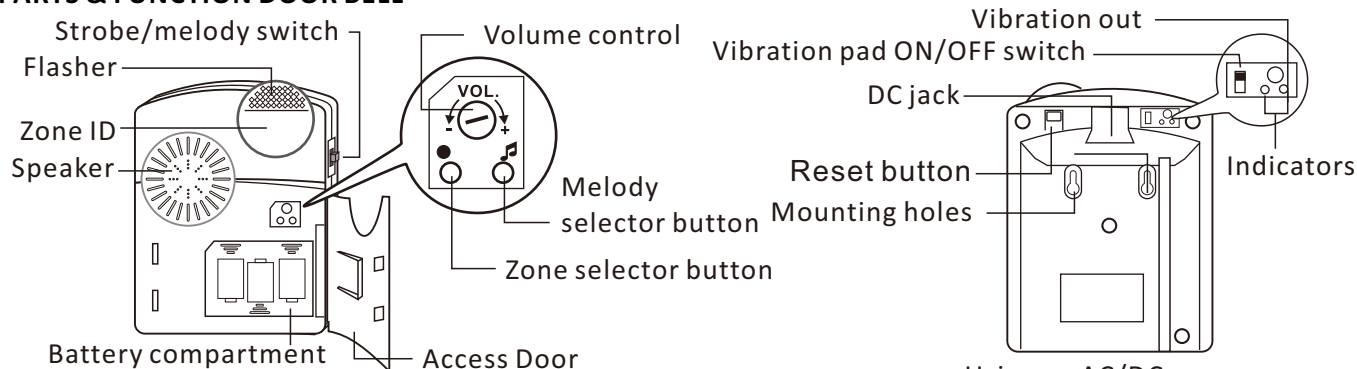

### MOUNTING

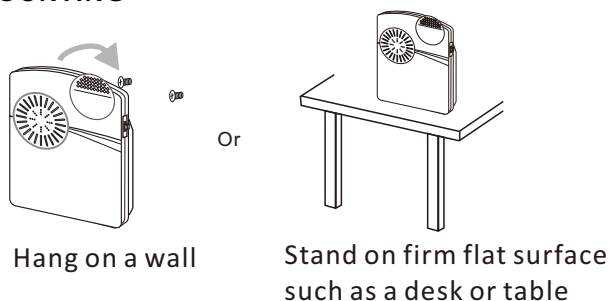

### POWER

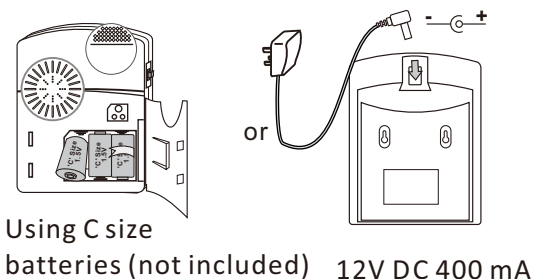

## Doorbell pusher

### PARTS & FUNCTION DOOR BELL



### MOUNTING

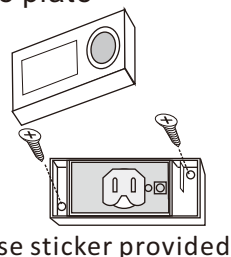

### POWER

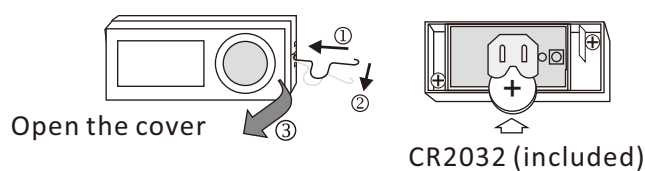

## CODE PAIRING & MELODY SELECTION

\* PLEASE NOTE THE BELL PUSHER AND CHIME UNIT ARE PAIRED AND READY TO USE.

Step 1: Insert the battery into the transmitter to be used (Doorbell button)

Step 2: Insert the batteries into the receiver (chime unit).

Step 3: Enter pairing mode for the receiver (chime unit). Press and hold the ● zone selector button for 3 seconds. The LED in zone #1 will flash.

Step 4: Press the ● zone selector button again to move to the zone you wish to pair with. Press 🎵 button to scroll through the melodies. Once you hear a melody you prefer, do not press any button as the melody is set for that zone.

Step 5: Once the zone & melody are selected, press the Doorbell button once to pair. If successful, the receiver (chime unit) will generate two short tones. Press the ● zone selector button to exit the pairing mode, the system is now ready to use.

To stop the Chime while the receiver (chime unit) is alerting press the reset button.

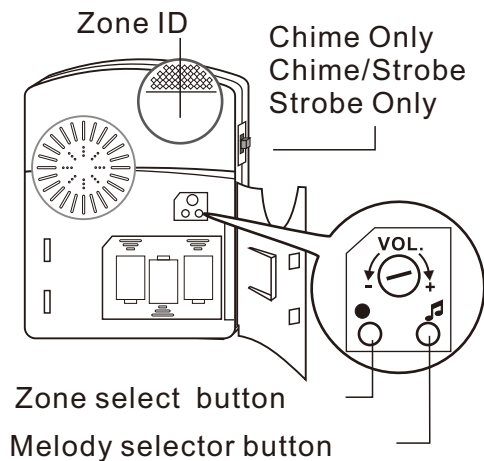

# Wireless Receiver w/Doorbell 10708 Instructions for Use

Please read and retain these instructions for future reference

v001: 23/11/16

## **Clear transmitter on the chime memory**

Press and hold the ● zone selector button for 3 seconds to enter the pairing mode. Press the ● zone selector button to move to the zone you want to delete. Press and hold the ● zone selector button and the 🎵 button together for 3 seconds to delete the memory. The receiver will generate a tone to indicate the transmitter on the specified zone has been deleted.

## **Change the melody in desired zone**

Press and hold the ● zone selector button for 3 seconds to enter the pairing mode. Press the ● zone selector button to move to the zone then press the 🎵 button to select the melody required. Press the ● zone selector button until the pairing mode is exited.

## **Notes**

To cancel any alert on the remote receiver press the reset button. The reset button is located on the back of the receiver behind the flasher.

## **Battery low indicator**

If a zone LED is blinking, it indicates that the battery is low for this transmitter. You must replace the battery as soon as possible. If the white flash at the top of the chime blinks every 5 seconds, this indicates the receiver batteries are low. You must replace the batteries of the receiver immediately.

## **WARNINGS / CAUTIONS**

- For best results, use good quality alkaline batteries.
- Always replace old or weak batteries.
- Keep doorbell dry. If wet, dry immediately.
- Do not use cleaning solvents on electronic products.
- Solvents contain chemicals that can damage circuitry. Use damp towel or cloth to clean. Dry immediately.
- Do not expose the bell unit to rain or immerse in water. It is not water resistant.

## **BATTERIES**

- Keep batteries away from children and pets.
- Do not mix used and new batteries.
- Remove the batteries if left for long periods.
- Never dispose of batteries in a fire.
- Battery disposal, spent or expired batteries must be properly disposed of and recycled in compliance with local regulations. For detailed information, contact your local authority.
- Follow the battery manufacturer's safety, usage, and disposal instructions.

## **DISPOSAL**

- Dispose of all packaging, paper, cartons and plastic, plastic bags in accordance with your local recycling regulations.
- At the end of the product's lifespan please dispose of it at an authorised household WEEE waste recycling centre.

