

Wireless Telephone Signaller 10710 Instructions for Use

Please read and retain these instructions for future reference

v001: 23/11/16

The wireless Telephone Signaller is to be used in conjunction with Wireless Receiver with Doorbell - Item code 10708.

PARTS & FUNCTION

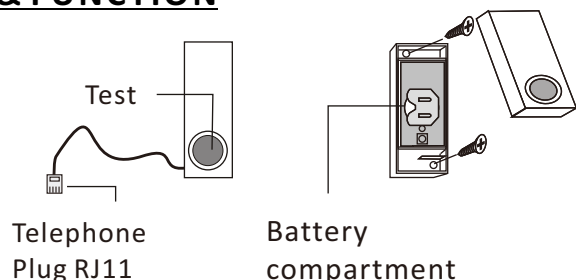

BATTERY INSTALLATION

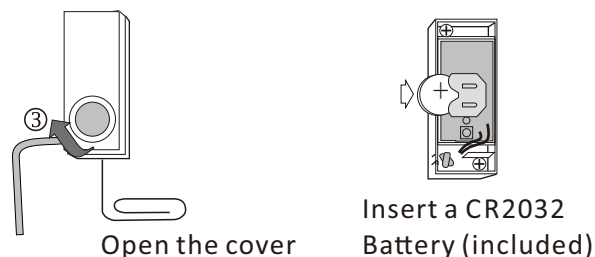

CODE PAIRING & MELODY SELECTION

The WIRELESS TELEPHONE SIGNALER works with the receiver and must be paired prior to use.

Step 1: Insert the battery into the telephone transmitter.

Step 2: Insert the batteries into the receiver (chime unit).

Step 3: Enter pairing mode for the receiver (chime unit). Press & hold the ● zone selector button for 3 seconds. The LED in zone #1 will flash.

Step 4: Press the ● zone selector button again to move to the zone you wish to pair with. Press the 🎵 melody selector button to scroll through the melodies. Once you hear a melody you prefer, do not press any button as the melody is set for that zone.

Step 5: Once the zone and melody are selected, press the test button on the telephone signaller once. If successful, the receiver will generate a short tone. Press the ● zone selector button to exit pairing mode unit is now ready to use.

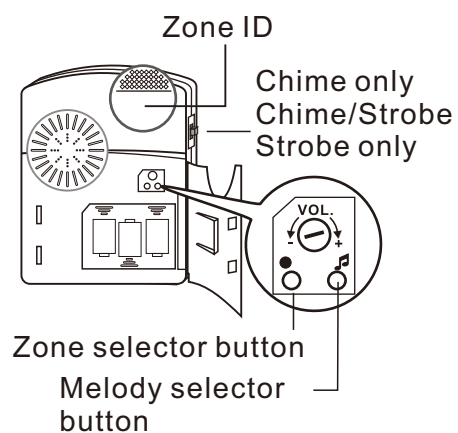

Alert Reset Button

To cancel any alert on the remote receiver press the reset button. The reset button is located on the back of the receiver behind the flasher.

OPERATION

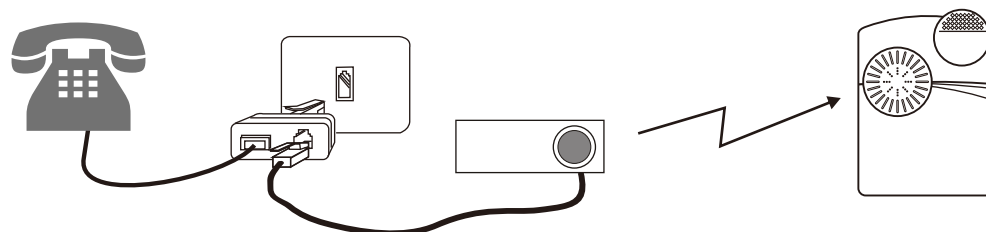

Uses CR2032 Battery

Plug the telephone line into the telephone RJ11 jack refer to the diagram. The system is now ready to use.

*Calls Cost 7 pence per minute plus your telephone company's network access charge

Head Office, 11 Bridge Street
Bishop's Stortford CM23 2JU
Tel: 0844 482 4400*
Fax: 01279 756595

www.coopersofstortford.co.uk

Coopers
OF STORTFORD

Wireless Telephone Signaller 10710 Instructions for Use

Please read and retain these instructions for future reference

v001: 23/11/16

BATTERY LOW INDICATOR

The status of one sensor battery is indicated on the receiver. Please refer to the “battery low indicator” on the receiver.

CODE CONFLICT

If the telephone signaller coding is the same as another sensor you must change the code. After you have changed the code, re-match the telephone signaller.

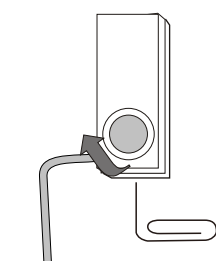

Open the cover

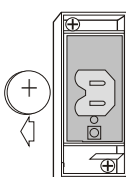

Remove the battery

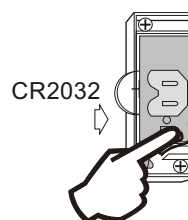

Press & hold the test button, insert the battery whilst holding the button for 5 seconds. The LED will flash 5 times, when a new code is generated.

WARNINGS / CAUTIONS

- Keep telephone signaller dry. If wet, dry immediately.
- Do not use cleaning solvents on electronic products.
- Solvents contain chemicals that can damage circuitry. Use damp towel or cloth to clean. Dry immediately.
- Do not expose the bell unit to rain or immerse in water. It is not water resistant.

BATTERIES

- Keep batteries away from children and pets.
- Do not mix used and new batteries.
- Remove the batteries if left for long periods.
- Never dispose of batteries in a fire.
- Battery disposal, spent or expired batteries must be properly disposed of and recycled in compliance with local regulations. For detailed information, contact your local authority.
- Follow the battery manufacturer’s safety, usage, and disposal instructions.

DISPOSAL

- Dispose of all packaging, paper, cartons and plastic, plastic bags in accordance with your local recycling regulations.
- At the end of the product’s lifespan please dispose of it at an authorised household WEEE waste recycling centre.

