



**Technical Details**  
220-240V – 50/60Hz, 750W



**Caution**  
Hot surface

**CAUTION! THIS ELECTRICAL APPLIANCE'S EXTERNAL SURFACES WILL GET HOT IN NORMAL USE. ALLOW TO COOL BEFORE TOUCHING THE EXTERNAL SURFACES. USE NON-METALLIC UTENSIL TO REMOVE ITEMS FROM THE SANDWICH MAKER.**

**Parts:**

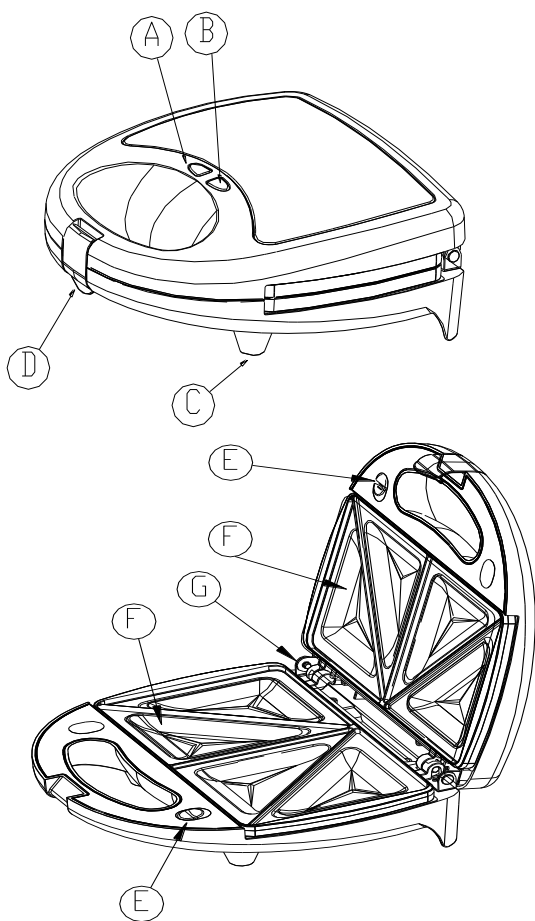

- A. Power pilot light (Red).  
When the sandwich maker is plugged into a wall socket, the red light is on.
- B. Cooking pilot light (Green).  
When the sandwich maker heats up, the green light is on. When the light goes off, the sandwich maker is ready for use.
- C. Feet. To prevent the sandwich maker from sliding.
- D. Handle clamp to close lids and secure.
- E. Slide switch. Slide the top and bottom switch to release the baking plate for cleaning or to replace with another baking plate.
- F. High-temperature non-stick Roasting tray. (see accessories)
- G. Safety shaft. To prevent the sandwich maker from tipping over and to facilitate cleaning.

## Accessories

### Interchangeable 3 non-stick coating plates Sandwich Plates



for making delicious toasted sandwiches

### Waffle Plates



for making 2 square shaped Belgian style waffles at a time

### Grill Plates



for grilling meat and vegetables

## INSTRUCTIONS FOR USE:

### Before using for the first time

- Clean the baking plates with a damp cloth or sponge.
- Slightly grease the baking plates with a little butter or cooking oil.
- Plug in the sandwich maker and heat up the plates until the green Cooking pilot light goes off.
- The sandwich maker is ready for use
- Note: When using this sandwich maker for the first time, a fine smoke haze may result. This is normal because of the initial heating of the internal components.

### Making toasted sandwich

- Put the mains plug into the wall socket. Both the red Power pilot light indicating that the device is working and the green Cooking pilot light indicating the sandwich maker is heating up will light up.
- When the green Cooking pilot light goes off, the sandwich maker is ready for use.
- Prepare the ingredients for your toasted sandwich. For each sandwich you need two slices of bread and a suitable filling.
- To obtain a golden brown result, you can slightly butter the side of the bread in contact with the plate.
- Lay the slices of bread with the buttered side on the lower cooking plate, place your filling and cover with the second slices of bread with buttered side up. You can toast only one sandwich if you wish.
- For optimal result, fillings should be placed well within the sandwich slices.
- Lower the upper cooking plate carefully onto the bread until the sandwich maker is tightly clamped.

- Open the sandwich maker after 2-3 minutes and check whether the toasted sandwich is sufficiently brown. The cooking time required to obtain crisp brown sandwiches depends on the type of bread, fillings and your personal taste.
- Use a non-metallic utensil (not included) to remove the toasted sandwich from the sandwich maker. Do not use sharp or abrasive kitchen utensils.
- Unplug the sandwich maker from the wall socket after use.

Note: During cooking, the green Cooking pilot light cycles on and off to maintain the appliance at the correct temperature.

### **Suggested fillings (for 2 sandwiches):**

Mix 4 tbsp. chopped drained tomatoes with a pinch of dried oregano, salt and pepper. Divide between 2 slices of bread (lightly buttered on one side) and sprinkle with 50g grated cheese. You can also add a slice of salami or ham to each sandwich.

### **Making Belgian style waffles**

Remove sandwich plates and insert waffle baking plates.

Beat 2 eggs in a large bowl with a hand-held mixer until fluffy. Beat in 250g of plain flour mixed with 4 teaspoons baking powder, 120ml vegetable oil, 1 tablespoon of caster sugar, ½ teaspoon of salt and ½ teaspoon vanilla extract. Beat until smooth.

Pour 2 portions of the mixture into sandwich maker and cook until golden brown.

Serve hot.

### **Grilling meat or vegetables**

Marinate the meat, fish or vegetables for 30-60 minutes. Pat dry or drain before grilling.

### **Suggested marinade**

Mix 2 ½ tbsp. olive oil with 1 ½ tbsp. balsamic vinegar. Add 2 cloves of garlic (peeled, crushed) (optional), 1 tsp. of chopped parsley or mint and ½ tsp salt and black pepper.

Please note that cooking times are for guidance and may vary depending on quantity, quality and personal preference. If cooking instructions are noted on the food's packaging, we advise you to follow these in order to get the best results. Check food is cooked before serving. If in doubt cook a little more and check again.

### **CARE AND CLEANING INSTRUCTIONS:**

- Unplug the sandwich maker and let it cool down before cleaning
- Clean the cooking plates with a damp cloth/sponge. Avoid water running into the appliance.
- Never immerse the appliance in water.
- Never use an abrasive cloth as it will damage the coating of the plate.
- The appliance can be stored in a vertical position.

### **WARNINGS AND SAFETY INSTRUCTIONS:**

WHEN USING ELECTRICAL APPLIANCES, BASIC SAFETY PRECAUTIONS SHOULD ALWAYS BE FOLLOWED:

- READ ALL INSTRUCTIONS BEFORE USE.
- FOR DOMESTIC INDOOR USE ONLY.
- DO NOT USE OUTDOORS OR FOR COMMERCIAL USE.

- BEFORE USE, CHECK THOROUGHLY FOR ANY DEFECTS AND DO NOT USE IF DEFECTS ARE FOUND. TAKE CARE NOT TO DROP THE APPLIANCE AS HEAVY IMPACTS MAY CAUSE INTERNAL DAMAGE.
- BEFORE CONNECTING THE APPLIANCE, CHECK IF THE VOLTAGE INDICATED ON THE BOTTOM OF THE APPLIANCE IS IN ACCORDANCE WITH THE MAINS VOLTAGE IN YOUR HOME.
- CHECK THE APPLIANCE AND POWER CABLE CAREFULLY FOR DAMAGE BEFORE EACH USE.
- EXTREME CAUTION MUST BE USED WHEN MOVING AN APPLIANCE CONTAINING HOT OIL OR OTHER HOT LIQUIDS.
- ALWAYS PLACE THE SANDWICH MAKER ON A HEAT RESISTANT SURFACE.
- DO NOT ATTEMPT TO DISLodge FOOD WHEN APPLIANCE IS PLUGGED IN.
- DO NOT LEAVE UNATTENDED WHILE IN USE.
- NEVER PLACE ANYTHING BETWEEN THE PLATE AND THE FOOD I.E. DISH, ALUMINIUM FOIL, ETC.
- THIS APPLIANCE CAN BE USED BY CHILDREN AGED FROM 8 YEARS AND ABOVE AND PERSONS WITH REDUCED PHYSICAL, SENSORY OR MENTAL CAPABILITIES OR LACK OF EXPERIENCE AND KNOWLEDGE IF THEY HAVE BEEN GIVEN SUPERVISION OR INSTRUCTION CONCERNING USE OF THE APPLIANCE IN A SAFE WAY AND UNDERSTAND THE HAZARDS INVOLVED. CHILDREN SHALL NOT PLAY WITH THE APPLIANCE. CLEANING AND USER MAINTENANCE SHALL NOT BE MADE BY CHILDREN WITHOUT SUPERVISION.
- CHILDREN OF LESS THAN 3 YEARS SHOULD BE KEPT AWAY UNLESS CONTINUOUSLY SUPERVISED.
- **SOME PARTS OF THIS PRODUCT CAN BECOME VERY HOT AND CAUSE BURNS. PARTICULAR ATTENTION HAS TO BE GIVEN WHERE CHILDREN AND VULNERABLE PEOPLE ARE PRESENT.**
- THE USE OF ANY ACCESSORY ATTACHMENTS NOT RECOMMENDED BY COOPERS OF STORTFORD MAY CAUSE INJURIES AND INVALIDATE ANY WARRANTY YOU MAY HAVE.
- DO NOT LET THE POWER CABLE HANG OVER THE EDGE OF A TABLE OR COUNTER, OR TOUCH HOT SURFACES.
- DO NOT PLACE ON OR NEAR HEAT SOURCES.
- USE ON A LEVEL, STABLE SURFACE.
- DO NOT COVER THE ITEM IN ANY WAY WHEN IN USE AS THIS MAY CAUSE OVERHEATING.
- DO NOT USE THIS APPLIANCE FOR ANY OTHER USE THAN THE INTENDED USE IT IS DESIGNED FOR.
- ENSURE THERE IS SUFFICIENT DISTANCE BETWEEN THIS APPLIANCE AND OTHER ITEMS ON THE WORK SURFACE OR WORK STATION, OR SUFFICIENT DISTANCE BETWEEN THE APPLIANCE AND THE CONFINES OF THE AREA IN WHICH IT IS SITUATED. WE RECOMMEND A MINIMUM CLEARANCE AROUND ALL FACES OF AT LEAST 10CM.
- DO NOT PLACE UNDER OR NEAR FLAMMABLE MATERIALS SUCH AS CURTAINS, DRAPERIES, SHELVES, LOOSE WALL PAPER, ETC.
- ALLOW THE ITEM TO COOL THOROUGHLY BEFORE PUTTING ON OR TAKING OFF PARTS.
- KEEP ITEM AT LEAST 1M AWAY FROM COMBUSTIBLE MATERIAL SUCH AS FURNITURE, CUSHIONS, BEDDING, PAPER, CLOTHES, CURTAINS ETC.
- TO PROTECT AGAINST ELECTRIC SHOCK, DO NOT IMMERSE POWER CABLE, PLUG OR APPLIANCE, IN WATER OR ANY OTHER LIQUID.
- UNPLUG FROM OUTLET WHEN NOT IN USE AND BEFORE CLEANING.
- DO NOT OPERATE ANY APPLIANCE WITH A DAMAGED POWER CABLE OR PLUG OR AFTER THE APPLIANCE MALFUNCTIONS, OR HAS BEEN DAMAGED IN ANY MANNER. WE RECOMMEND THAT THE POWER CABLE IS NOT KINKED OR STORED IN A TWISTED MANNER, AND THAT YOU REGULARLY CHECK ITS CONDITION.
- ANY REPAIRS MUST BE CONDUCTED BY A QUALIFIED ELECTRICIAN OR ELECTRICAL SERVICE AGENT.

Please read and retain these instructions for future reference

v00124/04/18

The 3 in 1 Sandwich Maker is fitted with a 13A Moulded plug. If this plug breaks, then seek a qualified electrician to replace this with a rewire-able BS1363 13 Amp plug.

## DISPOSAL

- Dispose of all packaging, paper, cartons, plastic and plastic bags in accordance with your local recycling regulations.
- At the end of the product's lifespan please dispose of it at an authorised household WEEE waste recycling centre.

